



OZCO BUILDING PRODUCTS

Product & Packaging Specs

6x6 Post Band (6X6-BND-IW)

Item #: 51786

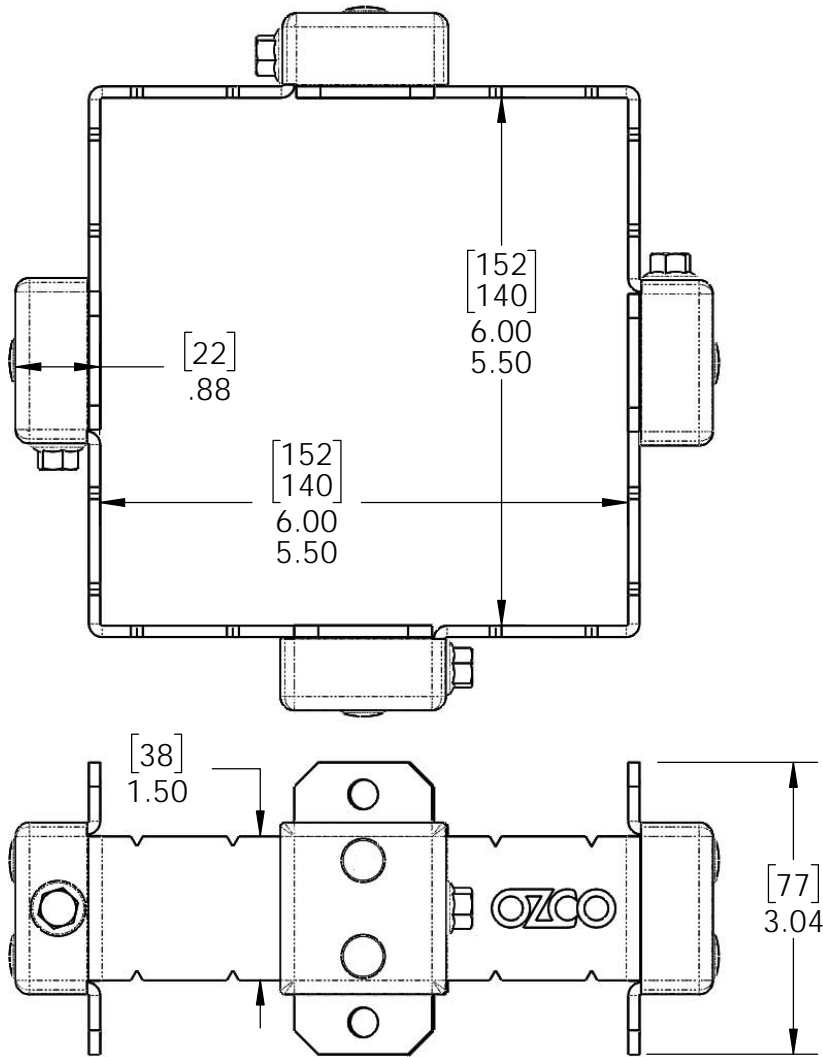

ITEM NO.	QTY.	PART NUMBER	DESCRIPTION
1	4	51786-11	Clamp, 6x6 Post Band IW
2	4	Screw	Screw, 1/4-20x1.50, Stainless Steel
3	8	9563K62	Plug, Metal Round for .25 hole

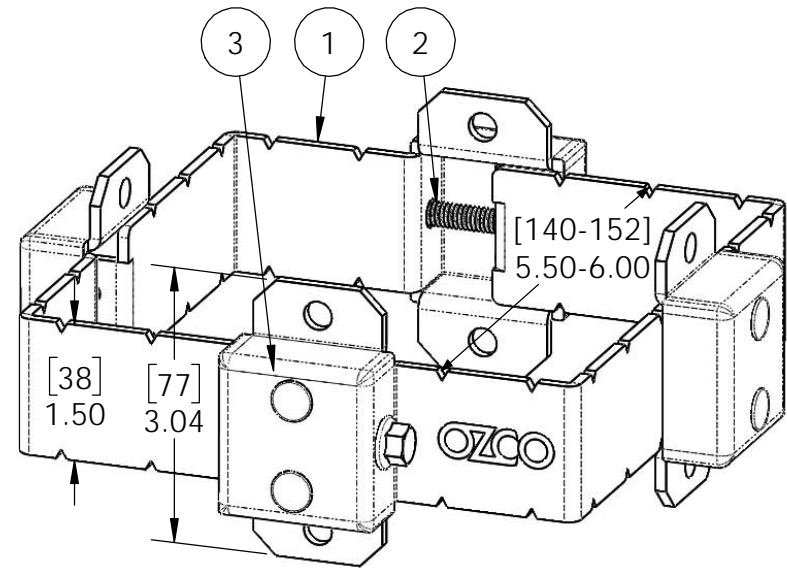

Weight: 12.18 LBS
 Scale: 1:2
 Last updated: 2/7/2018

51786

Product & Packaging Specs

6x6 Post Band (6X6-BND-IW)

Item #: Typical Installation 5.5"

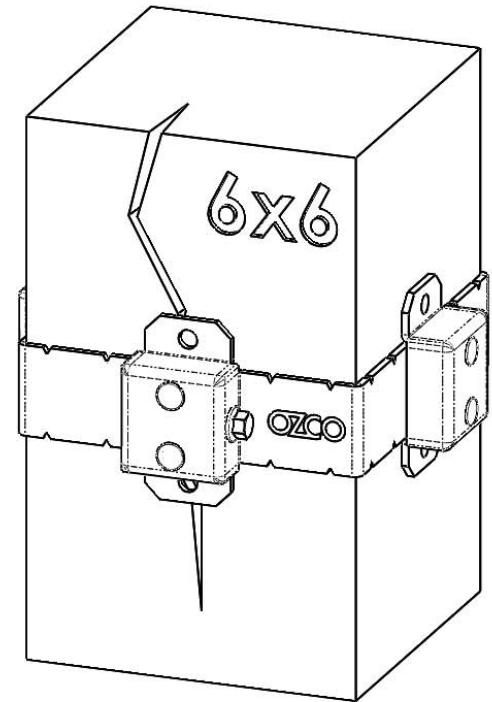
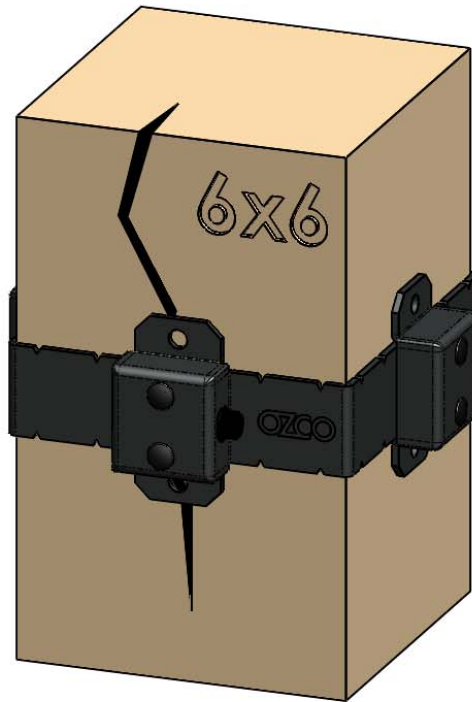
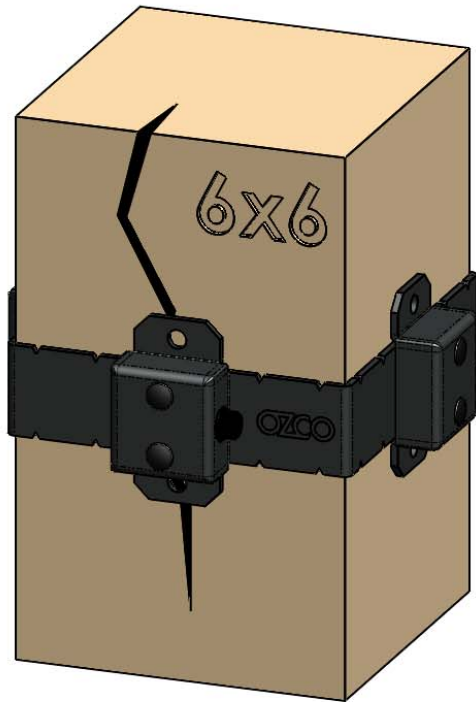

Weight: 12.18 LBS
Scale: 1:3
Last updated: 2/7/2018

51786



OZCO BUILDING PRODUCTS

Product & Packaging Specs

6x6 Post Band (6X6-BND-IW)

Item #: Typical Installation 5.5"

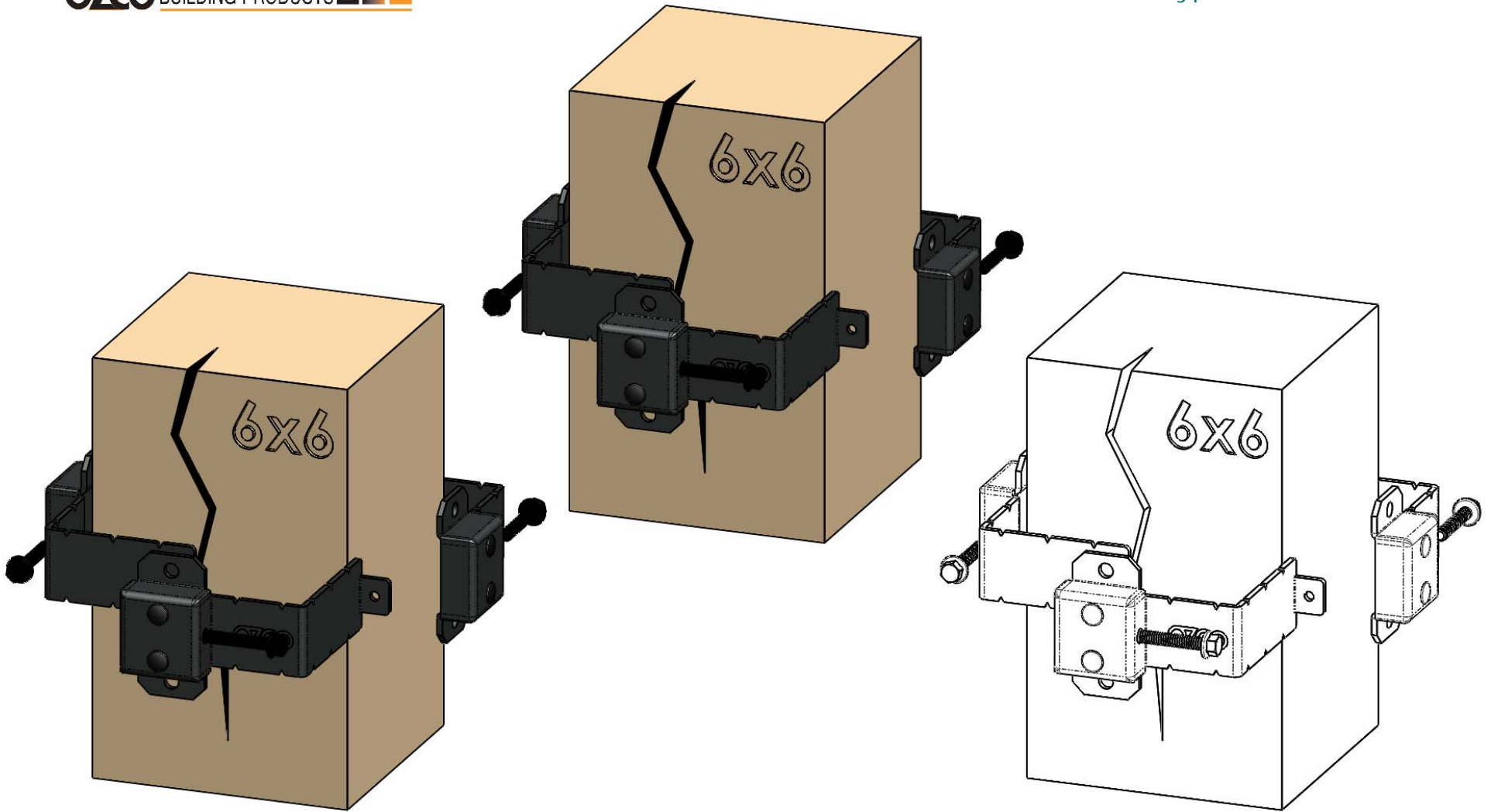

Weight: 12.18 LBS
Scale: 1:3
Last updated: 2/7/2018

51786

Product & Packaging Specs

6x6 Post Band (6X6-BND-IW)

Item #: Typical Installation

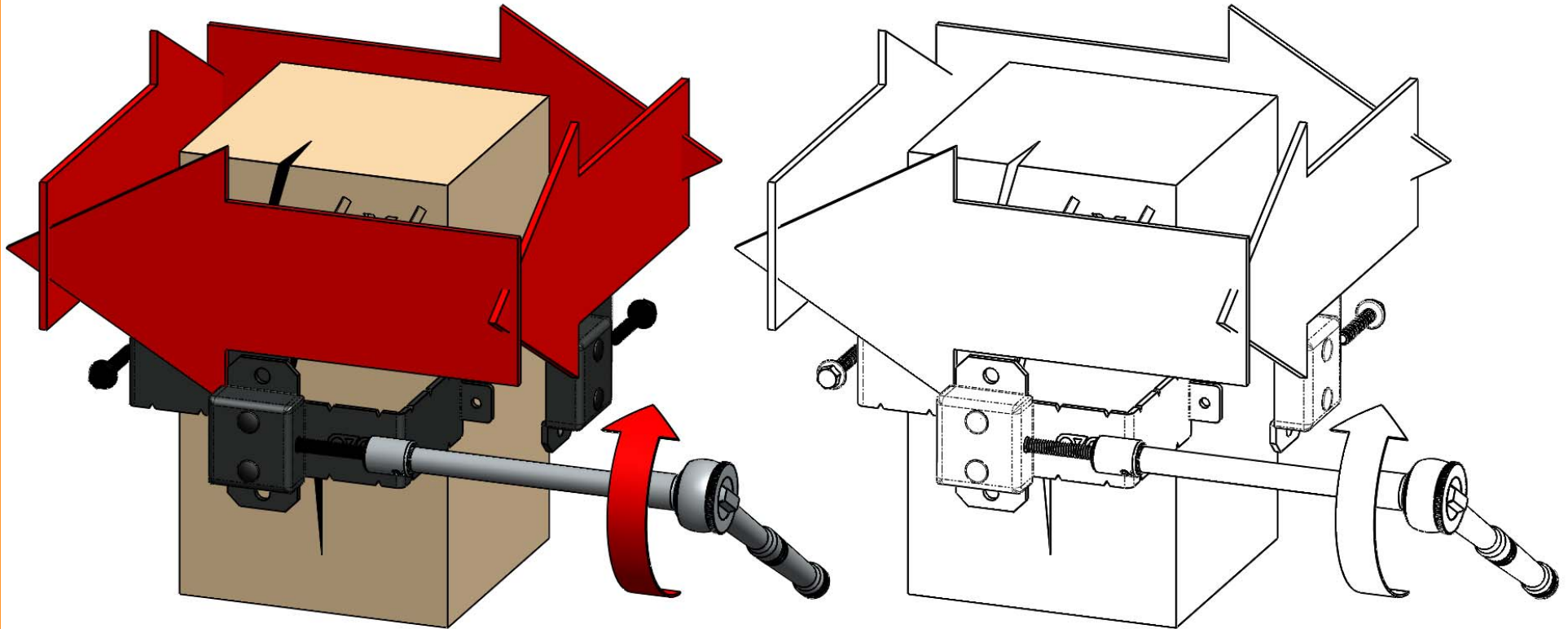

Weight: 12.18 LBS
Scale: 1:3
Last updated: 2/7/2018

51786



OZCO BUILDING PRODUCTS

Product & Packaging Specs

Box, 51786

Item #: Blister Pack

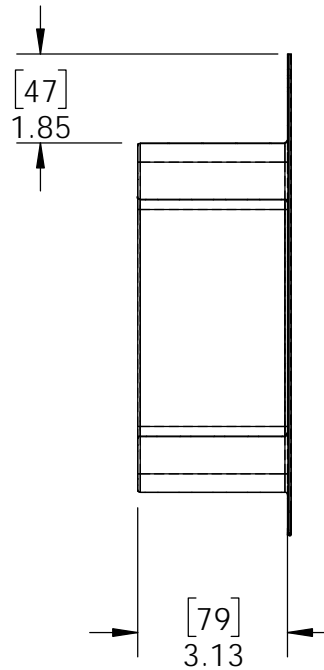
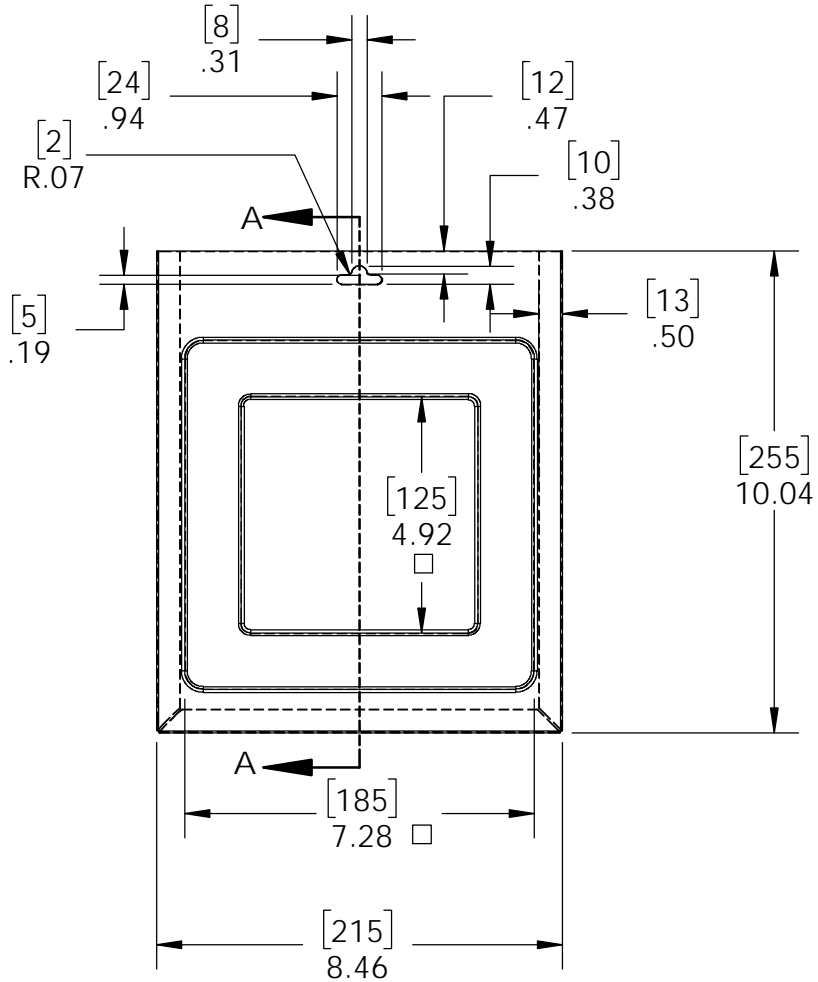

SECTION A-A

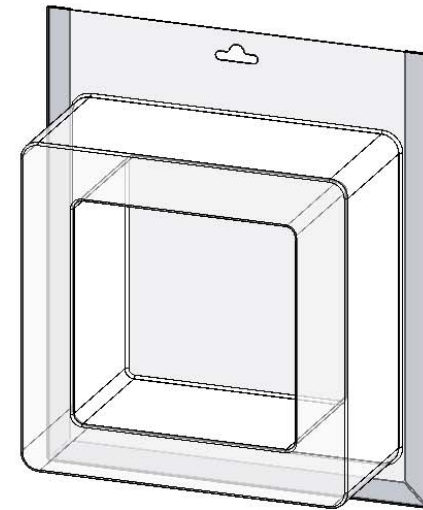

Material: ABS PC
Finish: -
Weight: 0.10 LBS
Scale: 1:4
Last updated: 2/7/2018

51786



OZCO BUILDING PRODUCTS

Product & Packaging Specs

Box, 51786

Item #: Backing

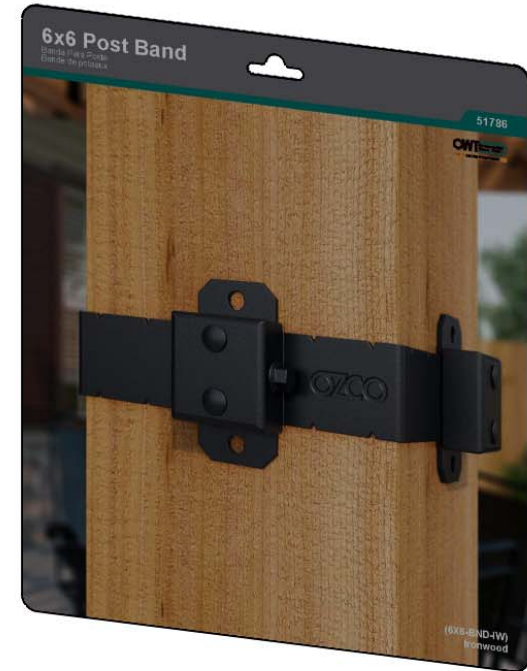
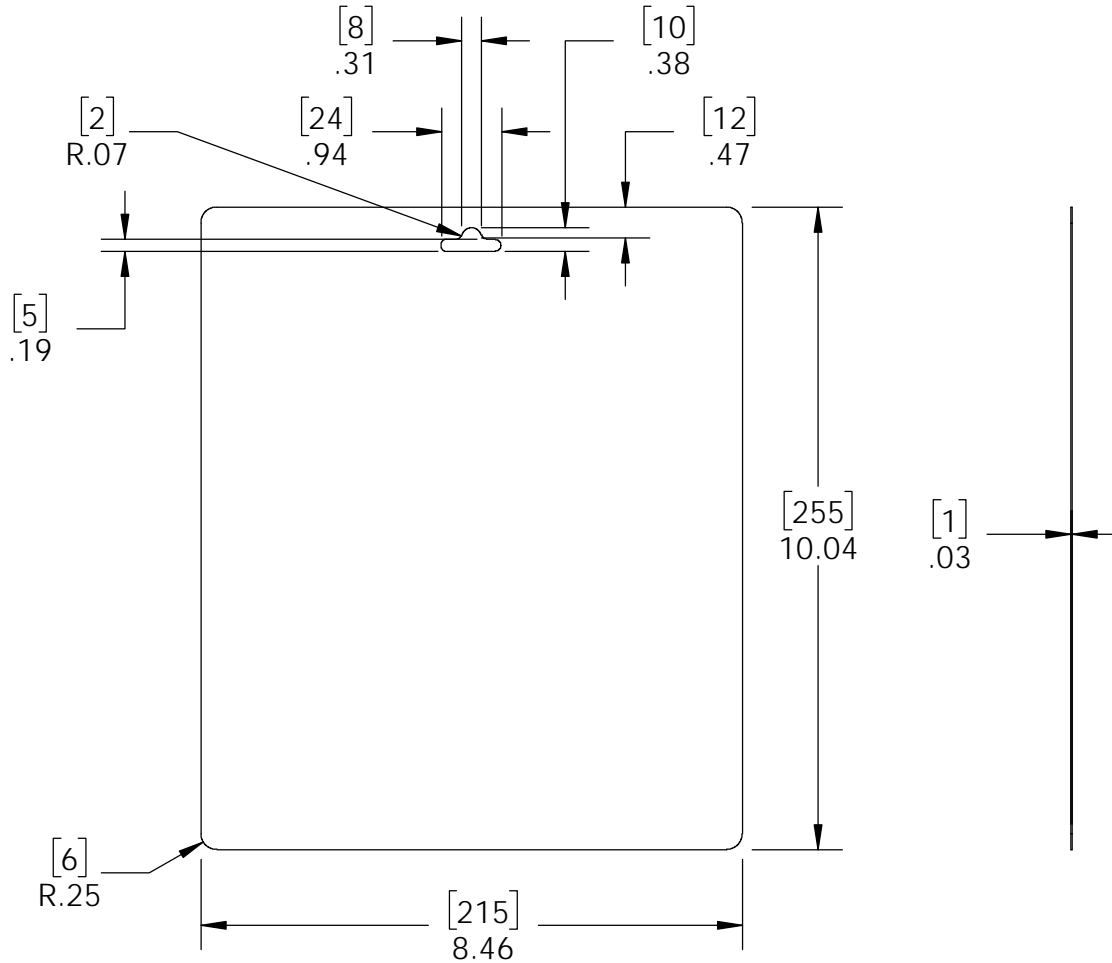

Material: Corrugated Paper
Finish: See Artwork
Weight: 0.01 LBS
Scale: 1:3
Last updated: 2/7/2018

51786



OZCO BUILDING PRODUCTS

Product & Packaging Specs

51786 Packing

Item #: Box packing

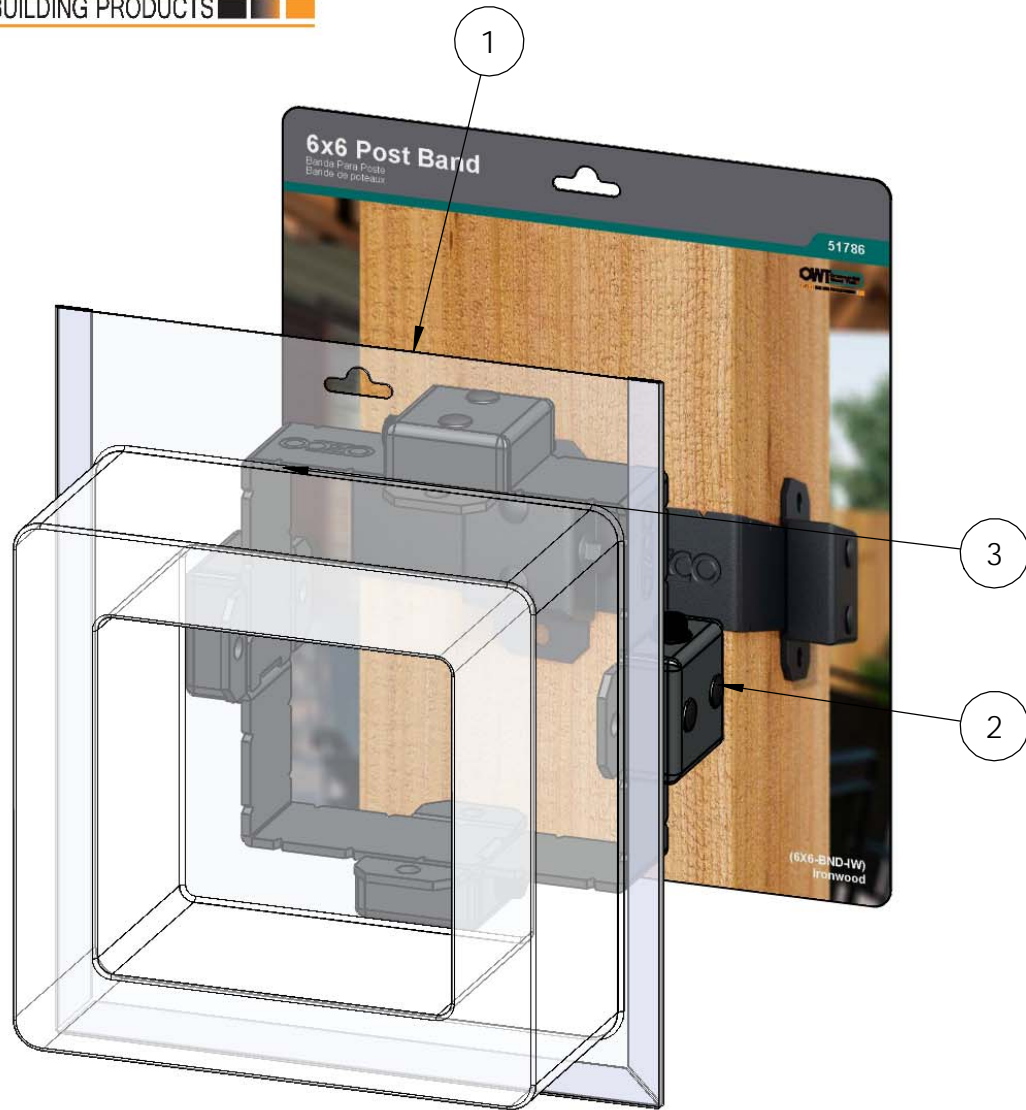

ITEM NO.	Box packing/ QTY.	PART NUMBER	DESCRIPTION
1	1	Box, 51786	Box, 51786
2	1	51786	6x6 Post Band (6X6-BND-IW)
3	1	Box, 51786	Box, 51786

Weight: 2.48 LBS
 Scale: 1:2.5
 Last updated: 2/7/2018

51786

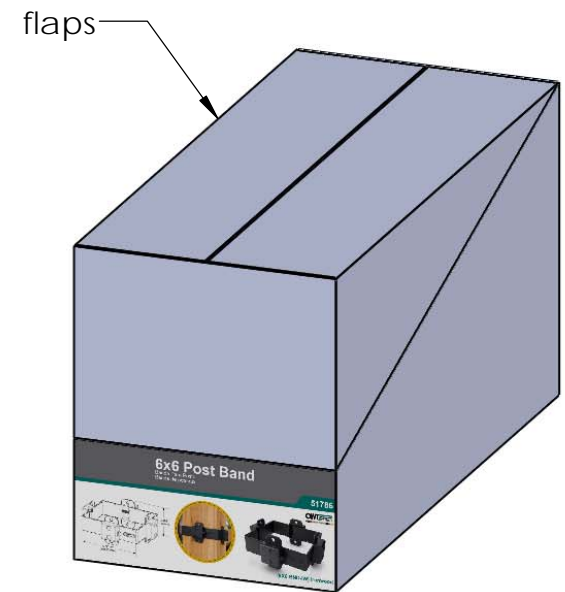
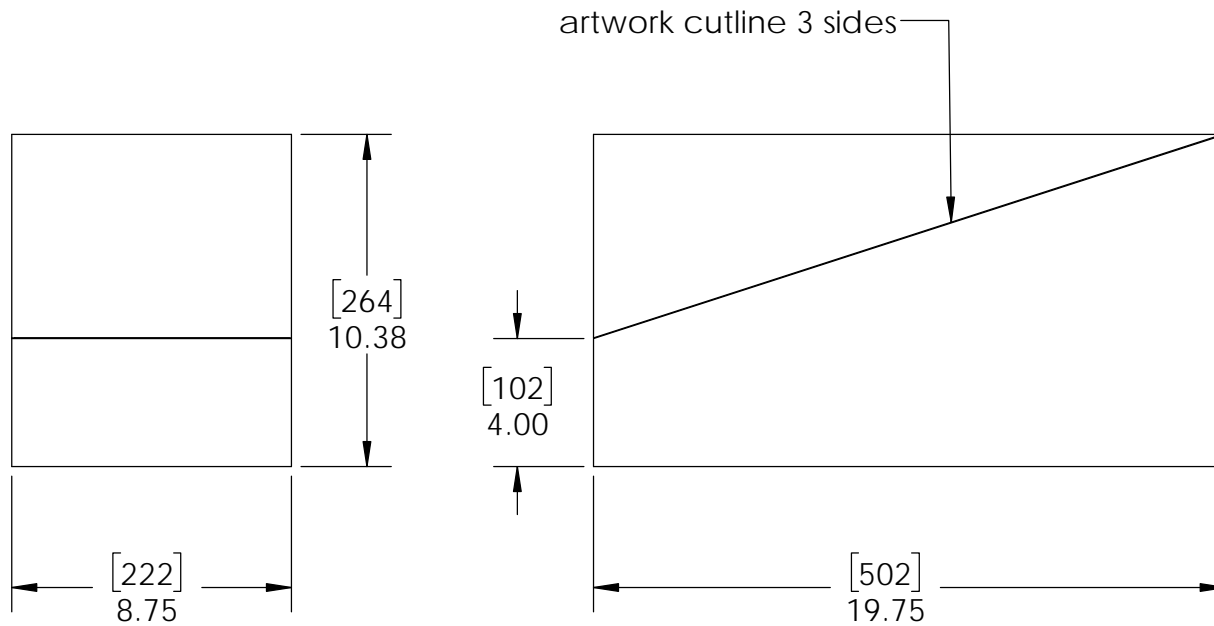

Material: Corrugated Paper
 Finish: See artwork
 Weight: 0.41 LBS
 Scale: 1:6
 Last updated: 2/7/2018

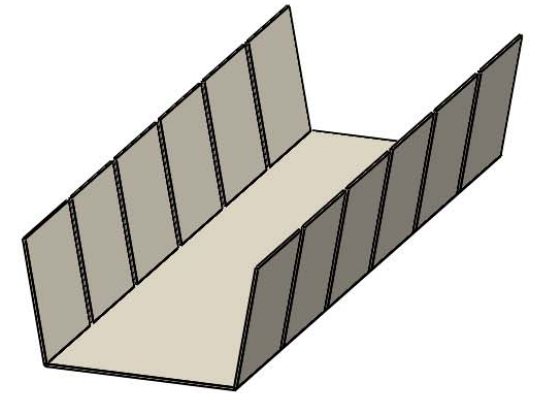
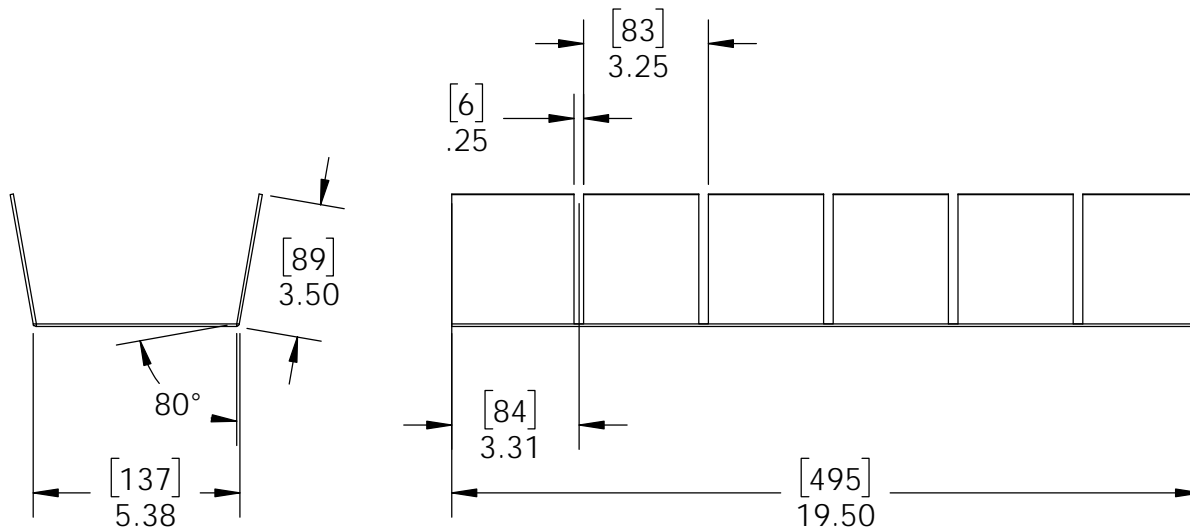

Material: Corrugated Paper
 Finish: -
 Weight: 0.10 LBS
 Scale: 1:5
 Last updated: 2/7/2018

51786

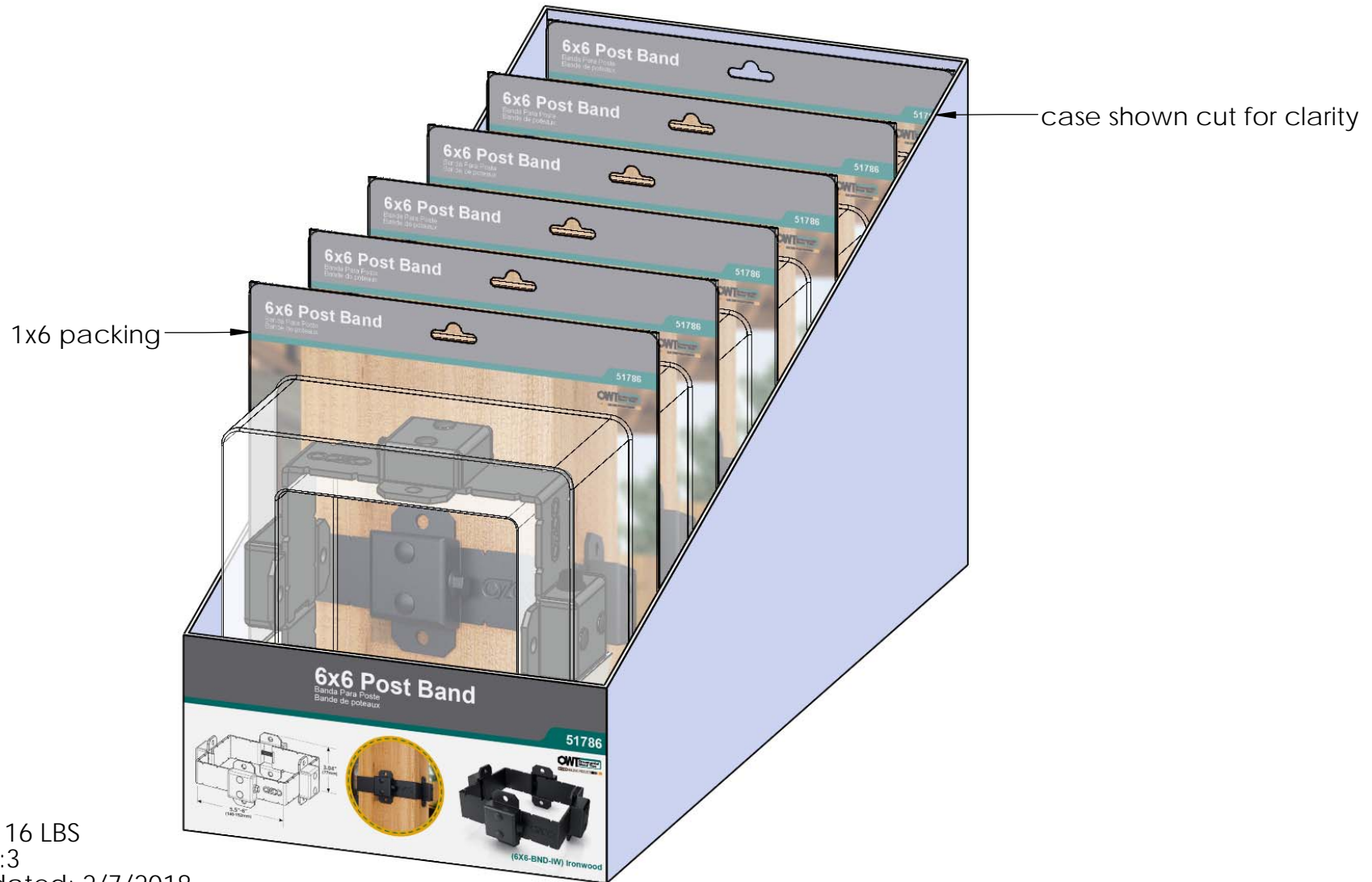

1x6 packing

case shown cut for clarity

Weight: 16 LBS
Scale: 1:3
Last updated: 2/7/2018

51786

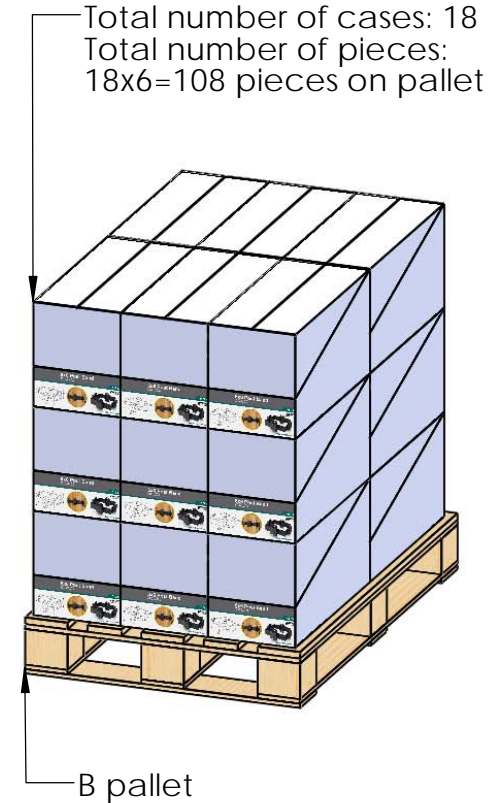
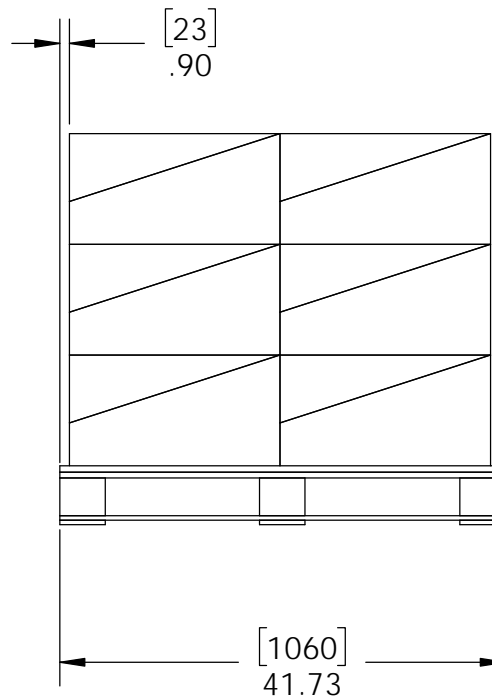
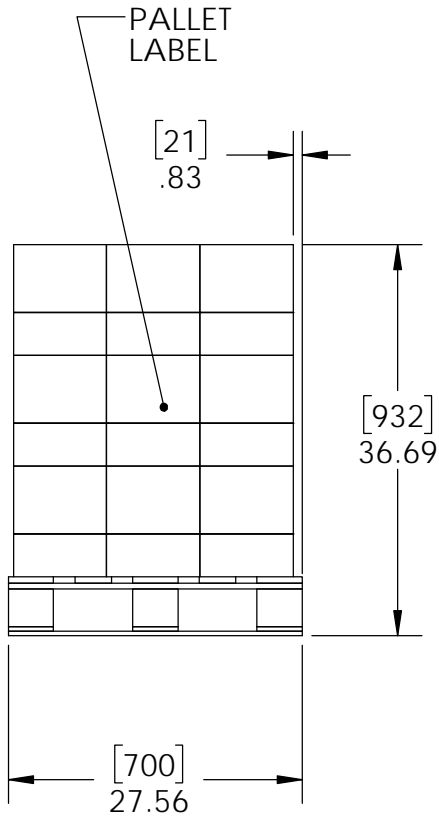

Weight: 406 LBS
 Scale: 1:18
 Last updated: 2/7/2018

additional pallet packing instructions

- plywood on top layer
- strap to pallet
- clear wrap around boxes

