

Product & Packaging Specs

8x8 Post Band (8X8-BND-IW)

Item #: 51787

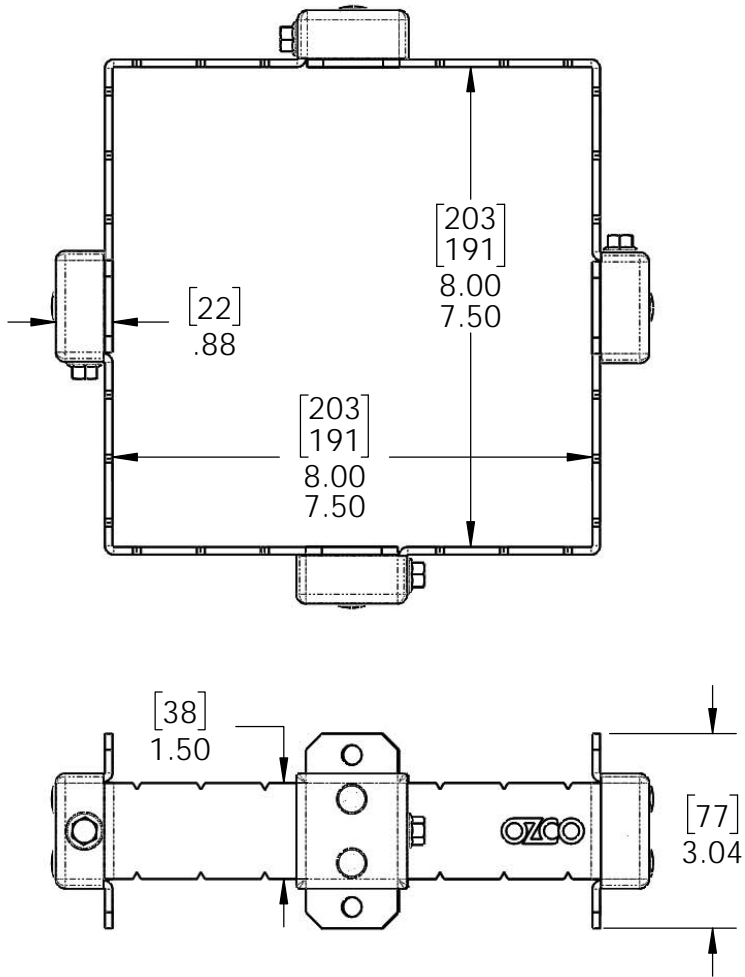

ITEM NO.	QTY.	PART NUMBER	DESCRIPTION
1	4	51787-11	Clamp, 8x8 Post Band IW
2	4	Screw	Screw, 1/4-20x1.50, Stainless Steel
3	8	9563K62	Plug, Metal Round for .25 hole

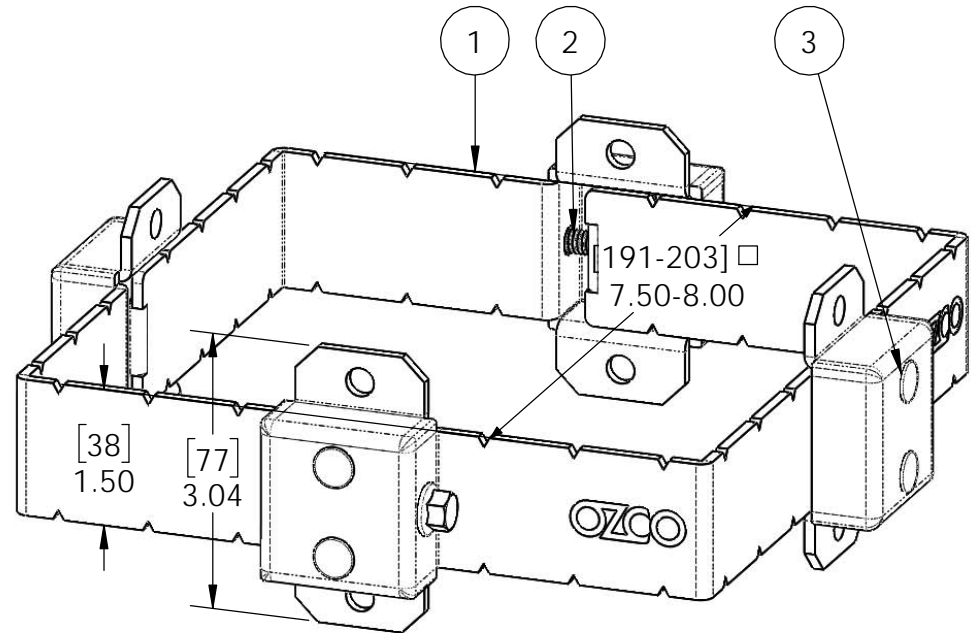

Weight: 21.04 LBS
 Scale: 1:3
 Last updated: 2/7/2018

51787

Product & Packaging Specs

8x8 Post Band (8X8-BND-IW)

Item #: Typical Installation 5.5"

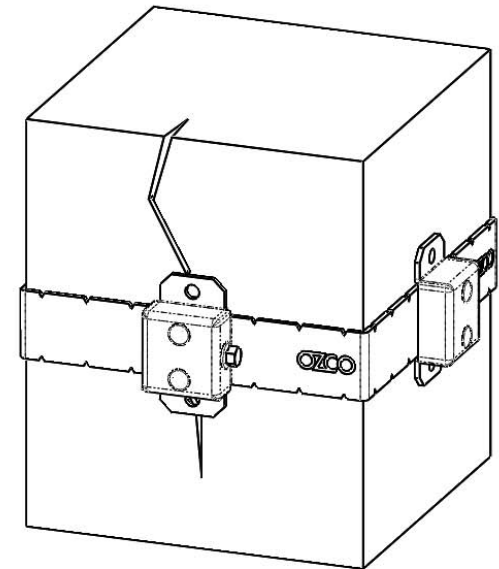
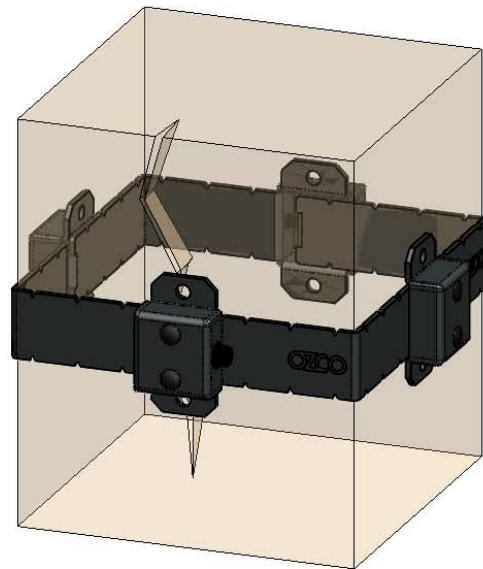
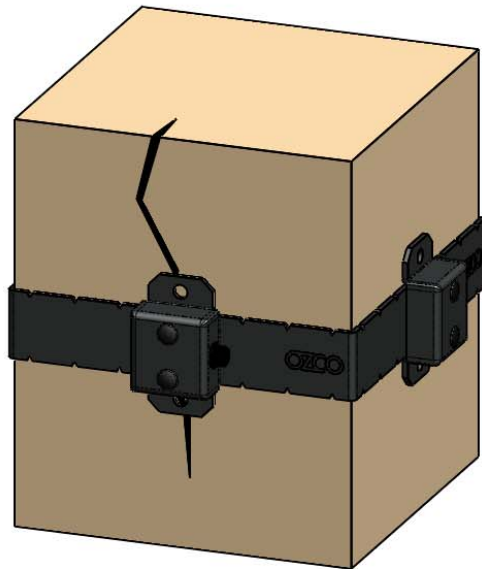

Weight: 21.04 LBS
Scale: 1:4
Last updated: 2/7/2018

51787

Product & Packaging Specs

8x8 Post Band (8X8-BND-IW)

Item #: Typical Installation 5.5"

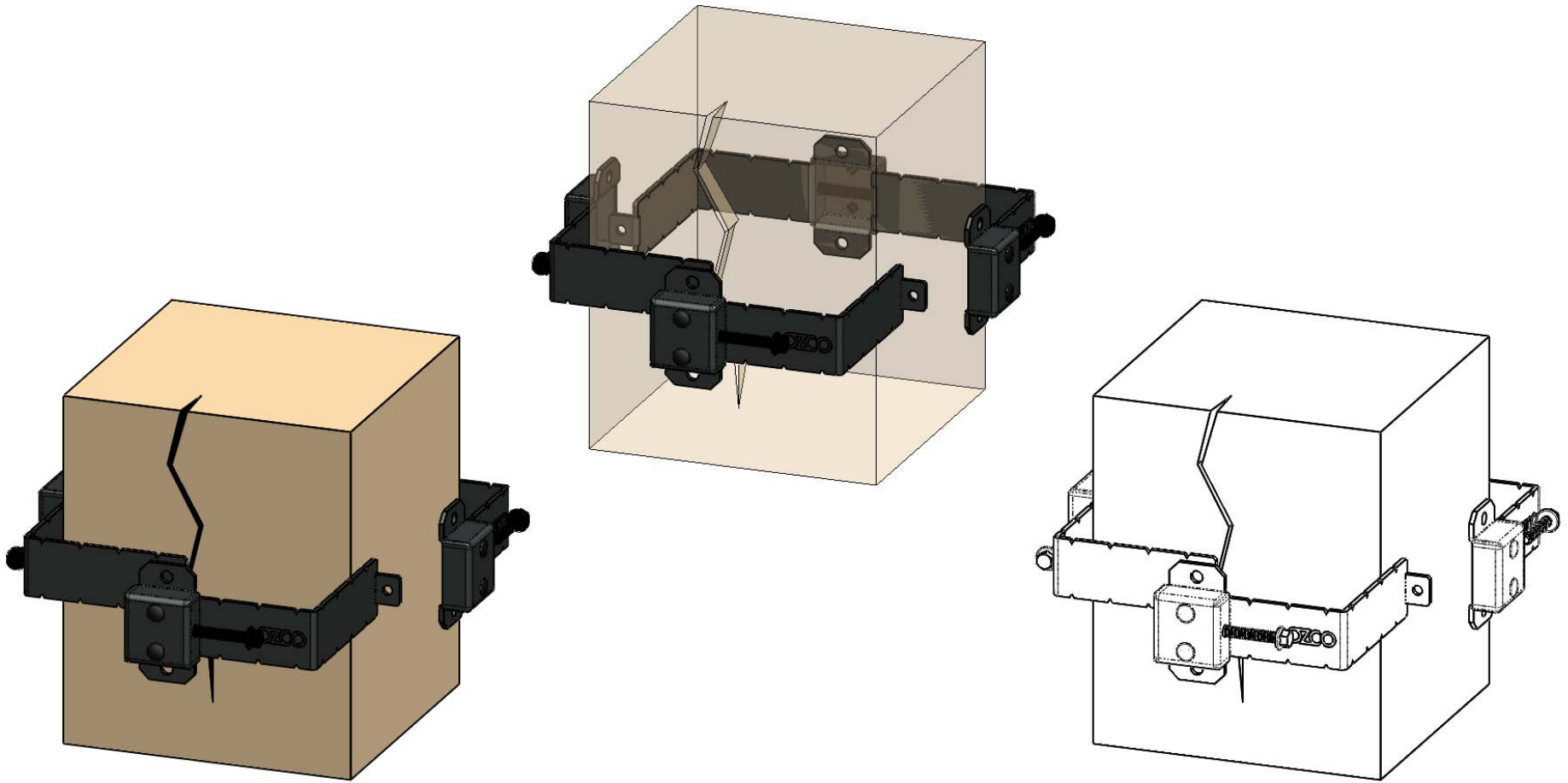

Weight: 21.04 LBS
Scale: 1:4
Last updated: 2/7/2018

51787

Product & Packaging Specs

8x8 Post Band (8X8-BND-IW)

Item #: Typical Installation

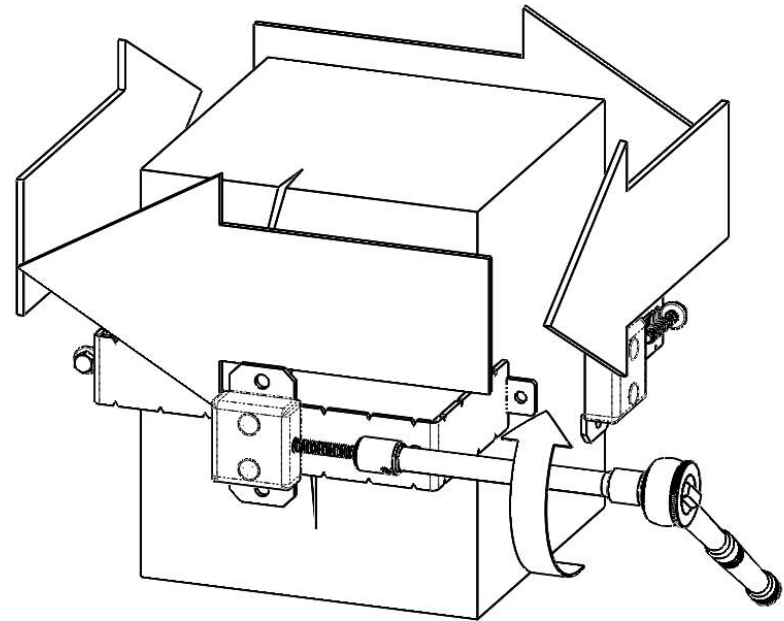
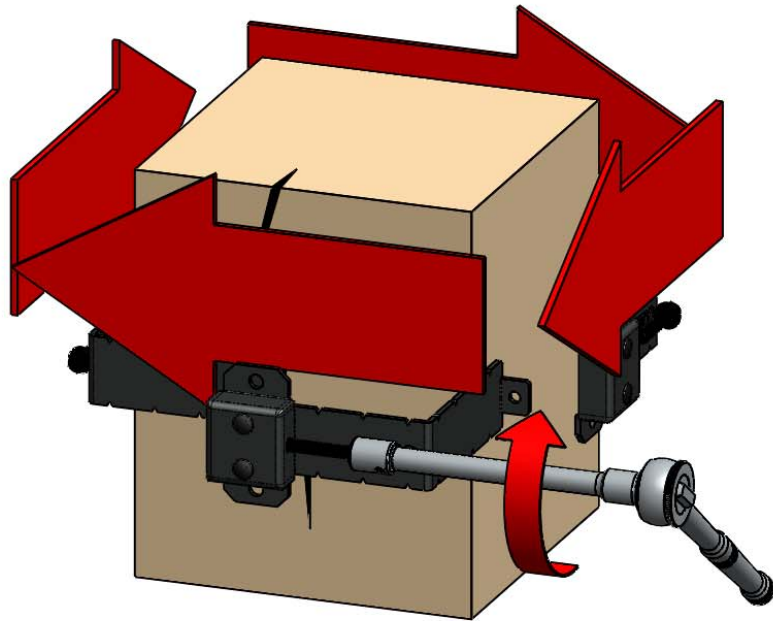

Weight: 21.04 LBS
Scale: 1:4
Last updated: 2/7/2018

51787



OZCO BUILDING PRODUCTS

Product & Packaging Specs

Box, 51787

Item #: Blister Pack

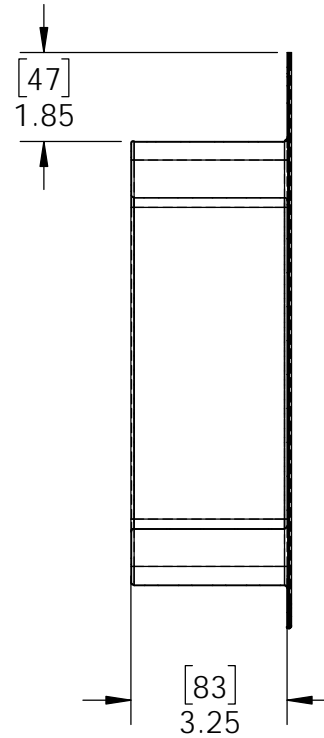
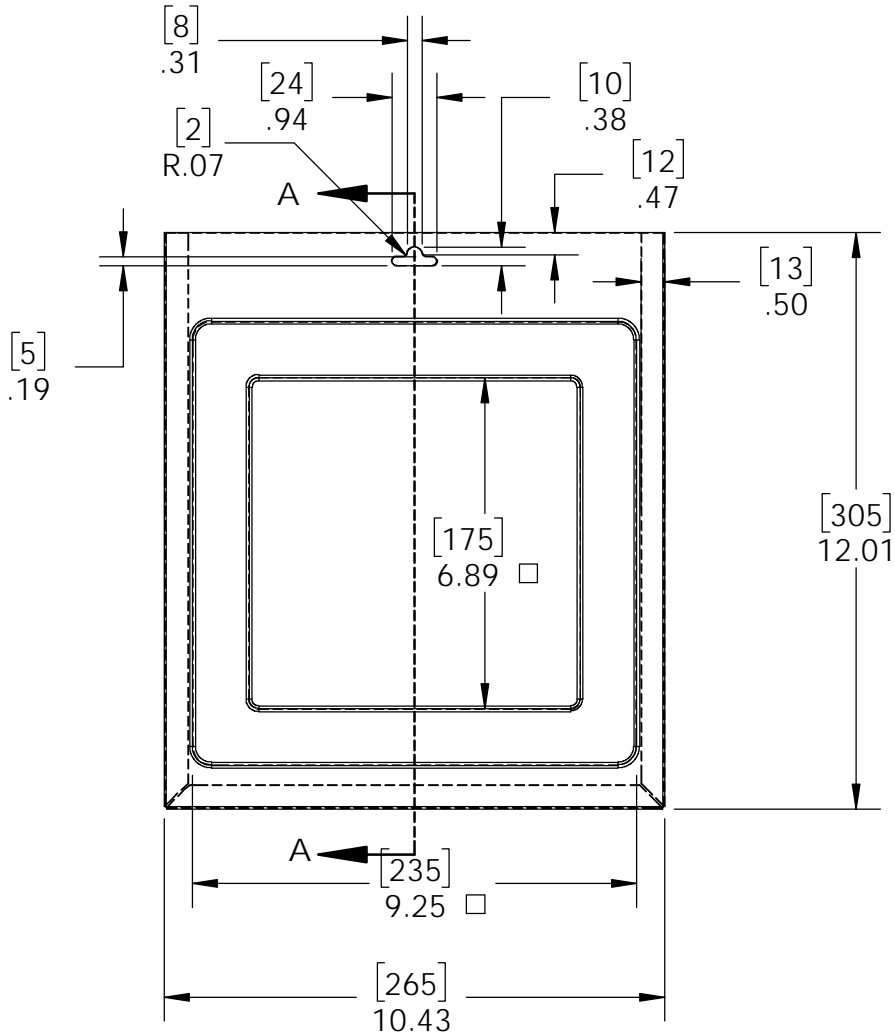

SECTION A-A

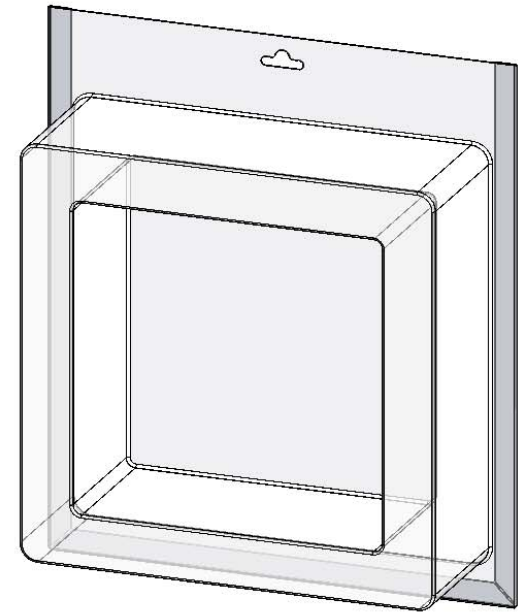

Material: ABS PC
Finish: -
Weight: 0.14 LBS
Scale: 1:4
Last updated: 2/7/2018

51787



OZCO BUILDING PRODUCTS

Product & Packaging Specs

Box, 51787

Item #: Backing

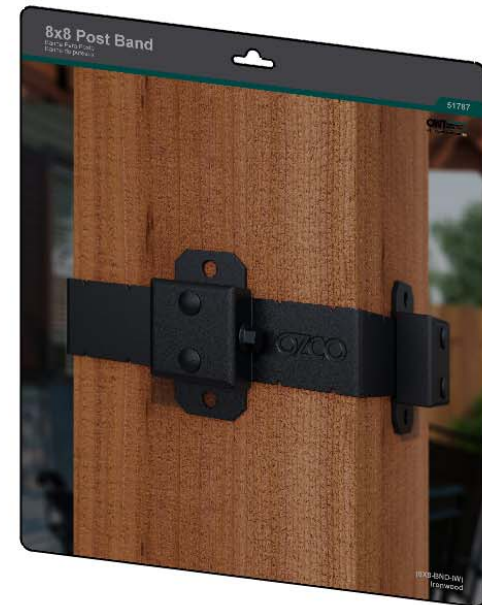
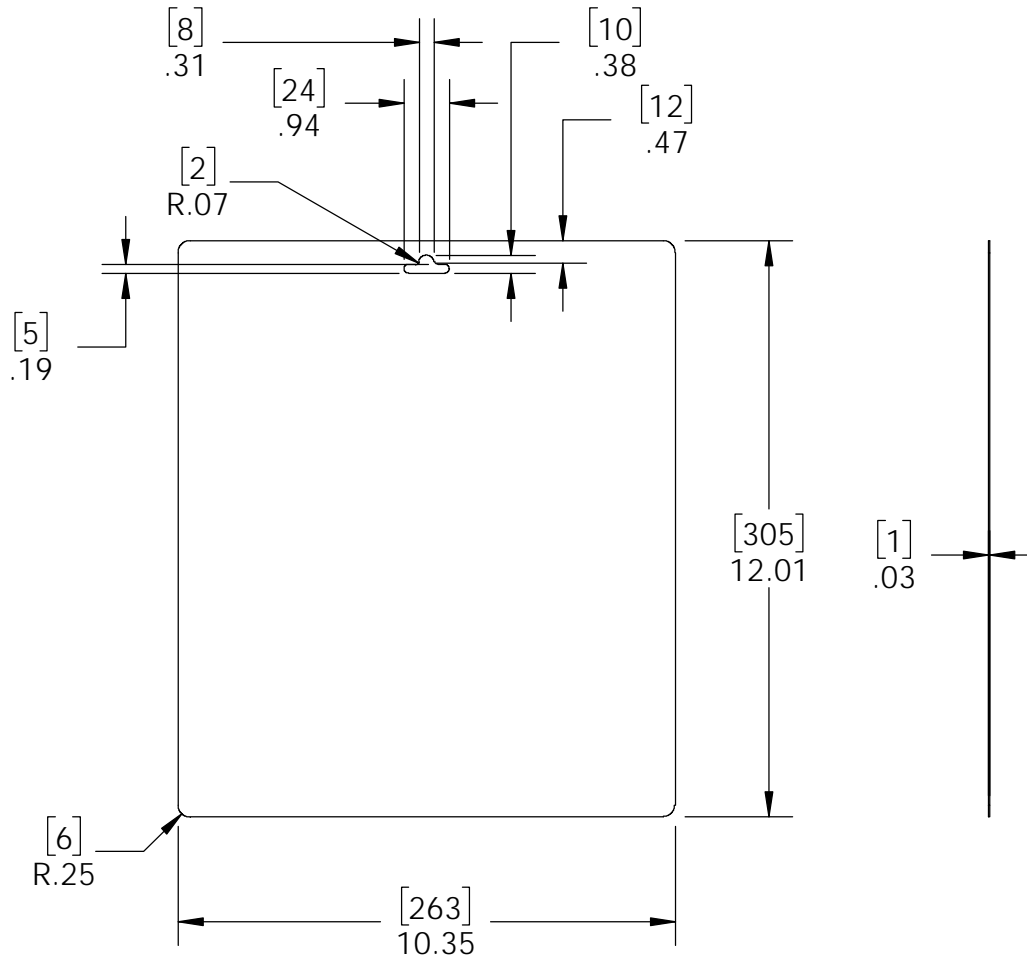

Material: Corrugated Paper
Finish: See Artwork
Weight: 0.02 LBS
Scale: 1:4
Last updated: 2/7/2018

51787



OZCO BUILDING PRODUCTS

Product & Packaging Specs

51787 Packing

Item #: Box packing

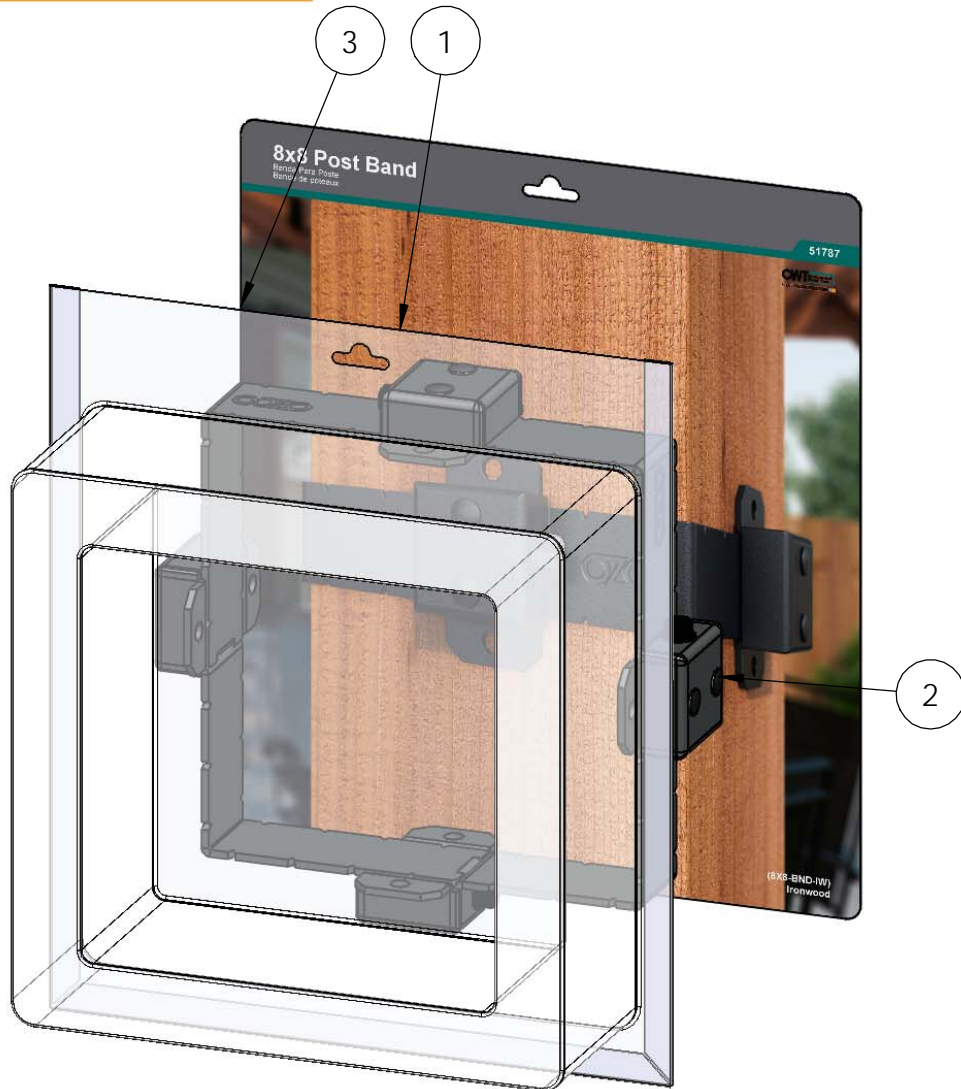

ITEM NO.	Box packing/ QTY.	PART NUMBER	DESCRIPTION
1	1	Box, 51787	Box, 51787
2	1	51787	8x8 Post Band (8X8-BND-IW)
3	1	Box, 51787	Box, 51787

Weight: 2.92 LBS
 Scale: 1:3
 Last updated: 2/7/2018

51787

Product & Packaging Specs

Case, 51787

Item #: Case

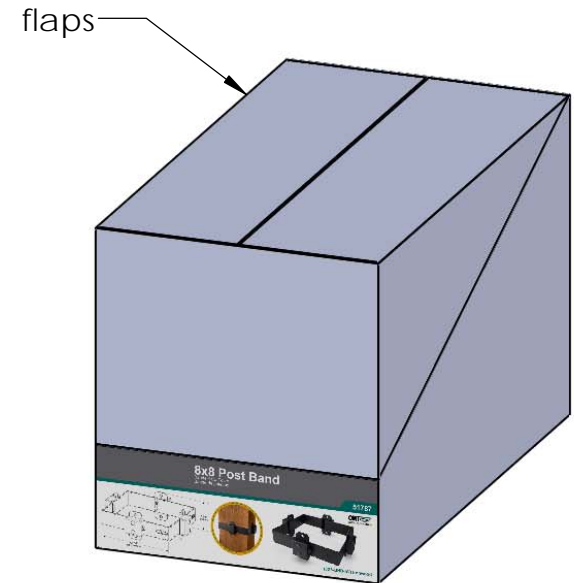
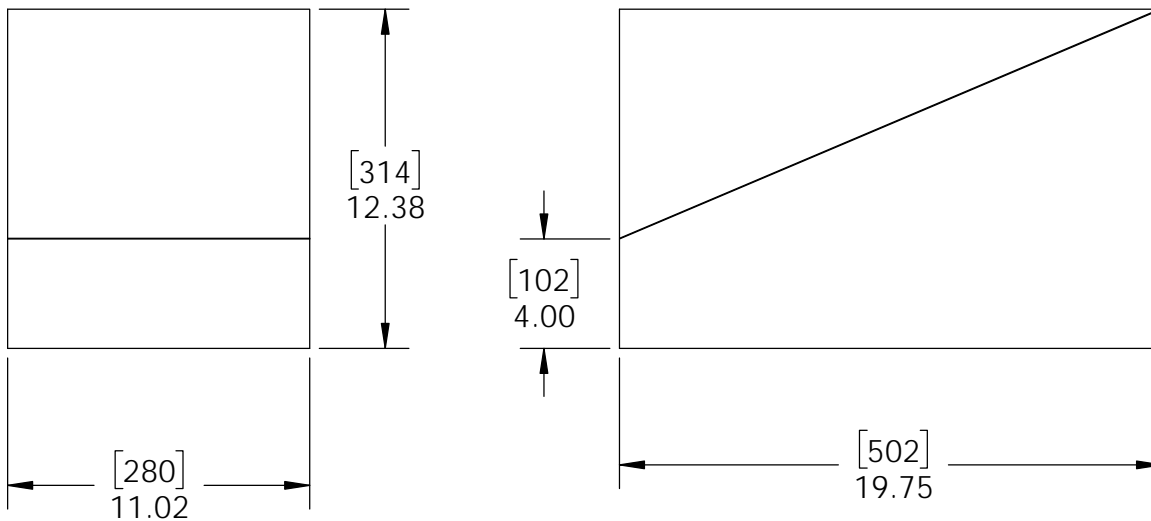

Material: Corrugated Paper
 Finish: See artwork
 Weight: 0.53 LBS
 Scale: 1:7
 Last updated: 2/7/2018

51787

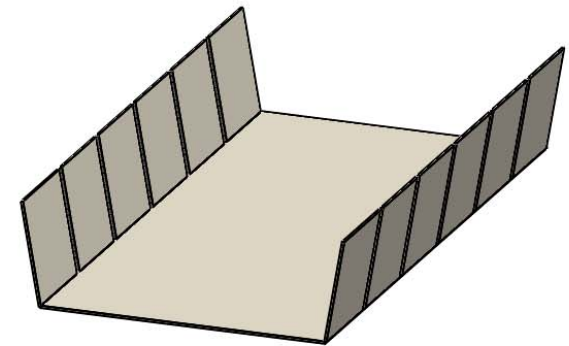
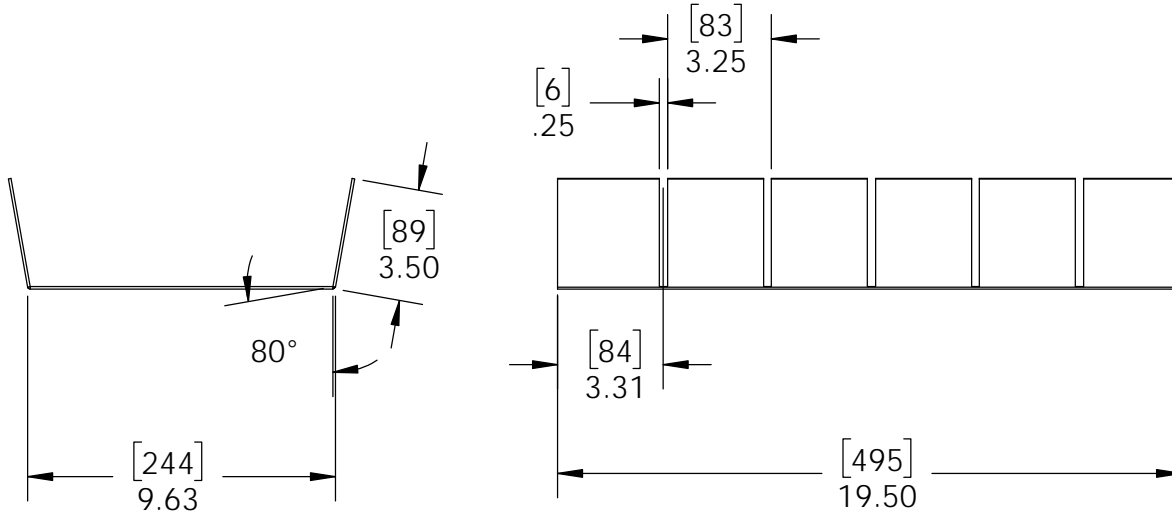

Material: Corrugated Paper
 Finish: -
 Weight: 0.14 LBS
 Scale: 1:6
 Last updated: 2/7/2018

51787

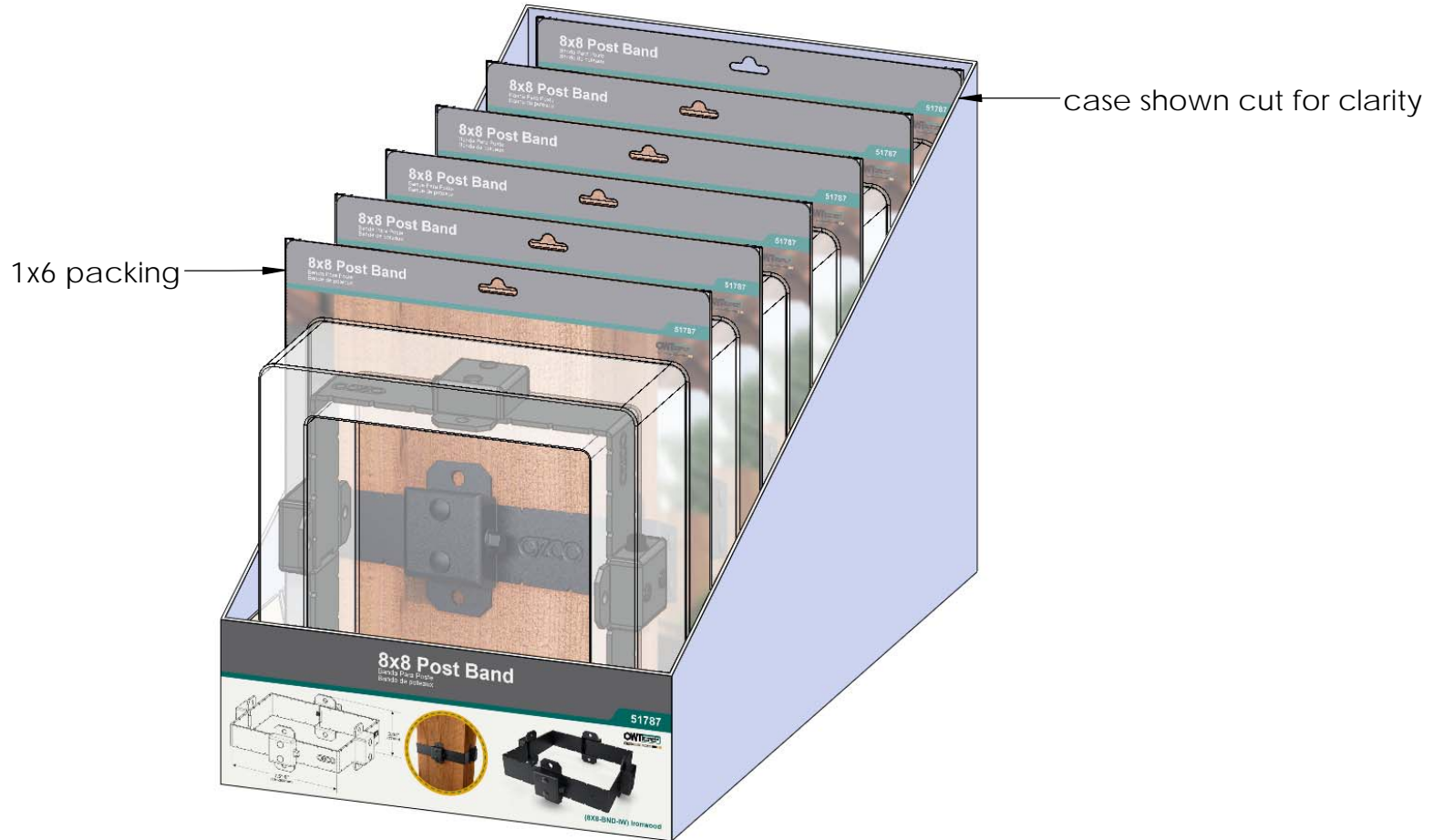

Weight: 19 LBS
Scale: 1:4
Last updated: 2/7/2018

51787

Product & Packaging Specs

51787 Packing

Item #: Pallet packing

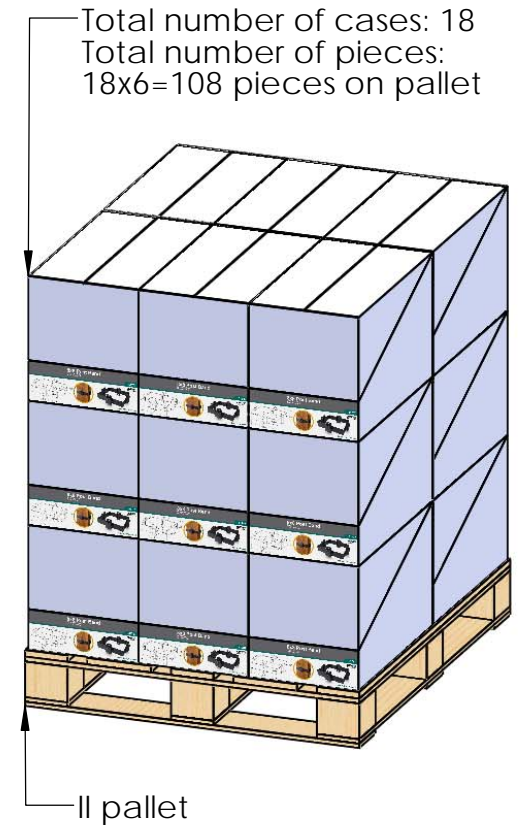
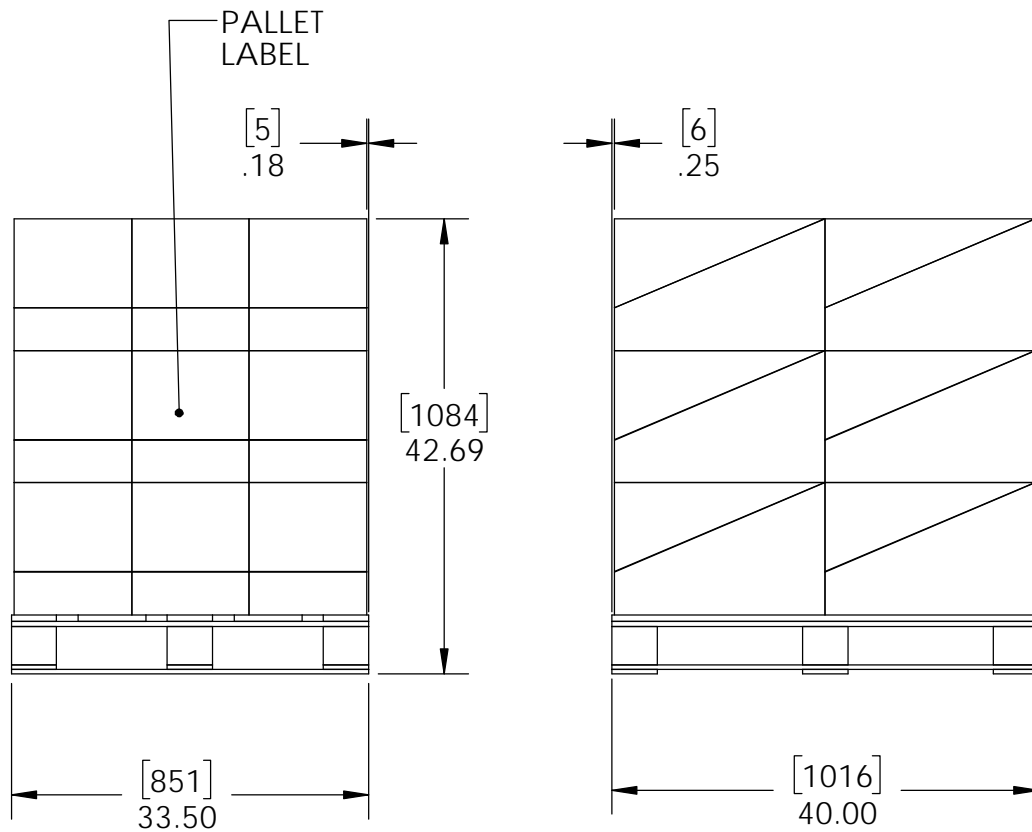

Weight: 368 LBS
 Scale: 1:18
 Last updated: 2/7/2018

additional pallet packing instructions

- plywood on top layer
- strap to pallet
- clear wrap around boxes

