

Product & Packaging Specs

OWT Hardware Accessory - Plant Hanger (HA-PH)

Item #: 57704

ITEM NO.	QTY.	PART NUMBER	DESCRIPTION
1	1	57704	OWT Hardware Accessory - Plant Hanger
2	2	Screw	Screw, .25-20 x .375 Torx Black with Locking Patch

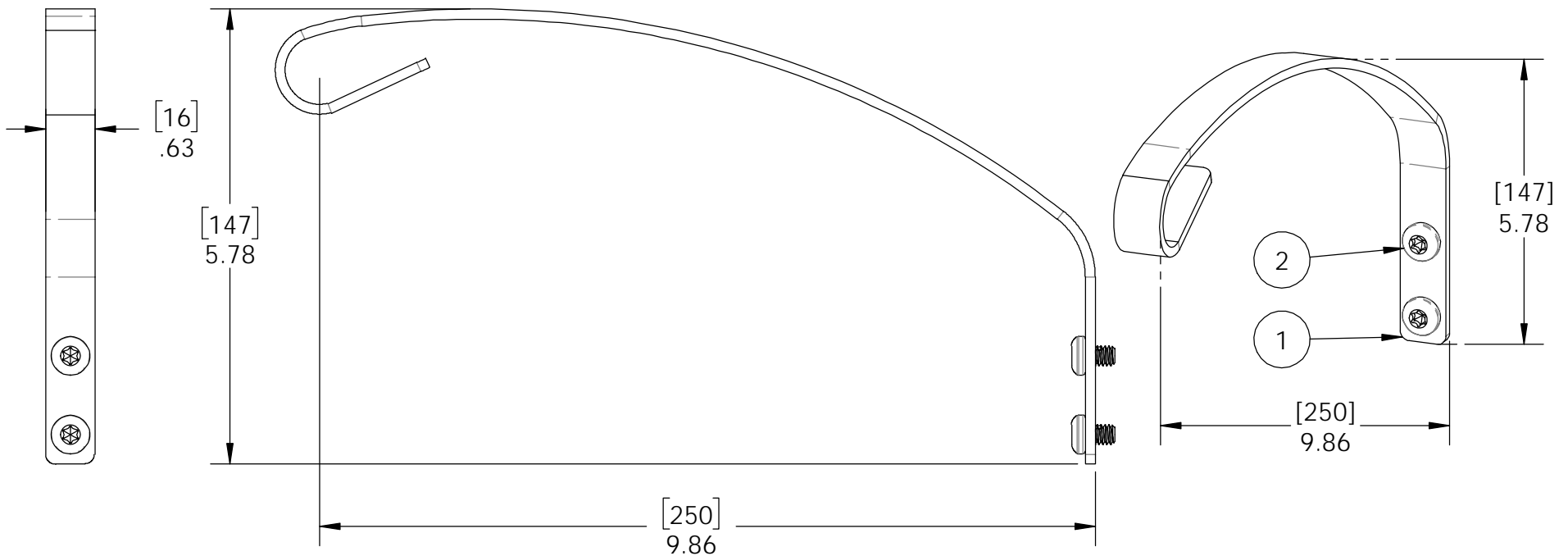

Weight: 12.56 LBS

Scale: 1:2

Last updated: 2/7/2018

57704

Product & Packaging Specs

OWT Hardware Accessory - Plant Hanger (HA-PH)

Item #: 57704

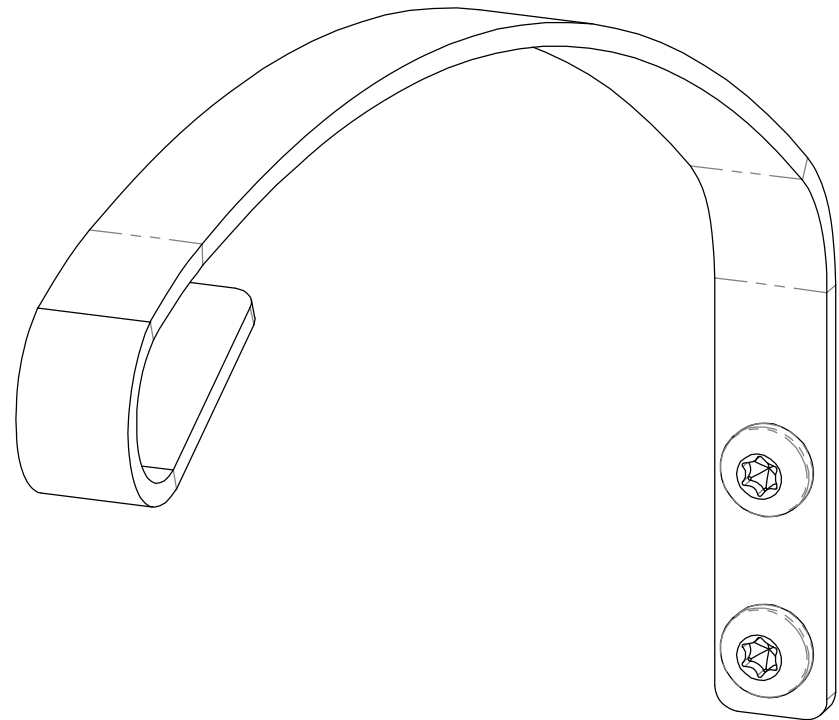

Weight: 12.56 LBS
Scale: 1:1
Last updated: 2/7/2018

57704



OZCO BUILDING PRODUCTS

Product & Packaging Specs

OWT Hardware Accessory - Plant Hanger (HA-PH)

Item #: 57704

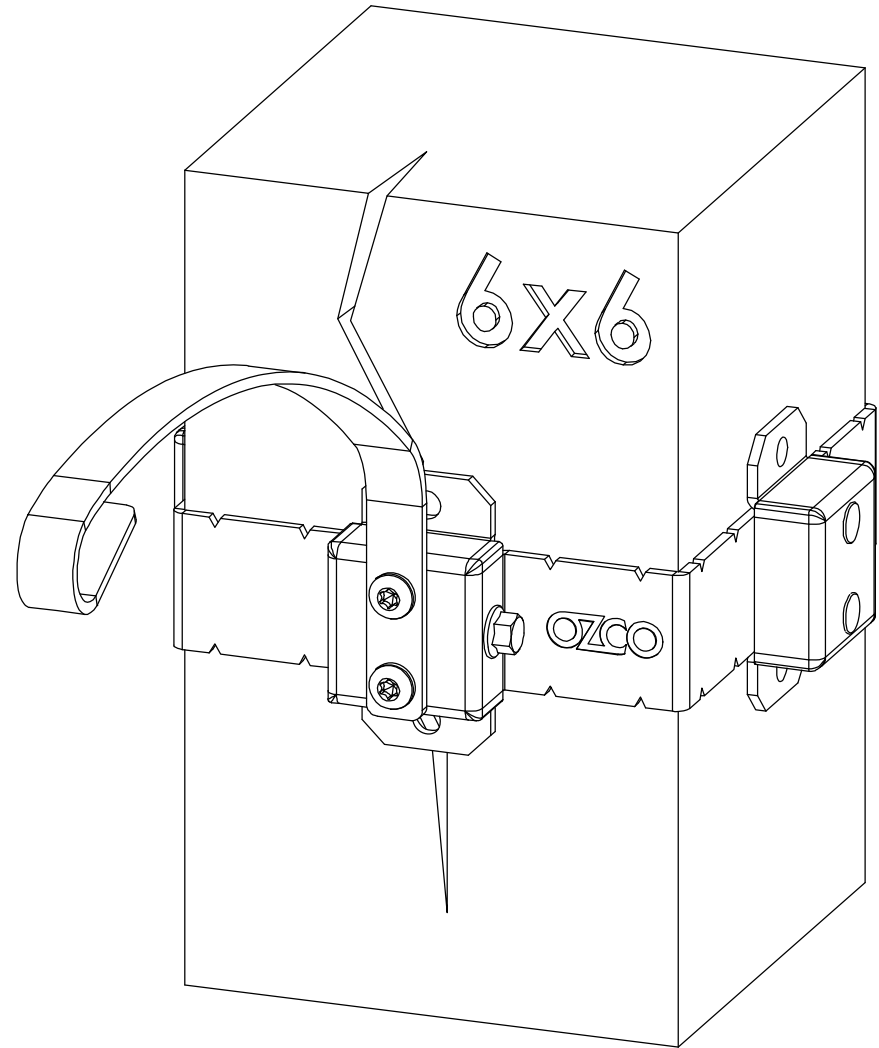

Weight: 12.56 LBS
Scale: 1:2
Last updated: 2/7/2018

shown installed on 6x6 Post Band (51786); 4x4 & 8x8 Post Bands available

57704

V2.00 - Installation Instructions, Specifications and Project Plans are effective 2/7/2018 . This information is updated periodically and should not be relied upon after 2 years from 2/7/2018 . Please visit OZCOBP.com to get current information. 3



OZCO BUILDING PRODUCTS

Product & Packaging Specs

Box, 57704
Item #: Blister Pack

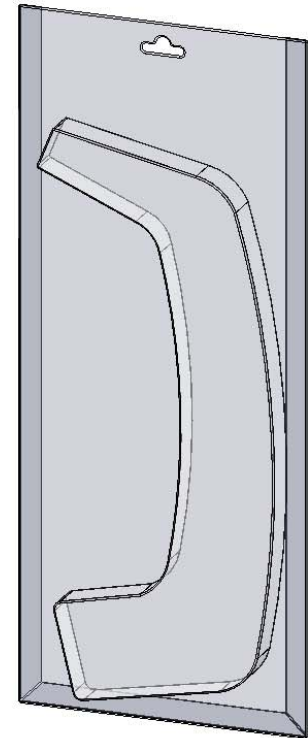
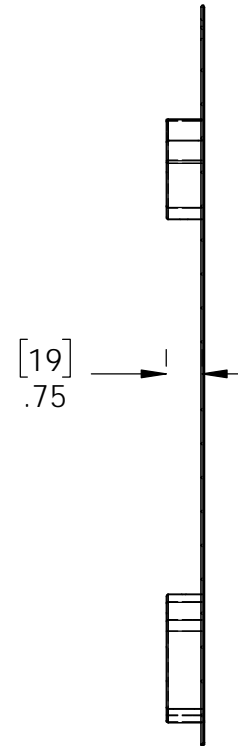
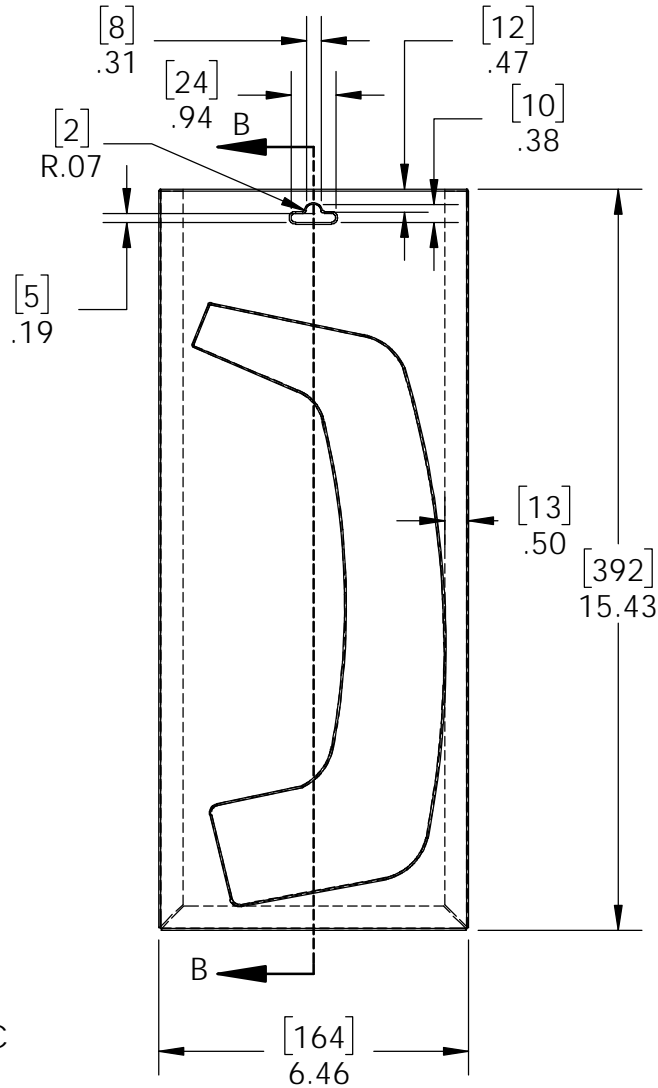

Material: ABS PC
Finish: -
Weight: 71.83 LBS
Scale: 1:4
Last updated: 2/7/2018

57704



OZCO BUILDING PRODUCTS

Product & Packaging Specs

Box, 57704

Item #: Backing

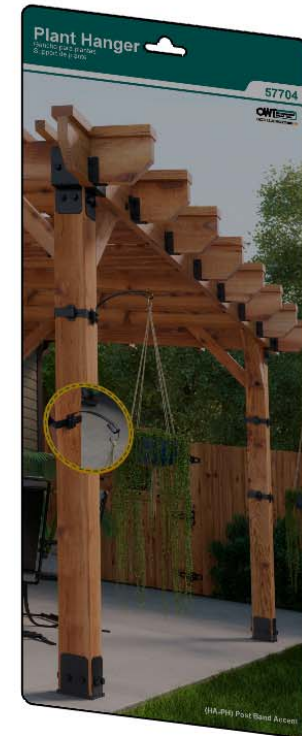
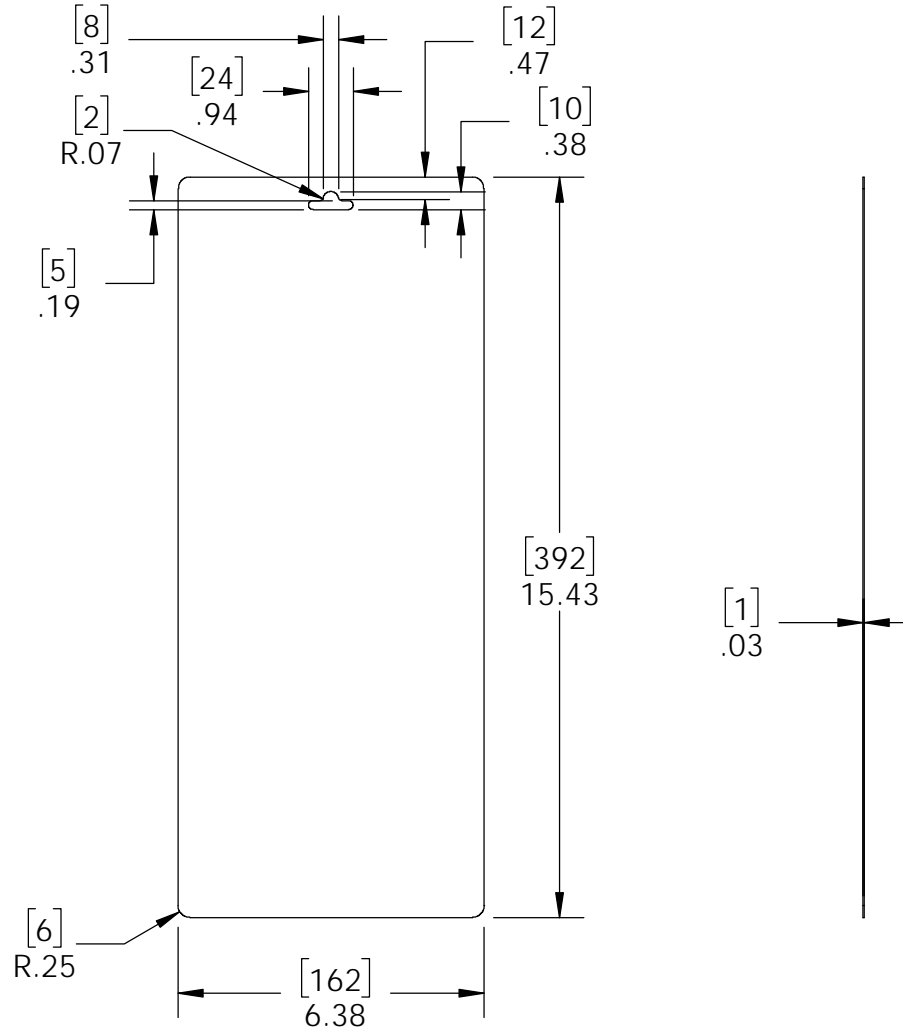

Material: Corrugated Paper
 Finish: See Artwork
 Weight: 6.27 LBS
 Scale: 1:4
 Last updated: 2/7/2018

57704



OZCO BUILDING PRODUCTS

Product & Packaging Specs

57704 Packing

Item #: Box packing

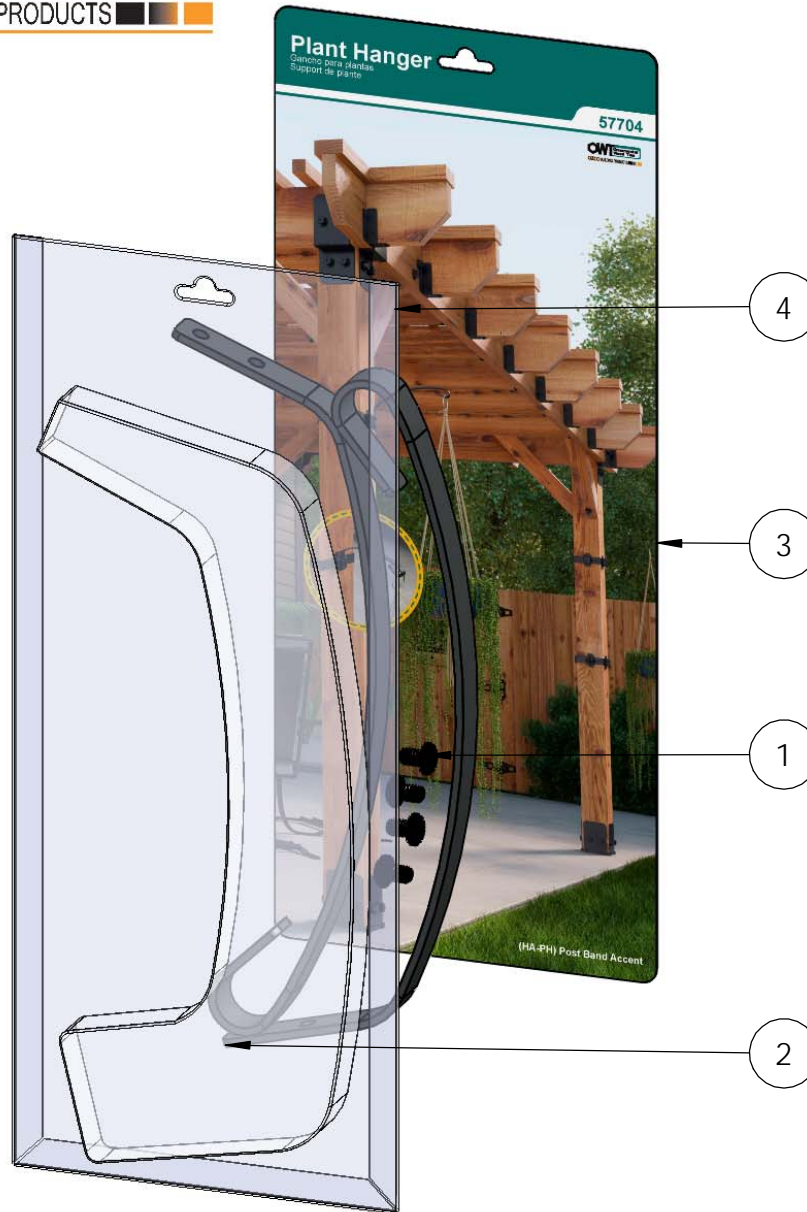

ITEM NO.	Box packing/ QTY.	PART NUMBER	DESCRIPTION
1	4	Screw	Screw, .25-20 x .375 Torx Black with Locking Patch
2	2	57704	OWT Hardware Accessory - Plant Hanger
3	1	Box, 57704	Box, 57704
4	1	Box, 57704	Box, 57704

Weight: .8 LBS
 Scale: 1:3
 Last updated: 2/7/2018

57704

Product & Packaging Specs

Case, 57704

Item #: Case

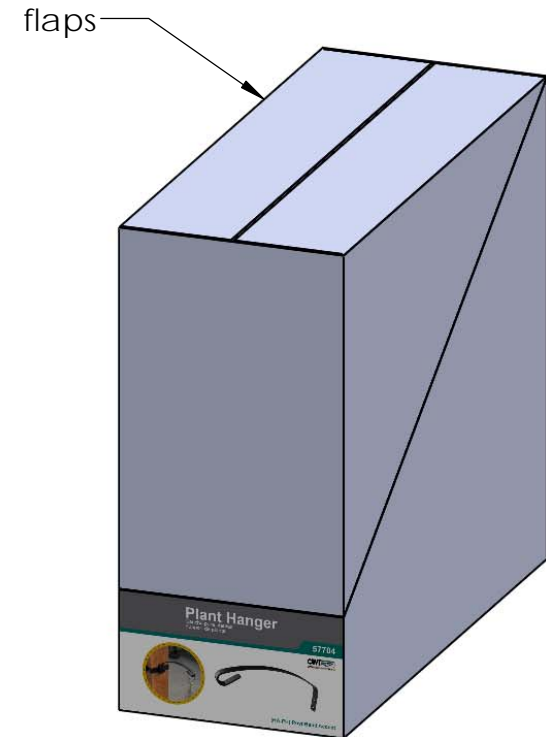
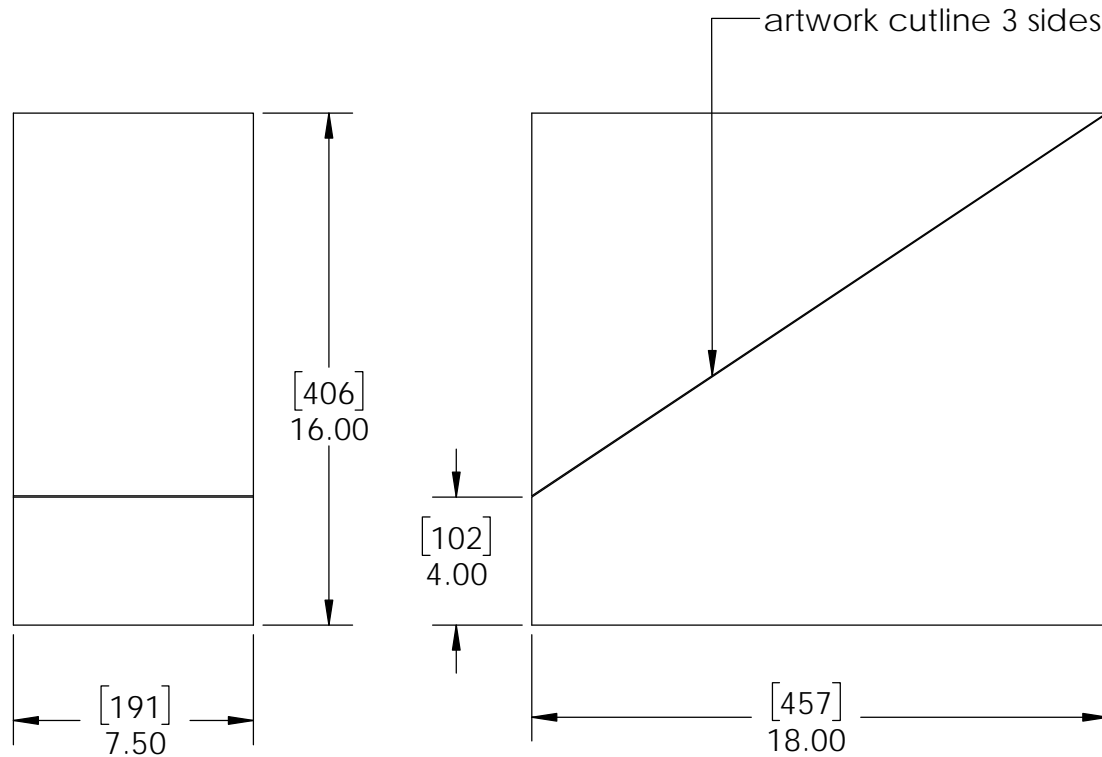

Material: Corrugated Paper
 Finish: See Artwork
 Weight: 130.43 LBS
 Scale: 1:6
 Last updated: 2/7/2018

57704

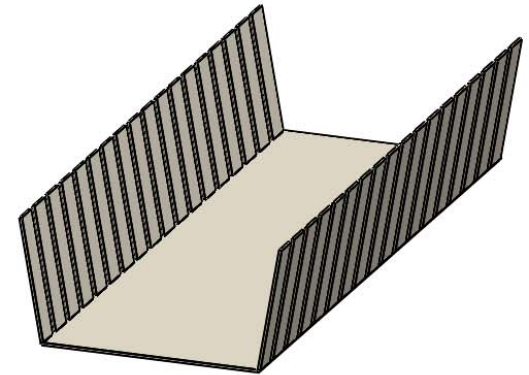
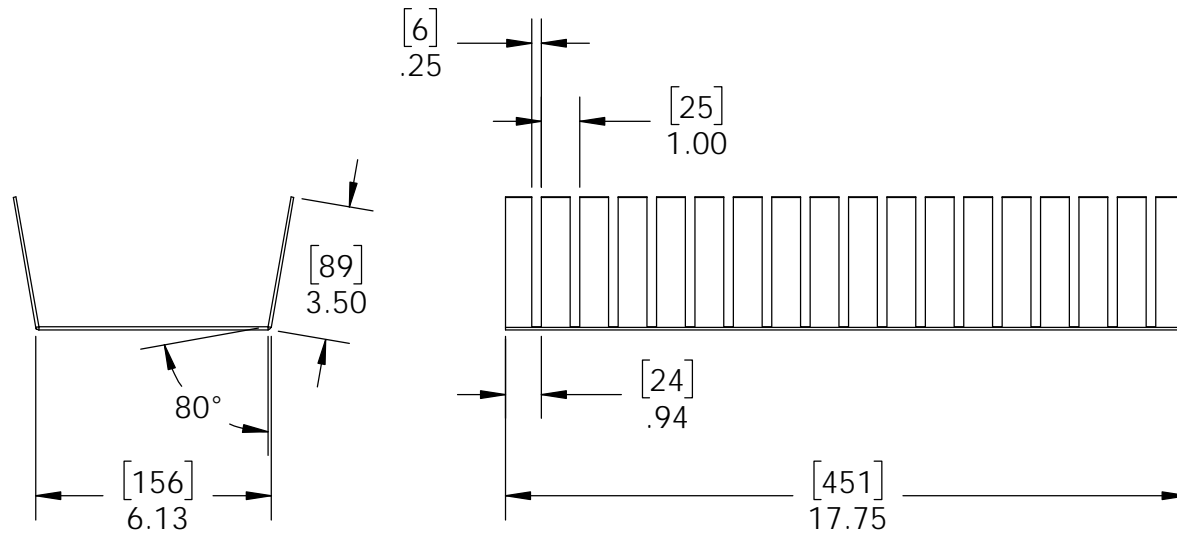

Material: Corrugated Paper
 Finish: -
 Weight: 0.09 LBS
 Scale: 1:5
 Last updated: 2/7/2018

57704

Product & Packaging Specs

57704 Packing

Item #: Case packing

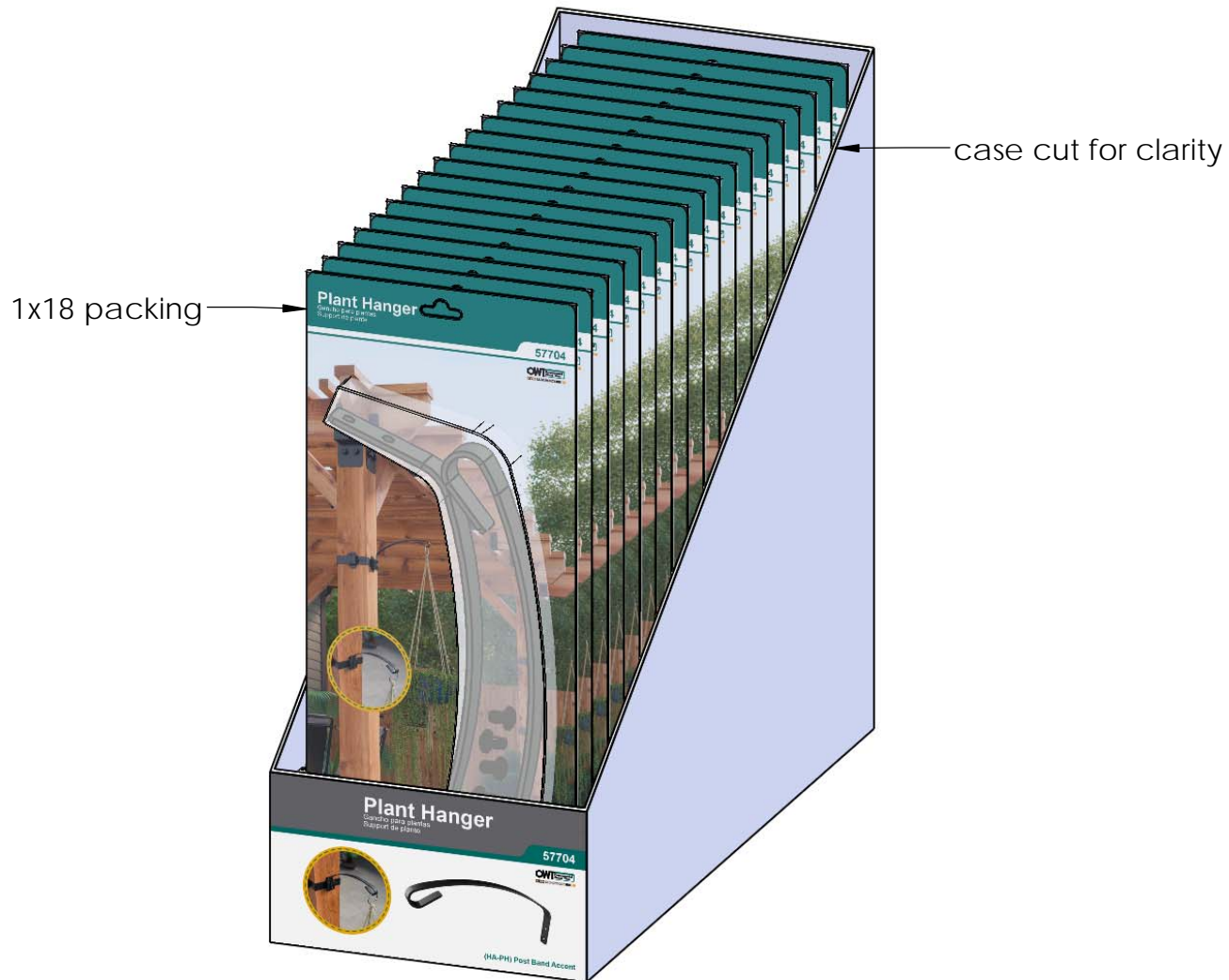

Weight: 20 LBS
Scale: 1:4
Last updated: 2/7/2018

57704

Product & Packaging Specs

57704 Packing

Item #: Pallet packing

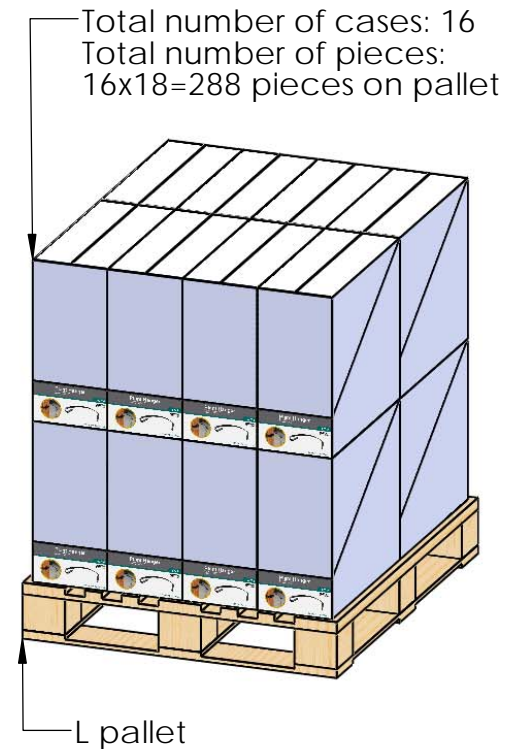
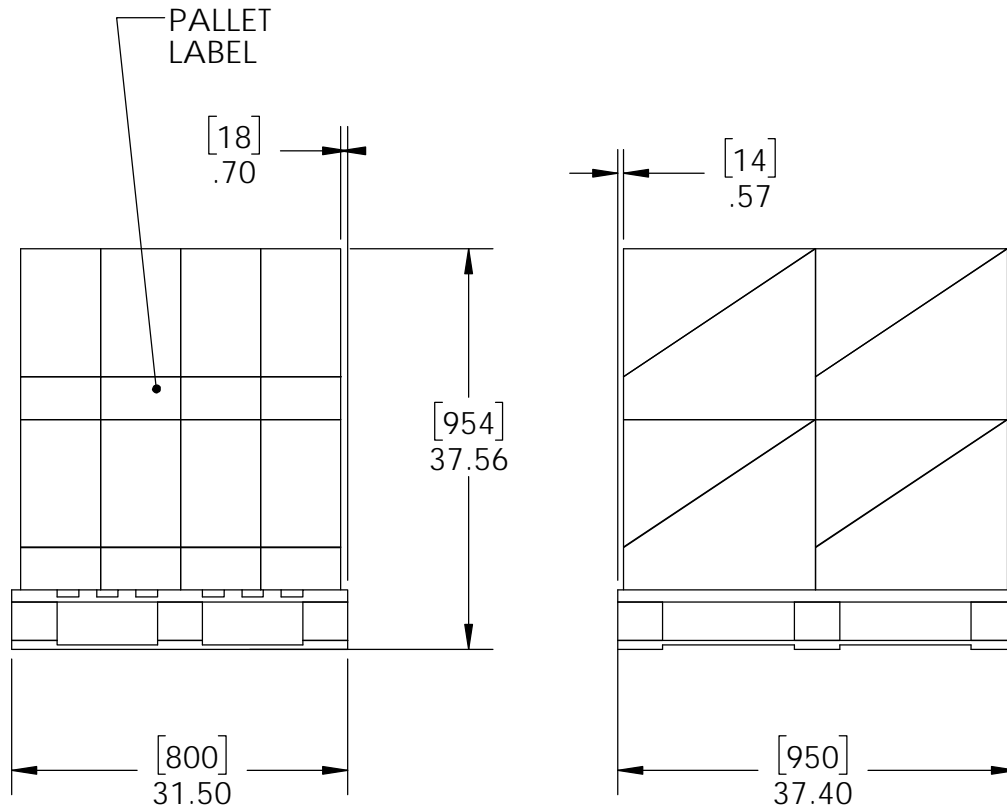

Weight: 344 LBS
 Scale: 1:18
 Last updated: 2/7/2018

57704

additional pallet packing instructions

- plywood on top layer
- strap to pallet
- clear wrap around boxes

