



OZCO BUILDING PRODUCTS

Product & Packaging Specs

6-8" Joist Hanger Tab (JHT-68-IW)

Item #: 51740

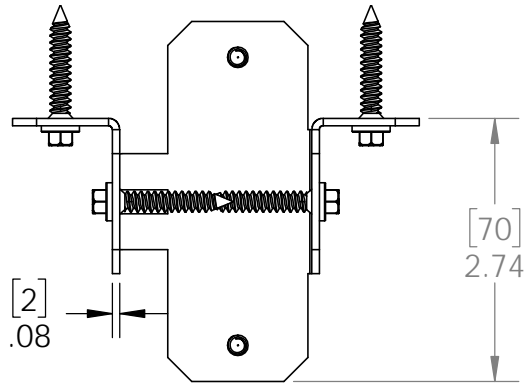

This Package Includes



- Requires a 1/4" hex driver bit
- Exclusive high friction design
- No pre-drilling required

ITEM NO.	QTY.	PART NUMBER	DESCRIPTION
1	10	80060	Screw, 1-1/2"x1/4" Black Hex-Head (1-1/2-HX-SCR)
2	1	51740-12	Bracket, 6-8" Joist Hanger
3	1	51740-11	Bracket, 6-8" Joist Hanger Tab

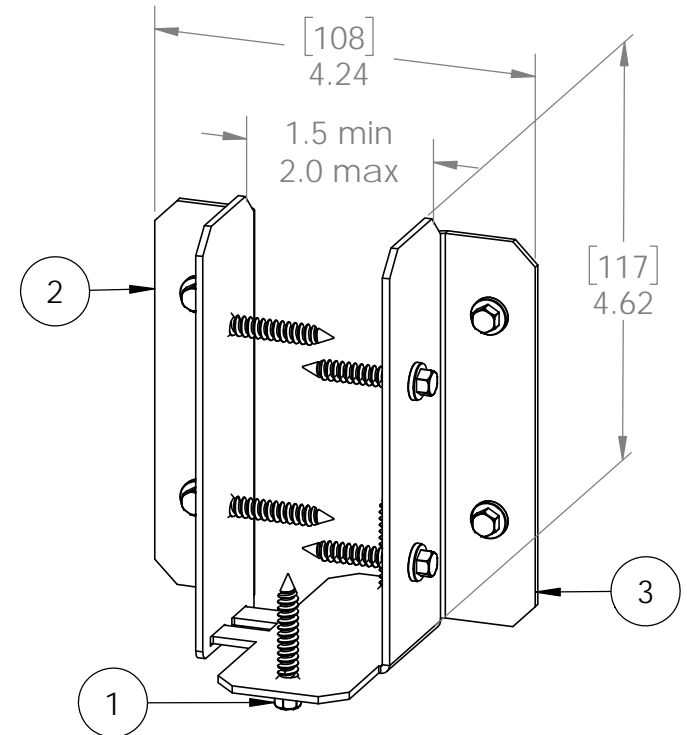
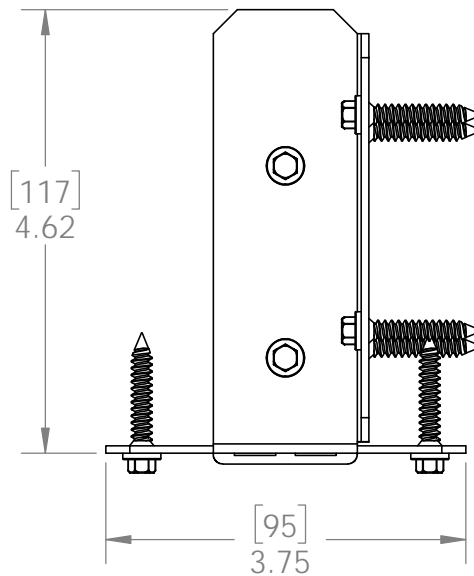
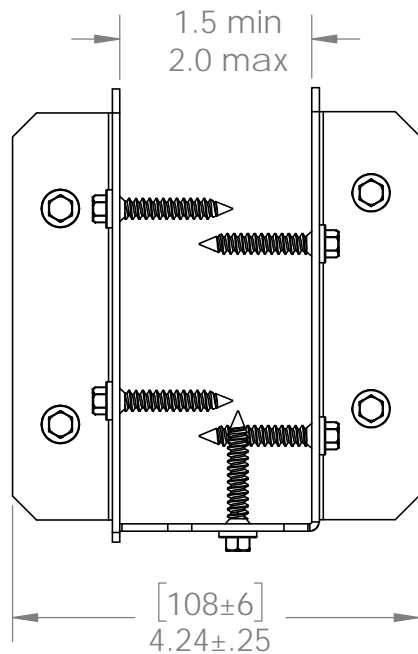

Weight: 0.64 LBS
 Scale: 1:2
 Last updated: 10/10/2016

51740

Product & Packaging Specs

6-8" Joist Hanger Tab (JHT-68-IW)

Item #: 51740

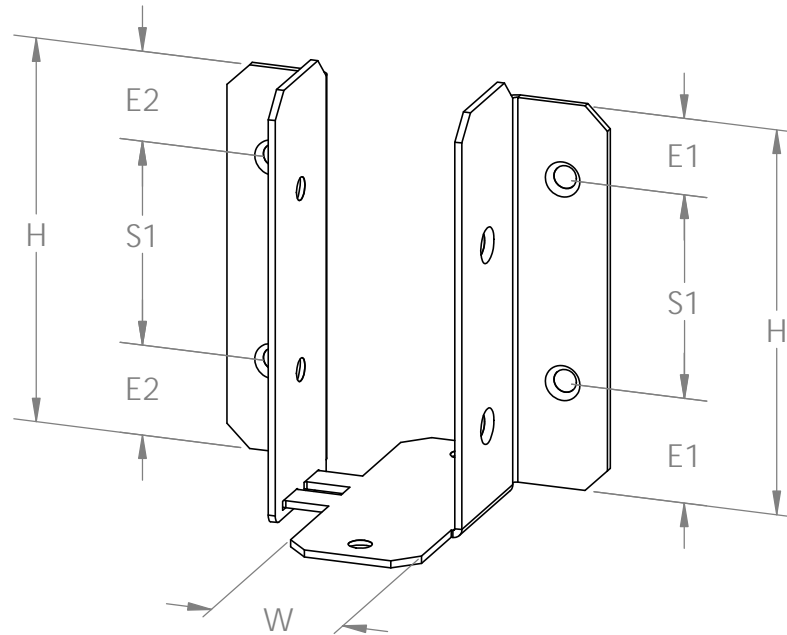

Weight: 0.64 LBS
Scale: 1:2
Last updated: 10/10/2016

51740

Product & Packaging Specs

6-8" Joist Hanger Tab (JHT-68-IW)

Item #: 51740

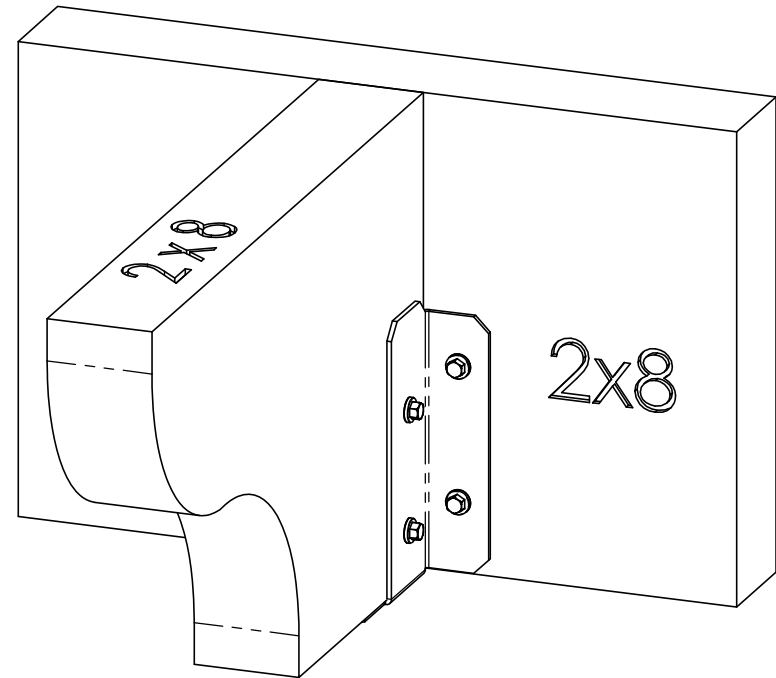
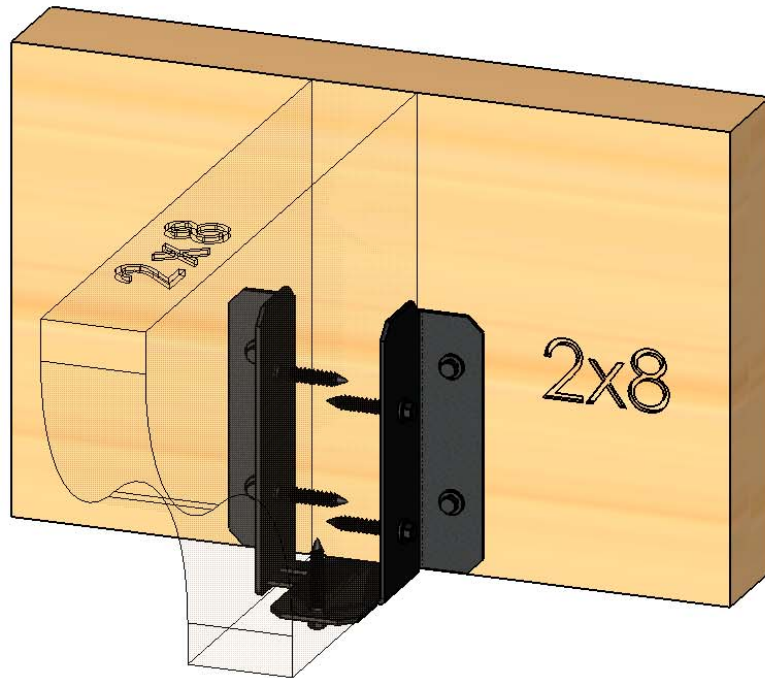

Weight: 0.64 LBS
Scale: 1:3
Last updated: 10/10/2016

51740

Product & Packaging Specs

6-8" Joist Hanger Tab (JHT-68-IW)

Item #: 51740

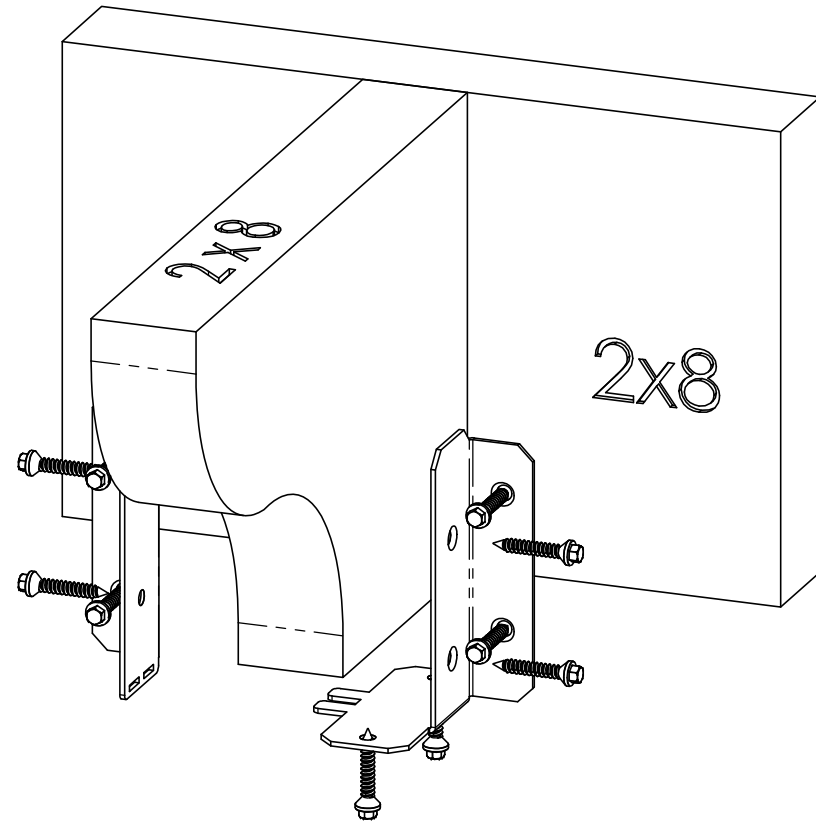
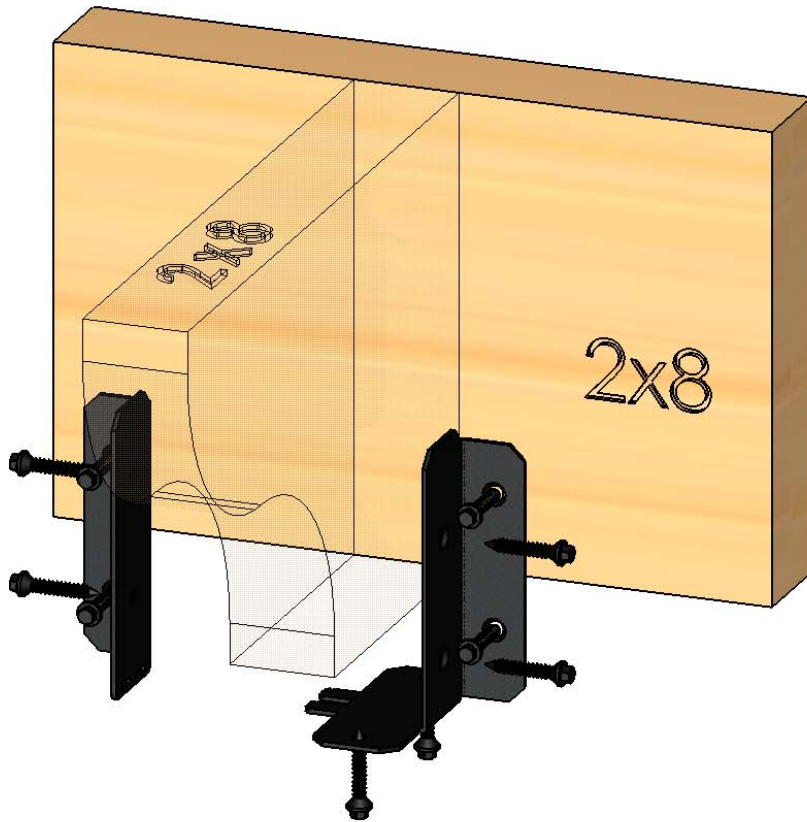

Weight: 0.64 LBS
Scale: 1:3
Last updated: 10/10/2016

51740



OZCO BUILDING PRODUCTS

This Package Includes



- Requires a 1/4" hex driver bit
- Exclusive high friction design
- No pre-drilling required

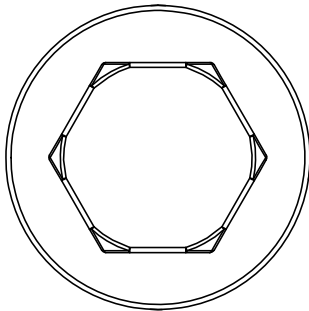

Product & Packaging Specs

Screw, 1-1/2"x1/4"

Black Hex-Head (1-1/2-HX-SCR)

Item #: 80060

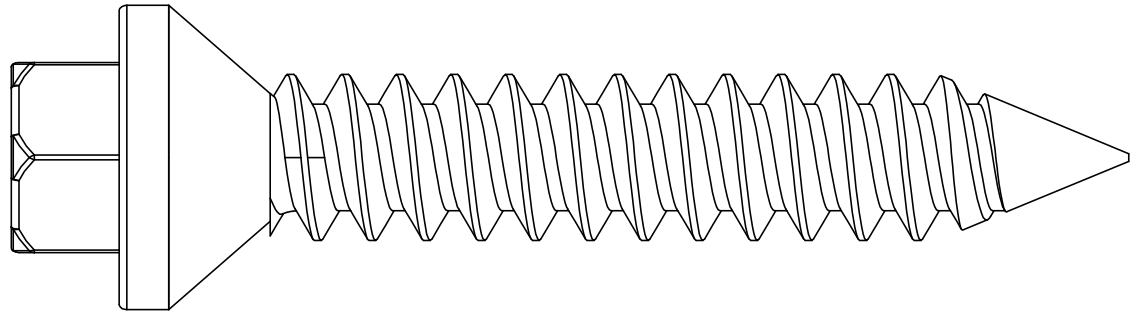
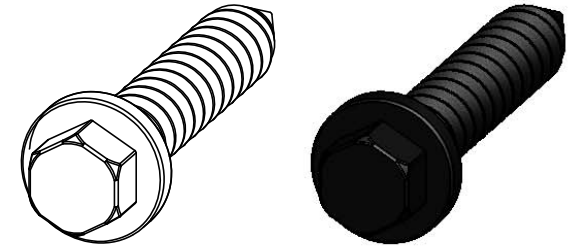

Material: Plain Carbon Steel
Finish: Black Zinc
Weight: 0.01 LBS
Scale: 4:1
Last updated: 10/10/2016

51740

for additional details, see drawing #80060

V2.00 - Installation Instructions, Specifications and Project Plans are effective 10/10/2016 . This information is updated periodically 7 and should not be relied upon after 2 years from 10/10/2016 . Please visit OZCOBP.com to get current information.

Product & Packaging Specs

51740 Packing

Item #: Box Packing

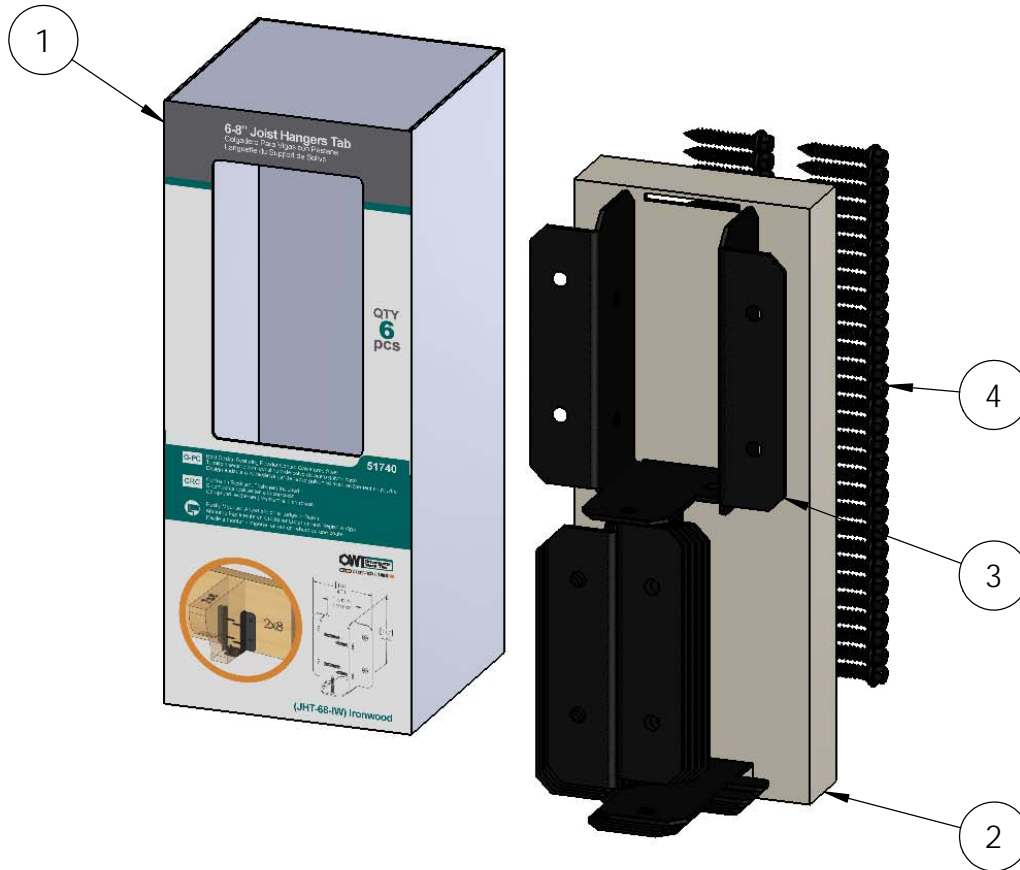

ITEM NO.	QTY.	PART NUMBER	DESCRIPTION
1	1	56639 Box Insert	56639 Box Insert
2	6	51740	6-8" Joist Hanger Tab (JHT-68-IW)
3	1	Box, 51740	Box, 51740
4	60	80060	Screw, 1-1/2"x1/4" Black Hex-Head (1-1/2-HX-SCR)

Screws placed inside a small plastic bag and placed inside each box

Weight: 7.19 LBS
Scale: 1:4
Last updated: 10/10/2016

51740

Product & Packaging Specs

51740 Packing

Item #: Case Packing

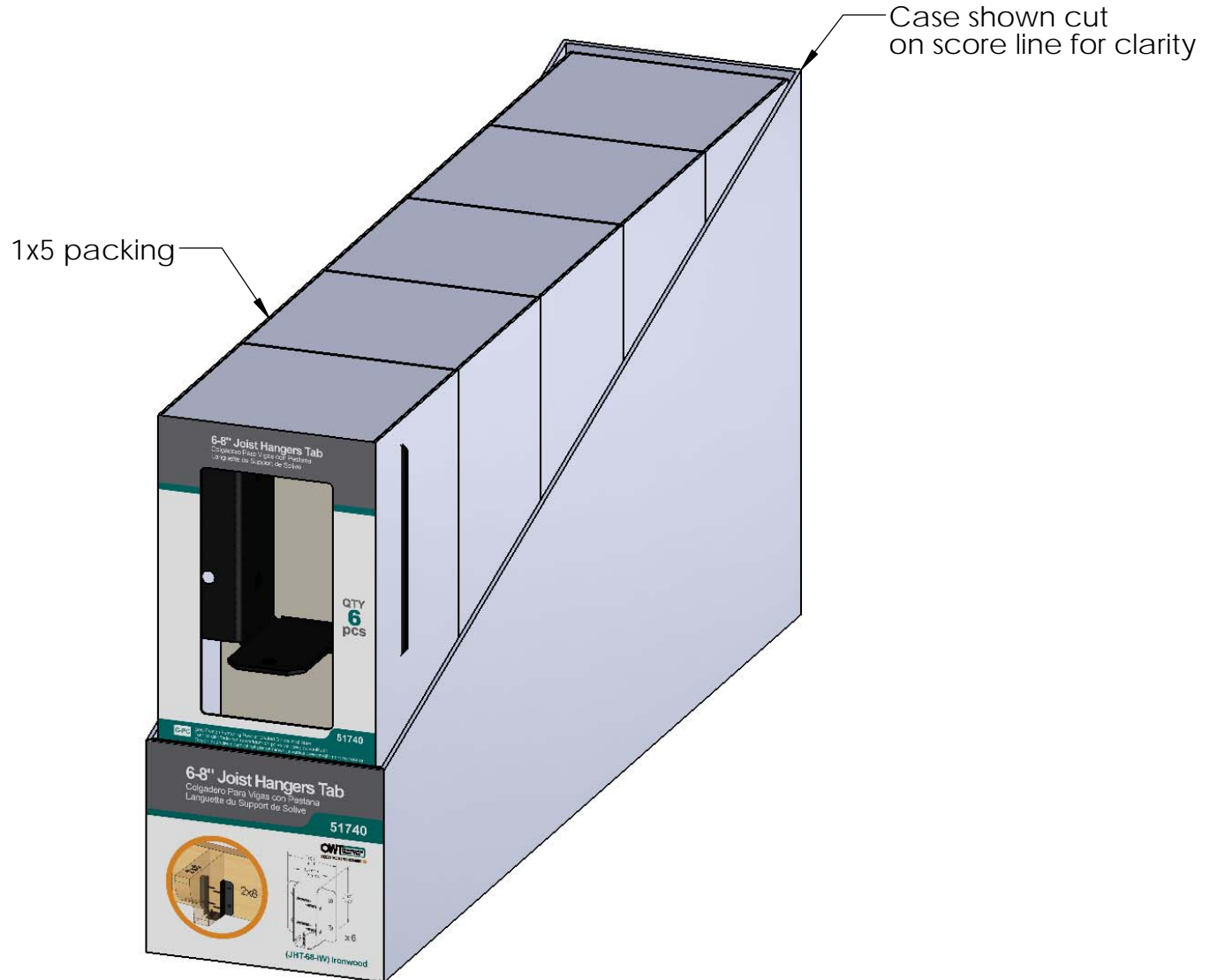

Weight: 21.75 LBS
Scale: 1:2
Last updated: 10/10/2016

51740

ADD PALLET LABEL

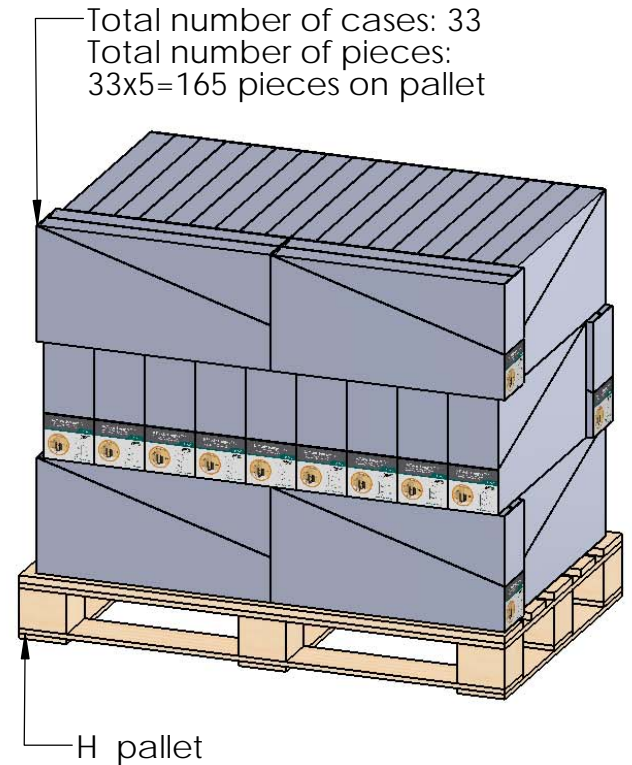
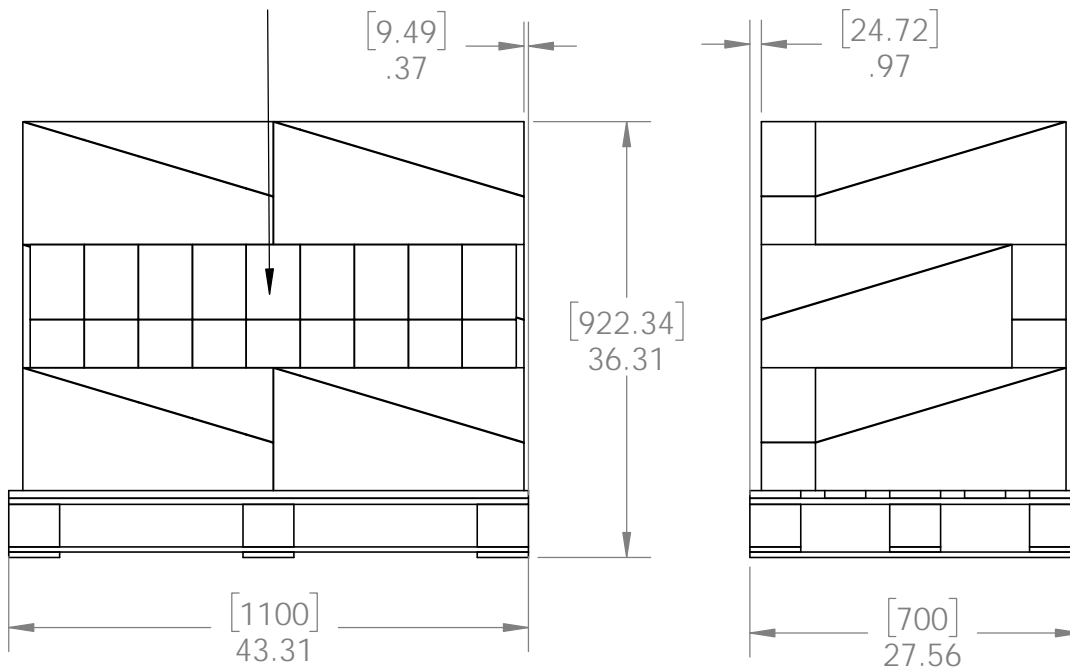

Weight: 746 LBS
 Scale: 1:2
 Last updated: 10/10/2016

51740

additional pallet packing instructions

- plywood on top layer
- strap to pallet
- clear wrap around boxes