



OZCO BUILDING PRODUCTS

# Product & Packaging Specs

## 8-10" Joist Hanger Flush (JHF-810-IW)

Item #: 51770

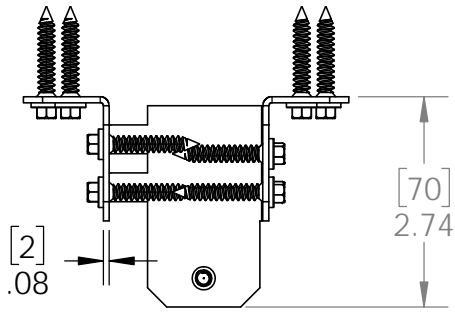

This Package Includes



- Requires a 1/4" hex driver bit
- Exclusive high friction design
- No pre-drilling required

ITEM NO.	QTY.	PART NUMBER	DESCRIPTION
1	1	51770-11	Bracket, 8-10" Joist Hanger Flush
2	1	51770-12	Bracket, 8-10" Joist Hanger Flush
3	19	80060	Screw, 1-1/2"x1/4" Black Hex-Head (1-1/2-HX-SCR)

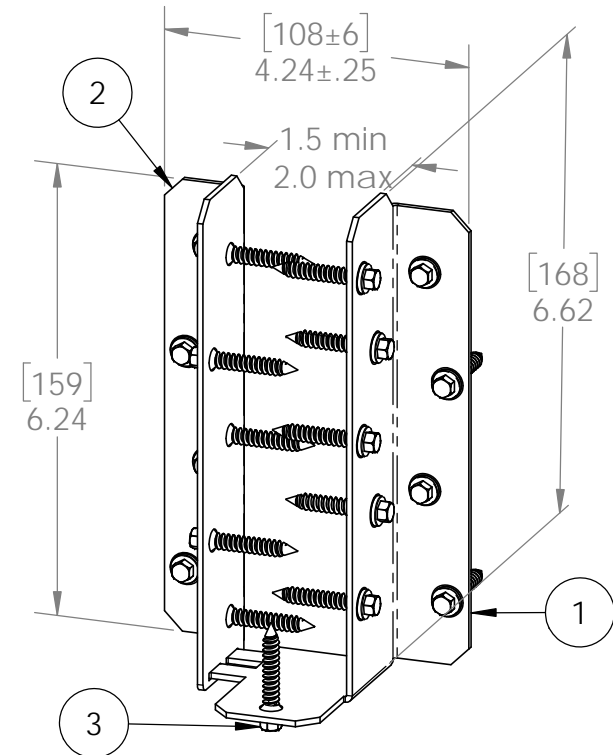
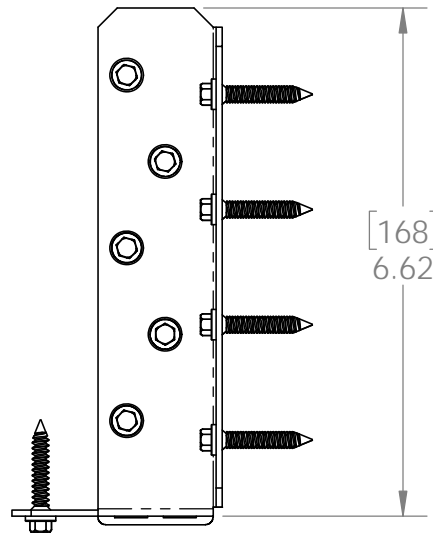
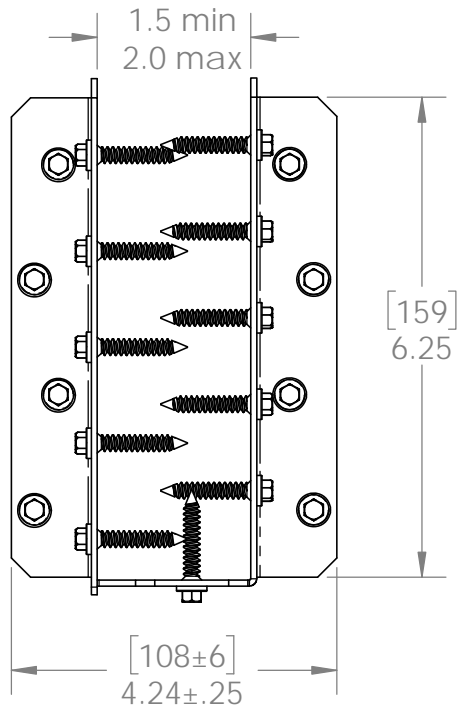

Weight: 0.83 LBS  
 Scale: 1:2.5  
 Last updated: 10/10/2016

51770

# Product & Packaging Specs

## 8-10" Joist Hanger Flush (JHF-810-IW)

Item #: 51770

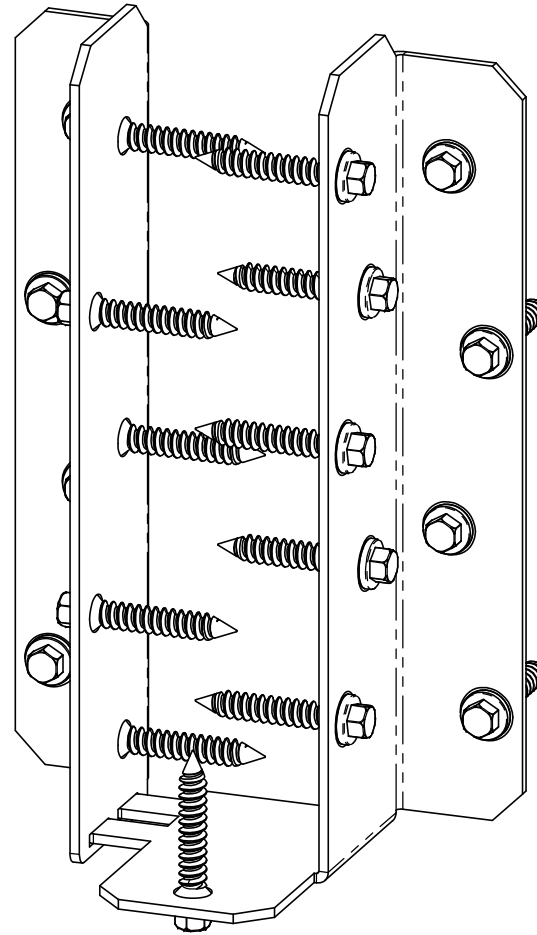
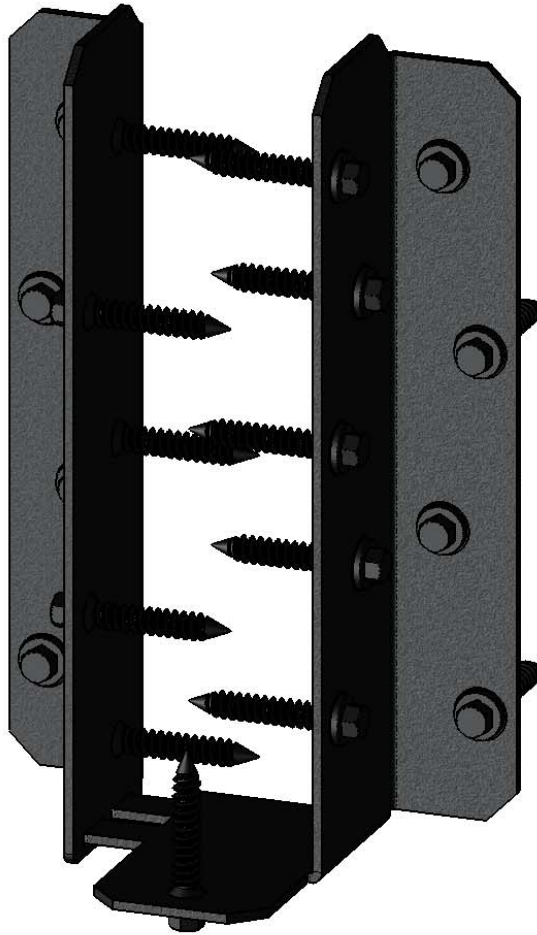

Weight: 0.83 LBS  
Scale: 1:1.5  
Last updated: 10/10/2016

51770

# Product & Packaging Specs

## 8-10" Joist Hanger Flush (JHF-810-IW)

Item #: Typical Installation & Basic Assembly

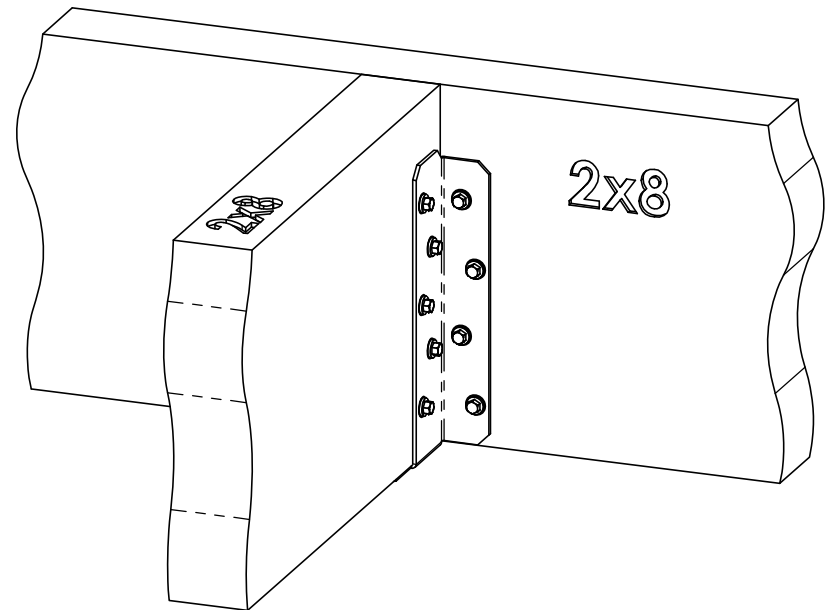
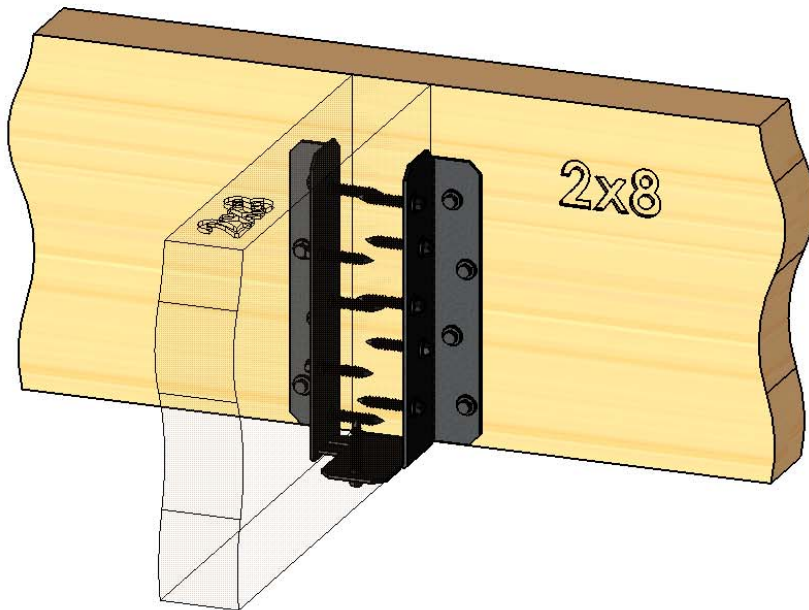

Weight: 0.83 LBS  
Scale: 1:4  
Last updated: 10/10/2016

51770

# Product & Packaging Specs

## 8-10" Joist Hanger Flush (JHF-810-IW)

Item #: Typical Installation & Basic Assembly

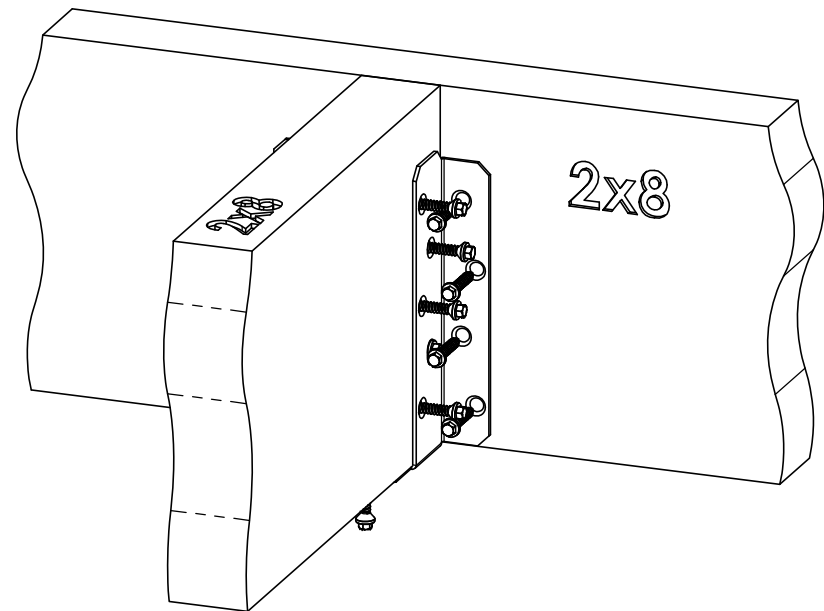
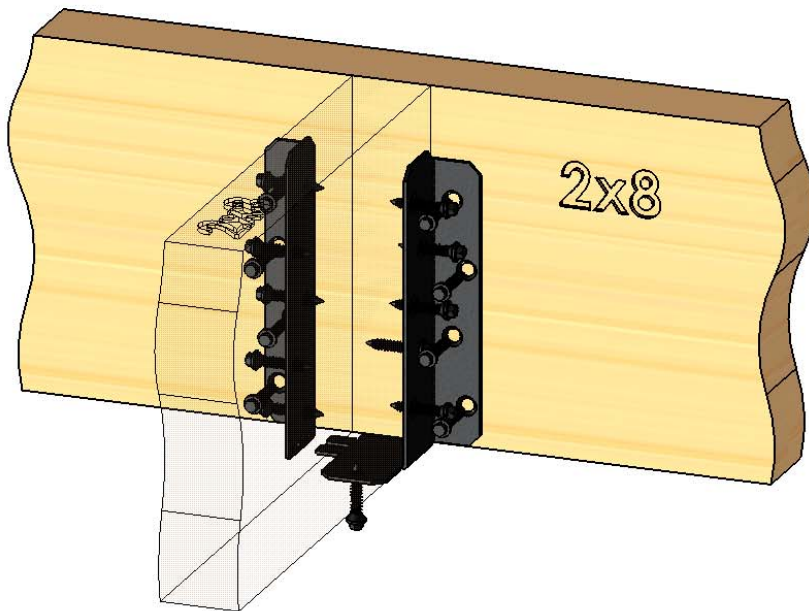

Weight: 0.83 LBS  
Scale: 1:4  
Last updated: 10/10/2016

51770



OZCO BUILDING PRODUCTS

This Package Includes



- Requires a 1/4" hex driver bit
- Exclusive high friction design
- No pre-drilling required

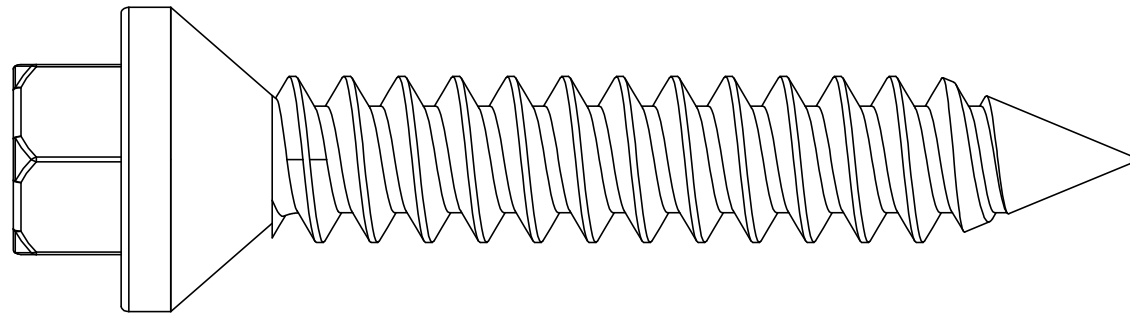
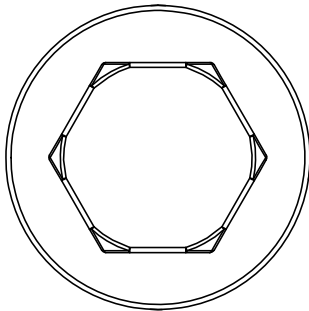

# Product & Packaging Specs

## Screw, 1-1/2"x1/4"

### Black Hex-Head (1-1/2-HX-SCR)

Item #: 80060

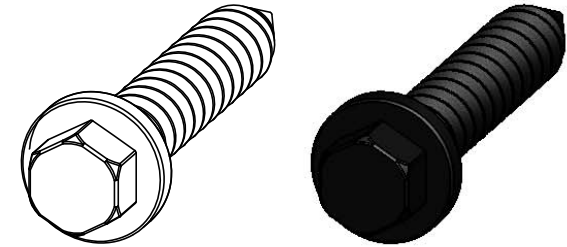

Material: Plain Carbon Steel  
Finish: Black Zinc  
Weight: 0.01 LBS  
Scale: 4:1  
Last updated: 10/10/2016

51770

for additional details, see drawing #80060

V2.00 - Installation Instructions, Specifications and Project Plans are effective 10/10/2016 . This information is updated periodically 7 and should not be relied upon after 2 years from 10/10/2016 . Please visit OZCOBP.com to get current information.

# Product & Packaging Specs

51770 packing

Item #: Box, packing

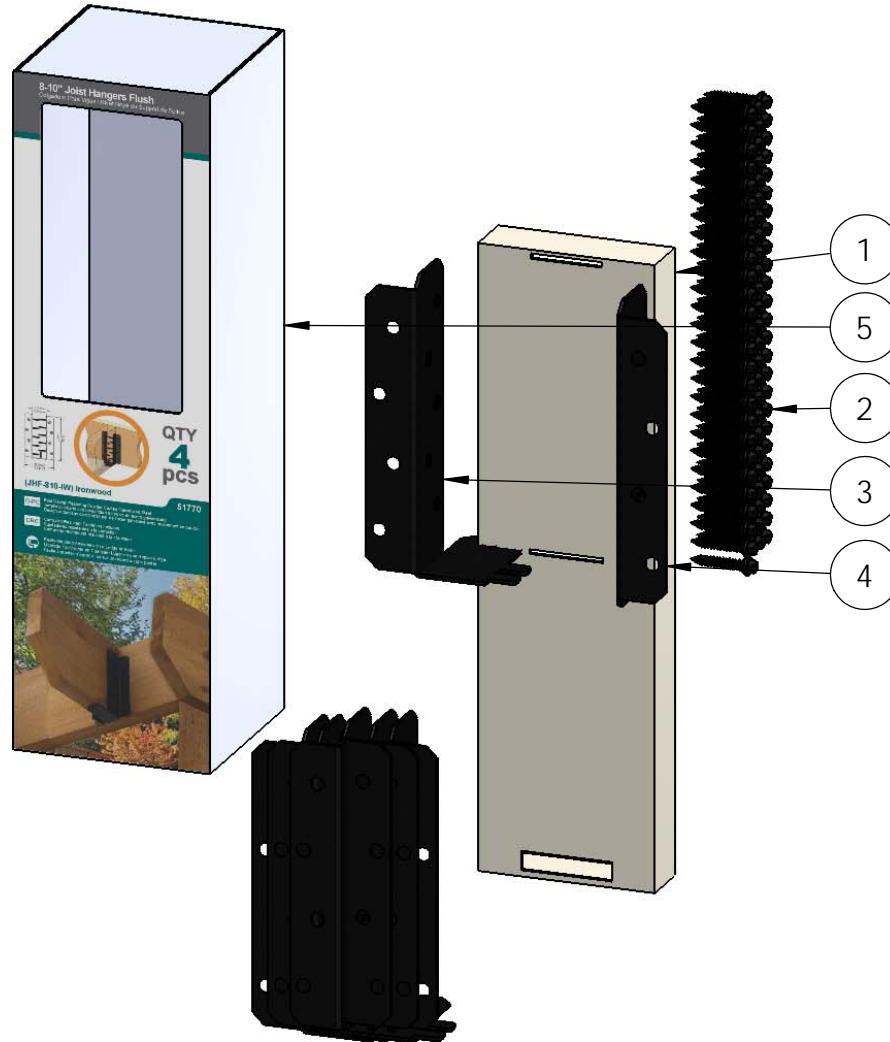

ITEM NO.	QTY.	PART NUMBER	DESCRIPTION
1	1	Insert, 56670	Insert, 56670
2	76	80060	Screw, 1-1/2"x1/4" Black Hex-Head (1-1/2-HX-SCR)
3	4	51770-11	Bracket, 8-10" Joist Hanger Flush
4	4	51770-12	Bracket, 8-10" Joist Hanger Flush
5	1	Box, 51770	Box, 8-10" Joist Hanger

Weight: 3.44 LBS  
 Scale: 1:4  
 Last updated: 10/10/2016

51770

# Product & Packaging Specs

51770 packing  
Item #: Case packing

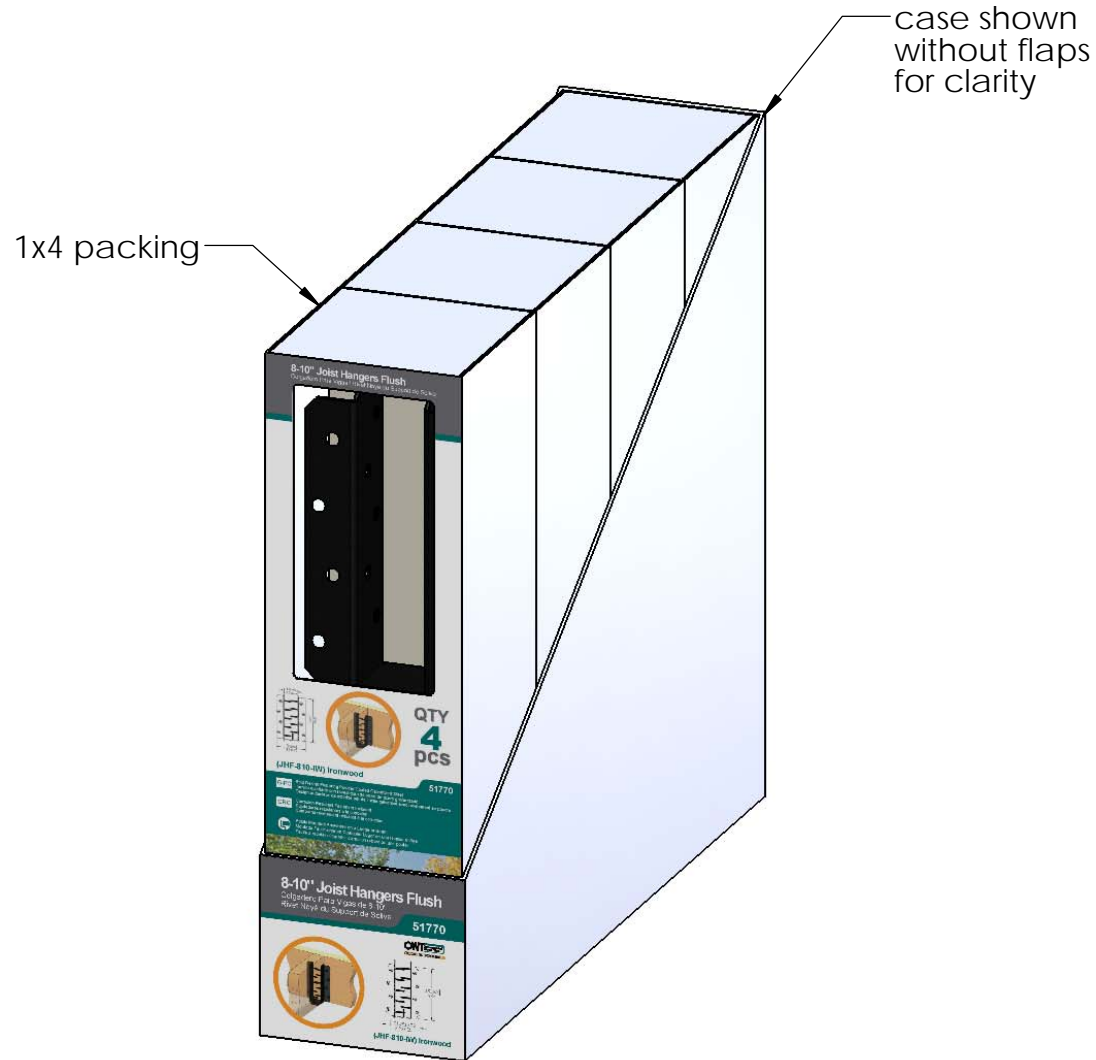

Weight: 16 LBS  
Scale: 1:4  
Last updated: 10/10/2016

51770

# Product & Packaging Specs

51770 packing  
 Item #: Pallet packing

ADD PALLET LABEL

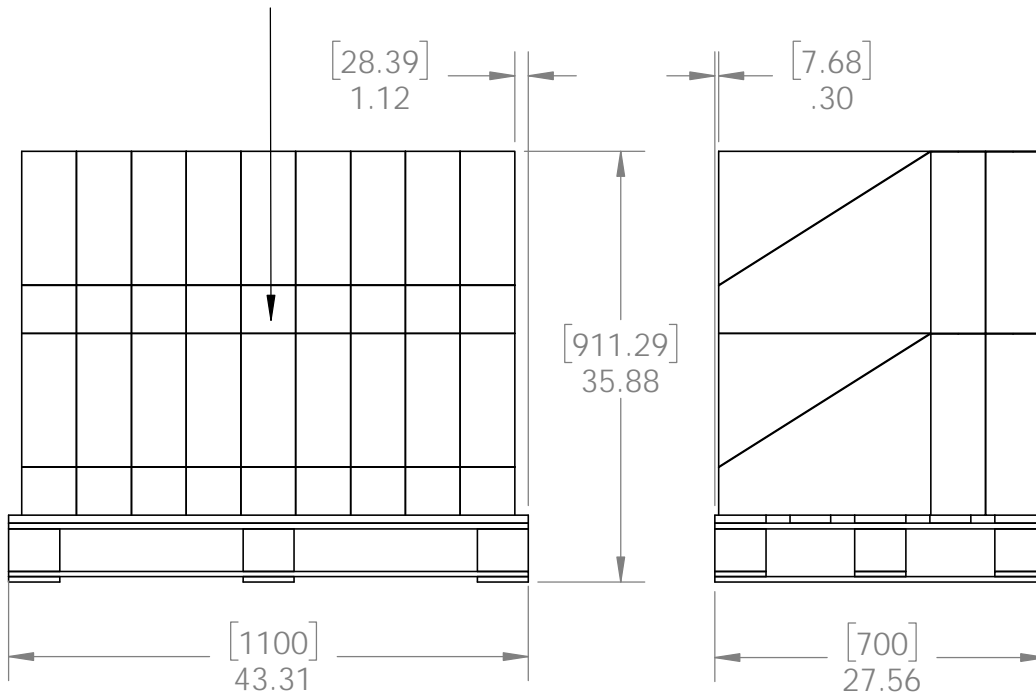

Total number of cases: 26  
 Total number of pieces:  
 26x4=104 pieces on pallet

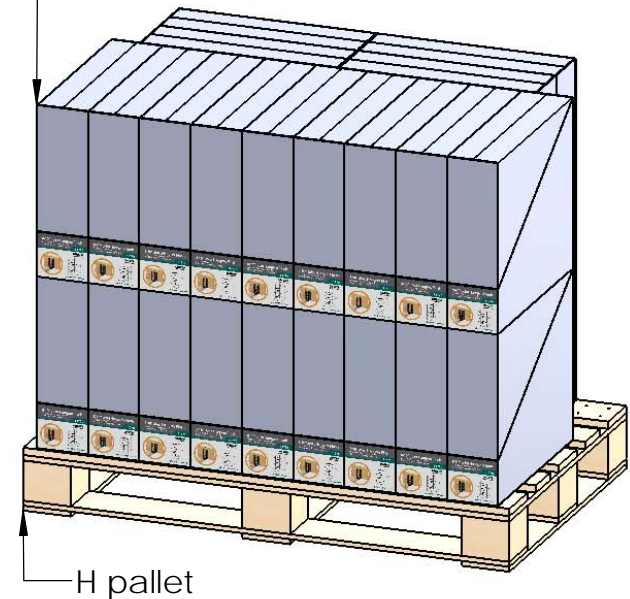

additional pallet packing instructions  
 plywood on top layer  
 strap to pallet  
 clear wrap around boxes

Weight: 215 LBS  
 Scale: 1:16  
 Last updated: 10/10/2016

51770