



OZCO BUILDING PRODUCTS

# Product & Packaging Specs

## Lite 8" Post 2 Beam (8- P2B-IWL)

Item #: 52110

ITEM NO.	QTY.	PART NUMBER	DESCRIPTION
1	0.08	56627	OWT Timber Screw 3-3/4"
2	0.4	56621	1 1/2" Hex Cap Nut (HCN)
3	0.08	56626	OWT Timber Screw 2-3/4"
4	1	56610-11	Ledge, Post to Beam
5	1	56610-12	Plate, Top 8" Post to Beam

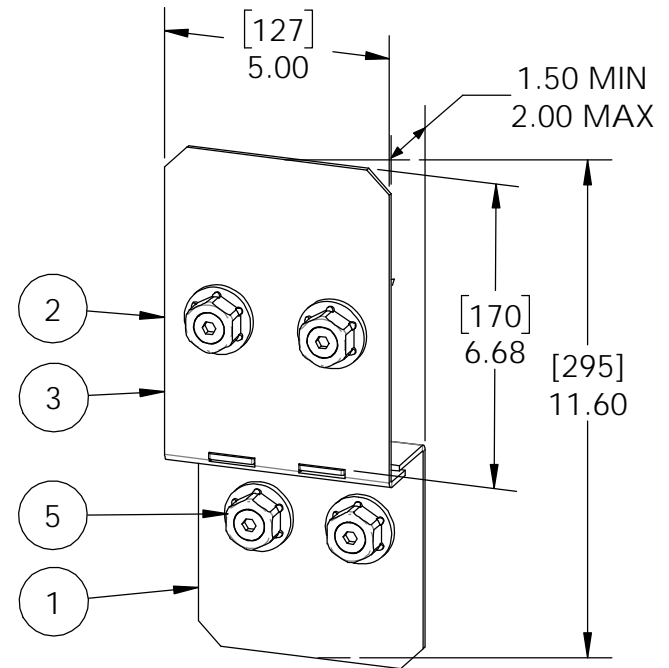
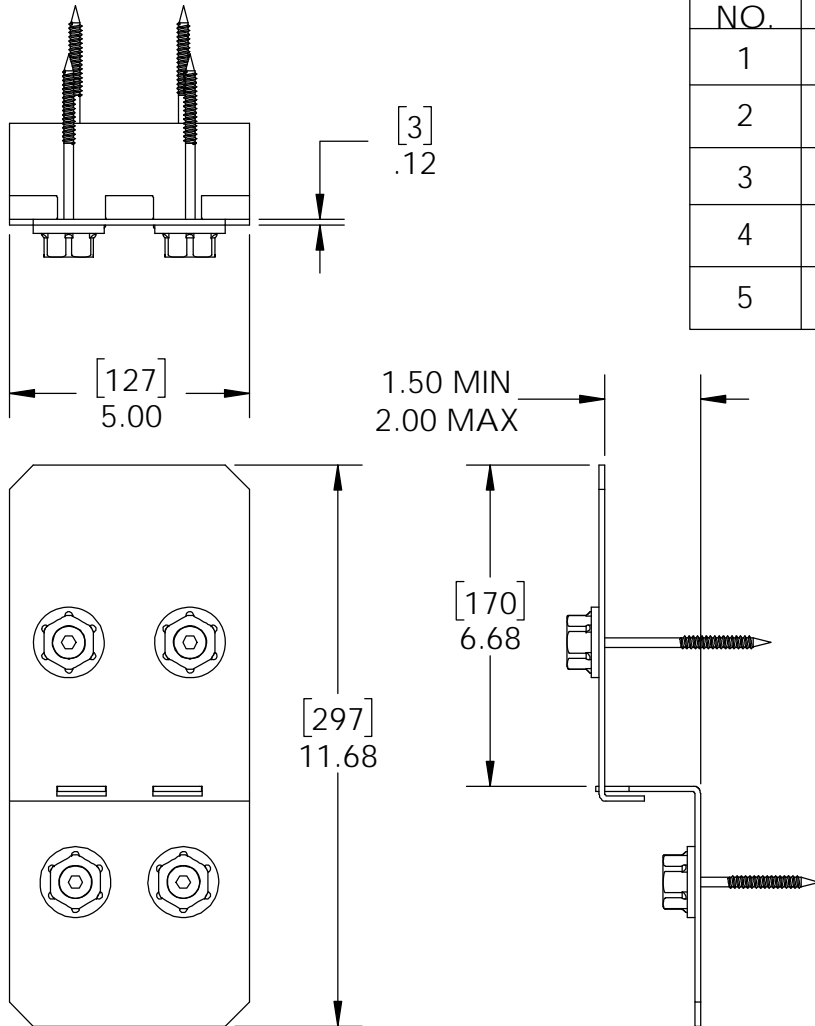

kit contains 2 assemblies

Weight: 2.62 LBS  
 Scale: 1:4  
 Last updated: 3/27/2018

52110

# Product & Packaging Specs

## Lite 8" Post 2 Beam (8- P2B-LSL)

Item #: 56610

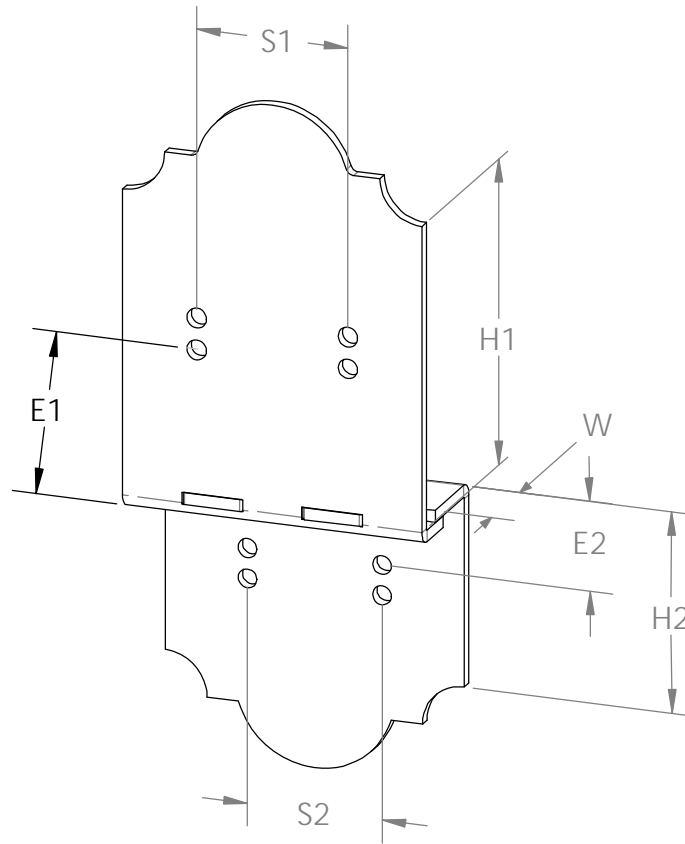

Weight: 3.47 LBS  
Scale: 1:3  
Last updated: 3/27/2018

52110

# Product & Packaging Specs

## Lite 8" Post 2 Beam (8- P2B-LSL)

Item #: Typical Installation & Basic Assembly

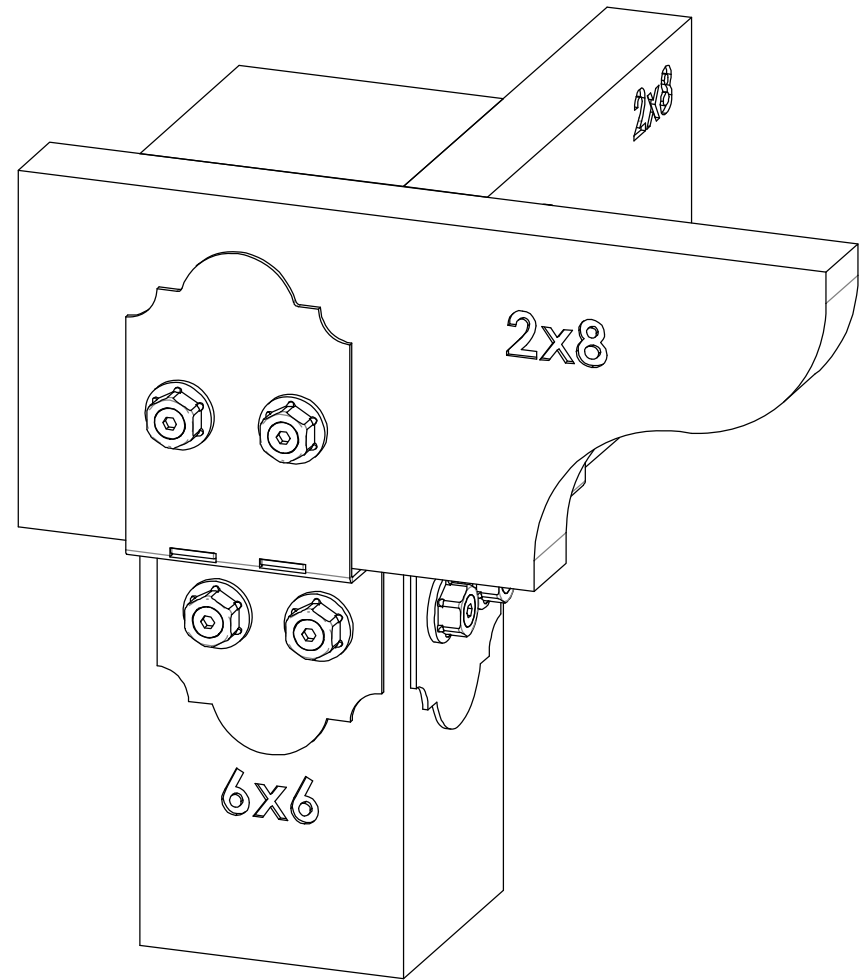
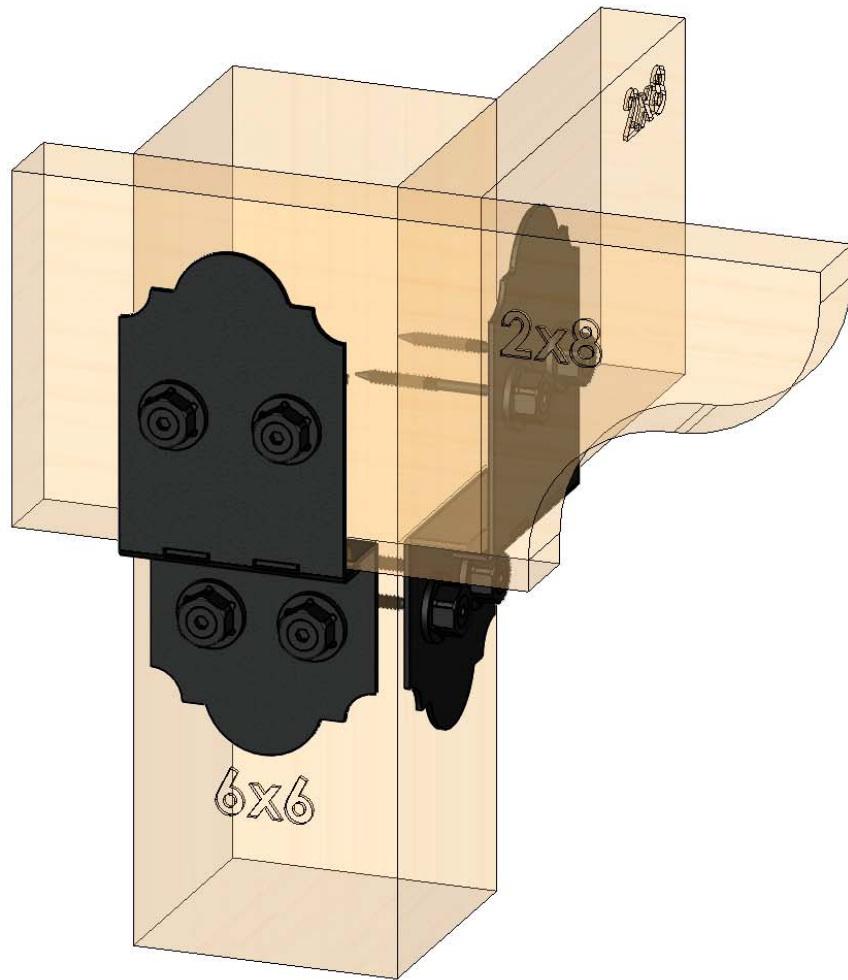

Weight: 40.80 LBS  
Scale: 1:4  
Last updated: 3/27/2018

52110

# Product & Packaging Specs

## Lite 8" Post 2 Beam (8- P2B-LSL)

Item #: Typical Installation & Basic Assembly

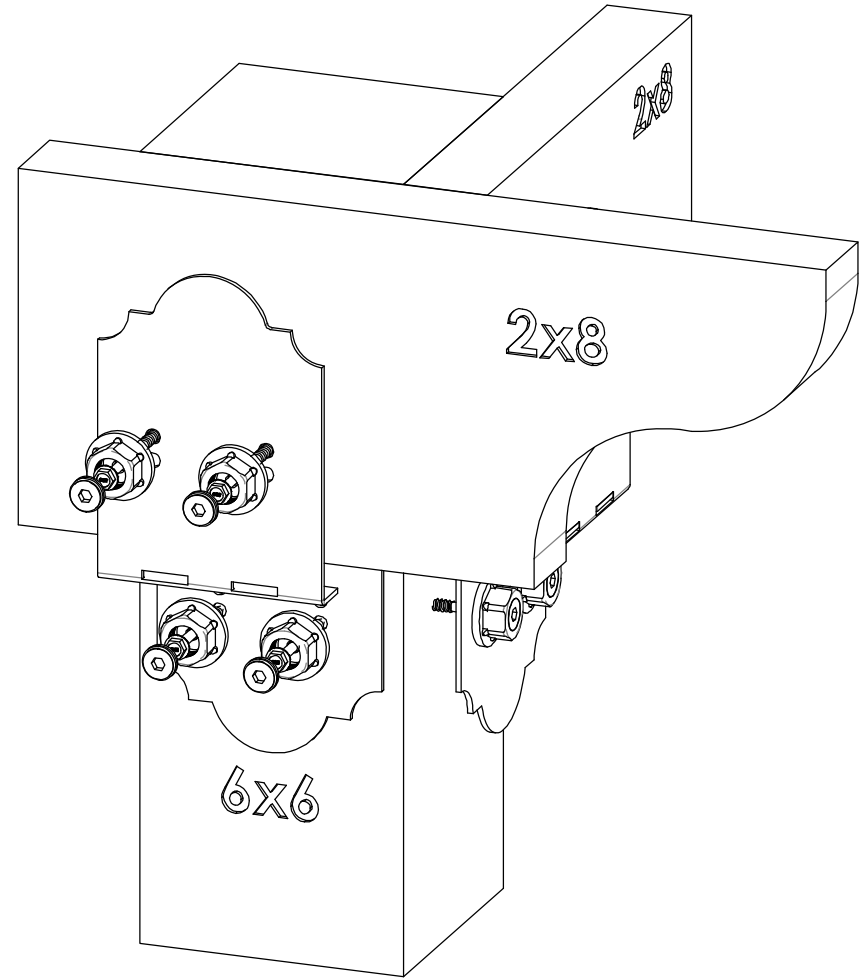
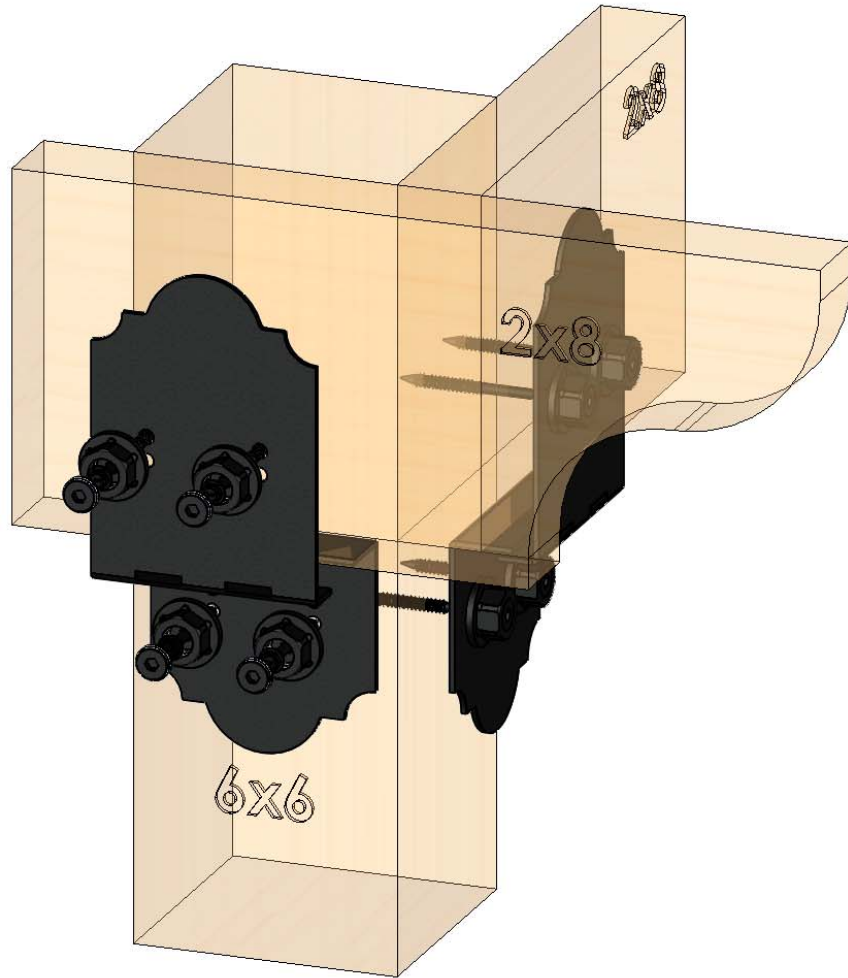

Weight: 40.80 LBS  
Scale: 1:4  
Last updated: 3/27/2018

52110

# Product & Packaging Specs

## Lite 8" Post 2 Beam (8- P2B-LSL)

Item #: Typical Installation & Basic Assembly

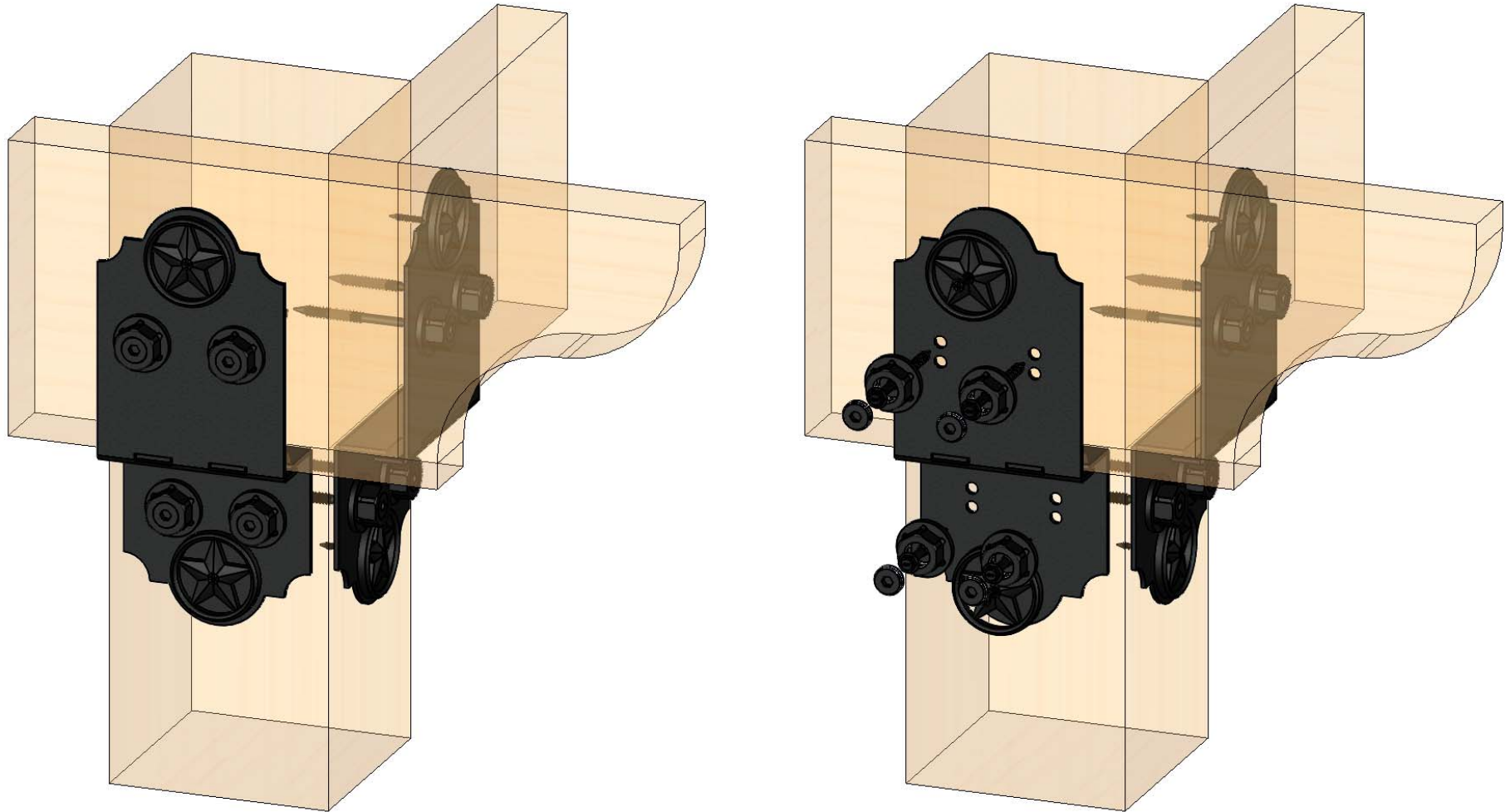

Weight: 41.07 LBS  
Scale: 1:4  
Last updated: 3/27/2018

52110

# Product & Packaging Specs

## Lite 8" Post 2 Beam (8- P2B-LSL)

Item #: Typical Installation & Basic Assembly

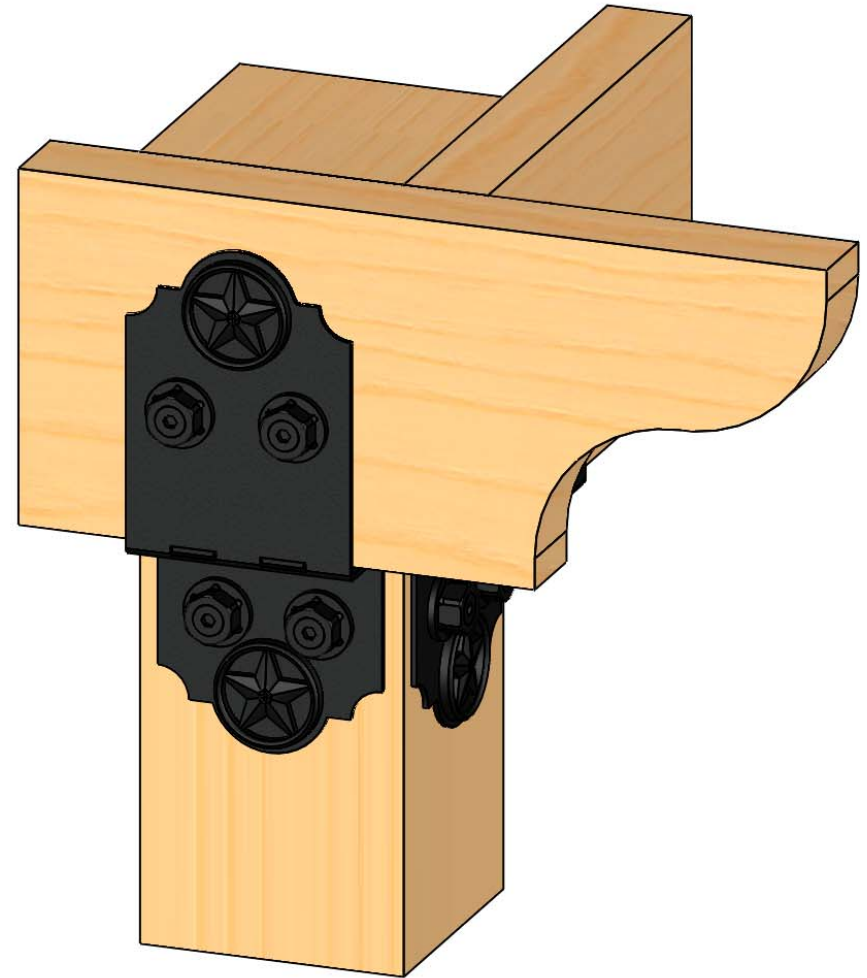
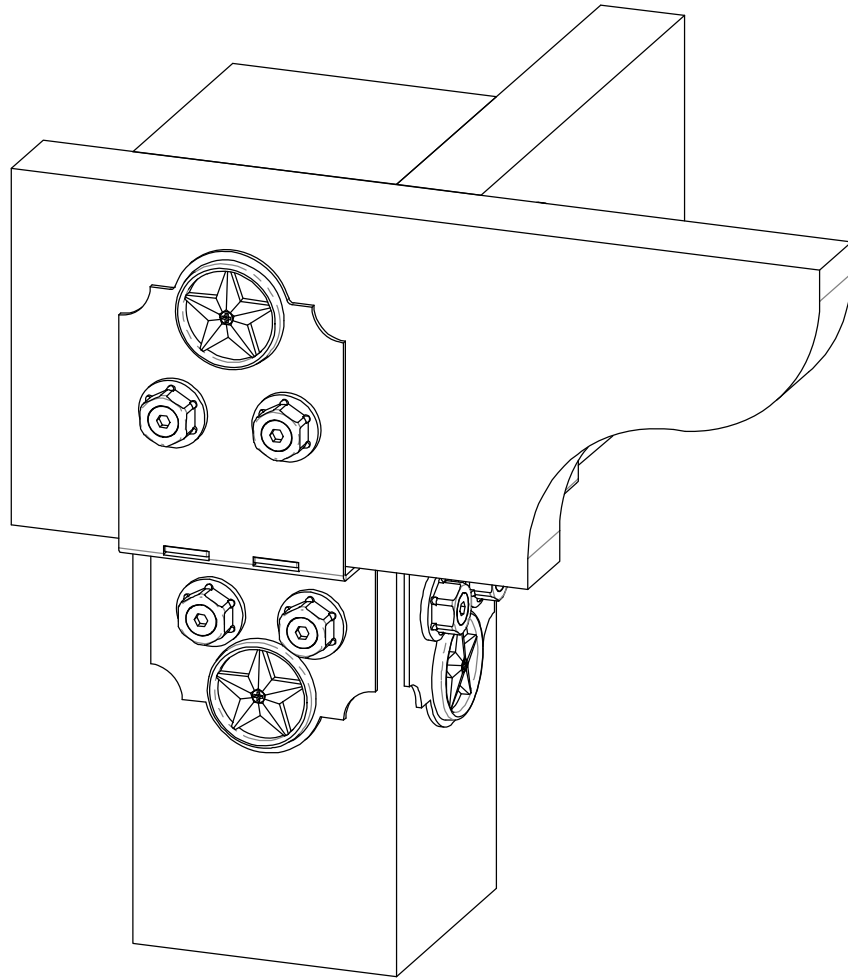

Weight: 41.07 LBS  
Scale: 1:4  
Last updated: 3/27/2018

52110



# Product & Packaging Specs

## Lite 8" Post 2 Beam (8- P2B-LSL)

Item #: Typical Installation & Basic Assembly

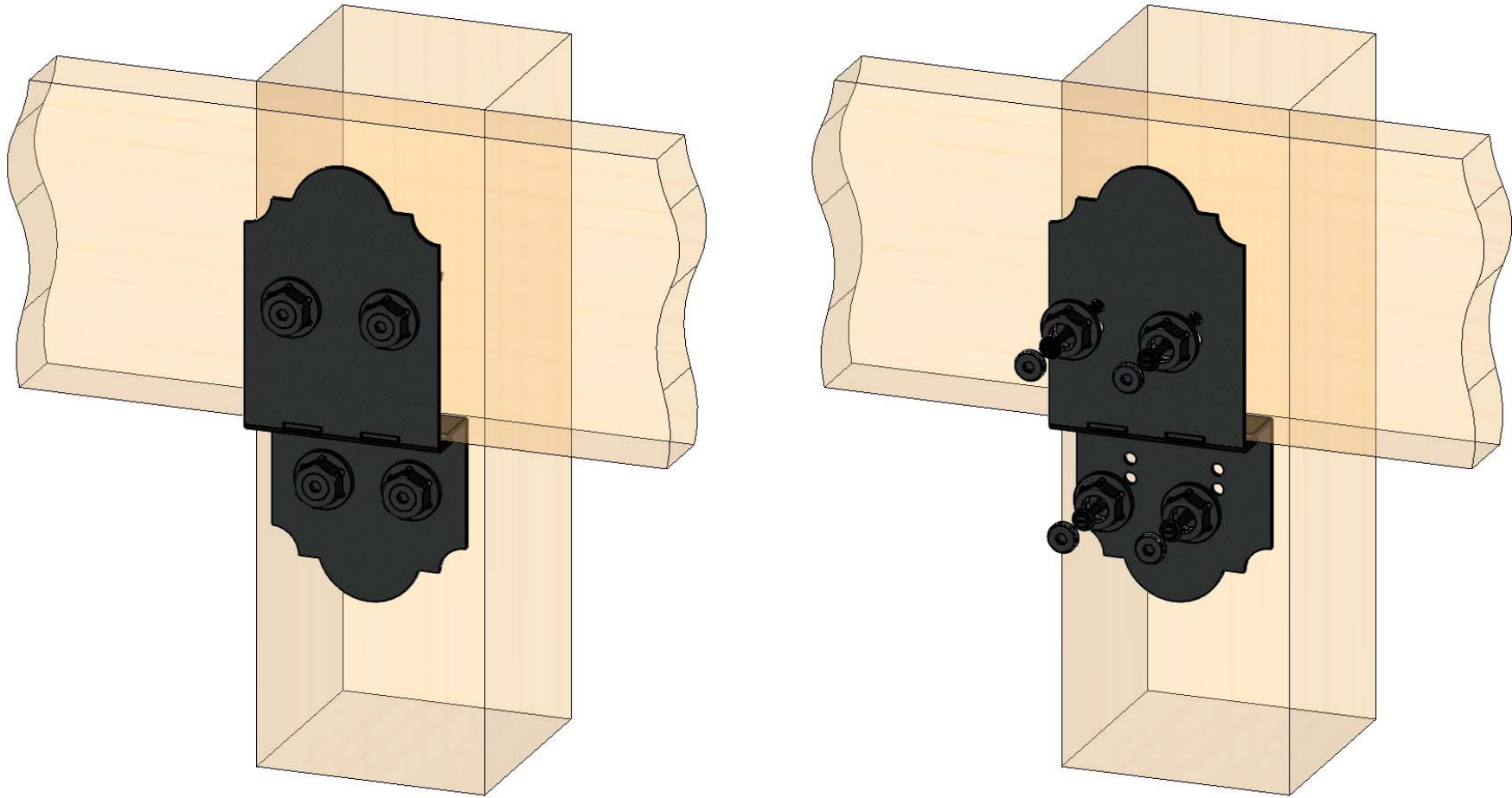

Weight: 33.07 LBS  
Scale: 1:4  
Last updated: 3/27/2018

52110



# Product & Packaging Specs

## Lite 8" Post 2 Beam (8- P2B-LSL)

Item #: Typical Installation & Basic Assembly

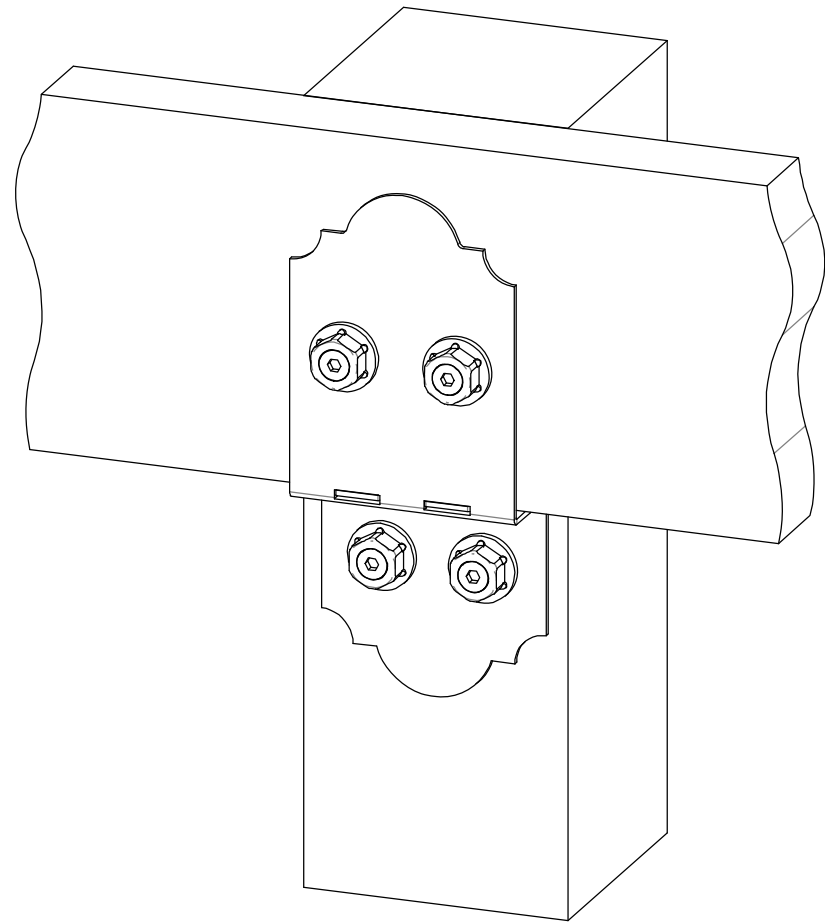
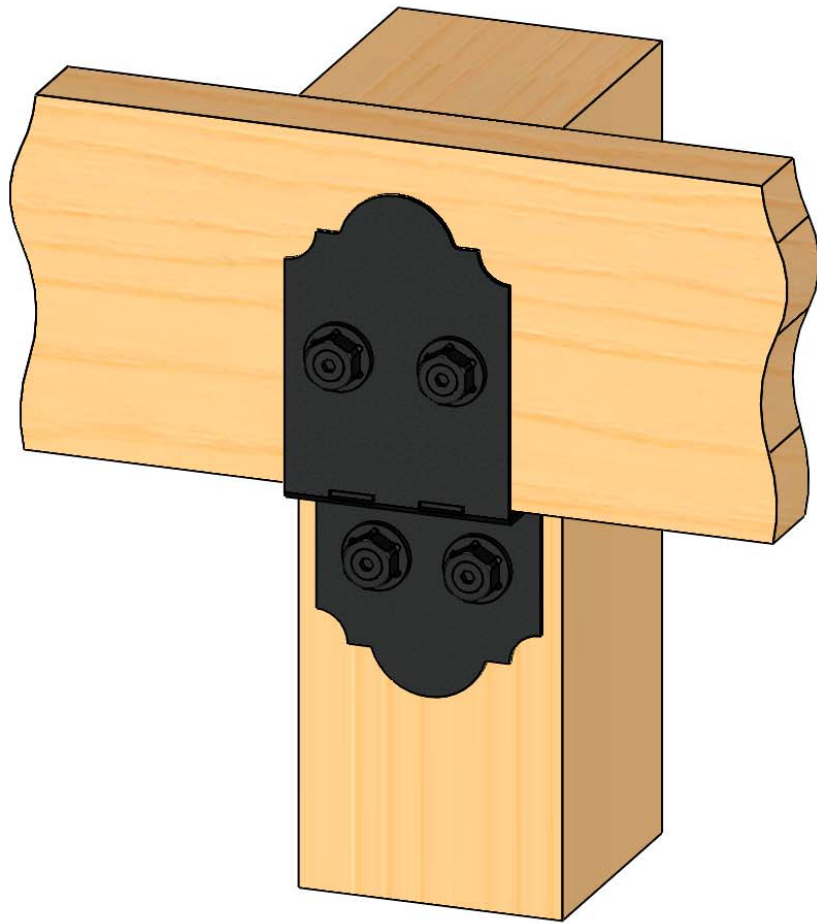

Weight: 33.07 LBS  
Scale: 1:4  
Last updated: 3/27/2018

52110



# Product & Packaging Specs

## Lite 8" Post 2 Beam (8- P2B-LSL)

Item #: Typical Installation & Basic Assembly

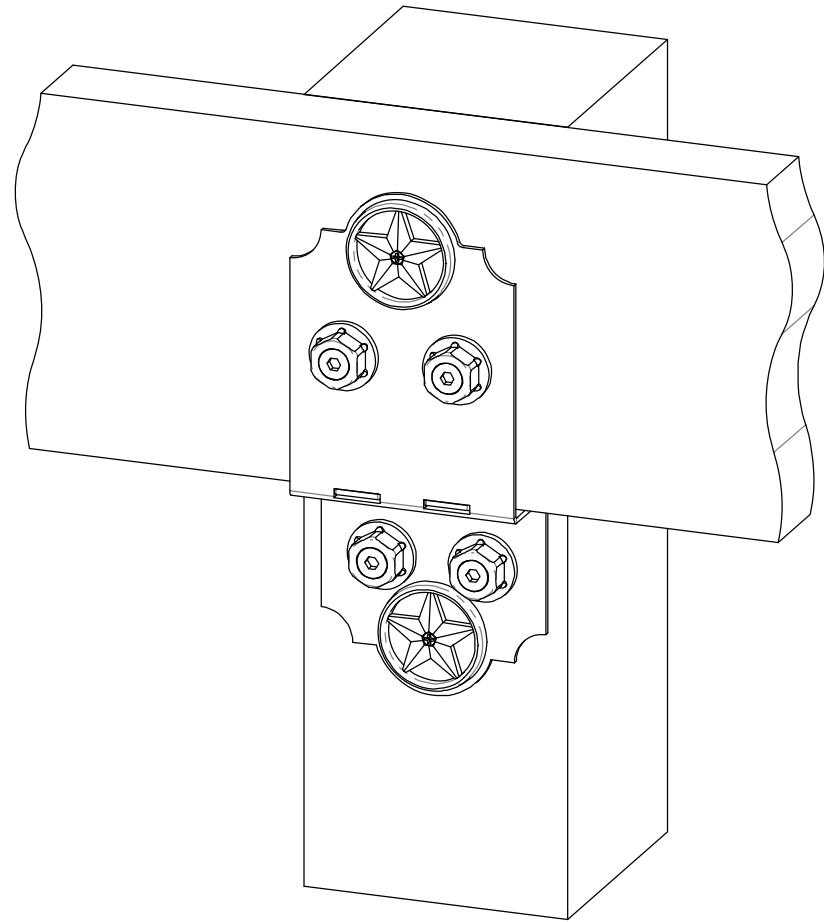
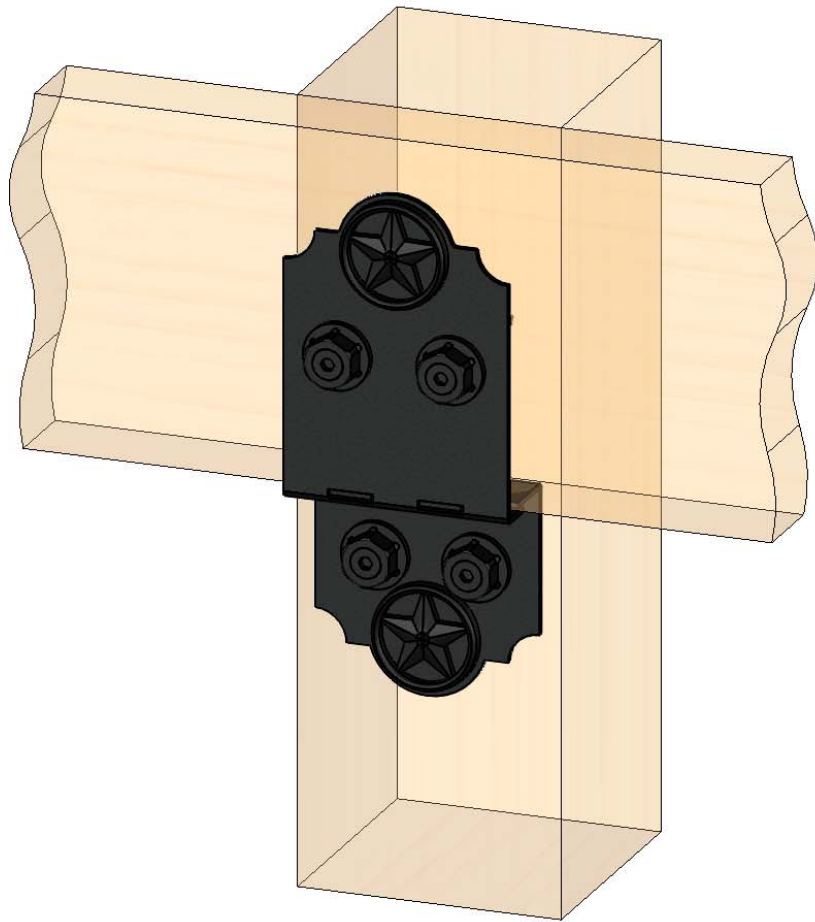

Weight: 33.20 LBS  
Scale: 1:4  
Last updated: 3/27/2018

52110

# Product & Packaging Specs

## Lite 8" Post 2 Beam (8- P2B-LSL)

Item #: 56610

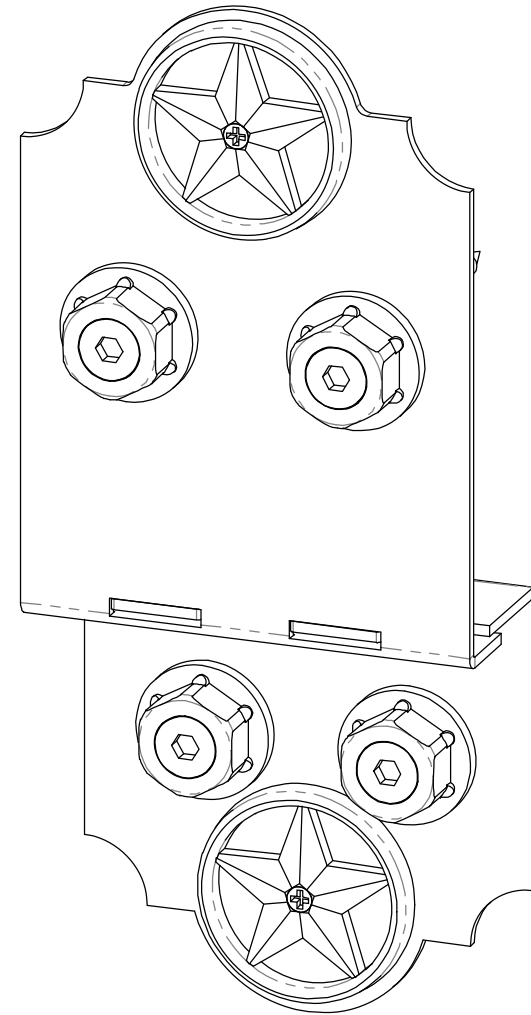
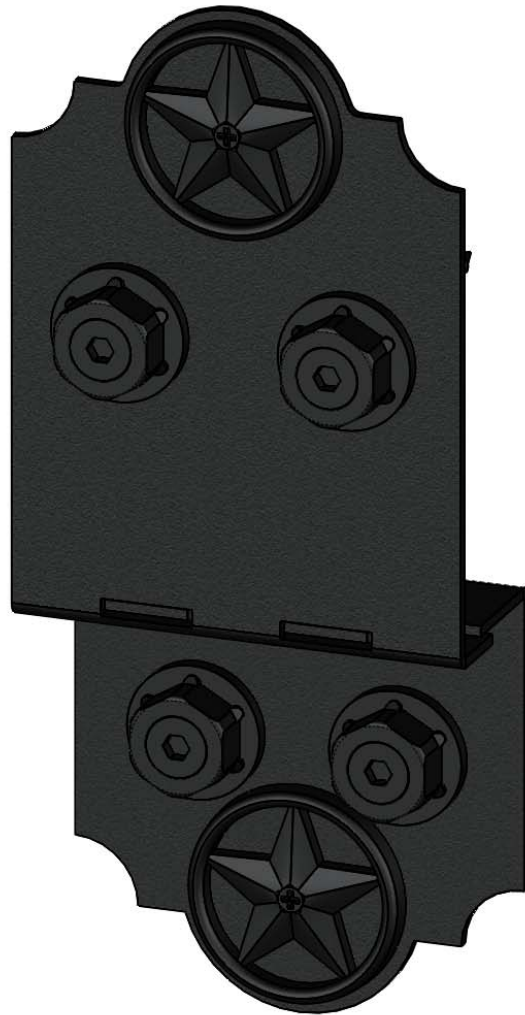

Weight: 2.49 LBS  
Scale: 1:2  
Last updated: 3/27/2018

52110



OZCO BUILDING PRODUCTS

# Product & Packaging Specs

Box

Item #: 52110 Box

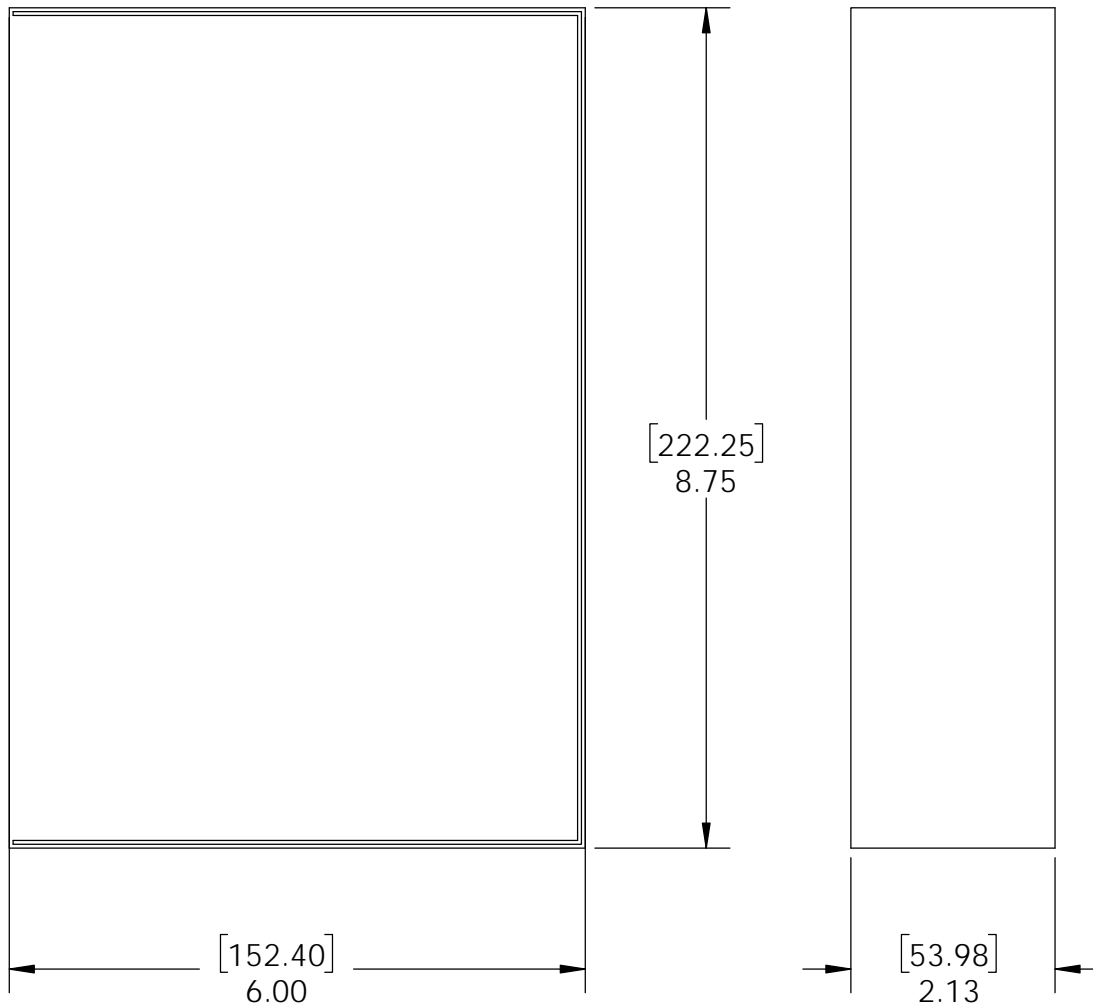

flap



Weight: 0.04 LBS  
 Scale: 1:2  
 Last updated: 3/27/2018

52110

# Product & Packaging Specs

## 52110 Packing

Item #: Box packing

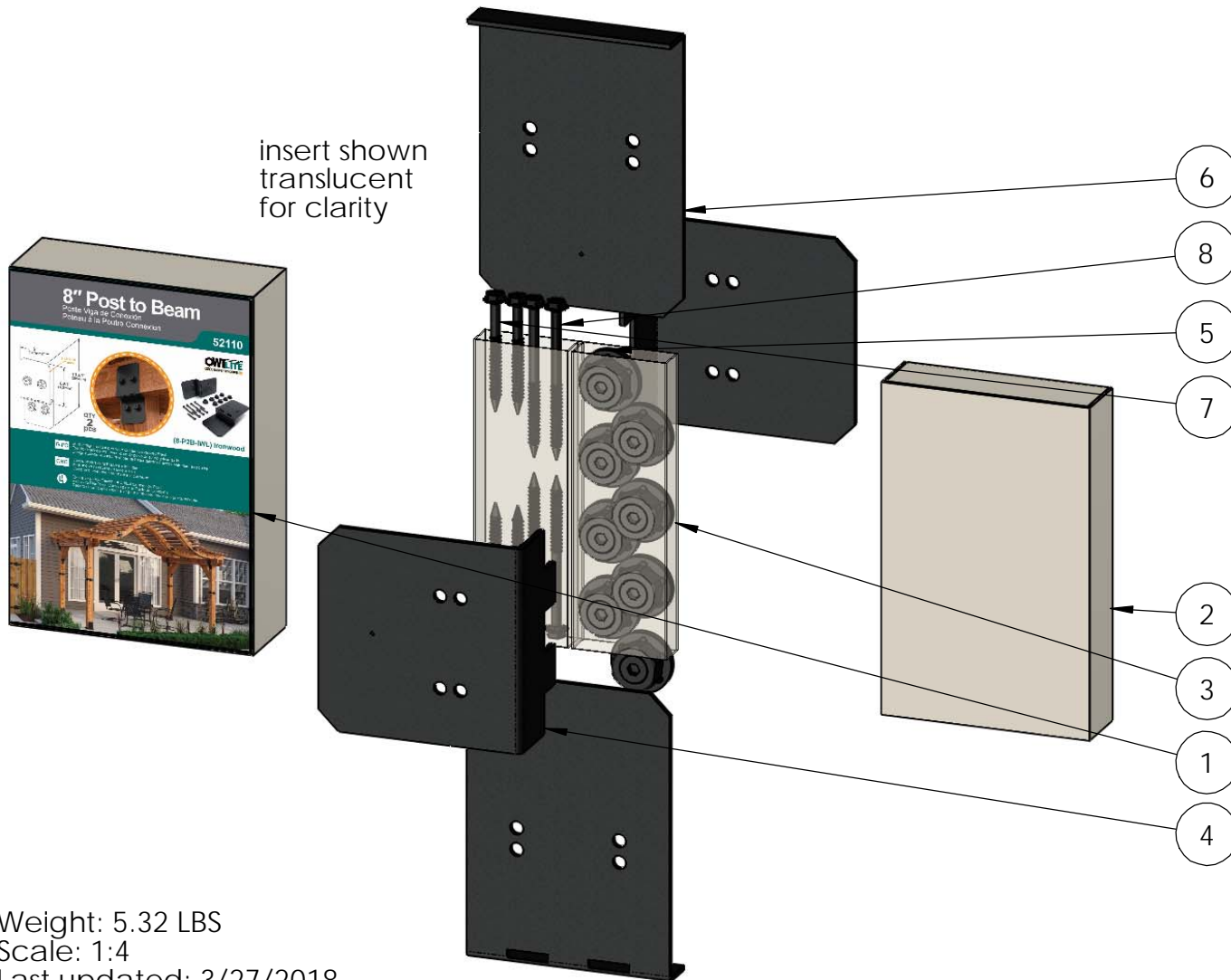

ITEM NO.	QTY.	PART NUMBER	DESCRIPTION
1	1	52110 Box	Box
2	1	56637 Inner Box	56637 Inner Box
3	1	56637 Inner Box Sleeve	56637 Inner Box Sleeve
4	2	52110-11	Ledge, Lite 8" Post 2 Beam IW
5	0.8	56621	1 1/2" Hex Cap Nut (HCN)
6	2	52110-12	Plate, Compression Lite 8" Post 2 Beam IW
7	0.08	56626	OWT Timber Screw 2-3/4"
8	0.24	56627	OWT Timber Screw 3-3/4"

Weight: 5.32 LBS  
 Scale: 1:4  
 Last updated: 3/27/2018

52110

# Product & Packaging Specs

Case, 52110  
 Item #: Case

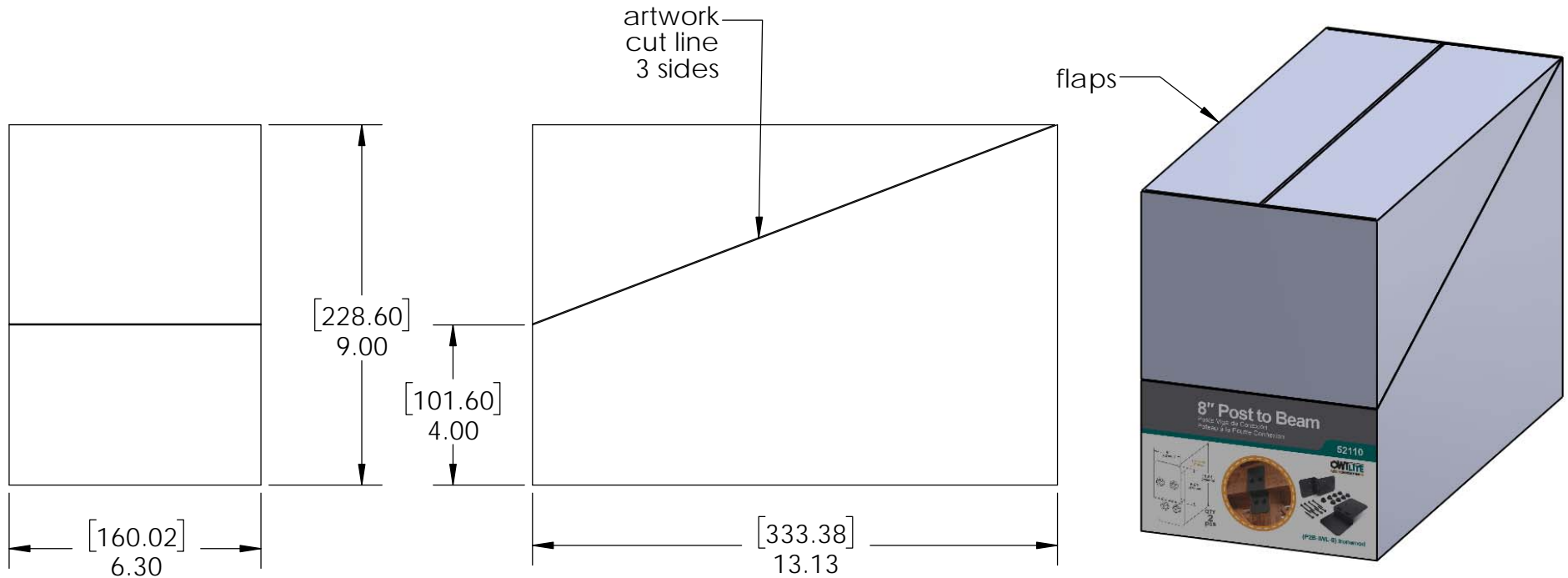

Weight: 0.23 LBS  
 Scale: 1:4  
 Last updated: 3/27/2018

52110





OZCO BUILDING PRODUCTS

# Product & Packaging Specs

52110 Packing

Item #: Case packing

case flaps  
not shown  
for clarity

1x6 packing

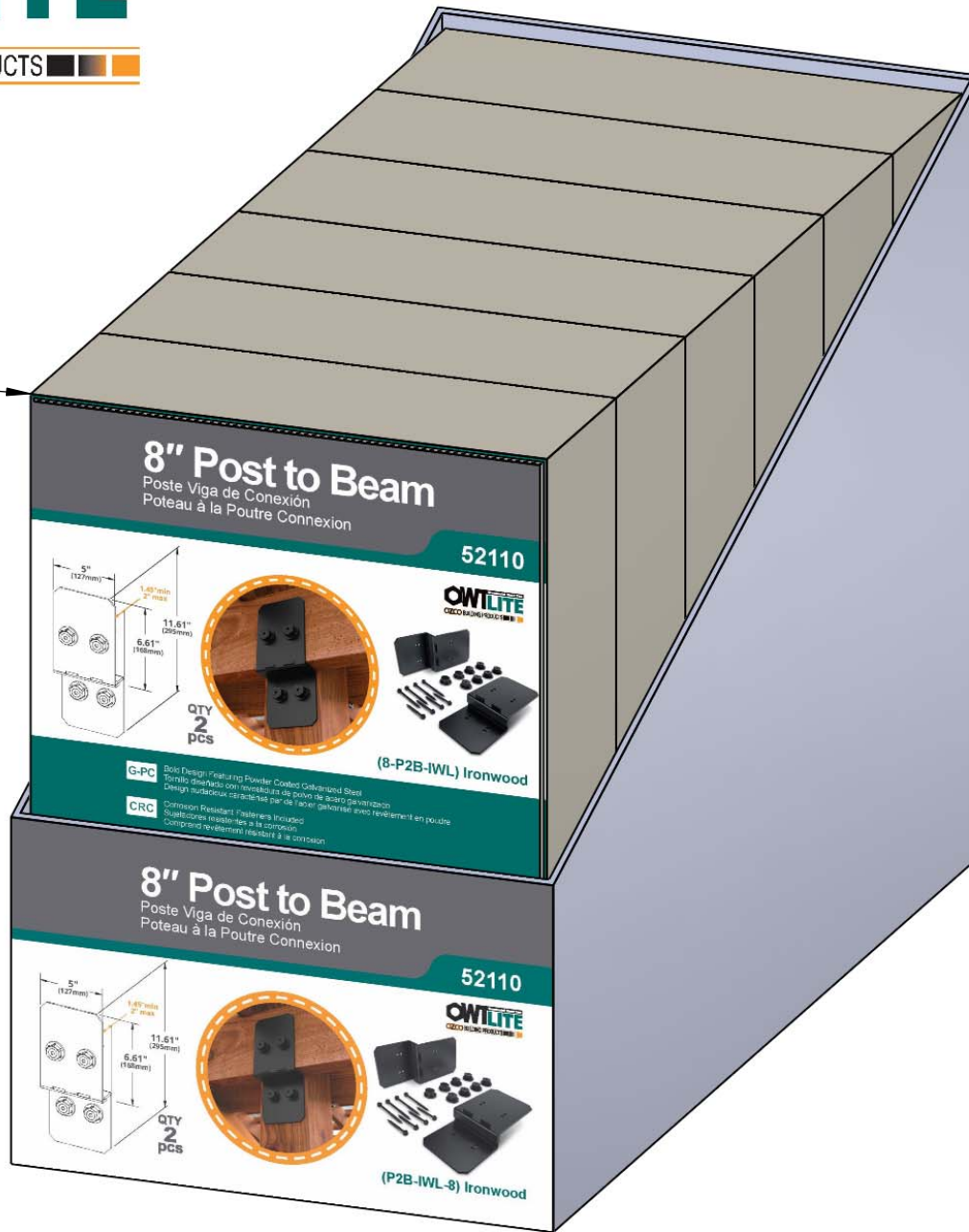

Weight: 33 LBS  
Scale: 1:2  
Last updated: 3/27/2018

52110



# Product & Packaging Specs

## 52110 Packing

Item #: Pallet packing

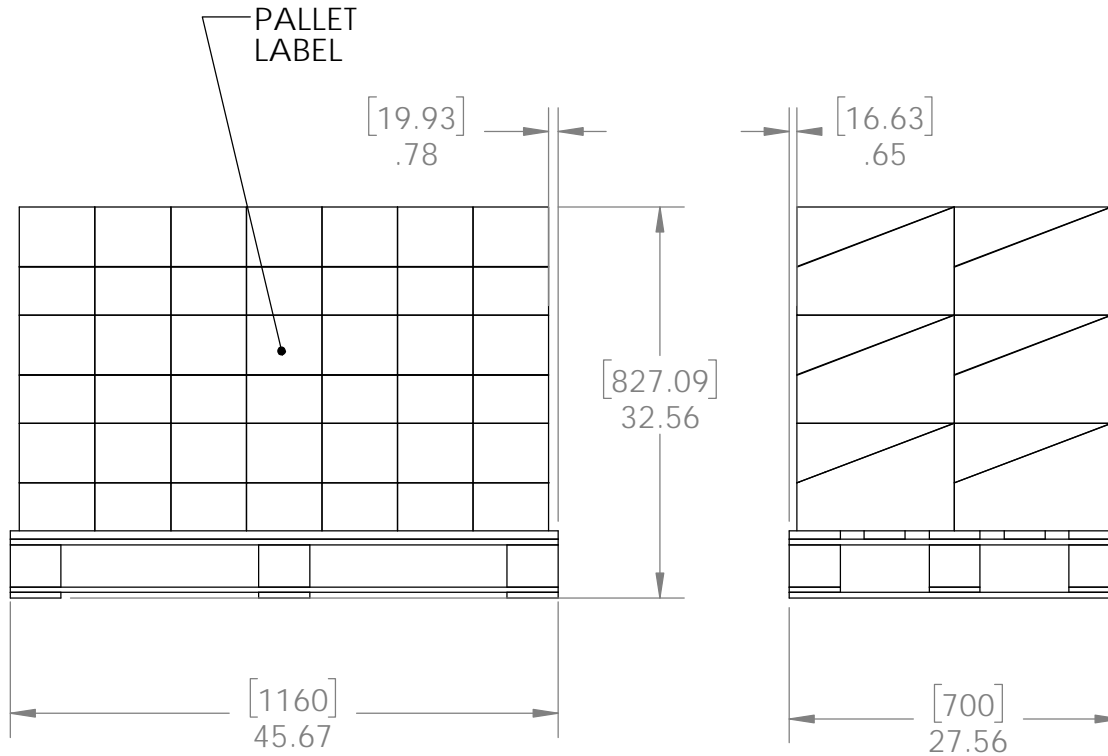

Total number of cases: 42  
 Total number of pieces:  
 42X6=252 pieces on pallet

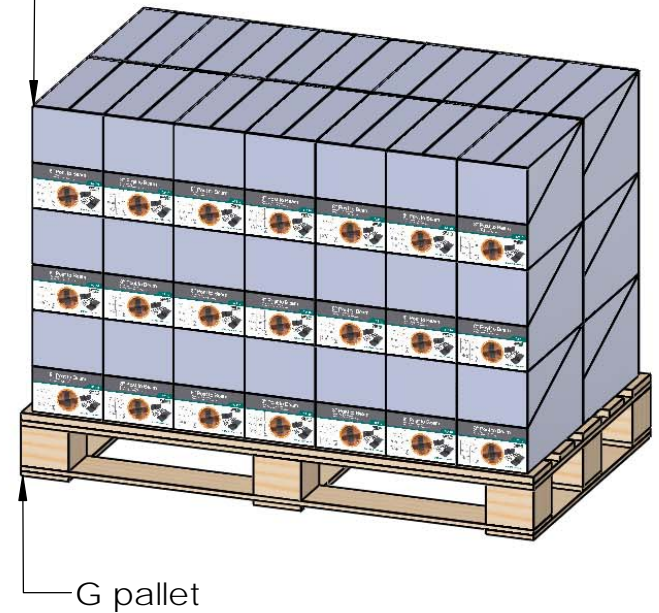

Weight: 1383 LBS  
 Scale: 1:16  
 Last updated: 3/27/2018

### additional pallet packing instructions

- plywood on top layer
- strap to pallet
- clear wrap around boxes

