



OZCO BUILDING PRODUCTS

Product & Packaging Specs

Lite 8" Post 2 Beam (8- P2B-LSL)

Item #: 54210

ITEM NO.	QTY.	PART NUMBER	DESCRIPTION
1	1	52110-11	Ledge, Lite 8" Post 2 Beam IW
2	0.08	56627	OWT Timber Screw 3-3/4"
3	1	52110-12	Plate, Compression Lite 8" Post 2 Beam IW
4	0.4	56621	1 1/2" Hex Cap Nut (HCN)
5	0.08	56626	OWT Timber Screw 2-3/4"

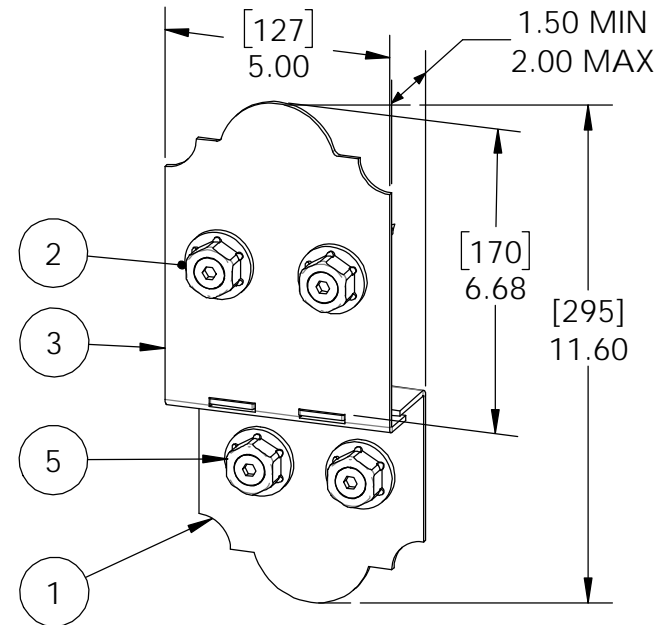
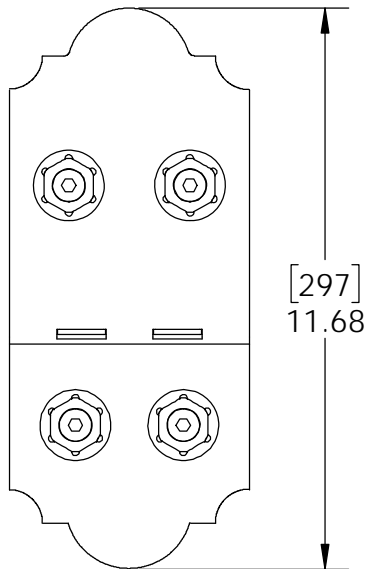
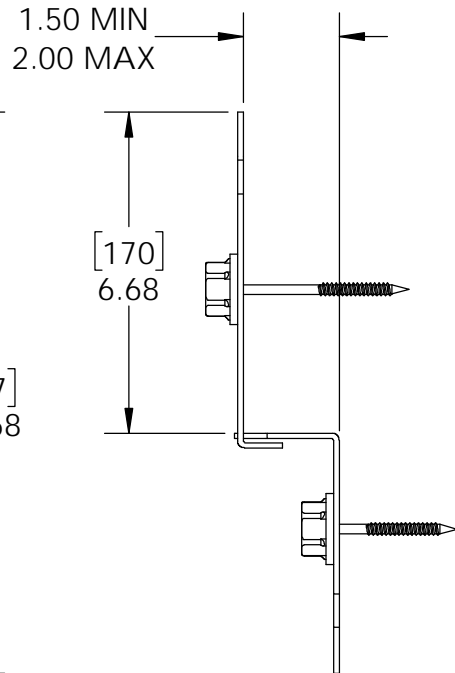
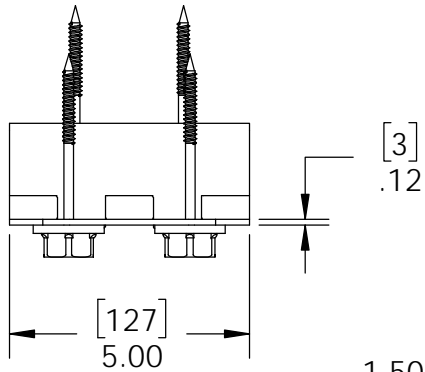

kit contains 2 assemblies

Weight: 2.38 LBS
 Scale: 1:4
 Last updated: 2/7/2018

54210

Product & Packaging Specs

Lite 8" Post 2 Beam (8- P2B-LSL)

Item #: 56610

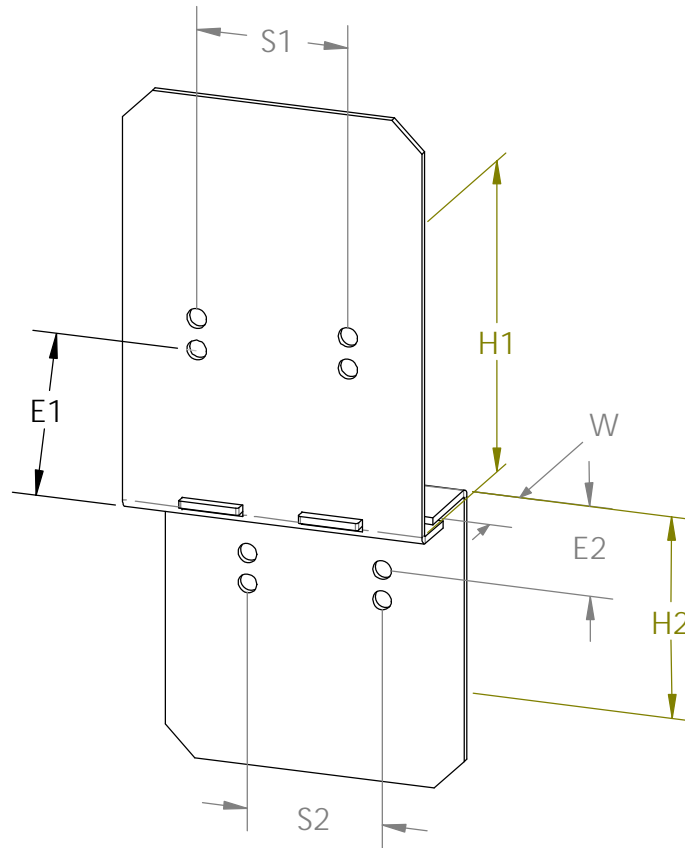

Weight: 2.36 LBS
Scale: 1:3
Last updated: 2/7/2018

54210

Product & Packaging Specs

Lite 8" Post 2 Beam (8- P2B-LSL)

Item #: Typical Installation & Basic Assembly

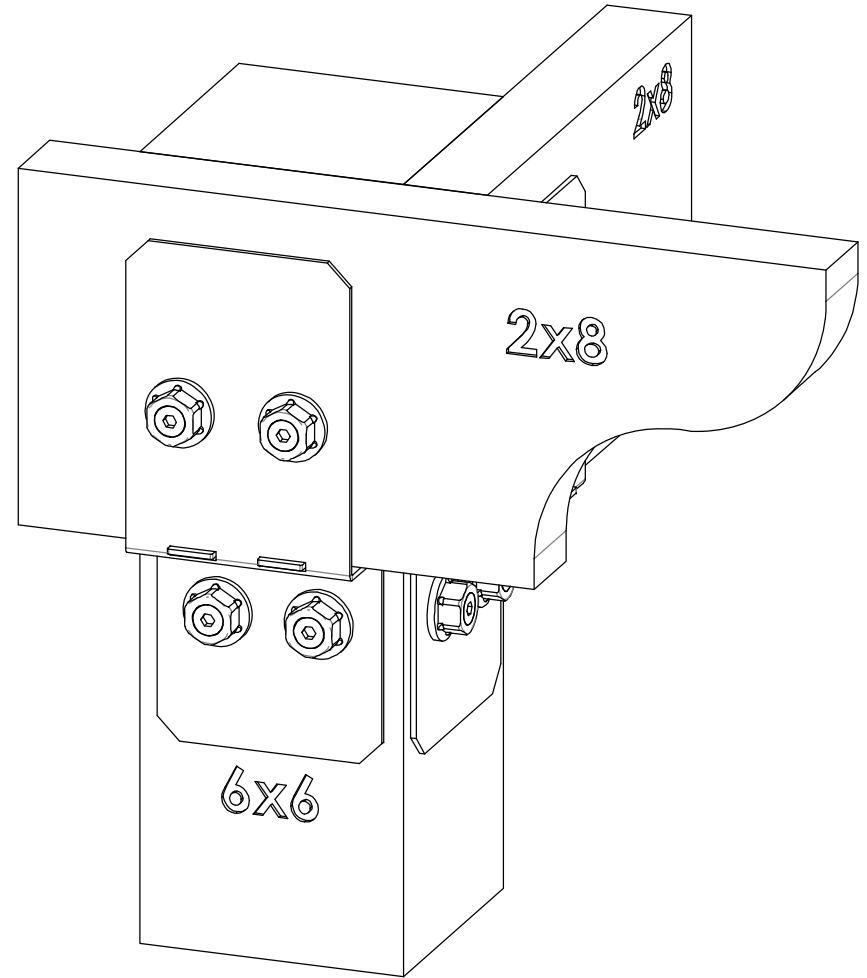
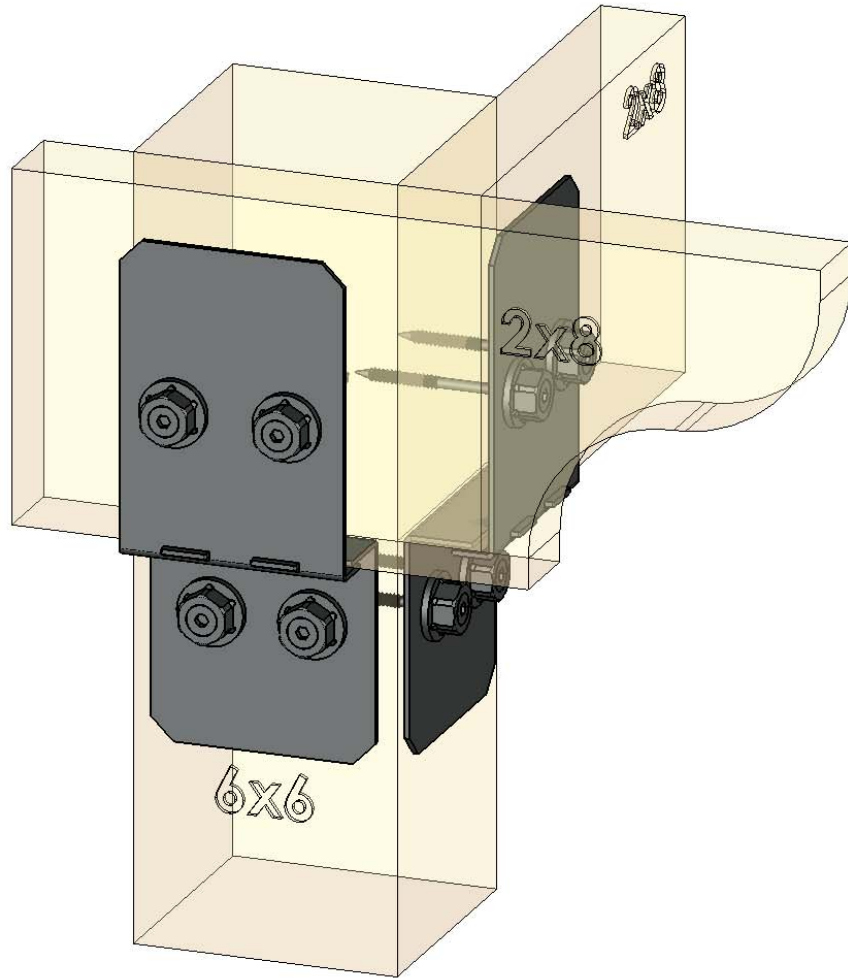

Weight: 41.32 LBS
Scale: 1:4
Last updated: 2/7/2018

54210

Product & Packaging Specs

Lite 8" Post 2 Beam (8- P2B-LSL)

Item #: Typical Installation & Basic Assembly

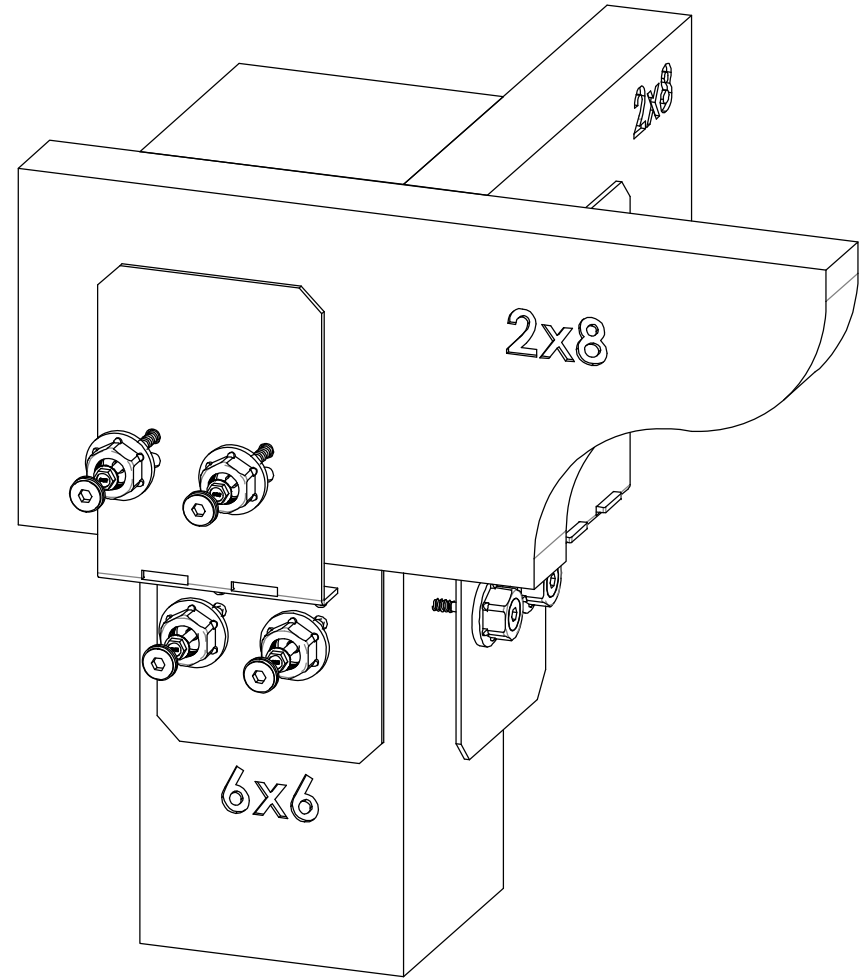
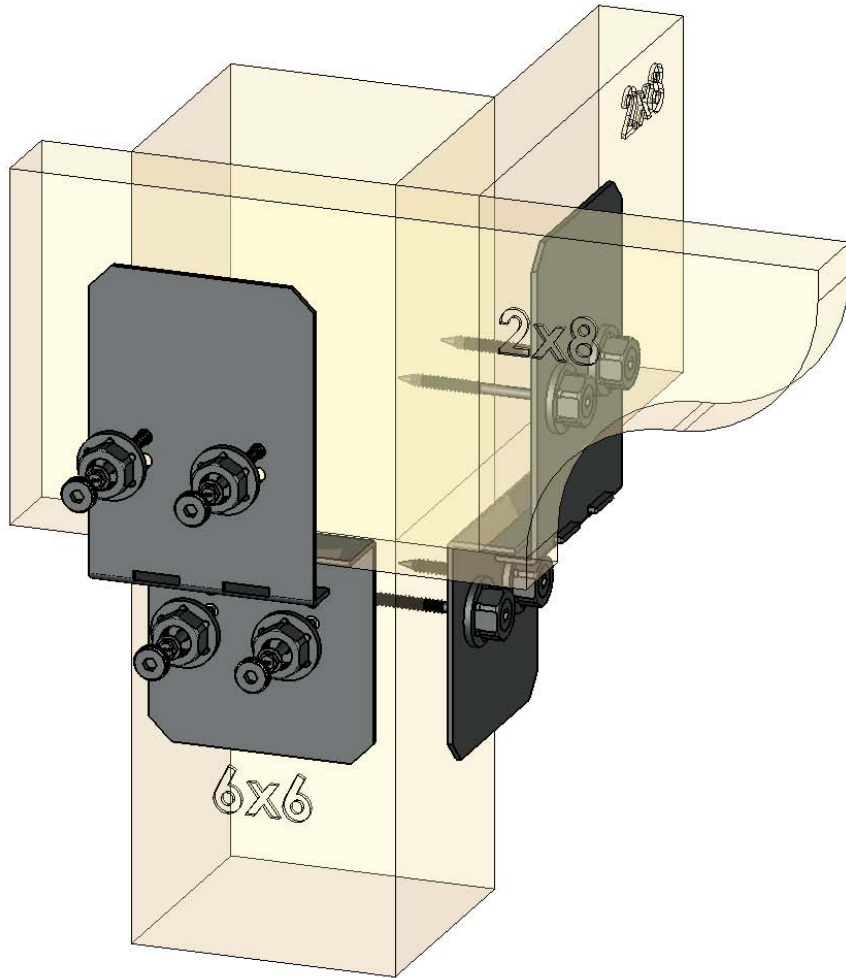

Weight: 41.32 LBS
Scale: 1:4
Last updated: 2/7/2018

54210

Product & Packaging Specs

Lite 8" Post 2 Beam (8- P2B-LSL)

Item #: Typical Installation & Basic Assembly

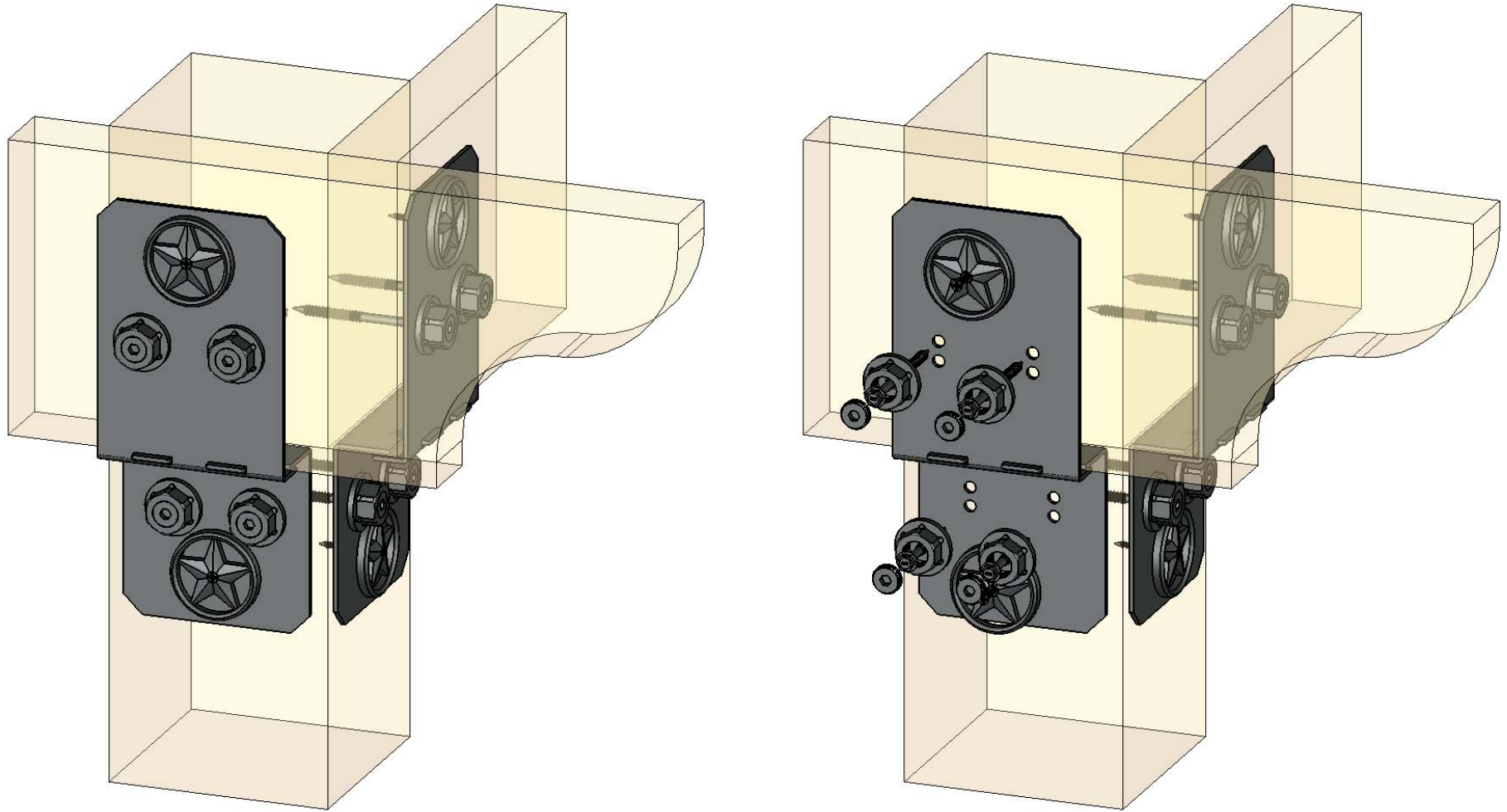

Weight: 41.59 LBS
Scale: 1:4
Last updated: 2/7/2018

54210

Product & Packaging Specs

Lite 8" Post 2 Beam (8- P2B-LSL)

Item #: Typical Installation & Basic Assembly

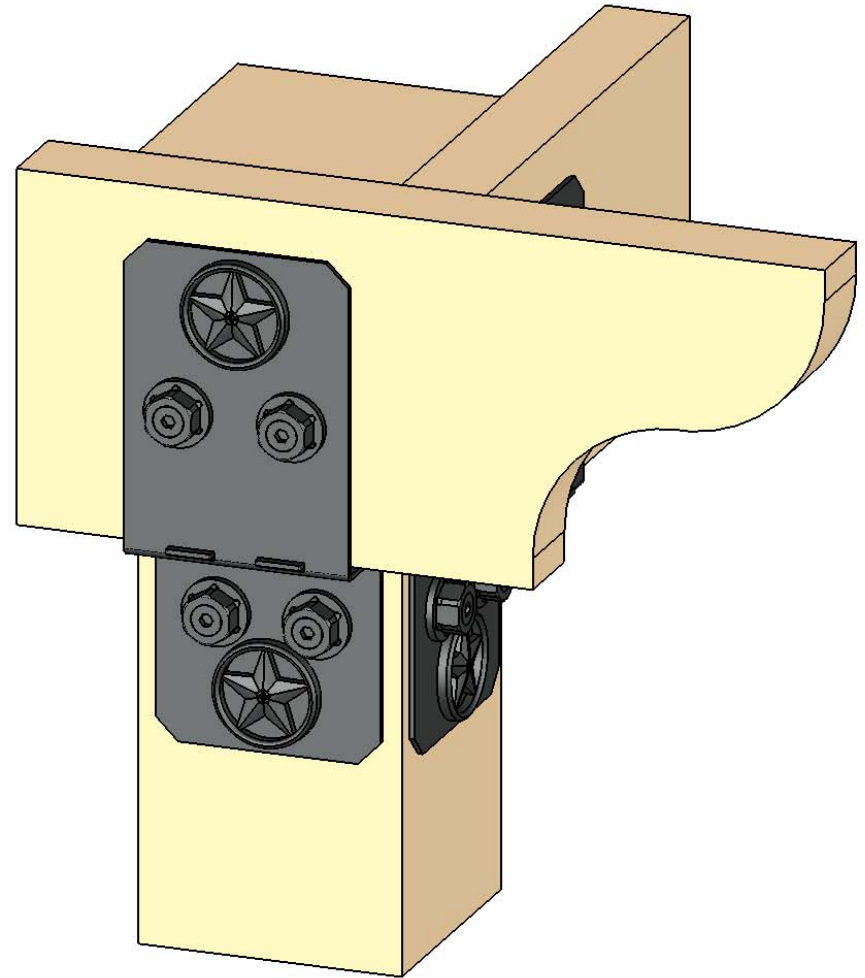
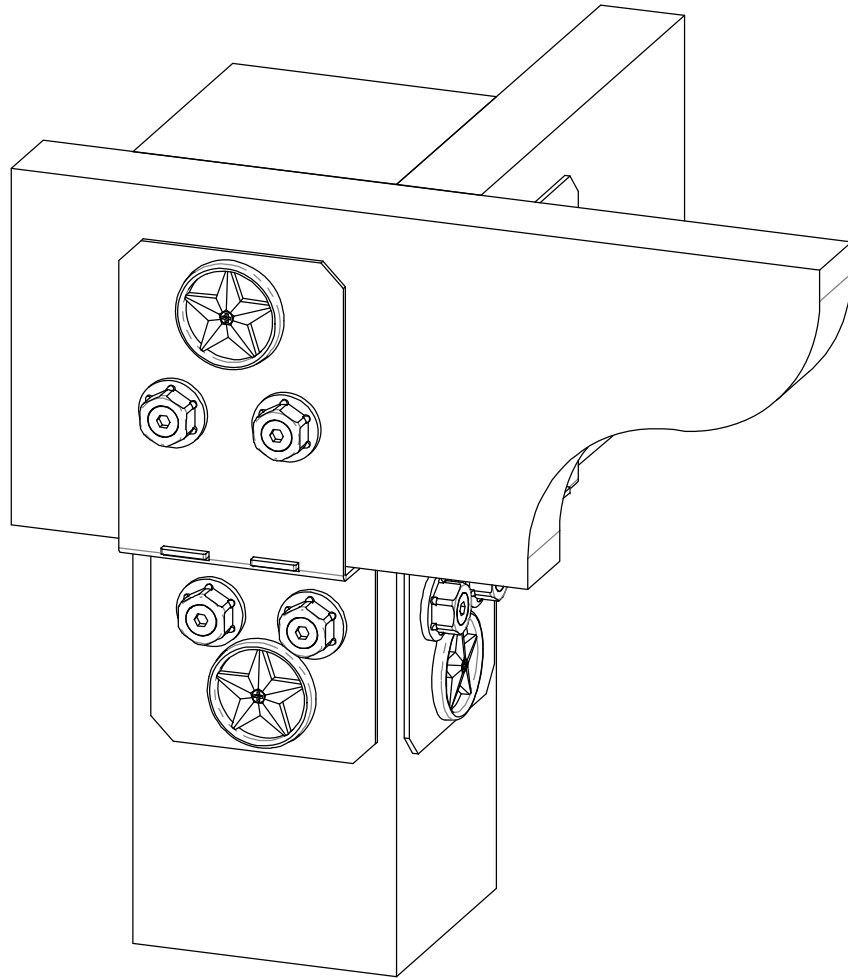

Weight: 41.59 LBS
Scale: 1:4
Last updated: 2/7/2018

54210

Product & Packaging Specs

Lite 8" Post 2 Beam (8- P2B-LSL)

Item #: Typical Installation & Basic Assembly

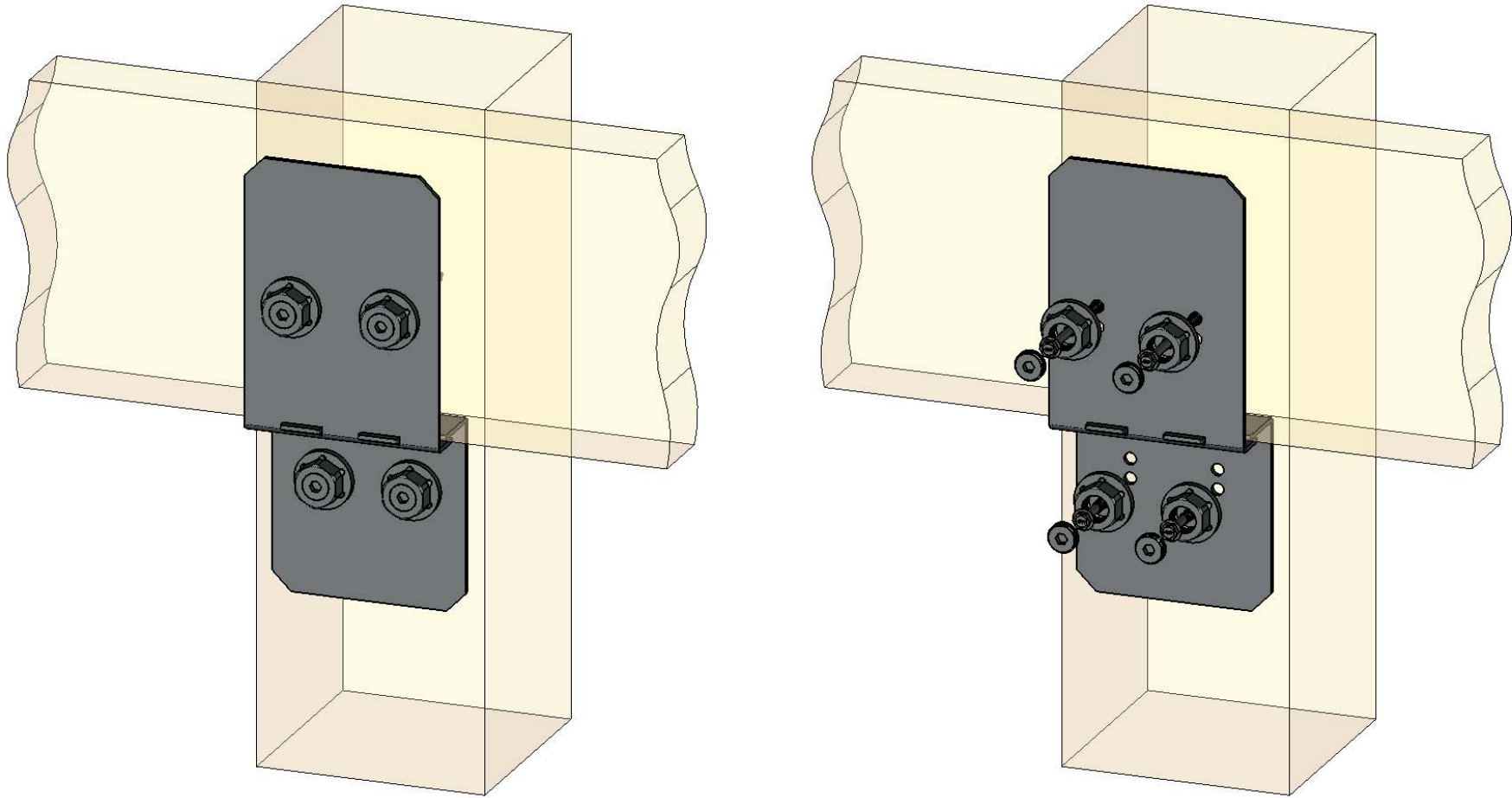

Weight: 33.32 LBS
Scale: 1:4
Last updated: 2/7/2018

54210

Product & Packaging Specs

Lite 8" Post 2 Beam (8- P2B-LSL)

Item #: Typical Installation & Basic Assembly

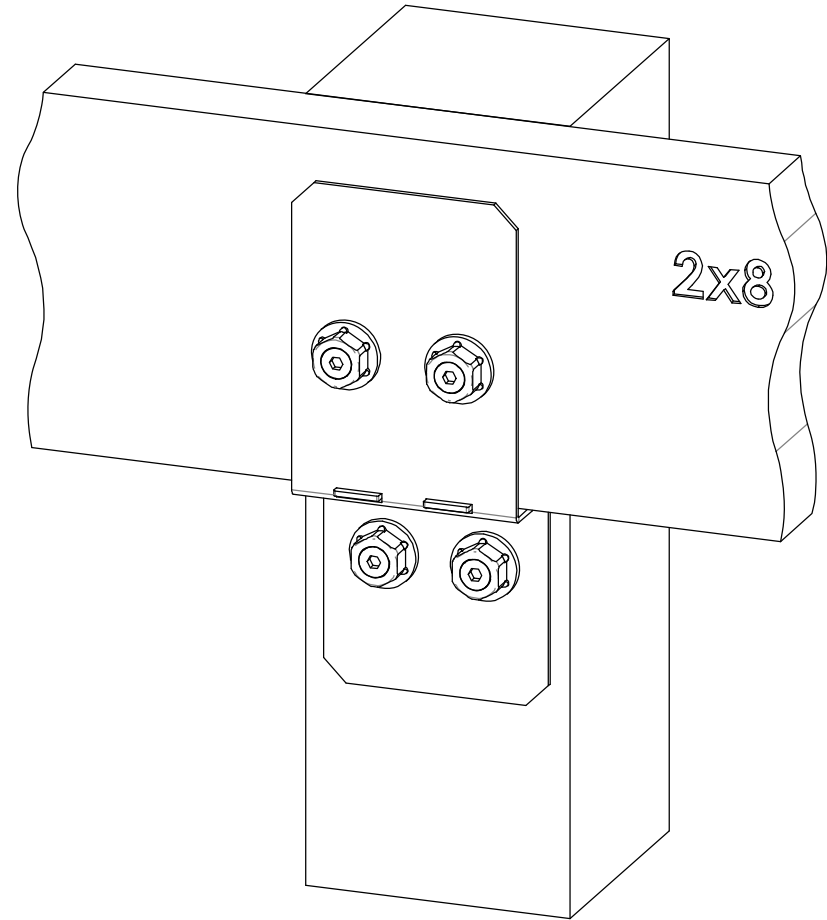
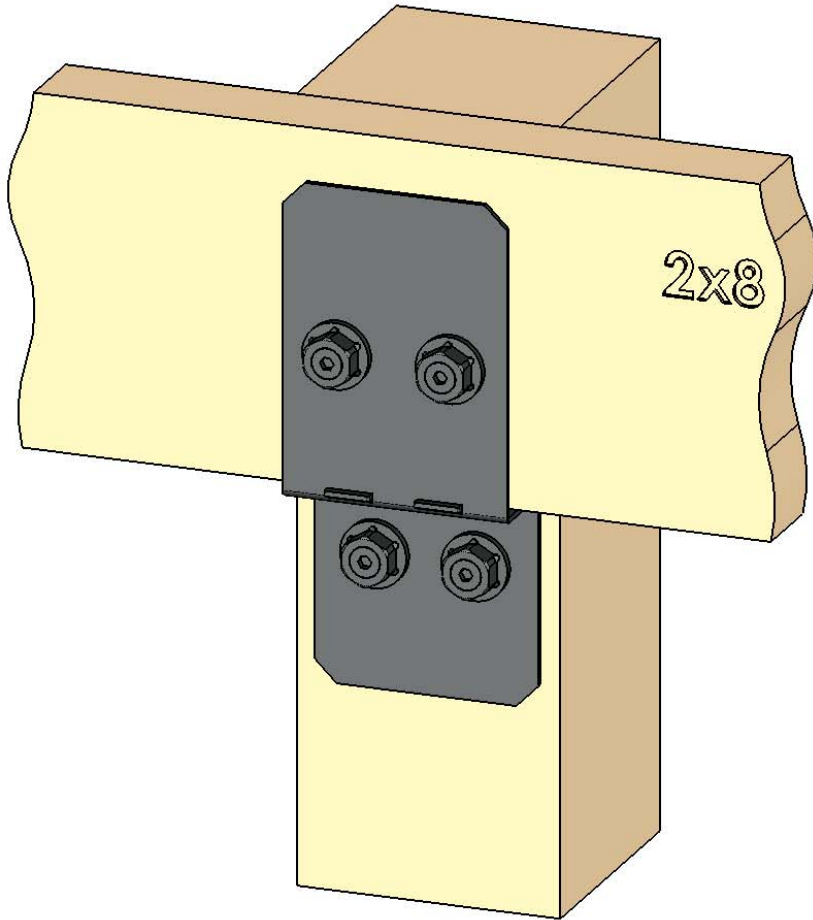

Weight: 33.32 LBS
Scale: 1:4
Last updated: 2/7/2018

54210

Product & Packaging Specs

Lite 8" Post 2 Beam (8- P2B-LSL)

Item #: Typical Installation & Basic Assembly

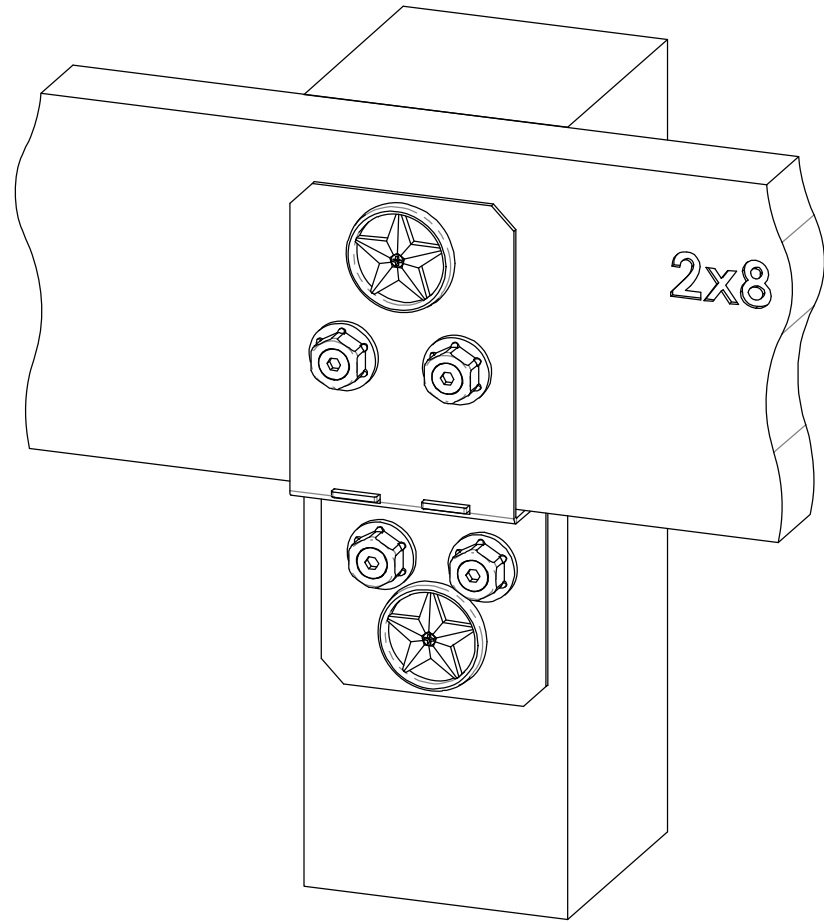
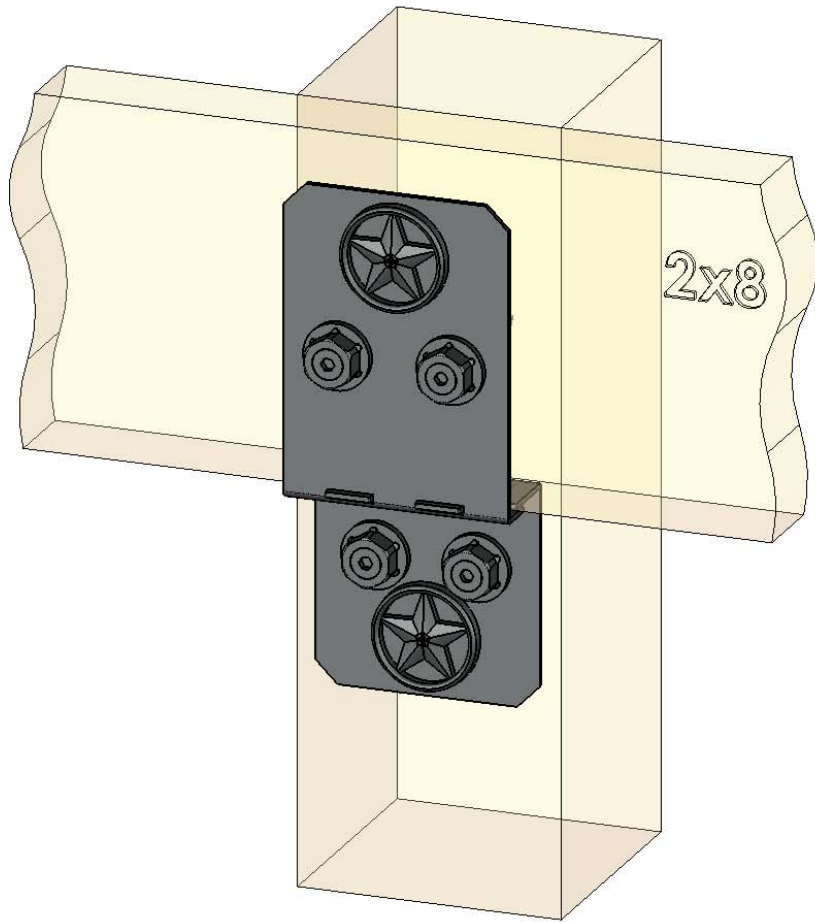

Weight: 33.45 LBS
Scale: 1:4
Last updated: 2/7/2018

54210



OZCO BUILDING PRODUCTS

Product & Packaging Specs

Lite 8" Post 2 Beam (8- P2B-LSL)

Item #: 56610

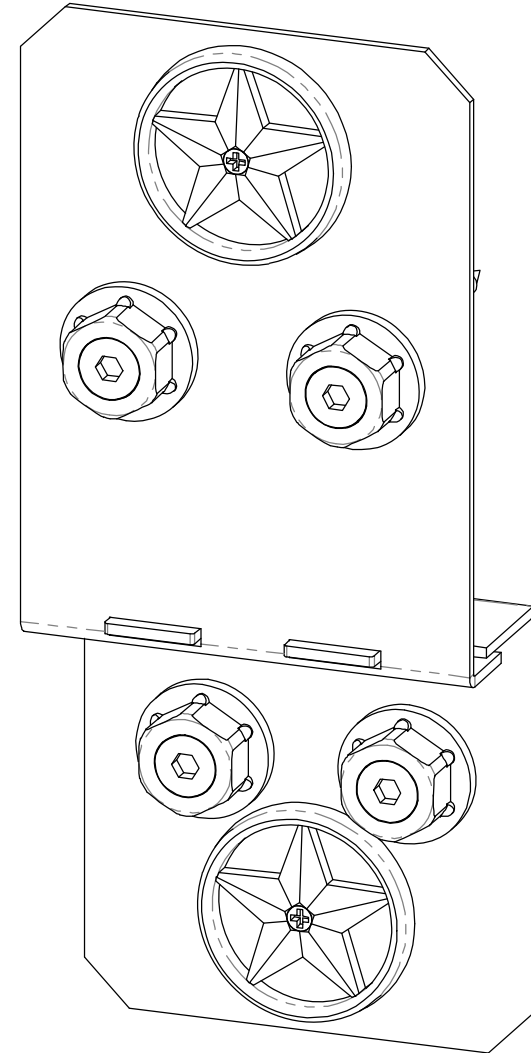
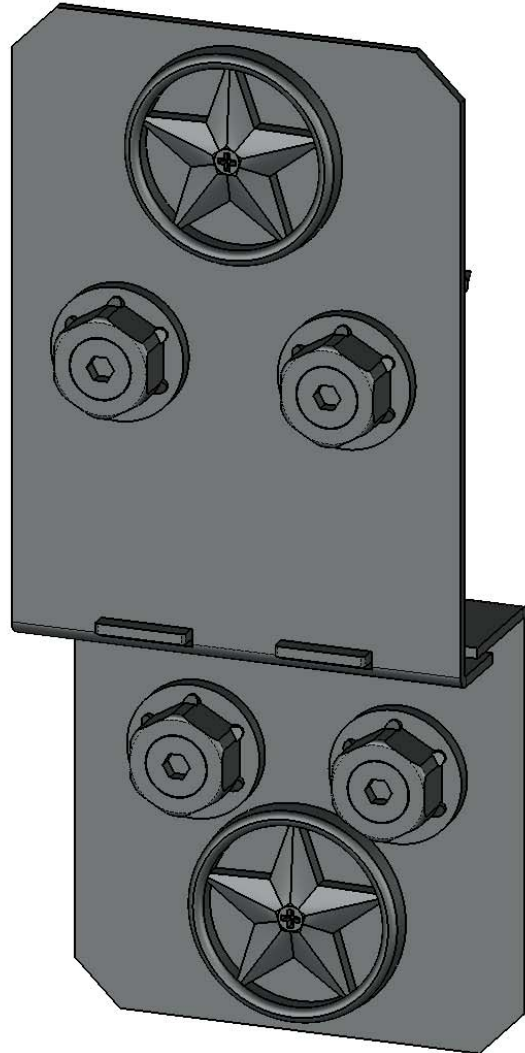

Weight: 2.75 LBS
Scale: 1:2
Last updated: 2/7/2018

54210



OZCO BUILDING PRODUCTS

Product & Packaging Specs

Box

Item #: 54210 Box

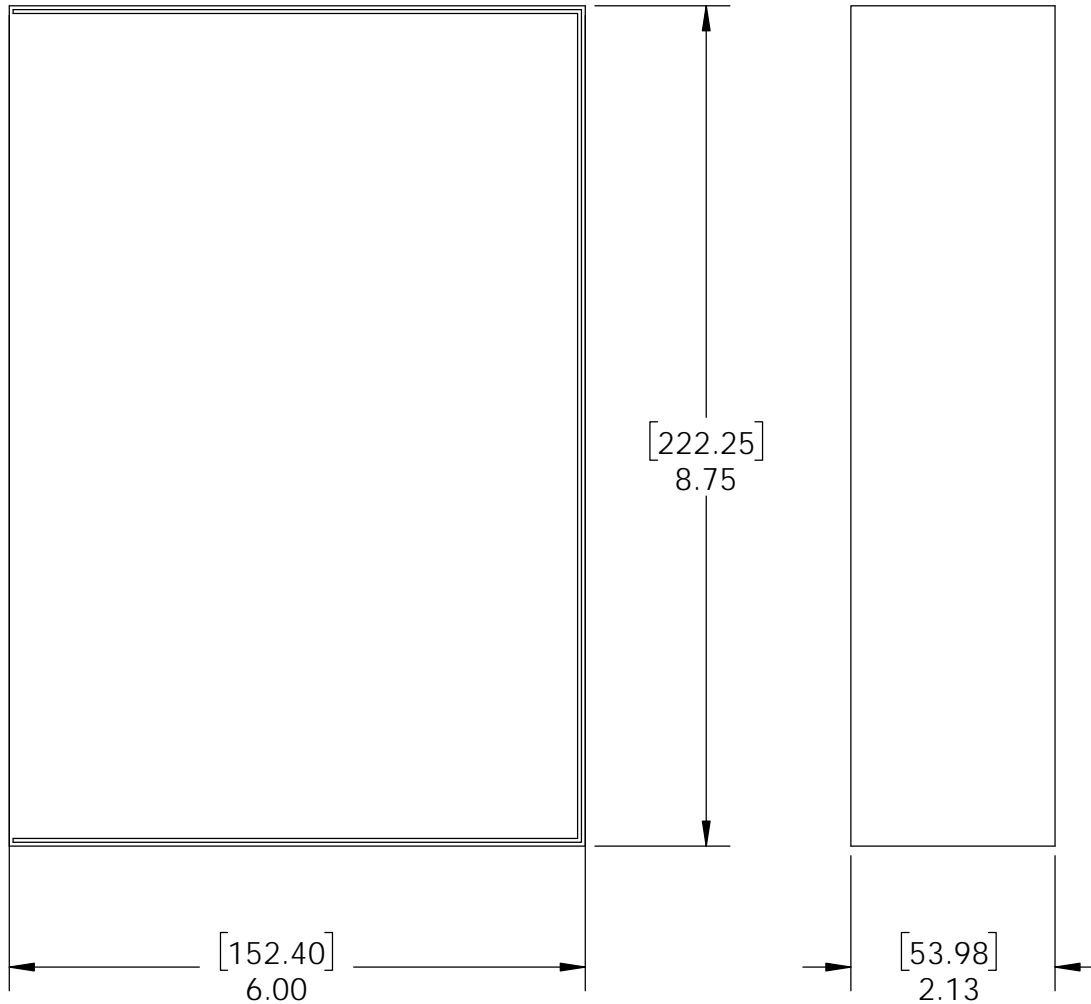

flap



Weight: 0.04 LBS
Scale: 1:2
Last updated: 2/7/2018

54210

Product & Packaging Specs

56637 Inner Box
 Item #: Box

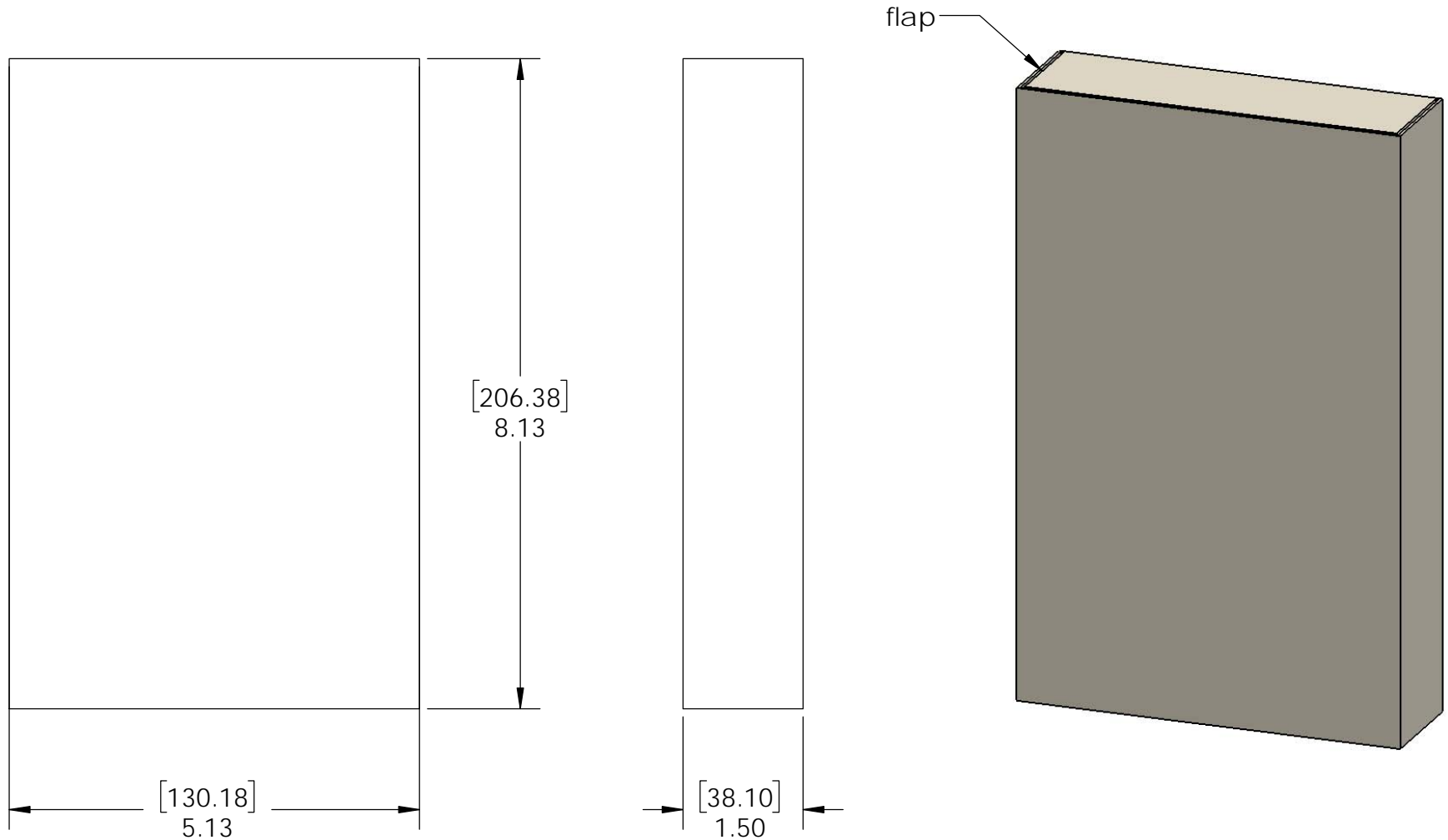

Weight: 0.03 LBS
 Scale: 1:2
 Last updated: 2/7/2018

54210

this packaging is shared with 56637

Product & Packaging Specs

56637 Inner Box Sleeve

Item #: Sleeve

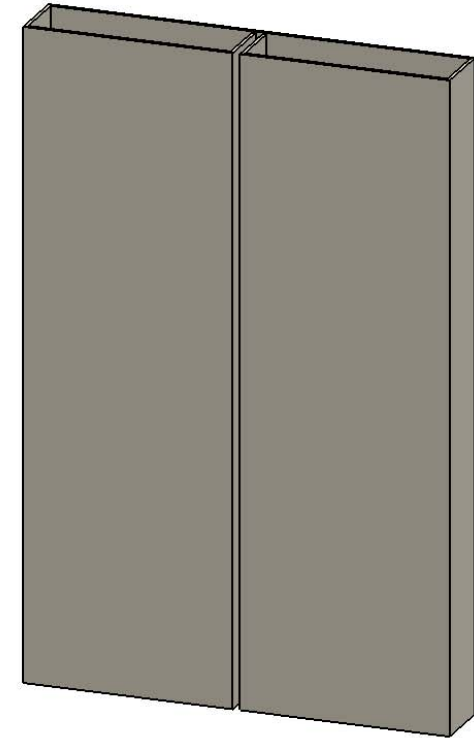
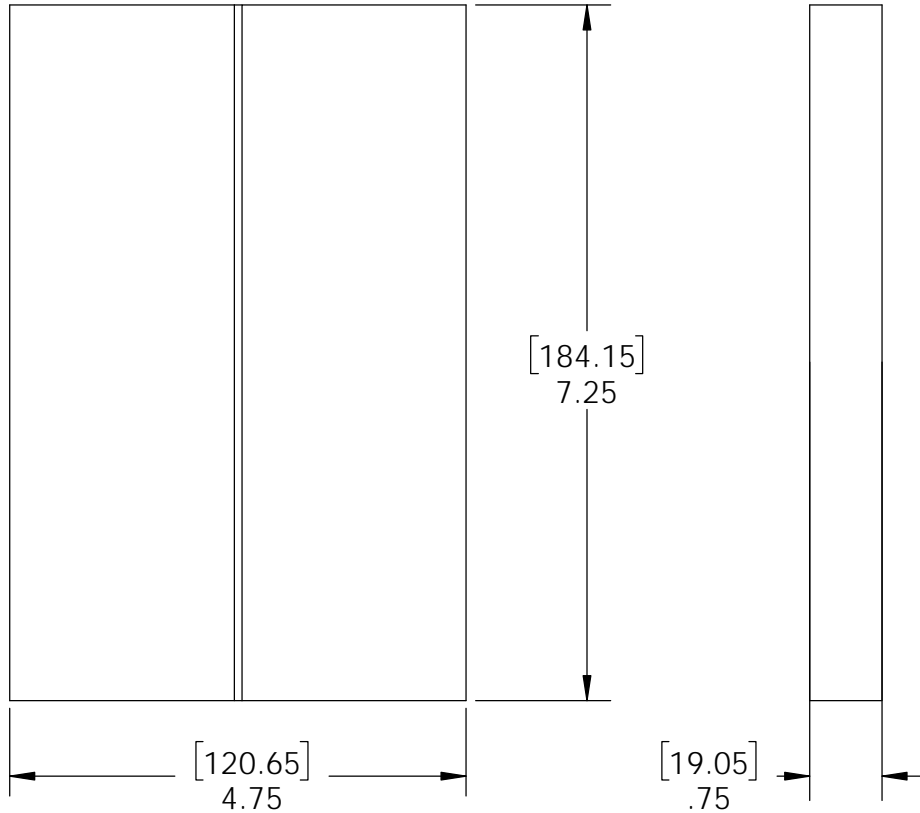
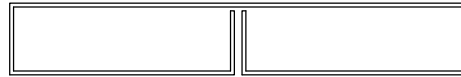

shown folded

Weight: 0.02 LBS
 Scale: 1:2
 Last updated: 2/7/2018

54210

this packaging is shared with 56637

Product & Packaging Specs

54210 Packing

Item #: Box packing

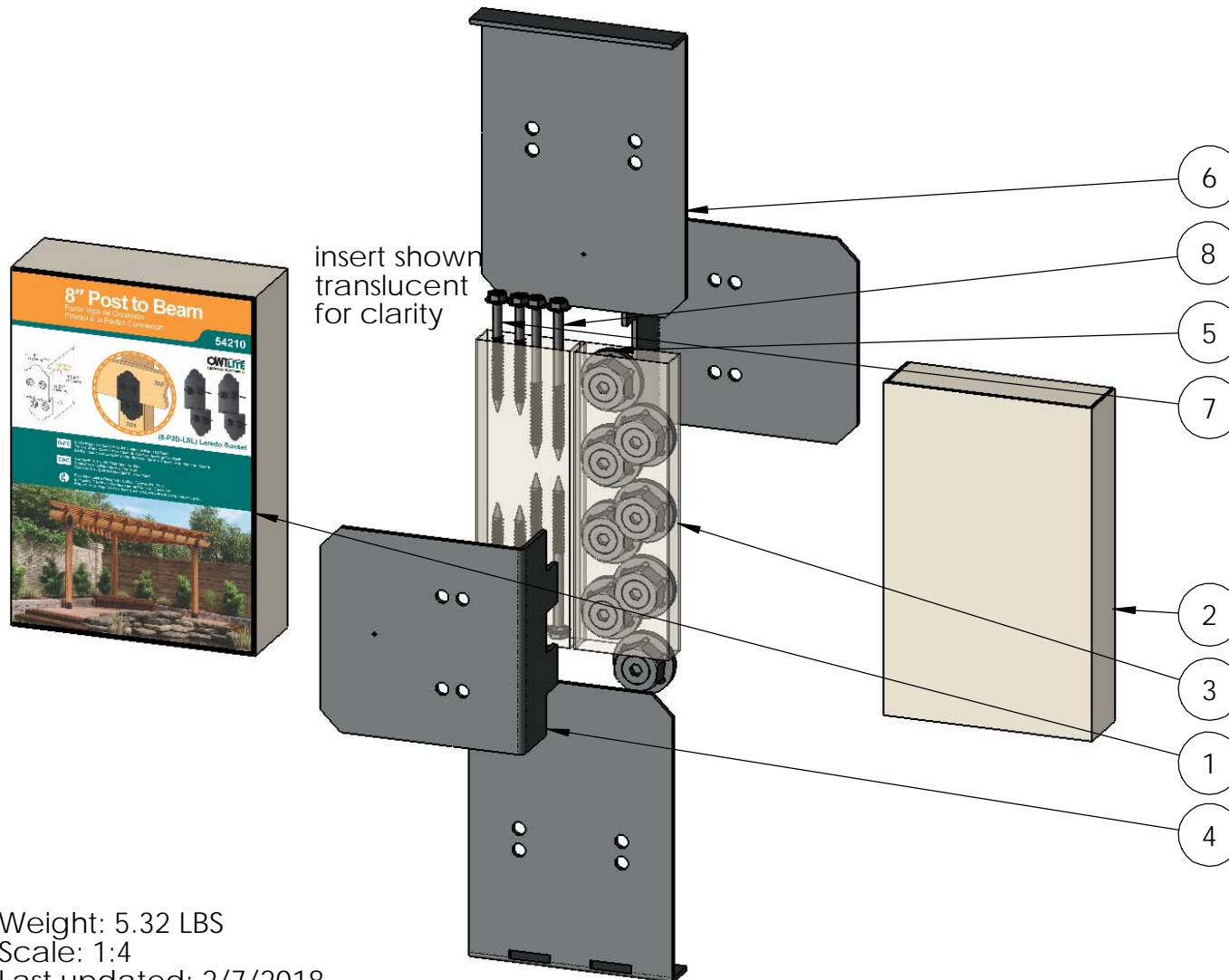

ITEM NO.	QTY.	PART NUMBER	DESCRIPTION
1	1	54210 Box	Box
2	1	56637 Inner Box	56637 Inner Box
3	1	56637 Inner Box Sleeve	56637 Inner Box Sleeve
4	2	52110-11	Ledge, Lite 8" Post 2 Beam IW
5	0.8	56621	1 1/2" Hex Cap Nut (HCN)
6	2	52110-12	Plate, Compression Lite 8" Post 2 Beam IW
7	0.08	56626	OWT Timber Screw 2-3/4"
8	0.24	56627	OWT Timber Screw 3-3/4"

Weight: 5.32 LBS
 Scale: 1:4
 Last updated: 2/7/2018

54210

Product & Packaging Specs

Case, 54210

Item #: Case

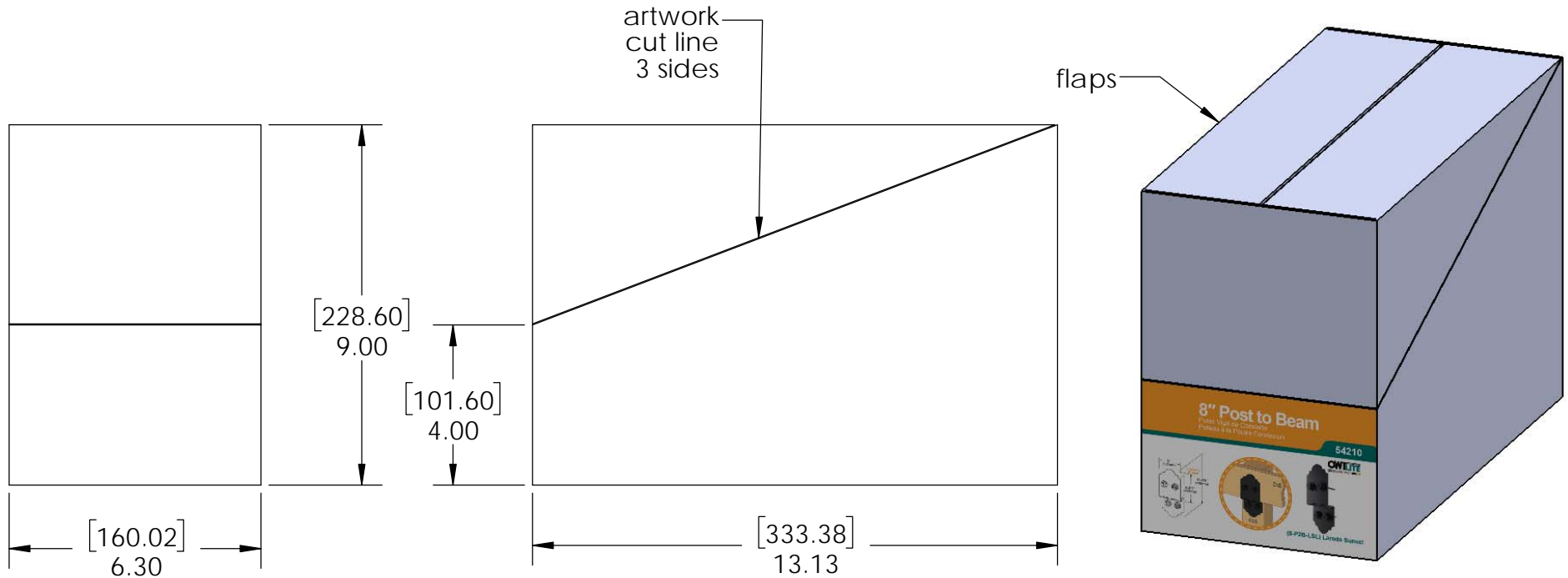

Weight: 0.23 LBS
 Scale: 1:4
 Last updated: 2/7/2018

54210

Product & Packaging Specs

54210 Packing
 Item #: Case packing

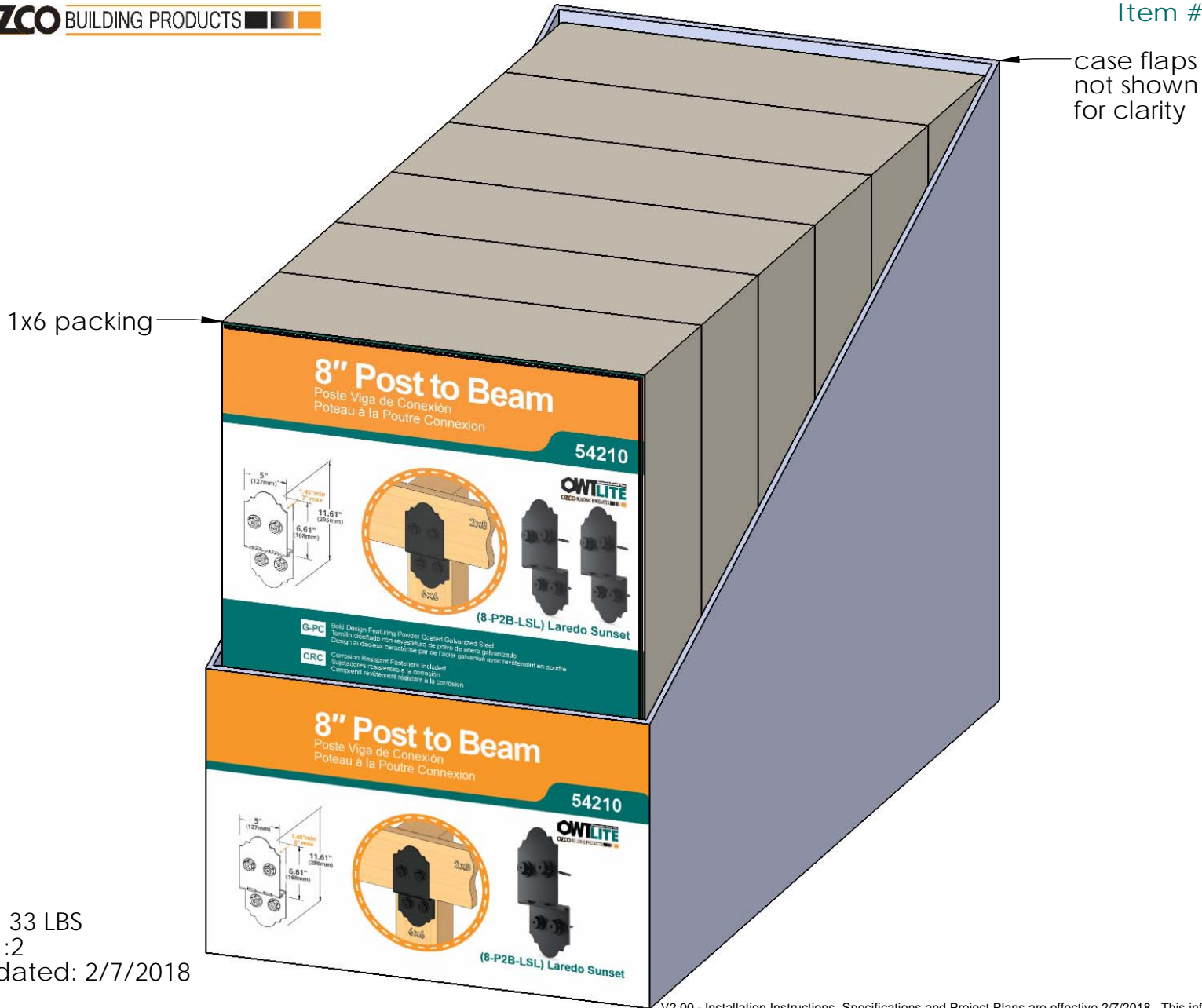

Weight: 33 LBS
 Scale: 1:2
 Last updated: 2/7/2018

54210

Product & Packaging Specs

54210 Packing

Item #: Pallet packing

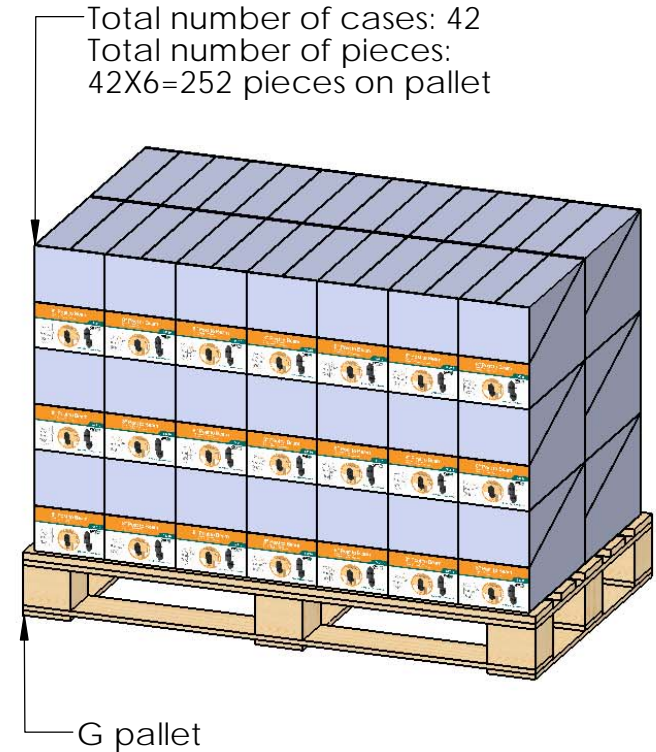
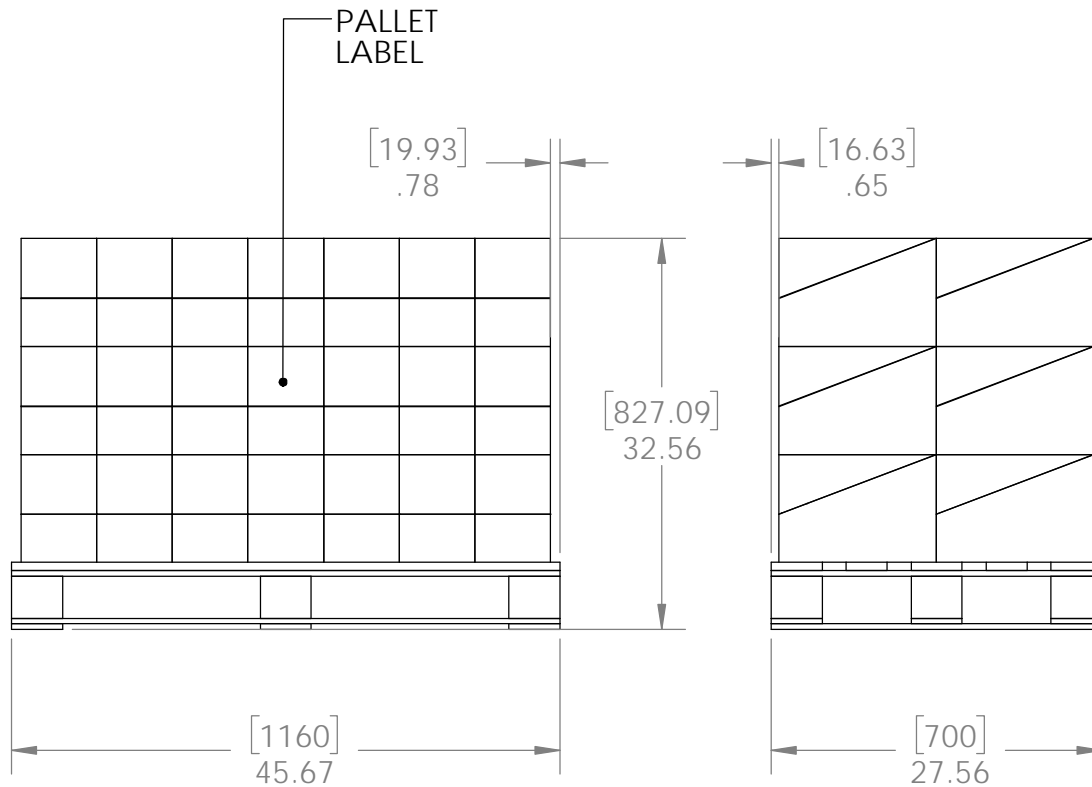

Weight: 1383 LBS
 Scale: 1:16
 Last updated: 2/7/2018

54210

additional pallet packing instructions

- plywood on top layer
- strap to pallet
- clear wrap around boxes

