

# Product & Packaging Specs

## 8" Post to Beam Coupler (P2B-SB-IW)

Item #: 51777

ITEM NO.	QTY.	PART NUMBER	DESCRIPTION
1	0.08	56626	OWT Timber Screw 2-3/4"
2	0.2	56621	1 1/2" Hex Cap Nut (HCN)
3	1	51710-11	Ledge, Post to Beam
4	1	51777-11	Plate, 8" Post to Beam

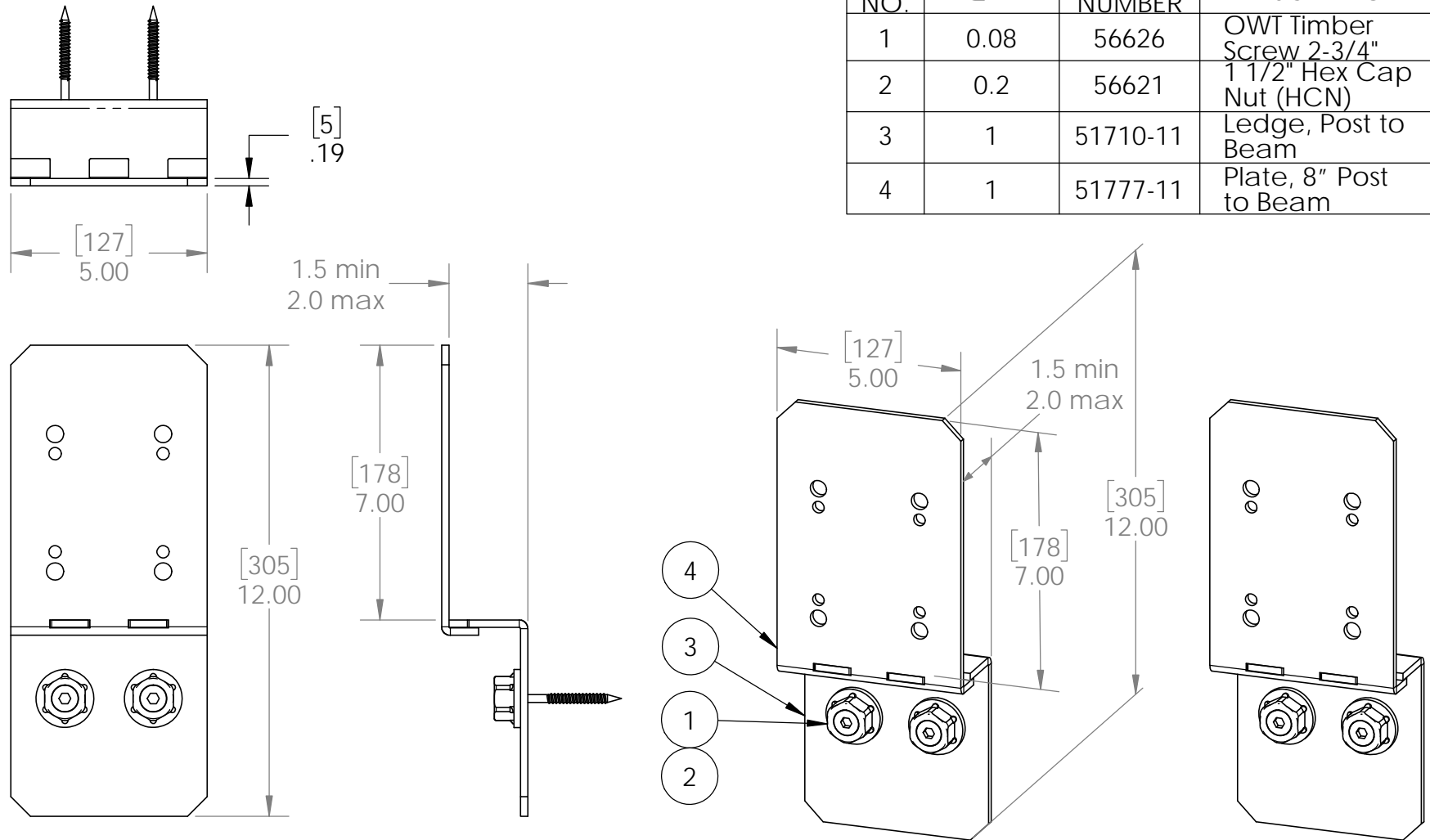

Weight: 3.90 LBS  
Scale: 1:4  
Last updated: 10/10/2016

51777

# Product & Packaging Specs

## 8" Post to Beam Coupler (P2B-SB-IW)

Item #: 51777

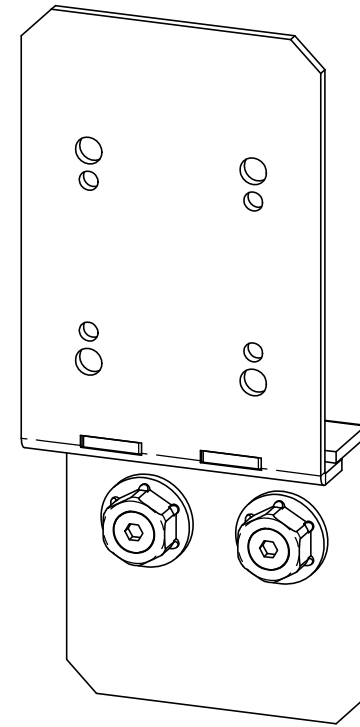
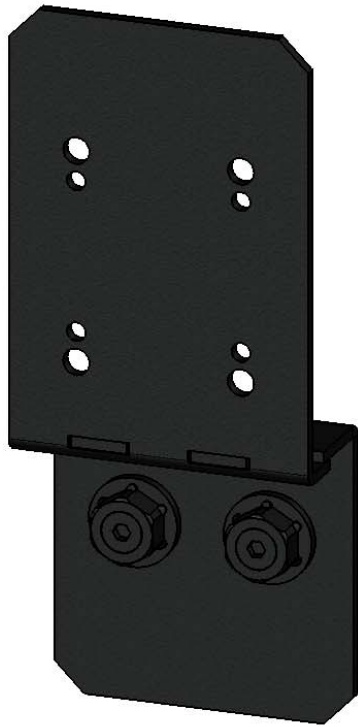

Weight: 3.90 LBS  
Scale: 1:3  
Last updated: 10/10/2016

51777

# Product & Packaging Specs

## 8" Post to Beam Coupler (P2B-SB-IW)

Item #: Typical Installation & Basic Assembly

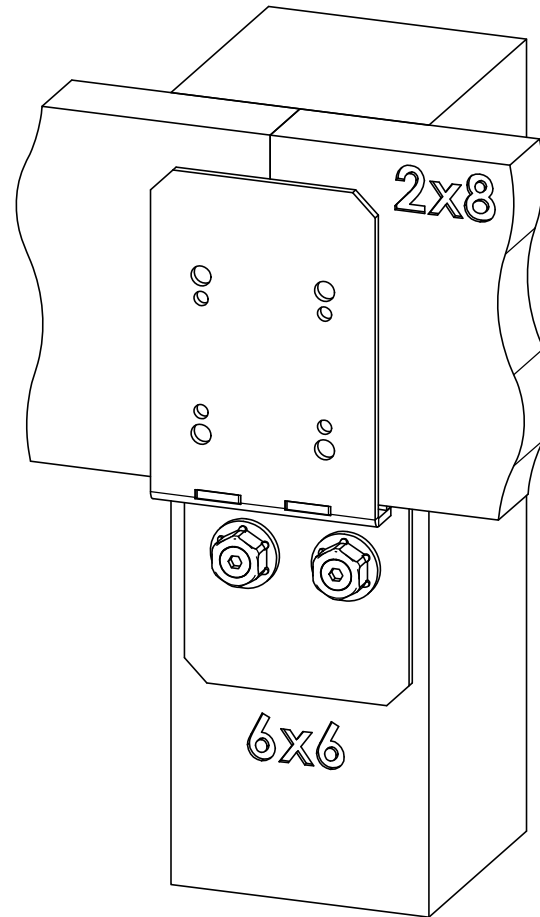
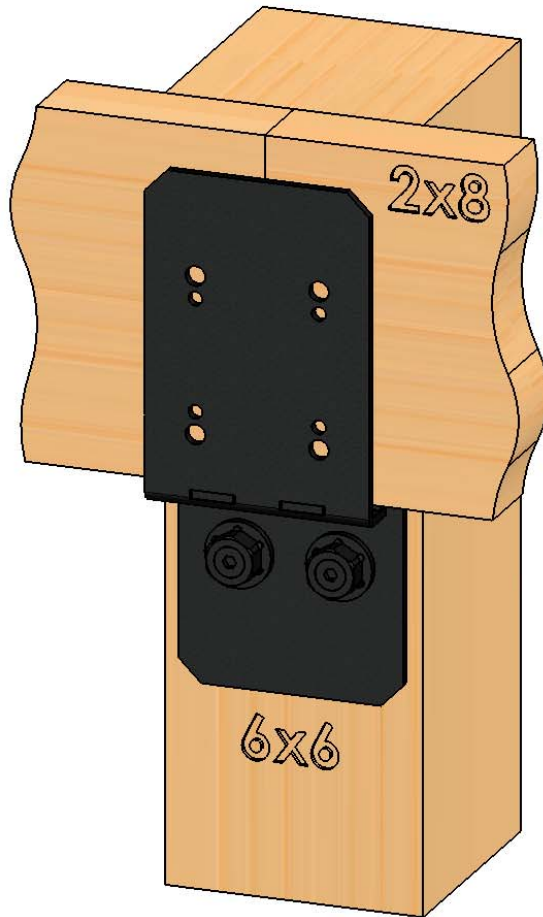

Weight: 30.10 LBS  
Scale: 1:4  
Last updated: 10/10/2016

51777

# Product & Packaging Specs

## 8" Post to Beam Coupler (P2B-SB-IW)

Item #: Typical Installation & Basic Assembly

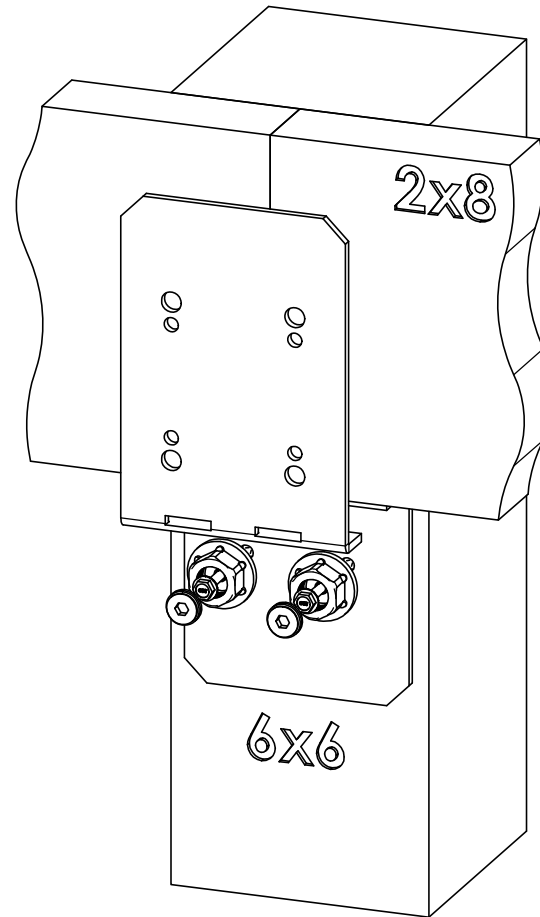
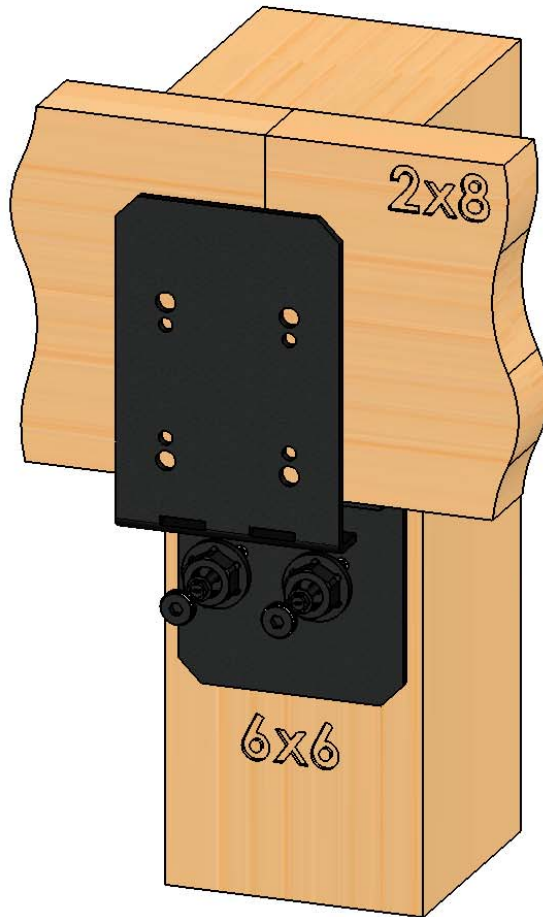

Weight: 30.10 LBS  
Scale: 1:4  
Last updated: 10/10/2016

51777

# Product & Packaging Specs

## 8" Post to Beam Coupler (P2B-IW-LS)

Item #: Typical Installation & Basic Assembly with Timber Bolts

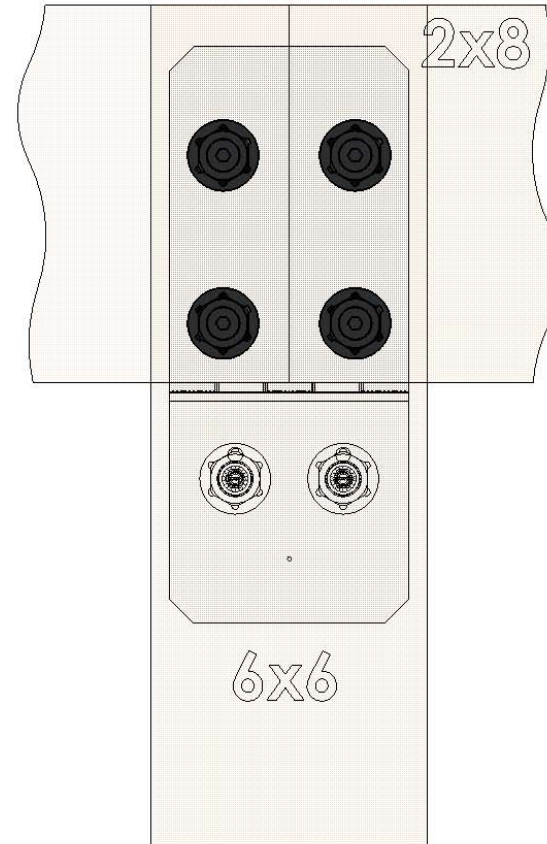
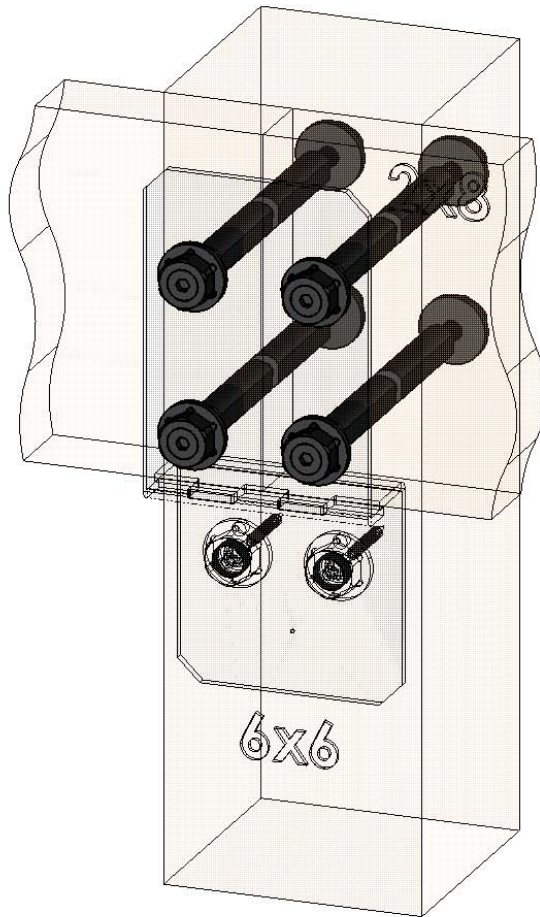

Weight: 31.89 LBS  
Scale: 1:4  
Last updated: 10/10/2016

**UPPER TIMBER BOLTS &/OR SCREWS SOLD SEPARATELY**



# Product & Packaging Specs

## 8" Post to Beam Coupler (P2B-IW-LS)

Item #: Typical Installation & Basic Assembly with Timber Screws

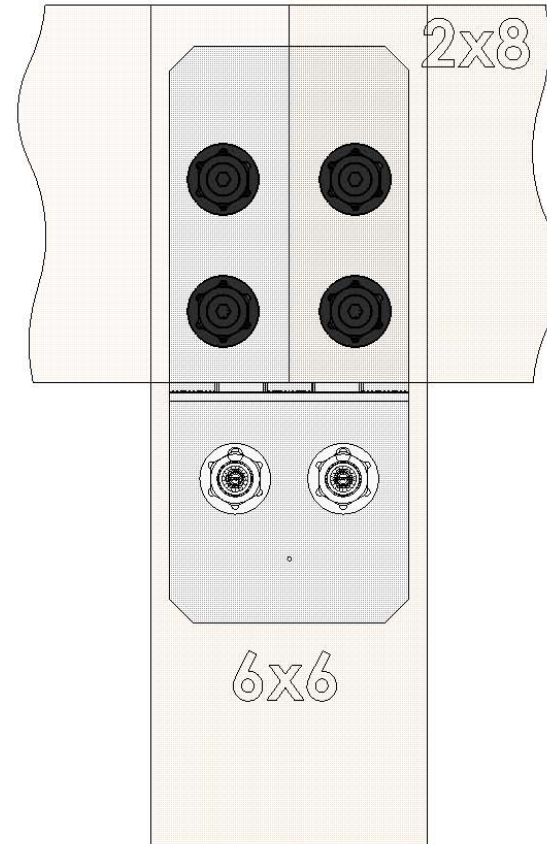
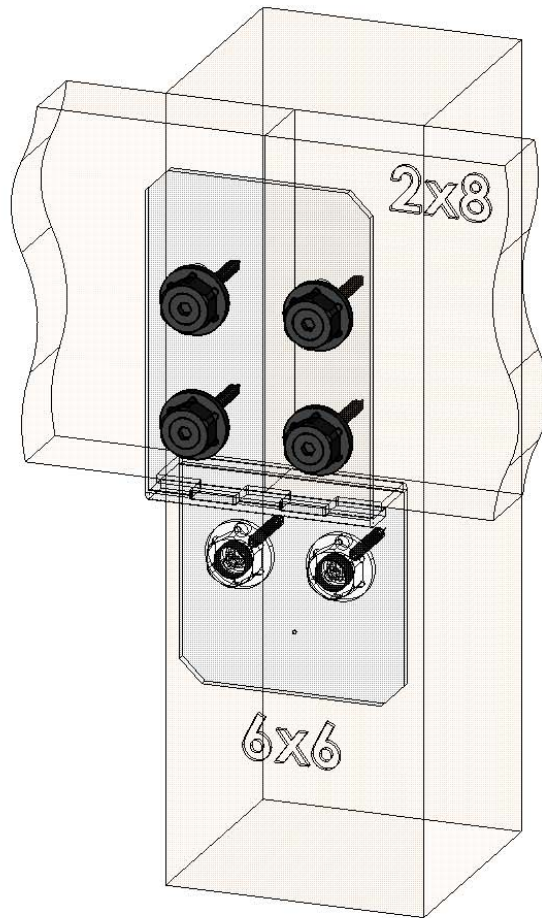

Weight: 30.42 LBS  
Scale: 1:4  
Last updated: 10/10/2016

**UPPER TIMBER BOLTS &/OR SCREWS SOLD SEPARATELY**

# Product & Packaging Specs

## 8" Post to Beam Coupler (P2B-SB-IW)

Item #: Typical Installation & Basic Assembly

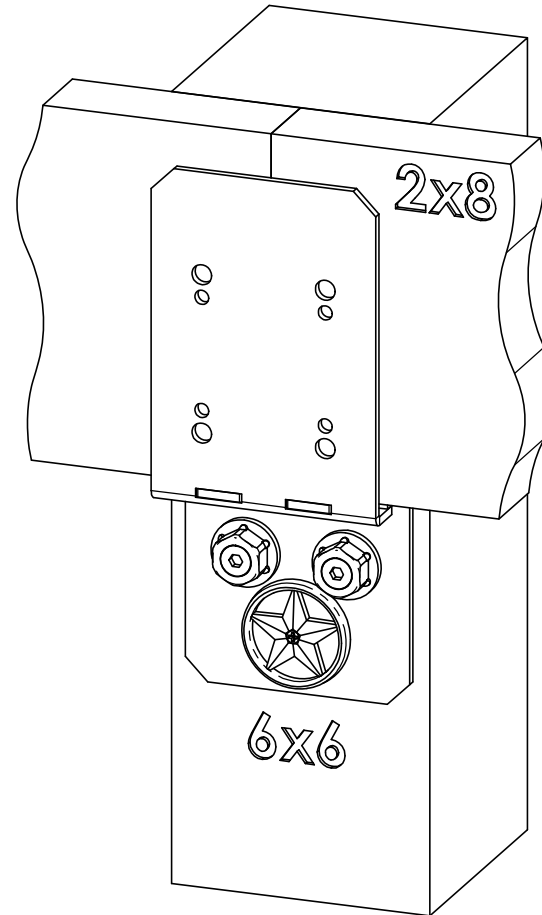
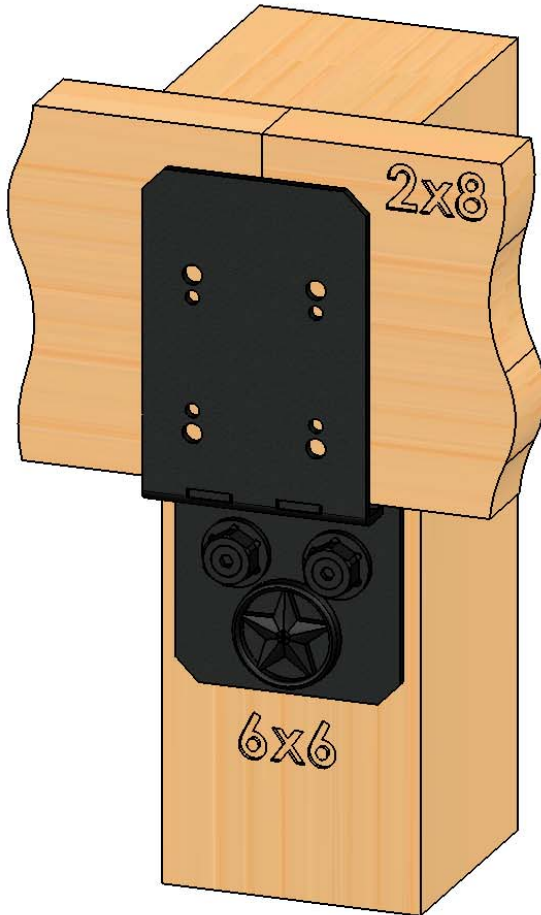

Weight: 30.17 LBS  
Scale: 1:4  
Last updated: 10/10/2016

**STARS SOLD SEPARATELY**

51777

# Product & Packaging Specs

## 8" Post to Beam Coupler (P2B-IW-LS)

Item #: 51777

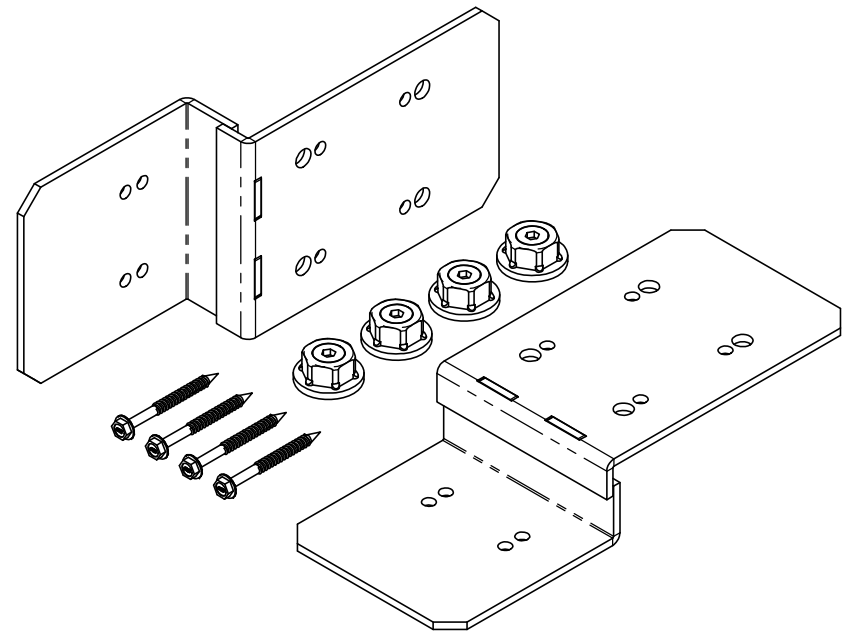

Weight: 7.80 LBS  
Scale: 1:4  
Last updated: 10/10/2016

51777



# Product & Packaging Specs

## 51777 Packing

Item #: Box packing

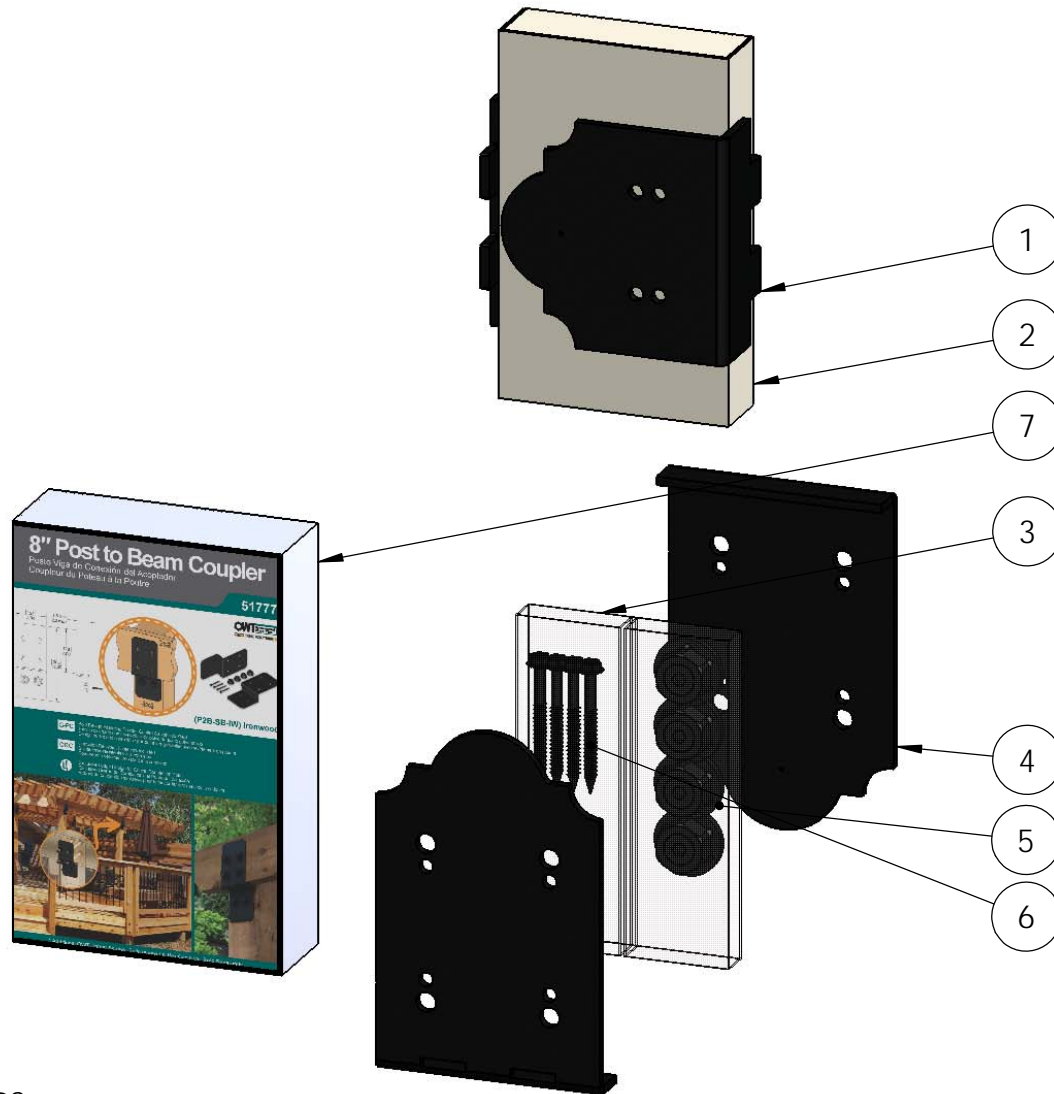

ITEM NO.	QTY.	PART NUMBER	DESCRIPTION
1	2	56610-11	Ledge, Post to Beam
2	1	Box, 56677	Box, 56677
3	1	Inner Insert, 56677	Inner Insert, 56677
4	2	56677-11	Plate, 8" Post to Beam
5	0.4	56621	1 1/2" Hex Cap Nut (HCN)
6	0.16	56626	OWT Timber Screw 2-3/4"
7	1	Box, 51777	Box, 51777

Weight: 7.30 LBS  
Scale: 1:2  
Last updated: 10/10/2016

51777

# Product & Packaging Specs

## 51777 Packing

Item #: Case packing

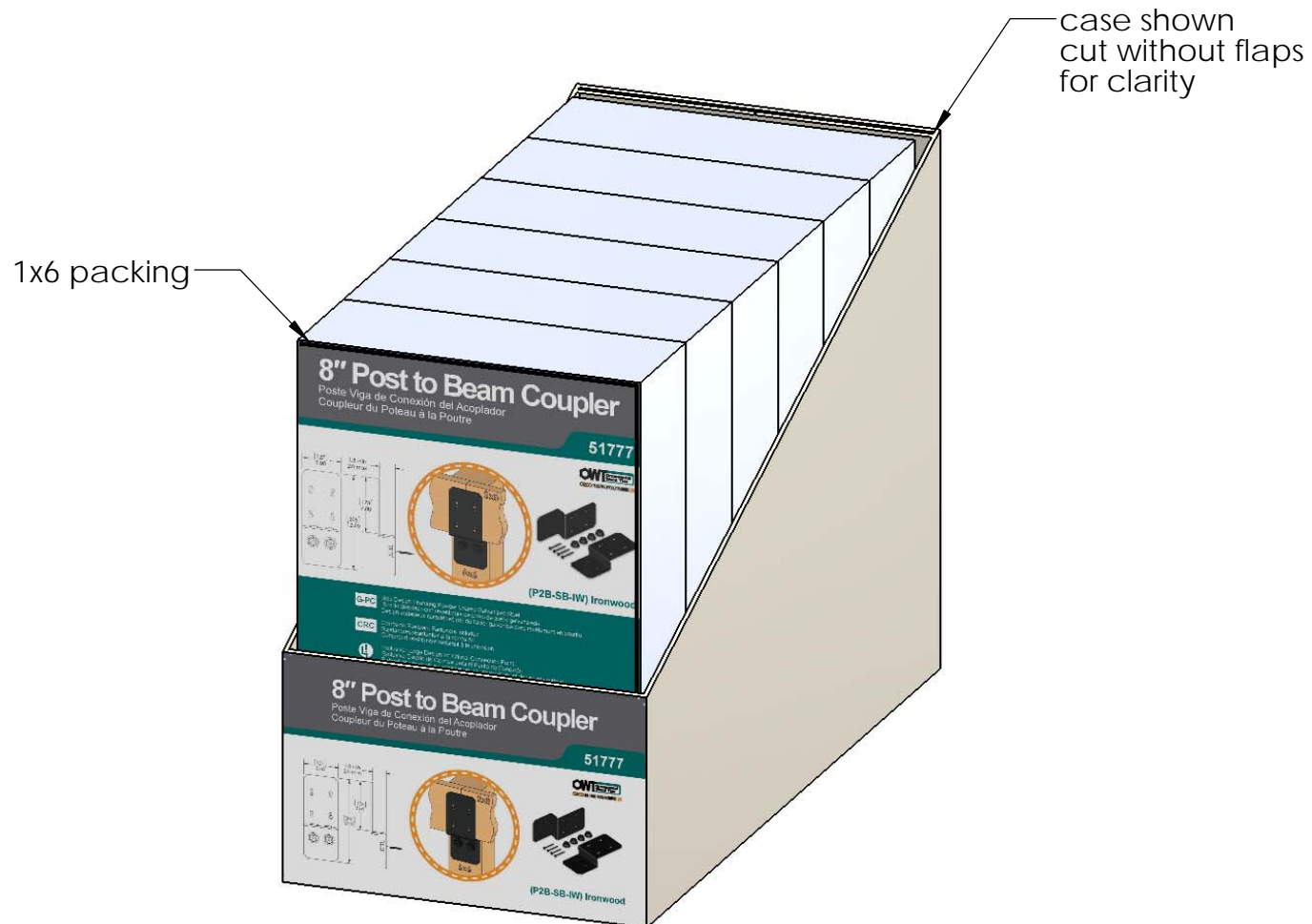

Weight: 45 LBS  
Scale: 1:3  
Last updated: 10/10/2016

51777

# Product & Packaging Specs

## 51777 Packing

Item #: Pallet packing

ADD PALLET LABEL

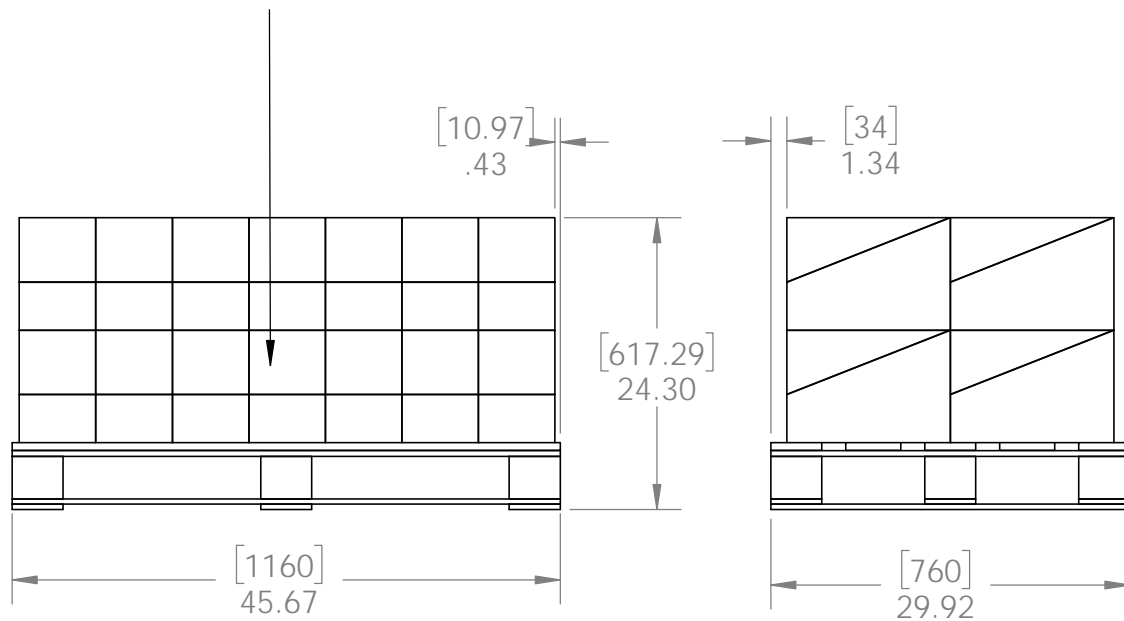

Total number of cases: 28  
Total number of pieces:  
28x6=168 pieces on pallet

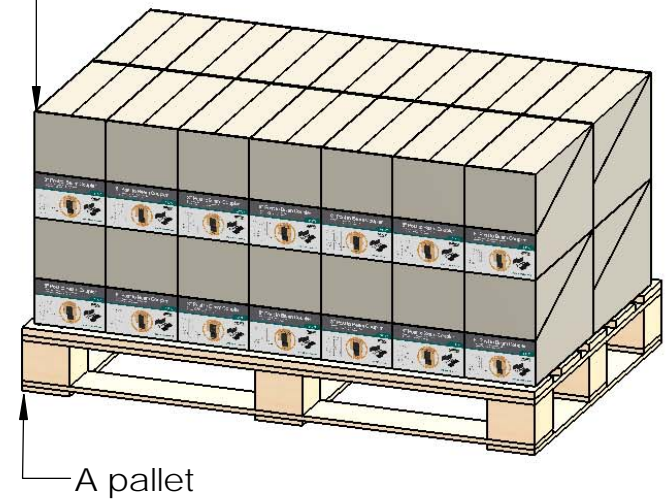

additional pallet packing instructions  
plywood on top layer  
strap to pallet  
clear wrap around boxes

Weight: 600 LBS  
Scale: 1:16  
Last updated: 10/10/2016

51777