

DESIGN

PURCHASE

CONSTRUCT

ENJOY

**Installation Instructions,
56677 8" Post to Beam Coupler (P2B-SB-LS)
51777 8" Post to Beam Coupler (P2B-SB-IW)**

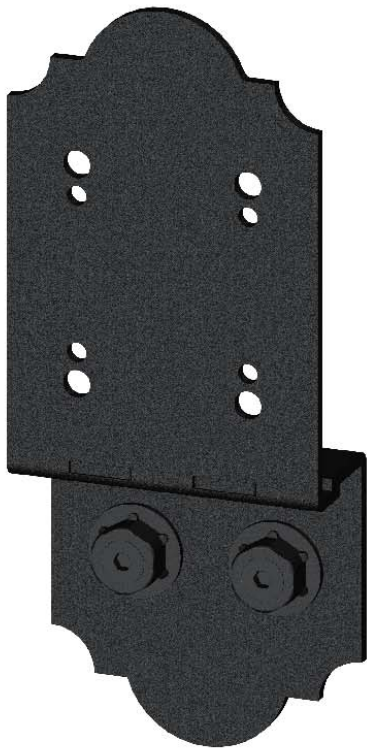

56677



51777

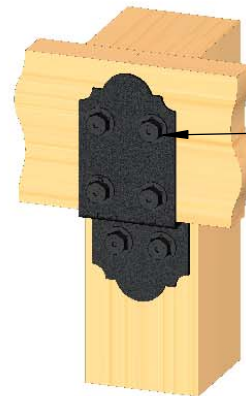

upper fasteners sold separately;
OWT Timber Screws or OWT Timber Bolts

Typical Installation
Laredo Sunset shown



OZCO BUILDING PRODUCTS



Printing Documents from ISSUU

Unfortunately, there is currently no way to print content directly through issuu. To print a publication, you will need to download it and print it from your computer.

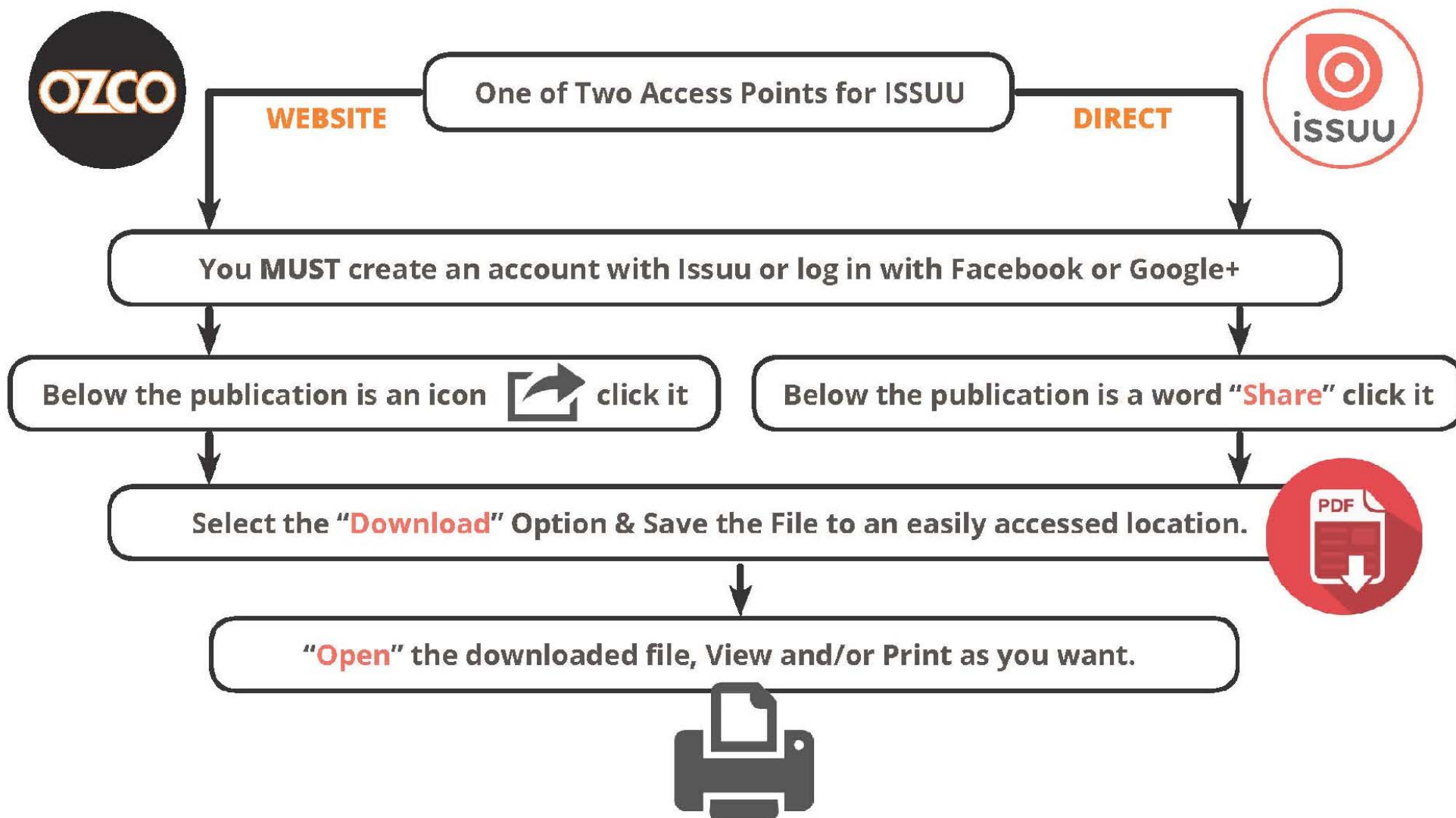

Laredo Sunset & Ironwood



Laredo Sunset
(566XX series)

2 great styles
Same functionality

choose your
connection lifestyle

both styles available for
most products

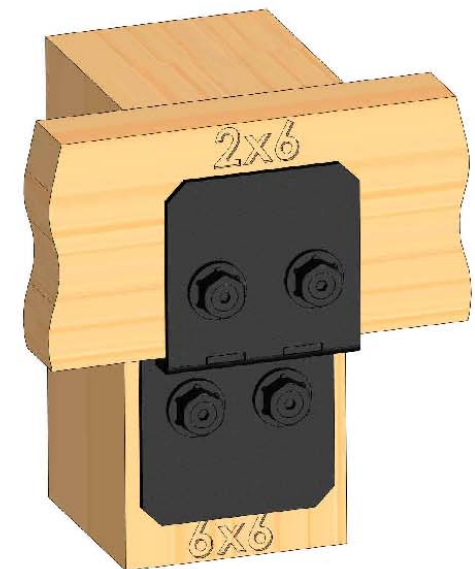

Ironwood
(517XX series)



OZCO BUILDING PRODUCTS

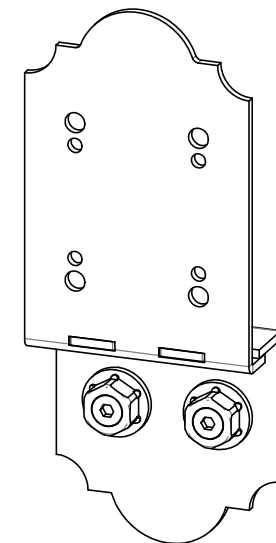
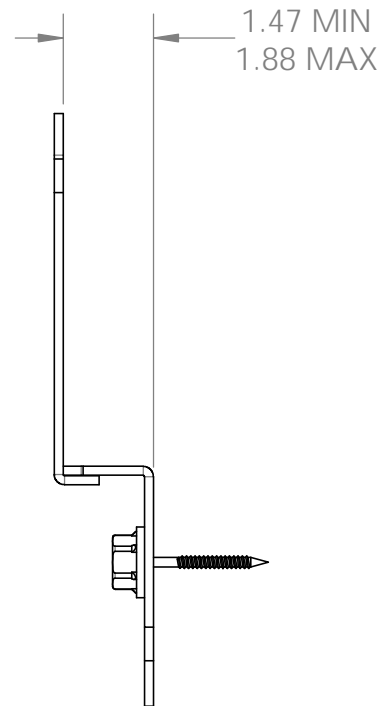
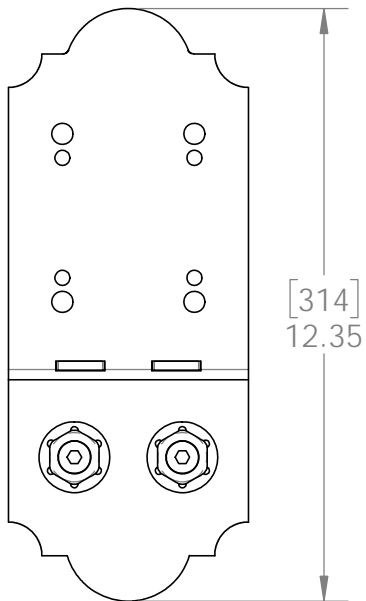
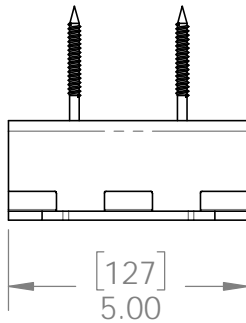

kit contains 2 assemblies

56677

Installation Instructions, 56677

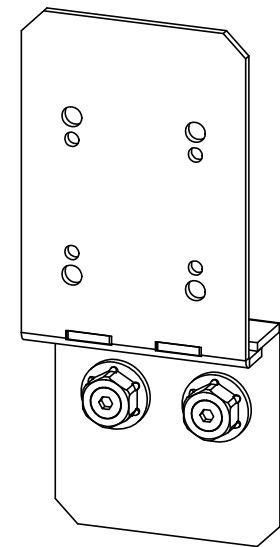
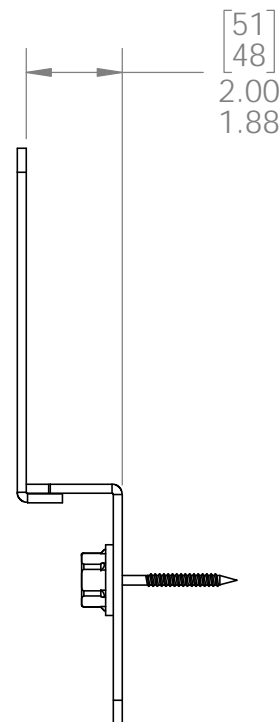
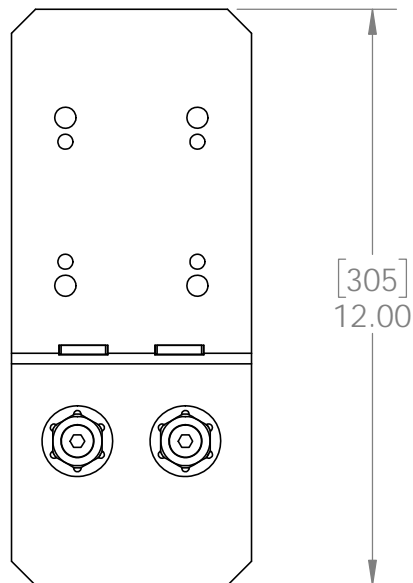
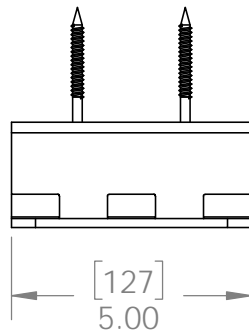

kit contains 2 assemblies

56677

Installation Instructions, 56677



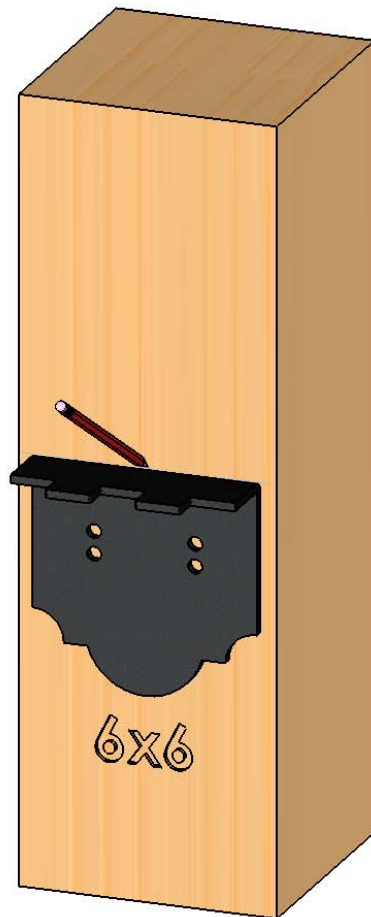

mark location
to mount ledge

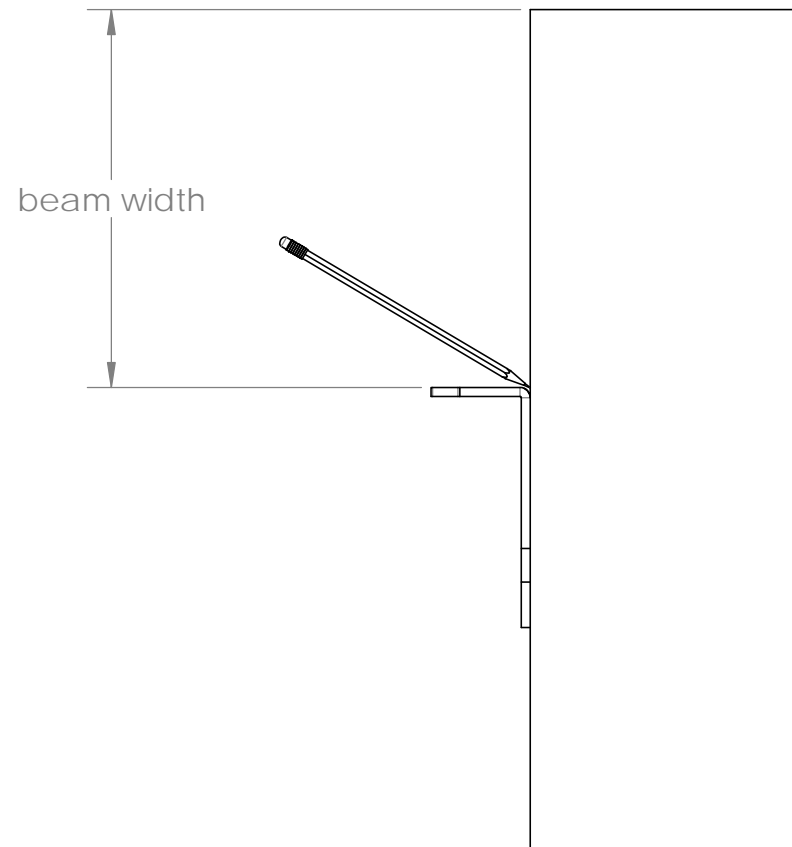

step 1

Installation Instructions, 56677

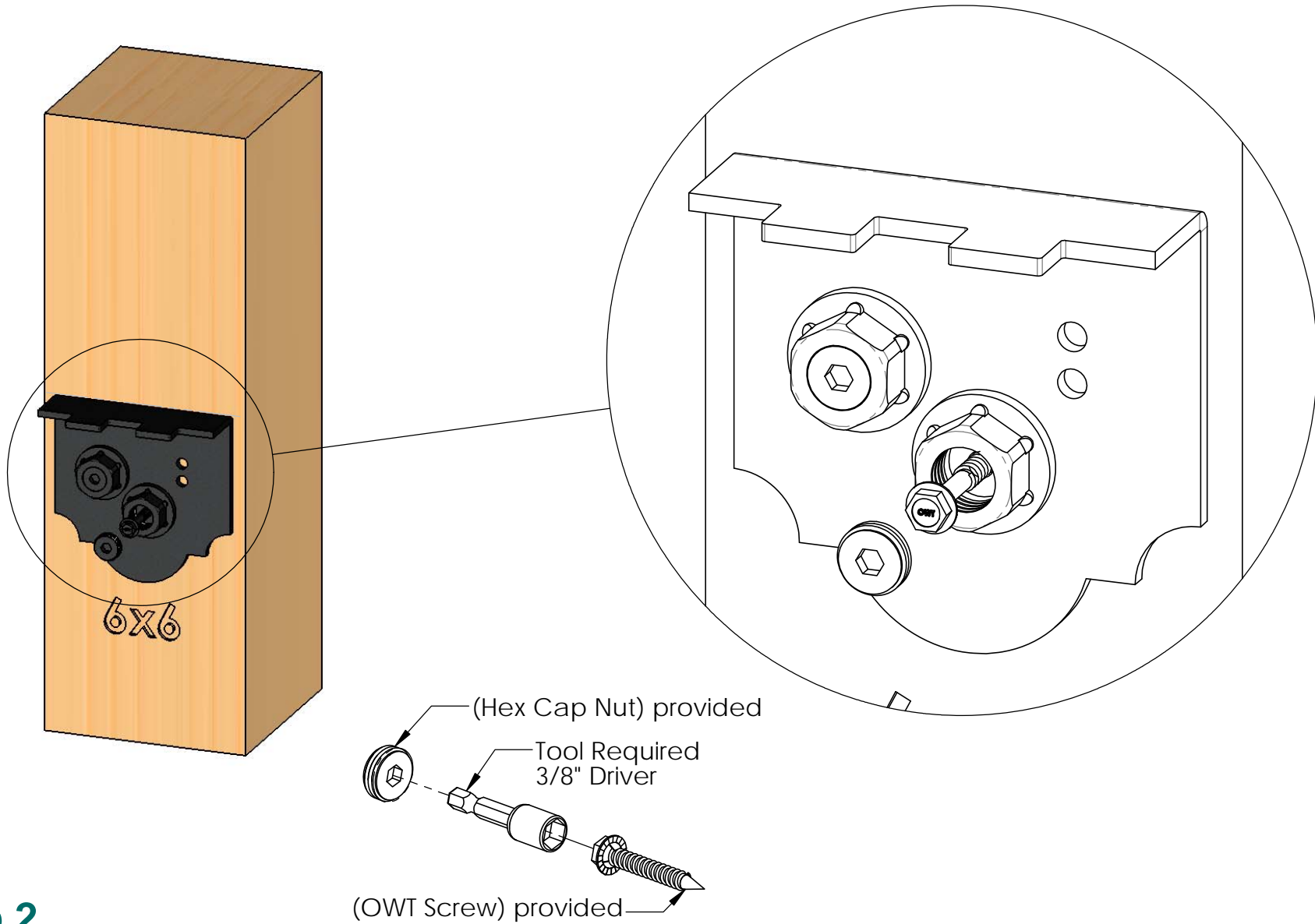

step 2

Installation Instructions, 56677

V2.00 - Installation Instructions, Specifications and Project Plans are effective 3/28/2016 . This information is updated periodically and should not be relied upon after 2 years from 3/28/2016 . Please visit OZCOBP.com to get current information.

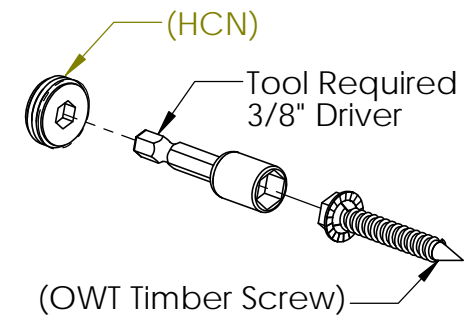
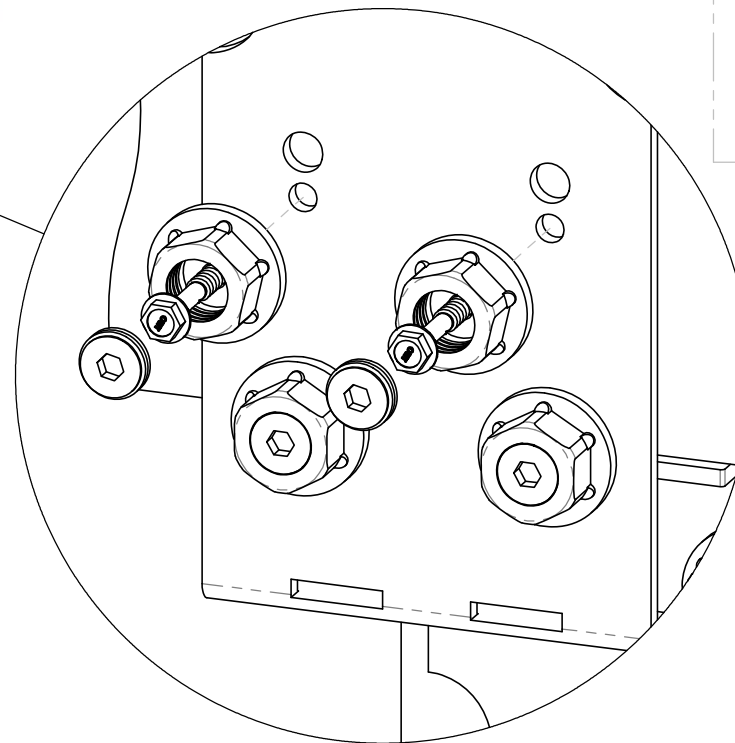
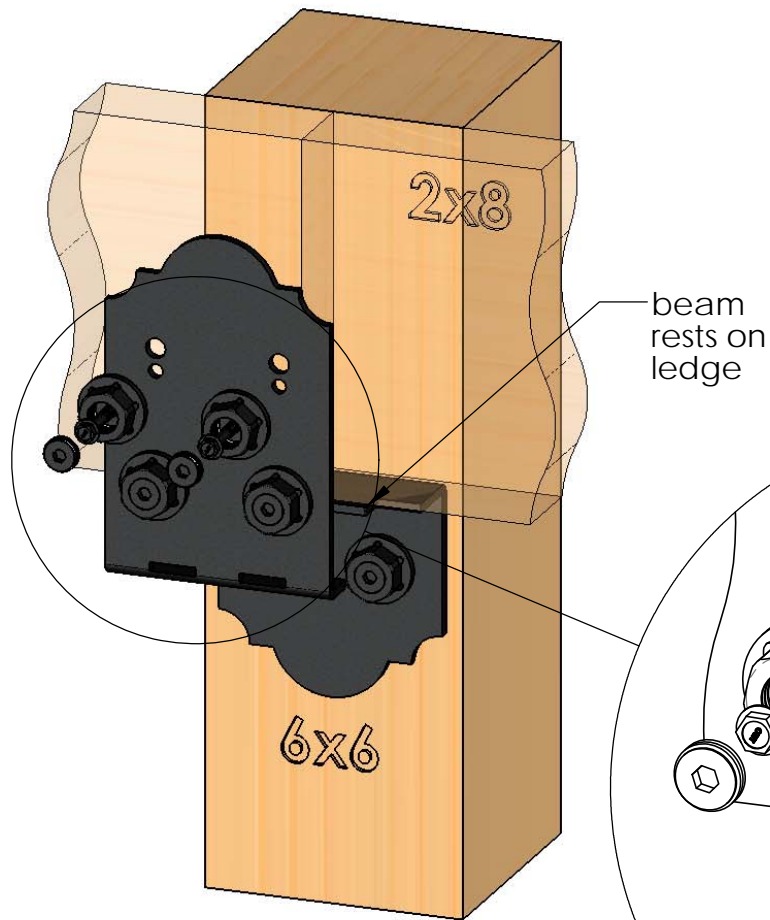

step 3 Timber Screws

Installation Instructions, 56677

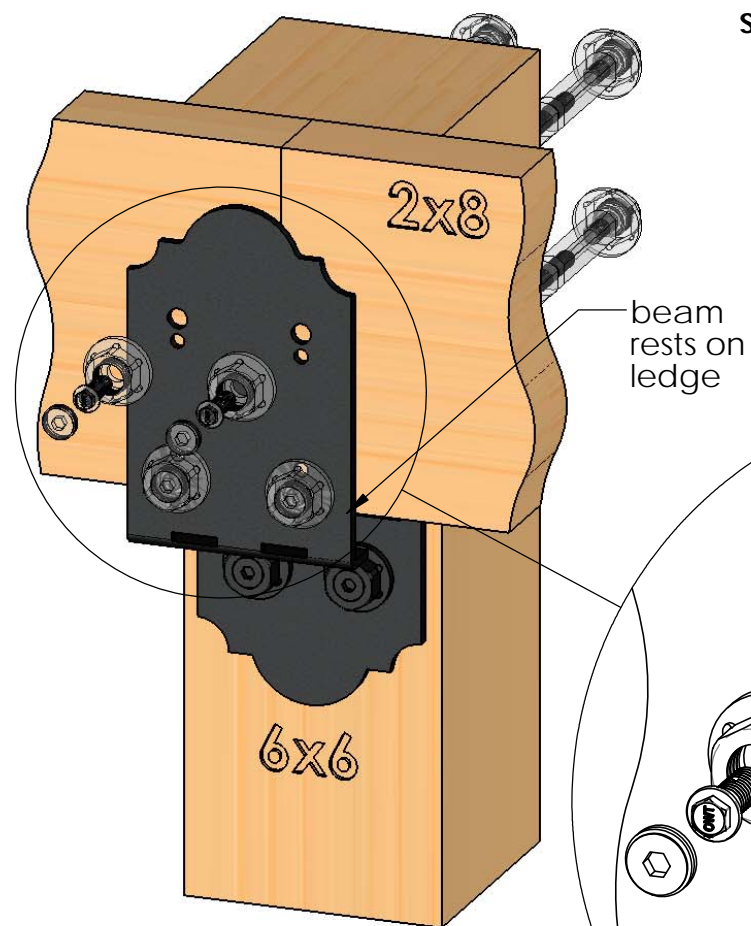

see Installation Instructions,
OWT Timber Bolts **BEFORE**
proceeding

OWT Timber Bolt
sold separately

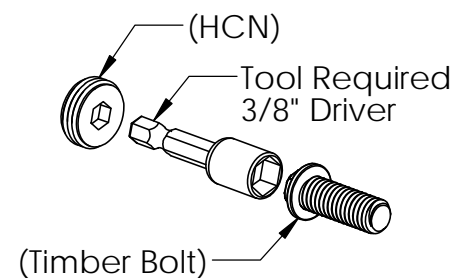
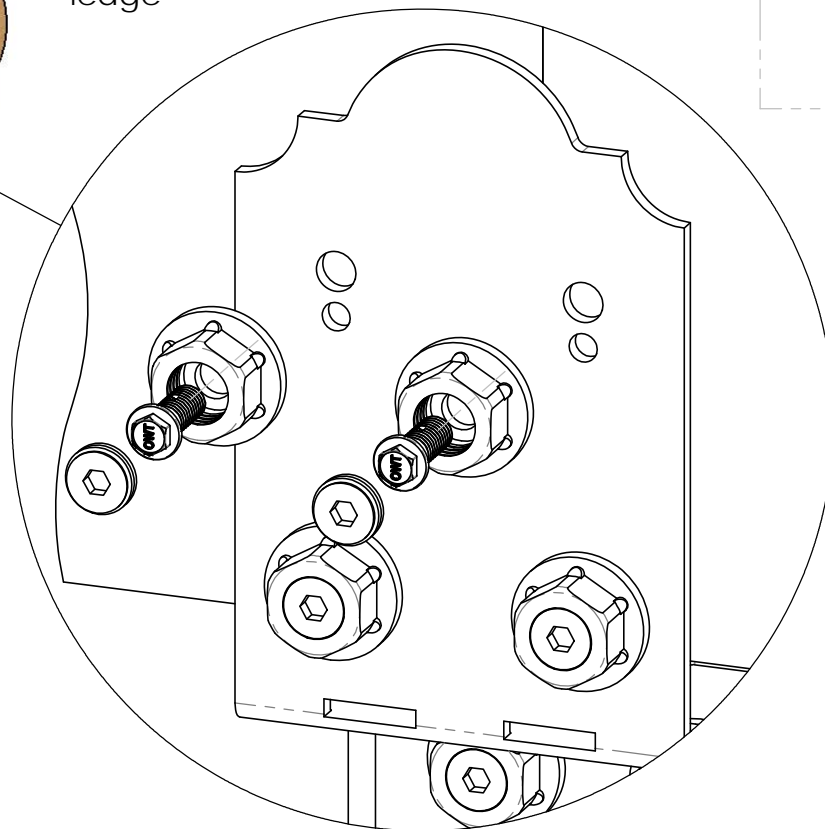

step 3 Timber Bolts

Installation Instructions, 56677

V2.00 - Installation Instructions, Specifications and Project Plans are effective 3/28/2016 . This information is updated periodically and should not be relied upon after 2 years from 3/28/2016 . Please visit OZCOBP.com to get current information.