

Product & Packaging Specs

Bolt Inline (P2B-BI-IW)

Item #: 51737

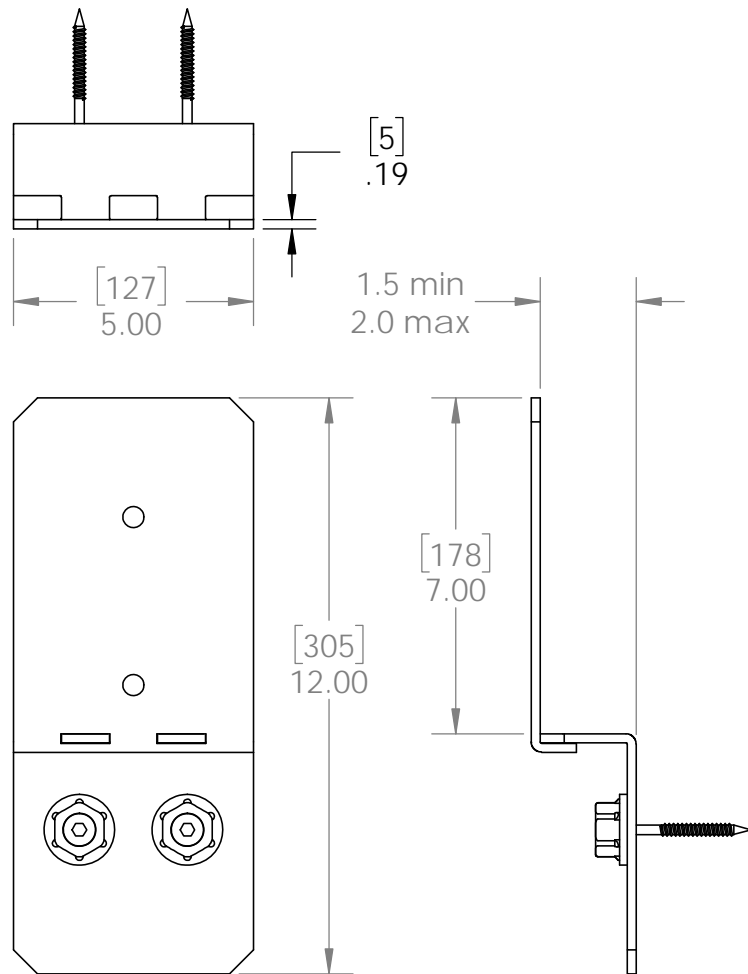

ITEM NO.	QTY.	PART NUMBER	DESCRIPTION
1	0.2	56621	1 1/2" Hex Cap Nut (HCN)
2	0.08	56626	OWT Timber Screw 2-3/4"
3	1	51710-11	Ledge, Post to Beam
4	1	51737-11	Plate, Bolt Inline

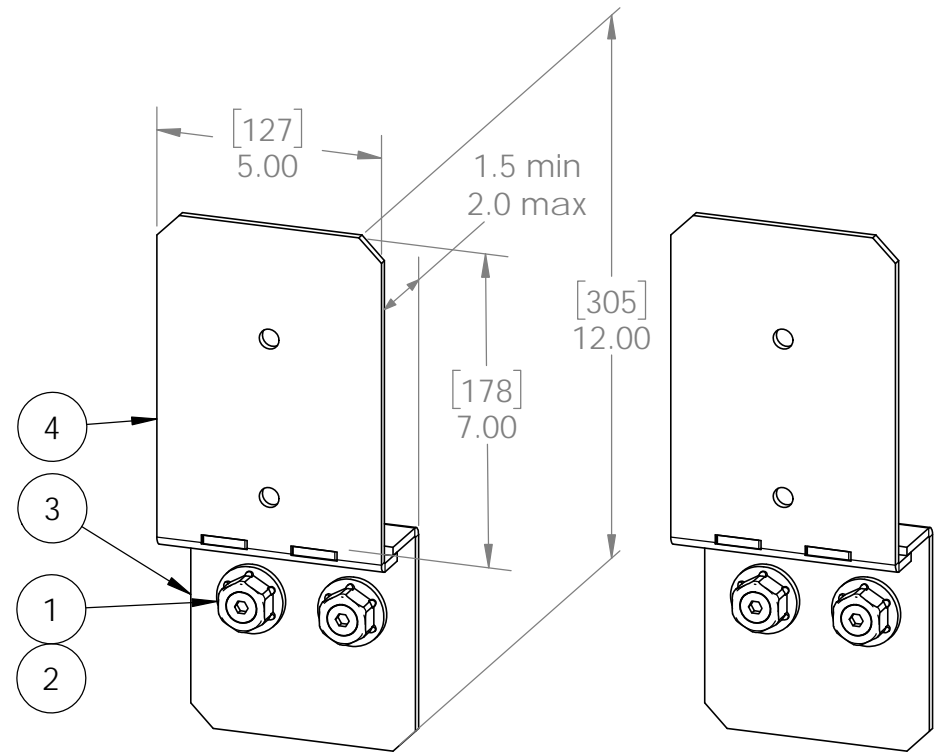

Weight: 3.93 LBS
Scale: 1:4
Last updated: 10/10/2016

51737

Product & Packaging Specs

Bolt Inline (P2B-BI-IW)

Item #: 56637

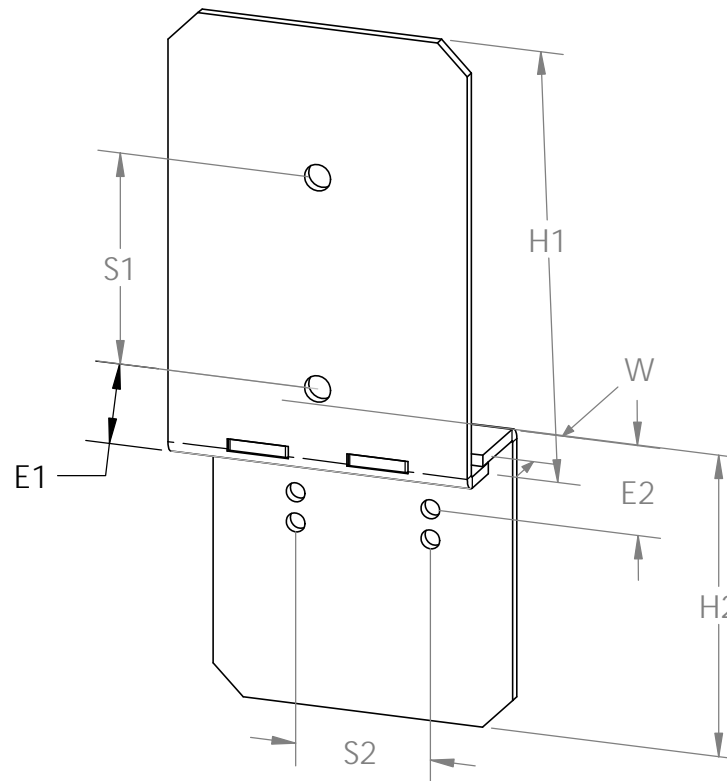

Weight: 3.93 LBS
Scale: 1:3
Last updated: 10/10/2016

51737

Product & Packaging Specs

Bolt Inline (P2B-BI-IW)

Item #: Typical Installation & Basic Assembly

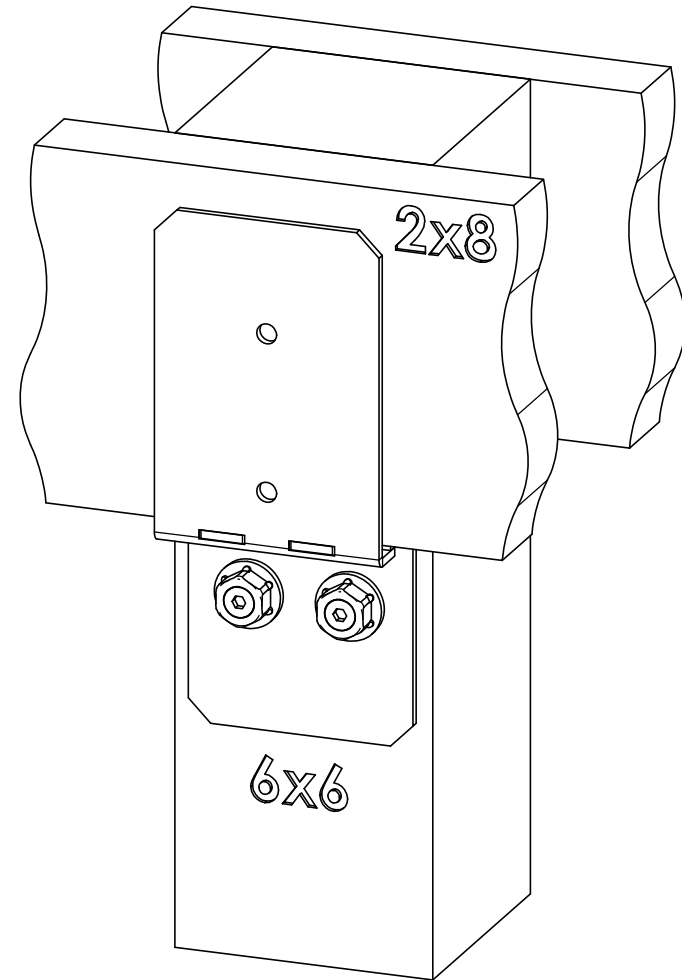
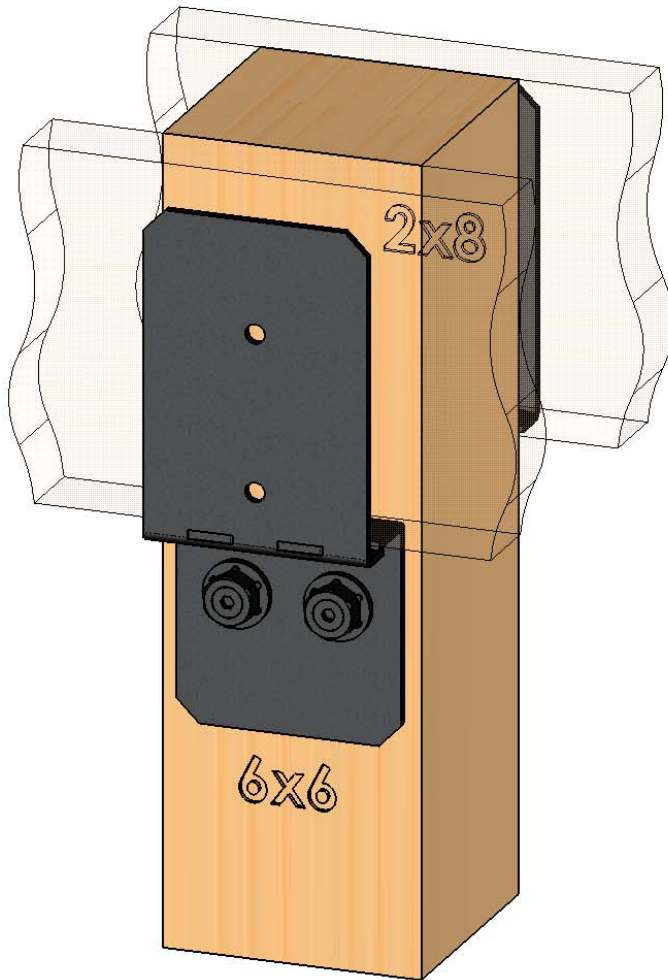

Weight: 3.93 LBS
Scale: 1:4
Last updated: 10/10/2016

51737

Product & Packaging Specs

Bolt Inline (P2B-BI-IW)

Item #: Typical Installation & Basic Assembly

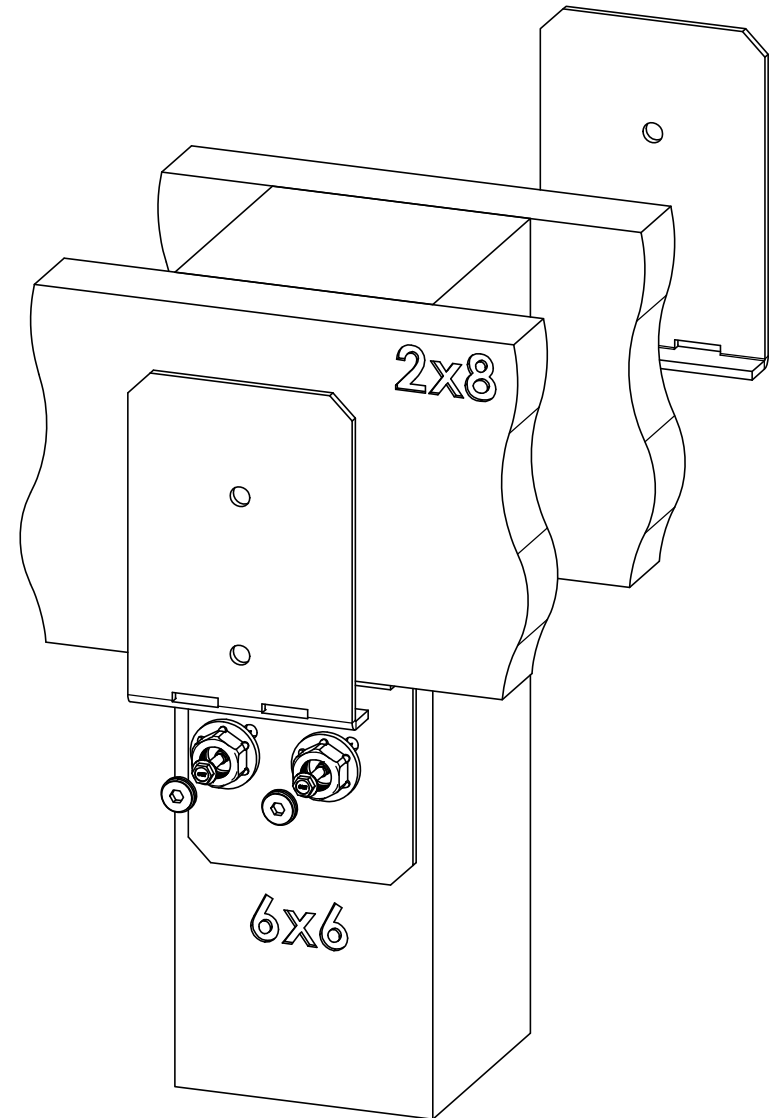
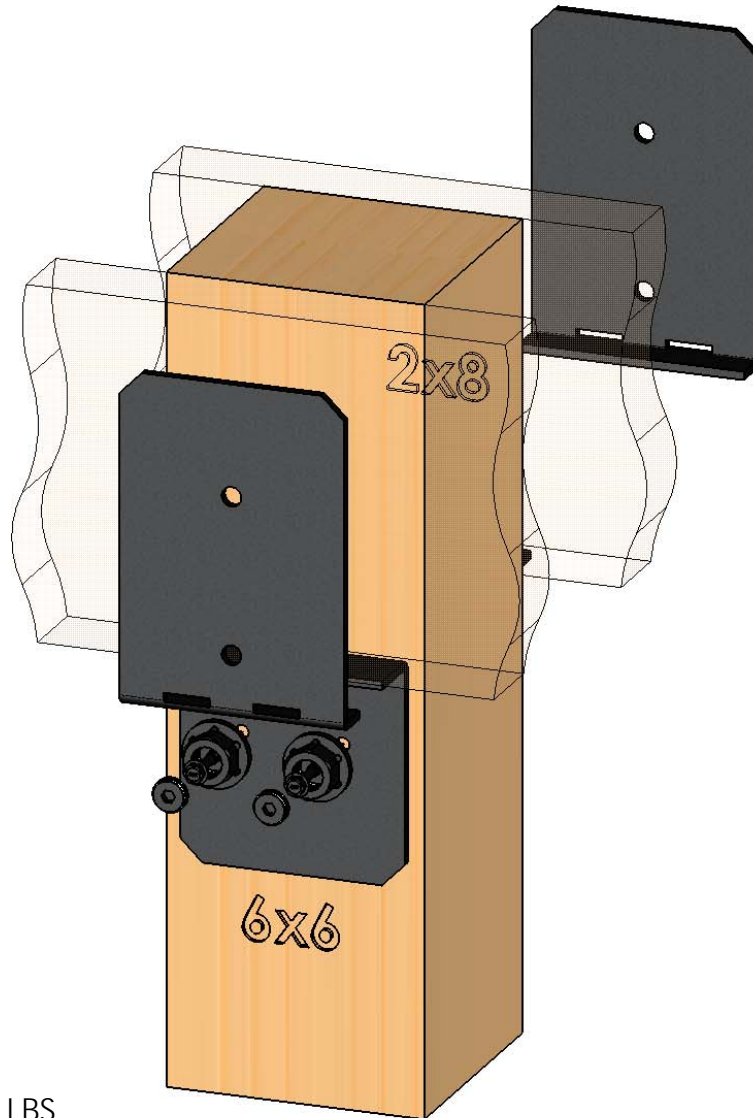

Weight: 3.93 LBS
Scale: 1:4
Last updated: 10/10/2016

51737

Product & Packaging Specs

Post to Beam Bolt Inline (P2B-BI-IW)

Item #: Typical Installation & Basic Assembly

TIMBER BOLTS SOLD SEPARATELY

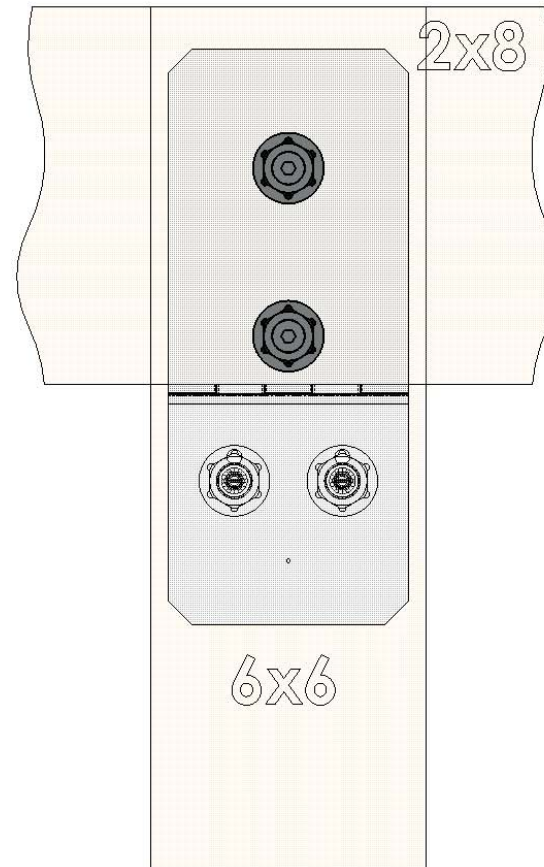
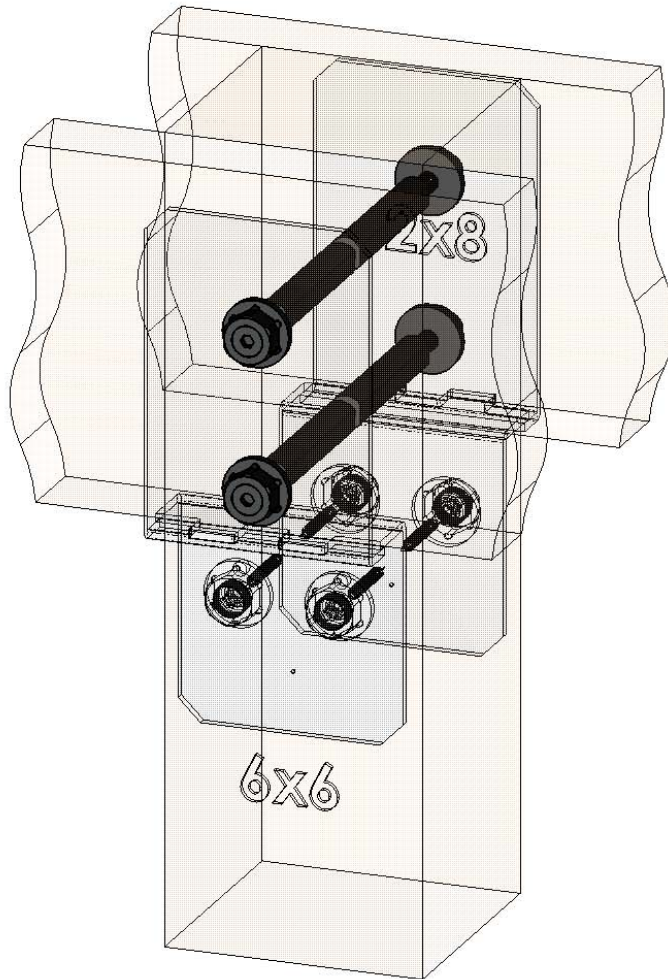

Weight: 41.00 LBS
Scale: 1:4
Last updated: 10/10/2016

51737

Product & Packaging Specs

Bolt Inline (P2B-BI-IW)

Item #: 51737

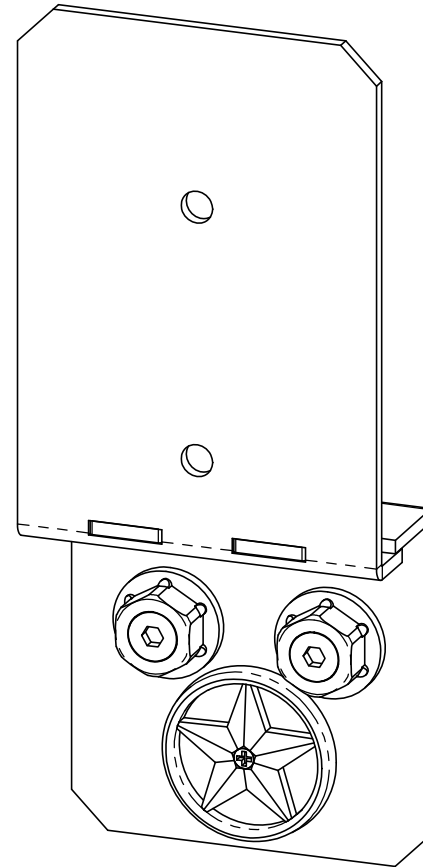
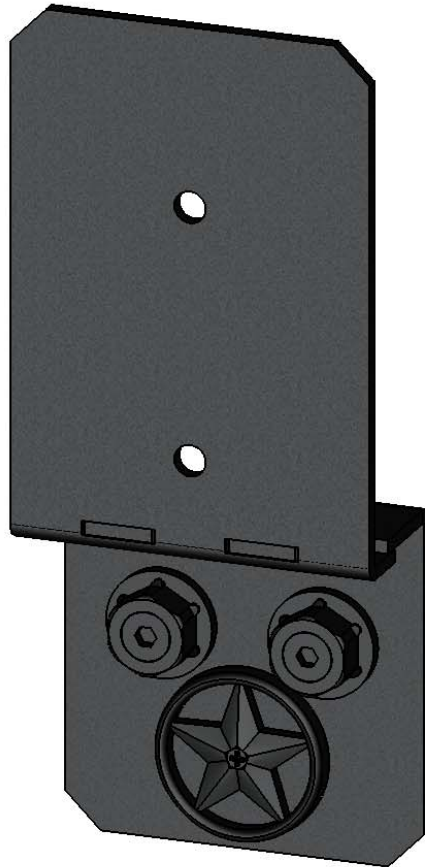

STARS SOLD SEPARATELY

Weight: 3.93 LBS
Scale: 1:2.5
Last updated: 10/10/2016

51737

Product & Packaging Specs

Bolt Inline (P2B-BI-IW)

Item #: Typical Installation & Basic Assembly

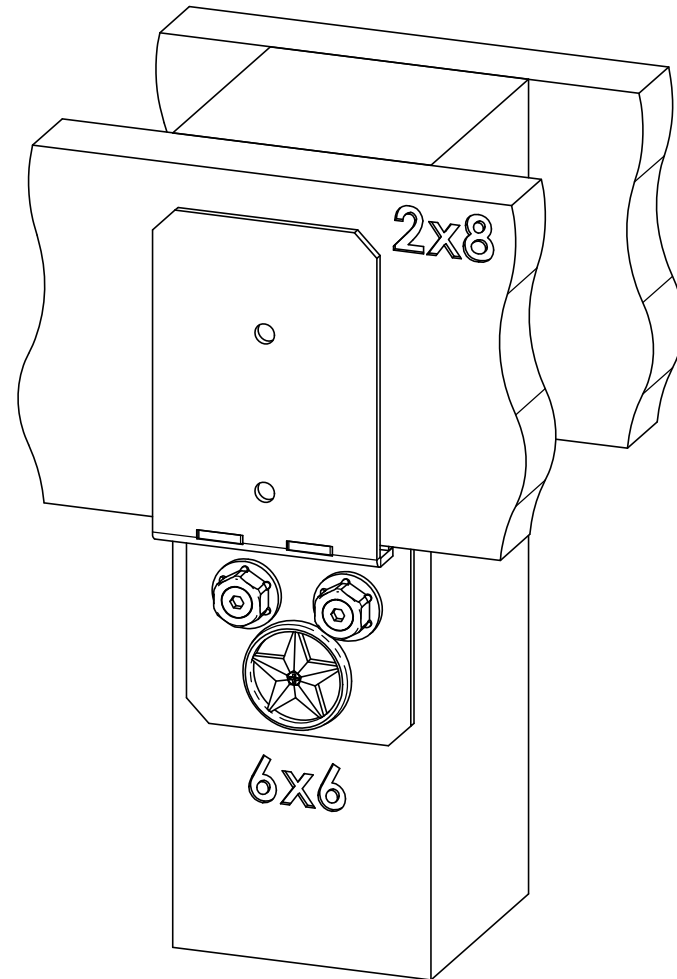
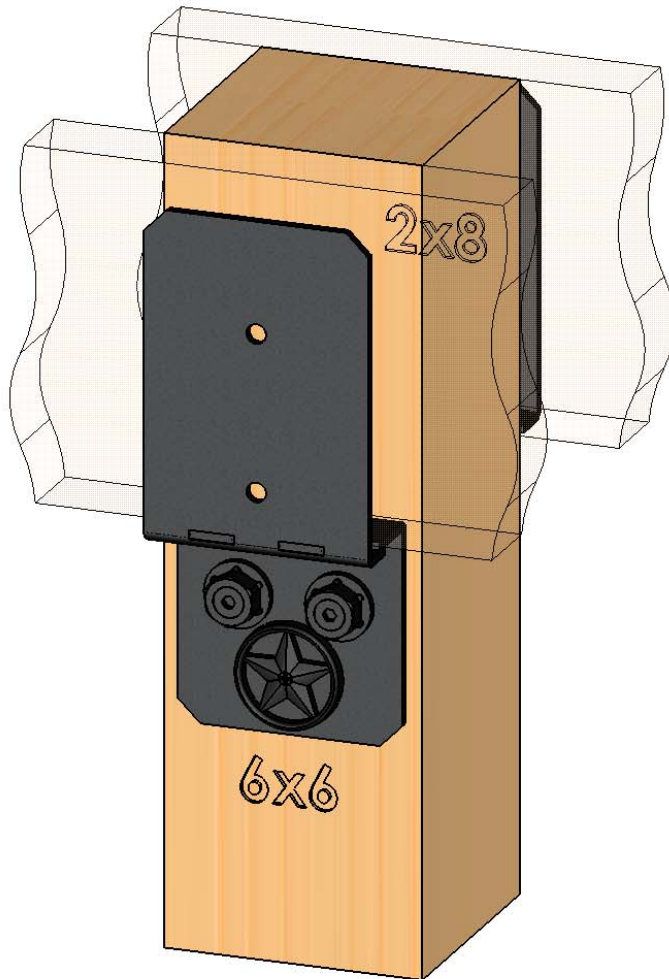

STARS SOLD SEPARATELY

Weight: 3.93 LBS
Scale: 1:2.5
Last updated: 10/10/2016

51737

Product & Packaging Specs

Post to Beam Bolt Inline (P2B-BI-IW)

Item #: 51737

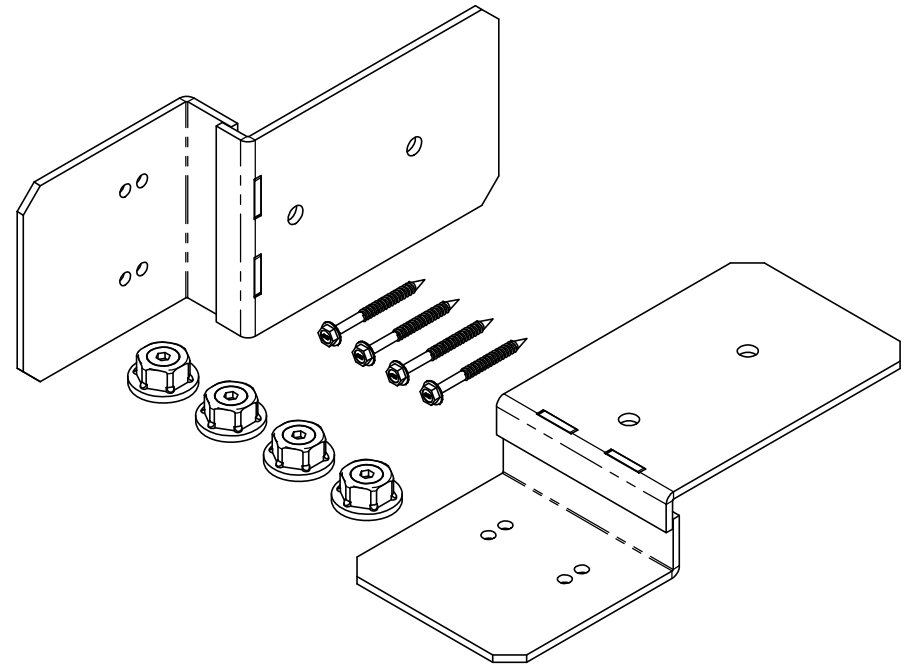
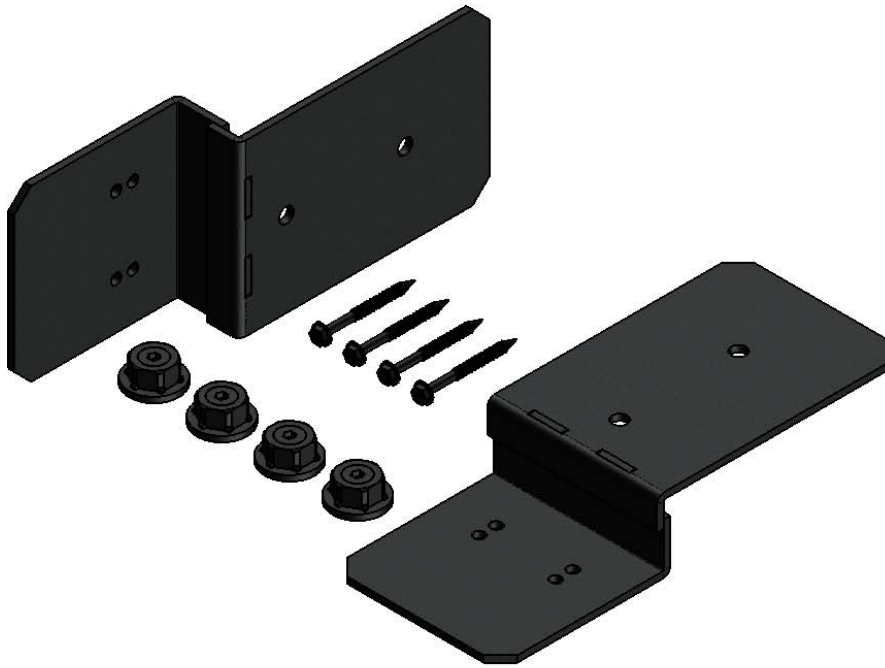

Weight: 7.87 LBS
Scale: 1:4
Last updated: 10/10/2016

51737

Product & Packaging Specs

51737 Packing

Item #: Box packing

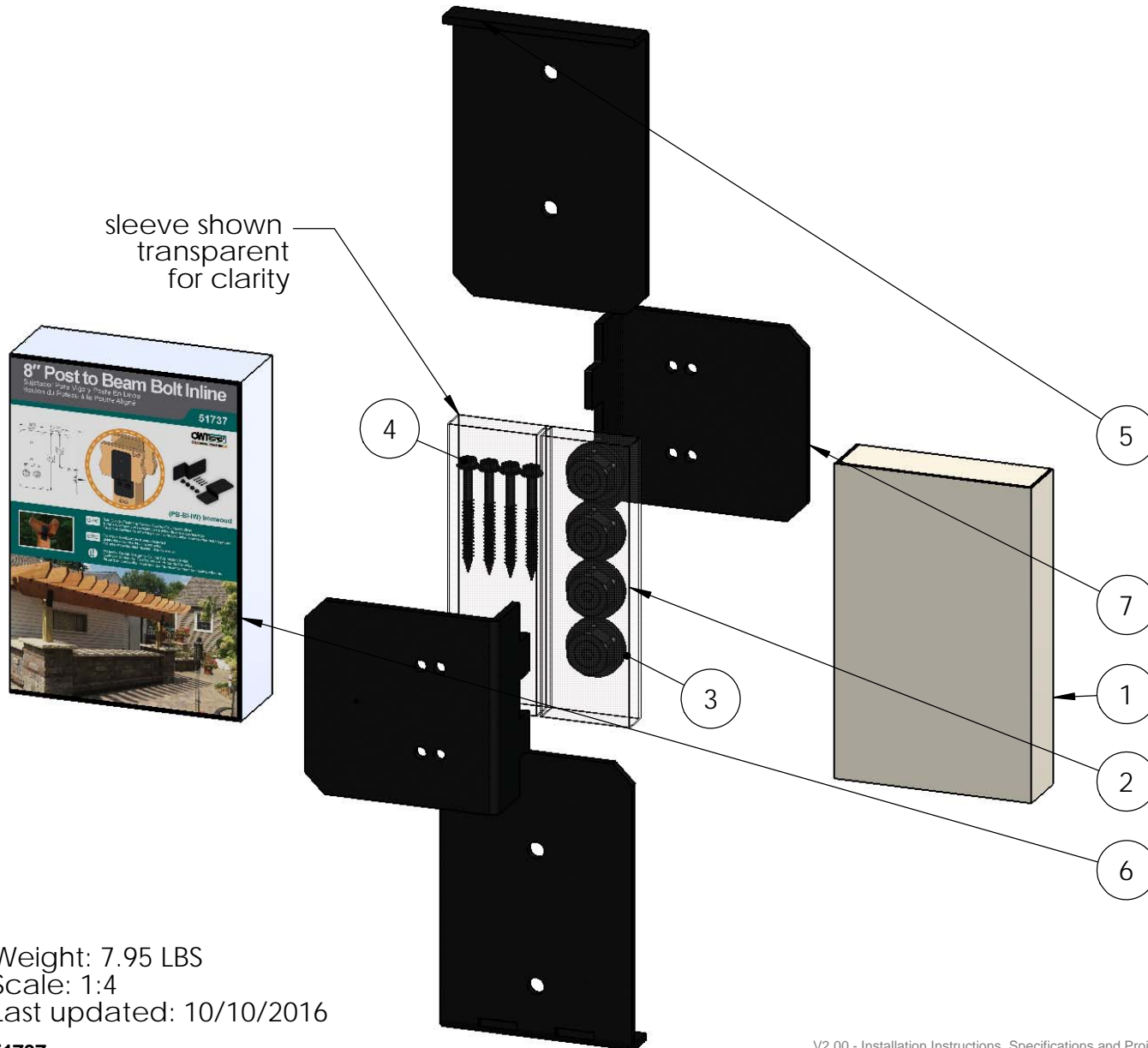

ITEM NO.	QTY.	PART NUMBER	DESCRIPTION
1	1	56637 Inner Box	56637 Inner Box
2	1	56637 Inner Box Sleeve	56637 Inner Box Sleeve
3	0.4	56621	1 1/2" Hex Cap Nut (HCN)
4	0.16	56626	OWT Timber Screw 2-3/4"
5	2	51737-11	Plate, Bolt Inline
6	1	Box, 51737	Box, 51737
7	2	51710-11	Ledge, Post to Beam

Weight: 7.95 LBS
Scale: 1:4
Last updated: 10/10/2016

51737

Product & Packaging Specs

51737 Packing

Item #: Case packing

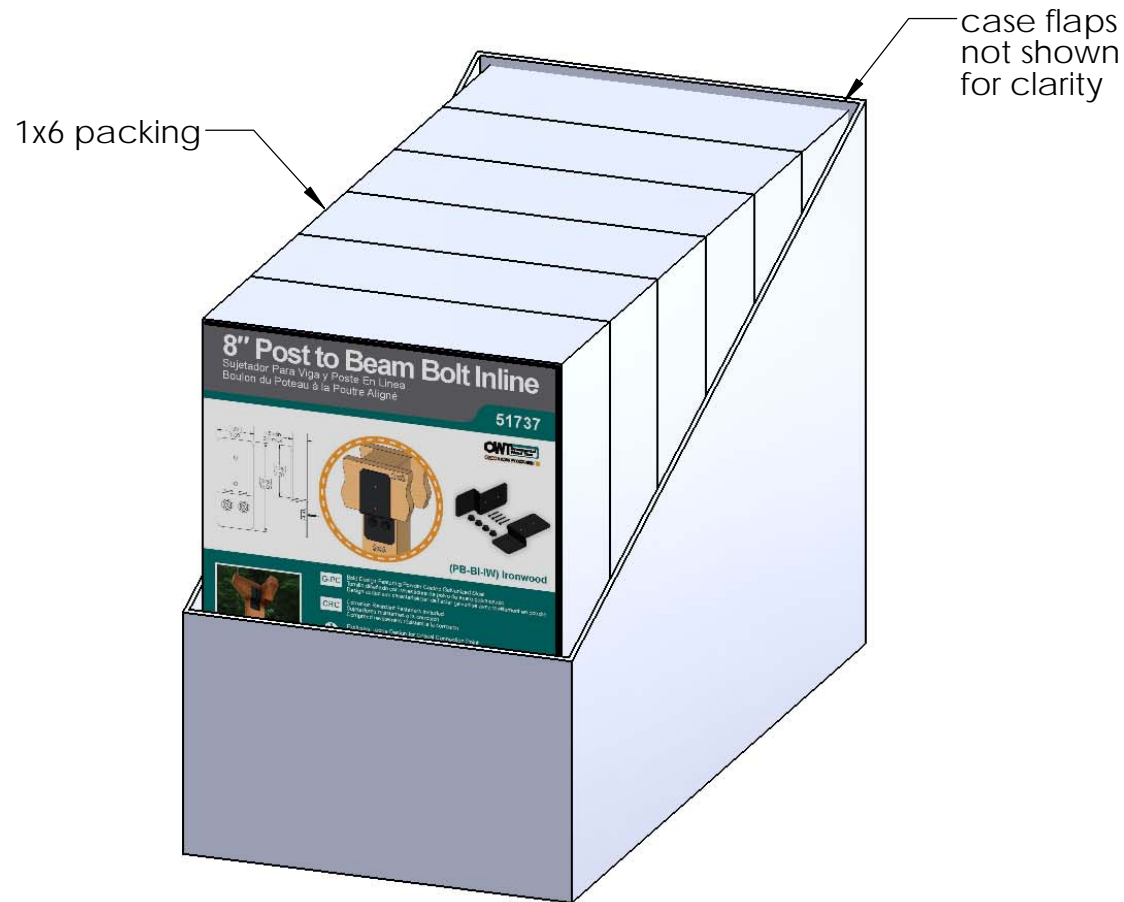

Weight: 0.37 LBS
Scale: 1:3
Last updated: 10/10/2016

51737

Product & Packaging Specs

51737 Packing

Item #: Pallet packing

ADD PALLET LABEL

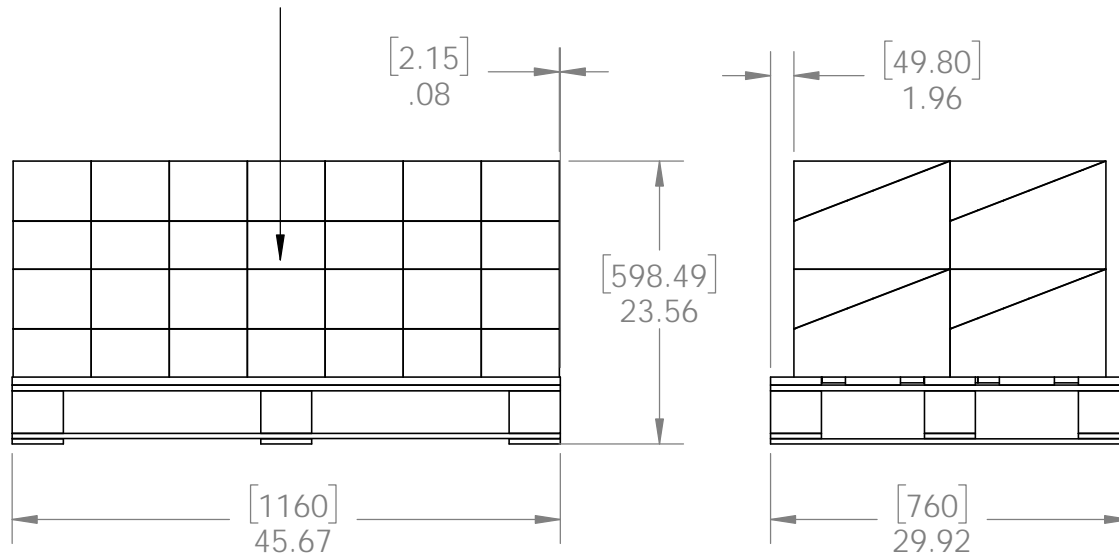

Total number of cases: 28
Total number of pieces:
28x6=168 pieces on pallet

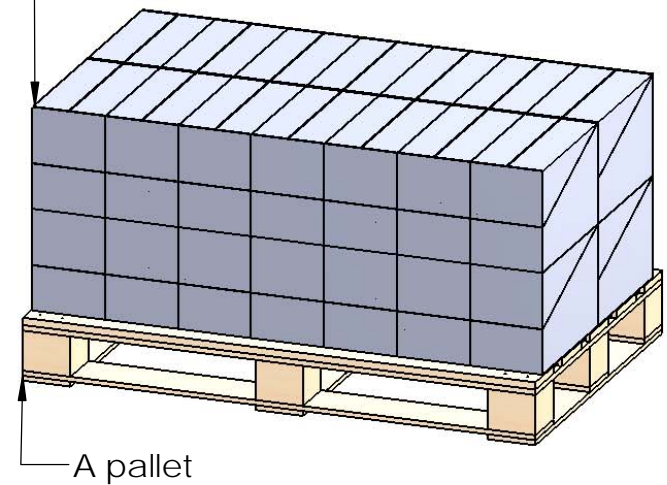

Weight: 1339 LBS
Scale: 1:16
Last updated: 10/10/2016

additional pallet packing instructions

- plywood on top layer
- strap to pallet
- clear wrap around boxes