

Product & Packaging Specs

Post to Beam Bolt Inline (P2B-BI-LS)

Item #: 56637

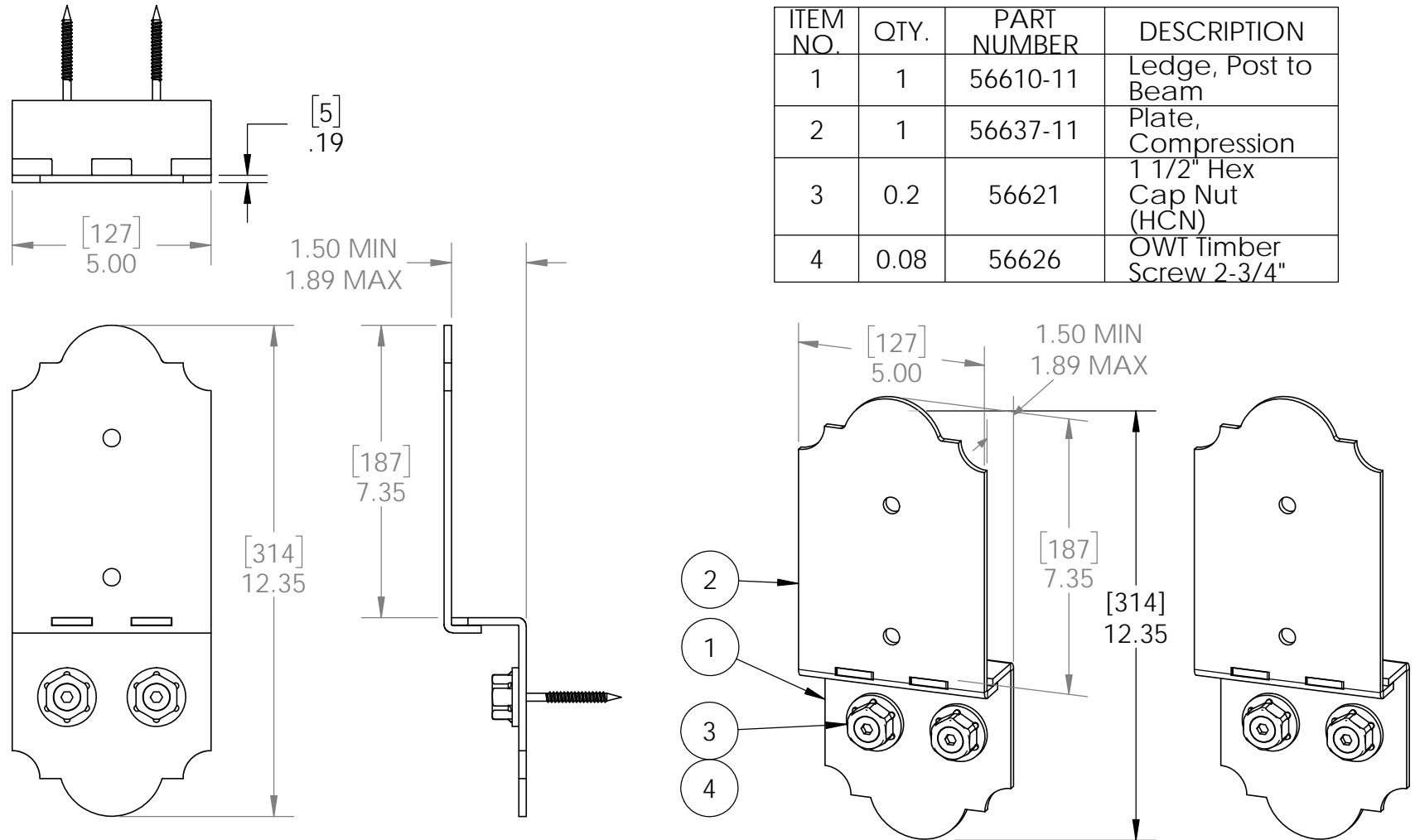

Weight: 3.64 LBS
 Scale: 1:4
 Last updated: 10/10/2016

TOP PLATE TIMBER BOLTS &/OR SCREWS SOLD SEPARATELY

Product & Packaging Specs

Post to Beam Bolt Inline (P2B-BI-LS)

Item #: 56637

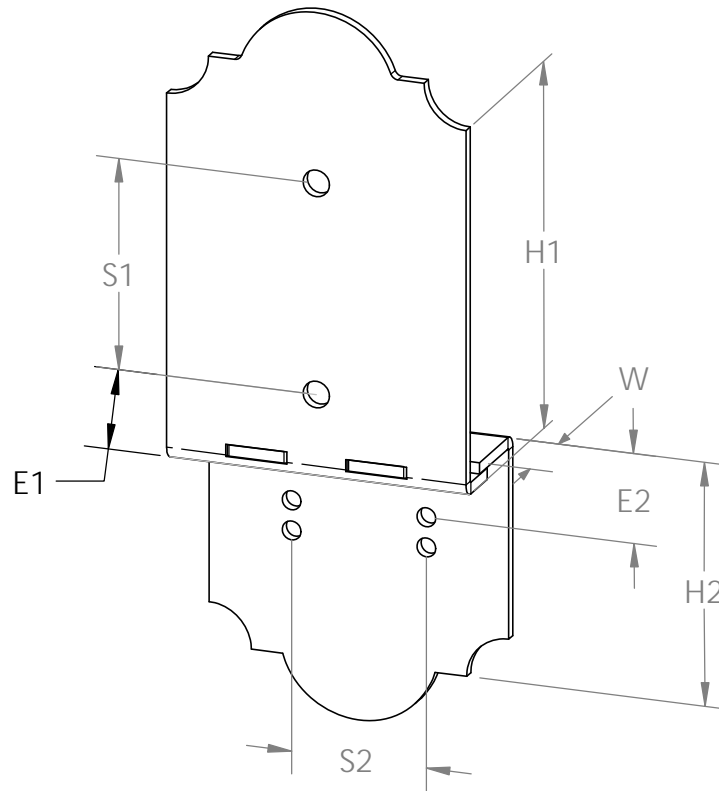

Weight: 3.64 LBS
 Scale: 1:3
 Last updated: 10/10/2016

56637-10

Product & Packaging Specs

Post to Beam Bolt Inline (P2B-BI-LS)

Item #: Typical Installation & Basic Assembly

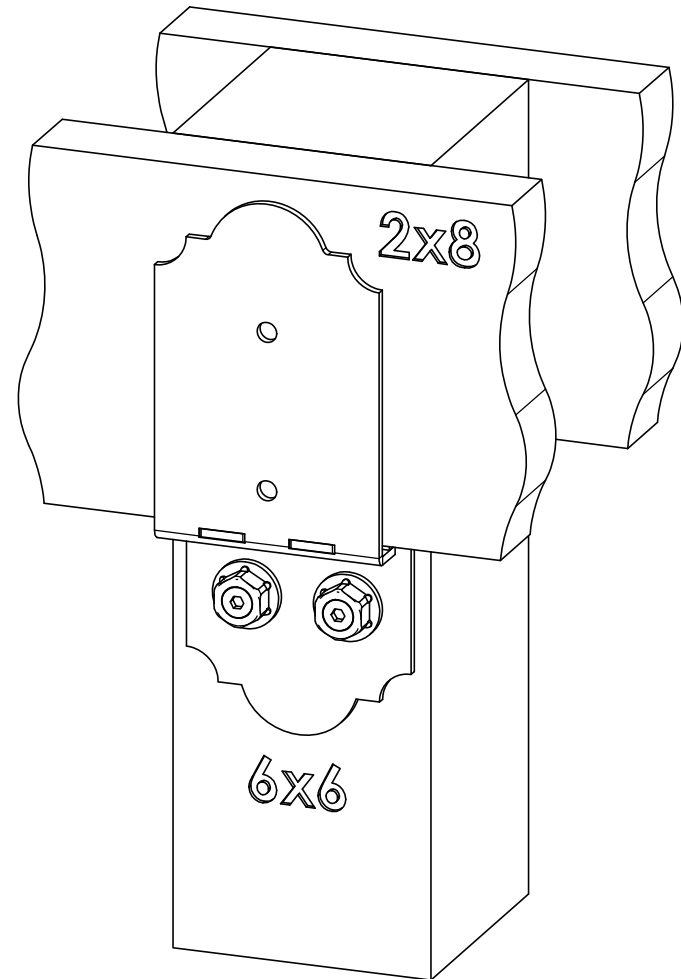
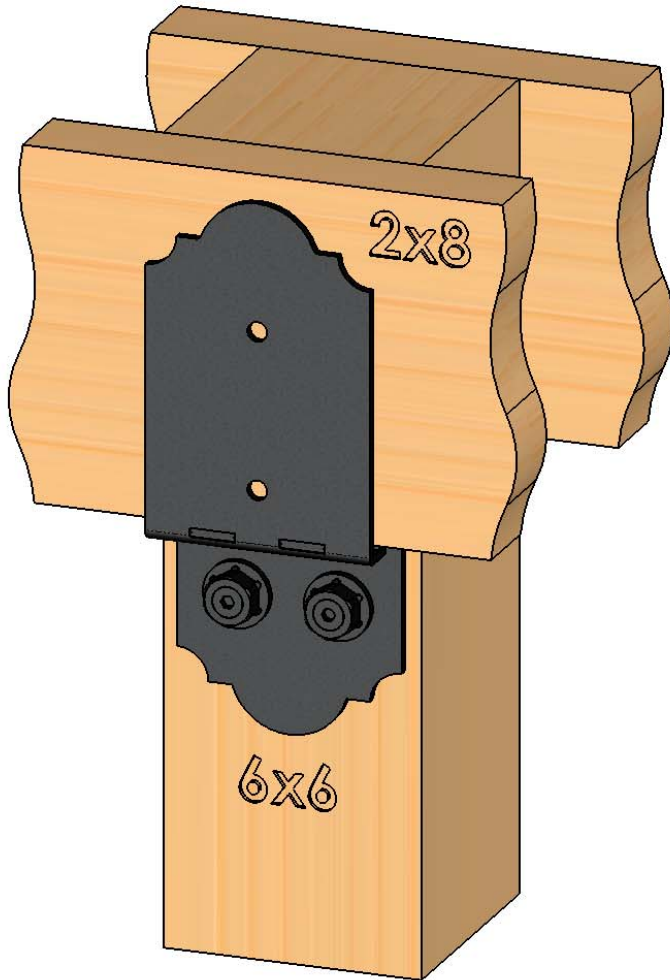

Weight: 3.64 LBS
Scale: 1:4
Last updated: 10/10/2016

TOP PLATE TIMBER BOLTS &/OR SCREWS SOLD SEPARATELY



OZCO BUILDING PRODUCTS

Product & Packaging Specs

Post to Beam Bolt Inline (P2B-BI-LS)

Item #: Typical Installation & Basic Assembly

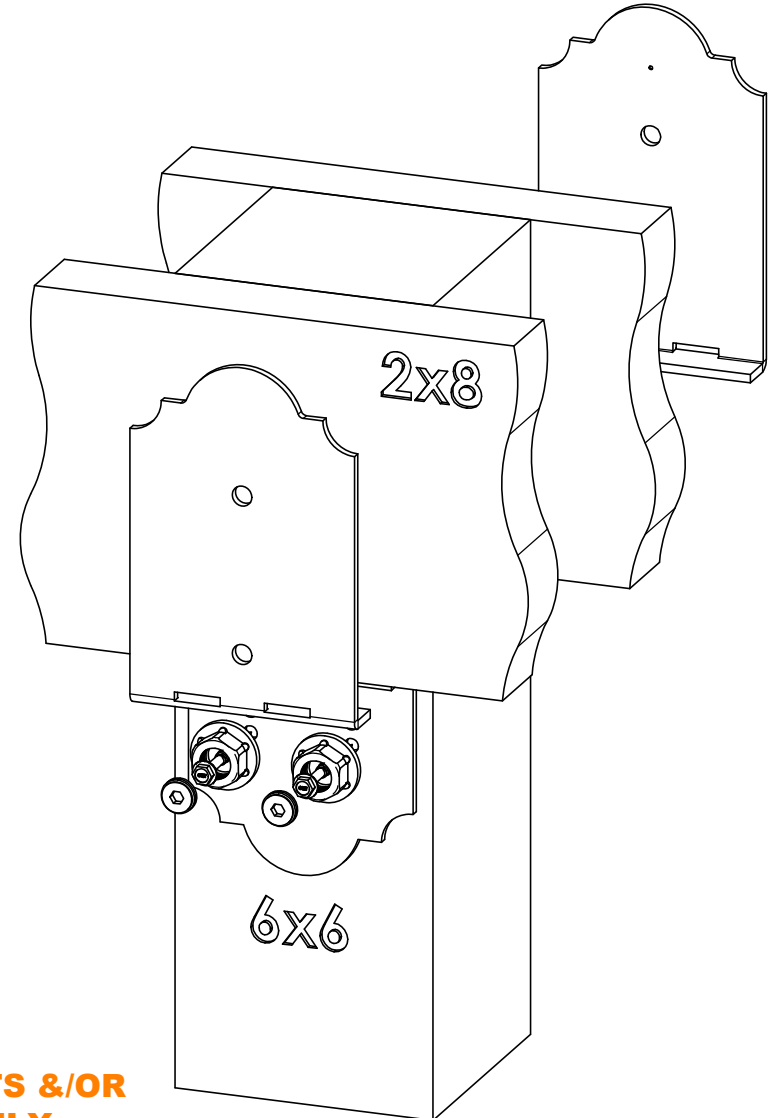
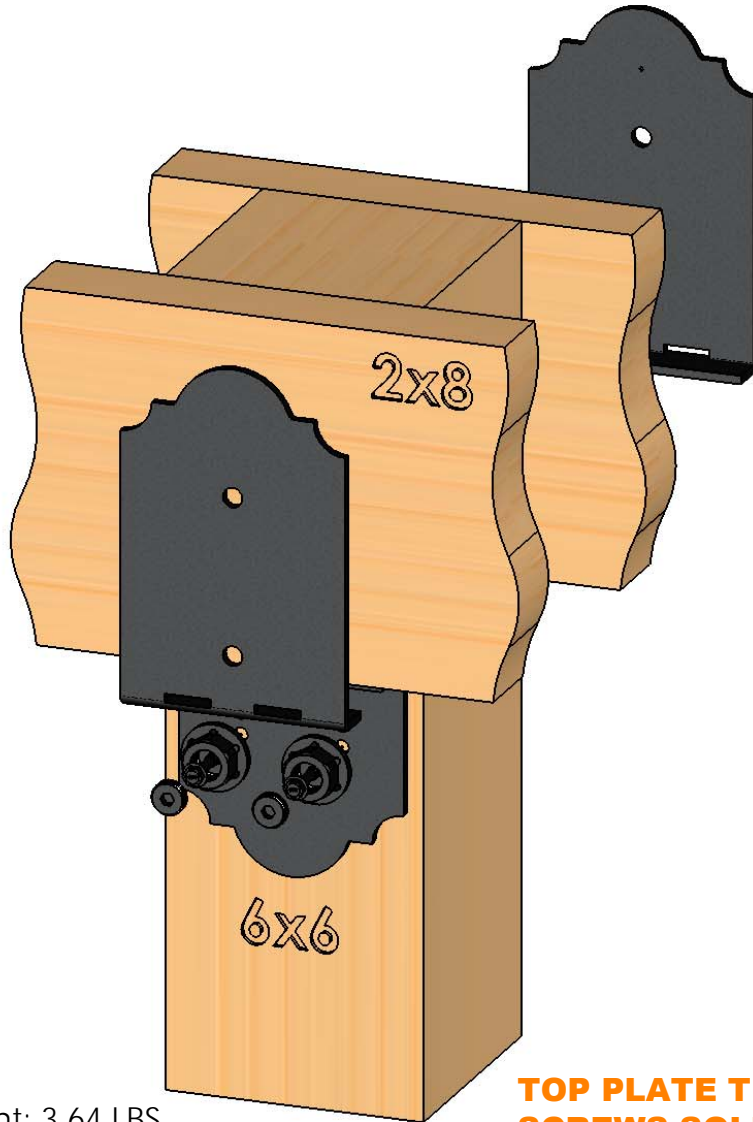

**TOP PLATE TIMBER BOLTS &/OR
SCREWS SOLD SEPARATELY**

Weight: 3.64 LBS
Scale: 1:4
Last updated: 10/10/2016

56637-10

Product & Packaging Specs

Post to Beam Bolt In-line (P2B-BI-LS)

Item #: Typical Installation & Basic Assembly

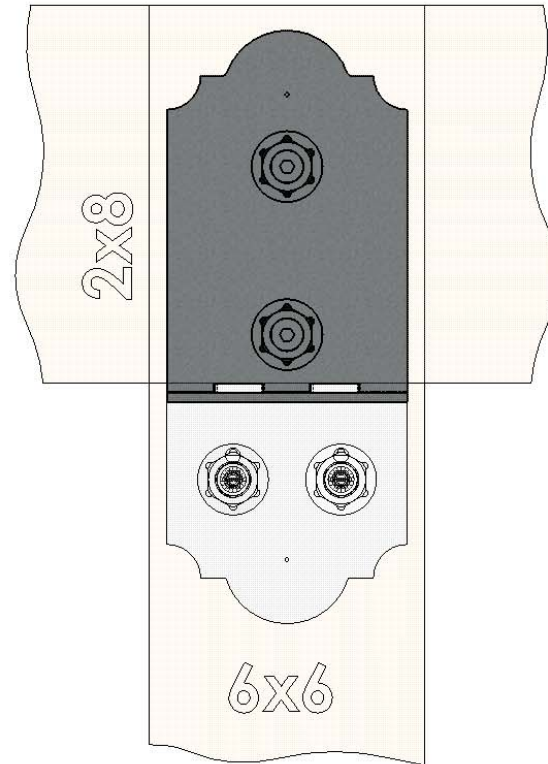
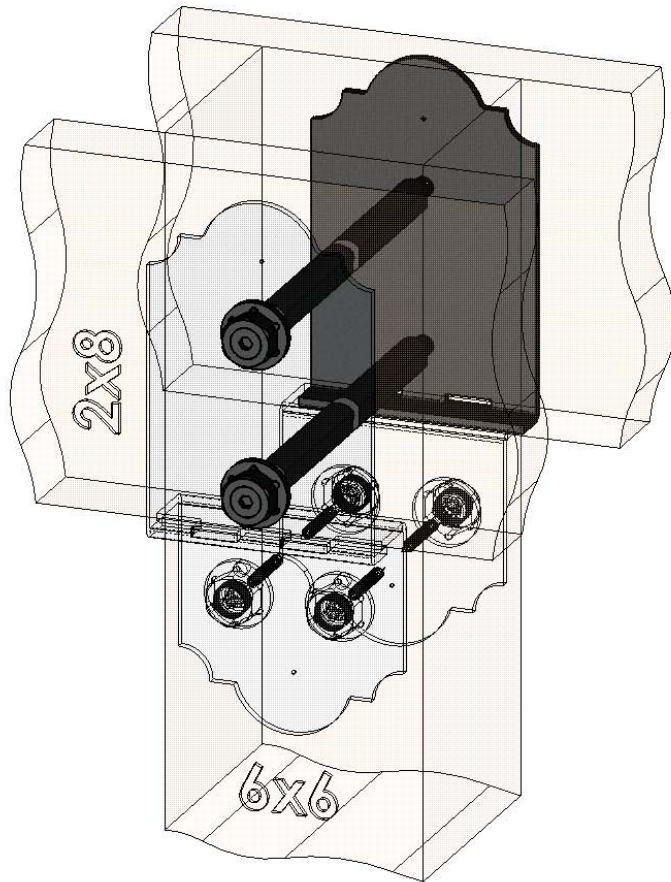

TOP PLATE TIMBER BOLTS &/OR SCREWS SOLD SEPARATELY

Weight: 37.57 LBS
Scale: 1:4
Last updated: 10/10/2016

56637-10

Product & Packaging Specs

Post to Beam Bolt Inline (P2B-BI-LS)

Item #: Typical Installation & Basic Assembly

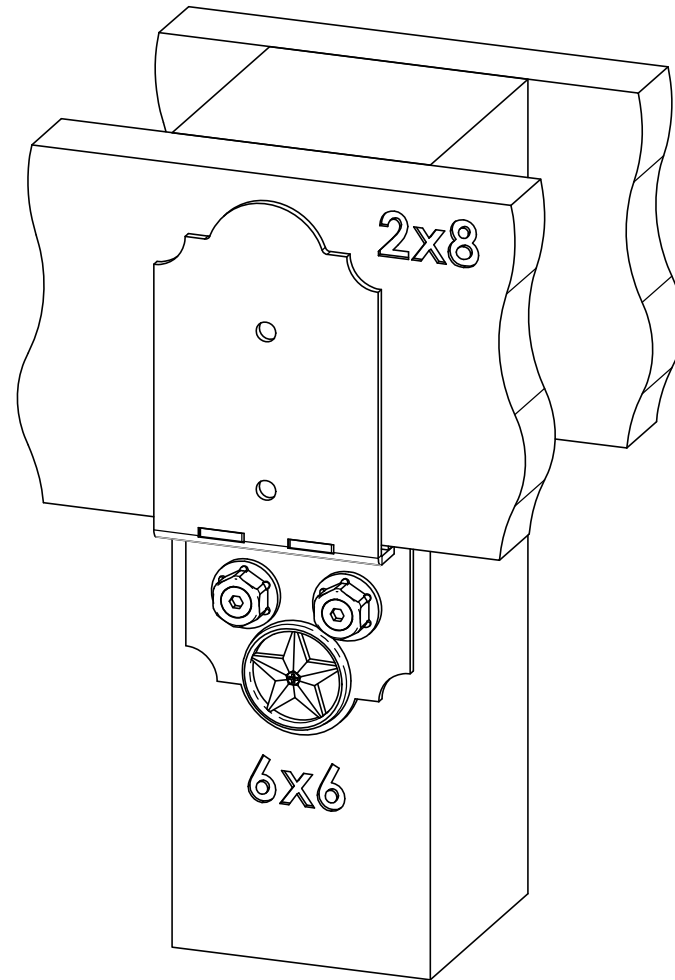
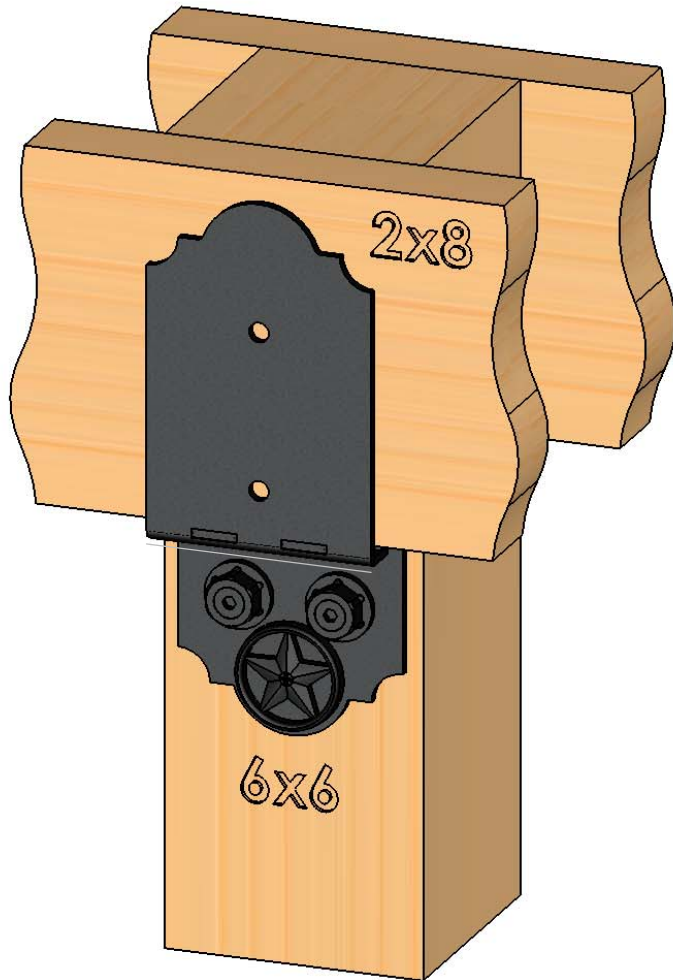

Weight: 3.64 LBS
Scale: 1:4
Last updated: 10/10/2016

TOP PLATE TIMBER BOLTS &/OR SCREWS SOLD SEPARATELY
STARS SOLD SEPARATELY

Product & Packaging Specs

Post to Beam Bolt Inline (P2B-BI-LS)

Item #: 56637

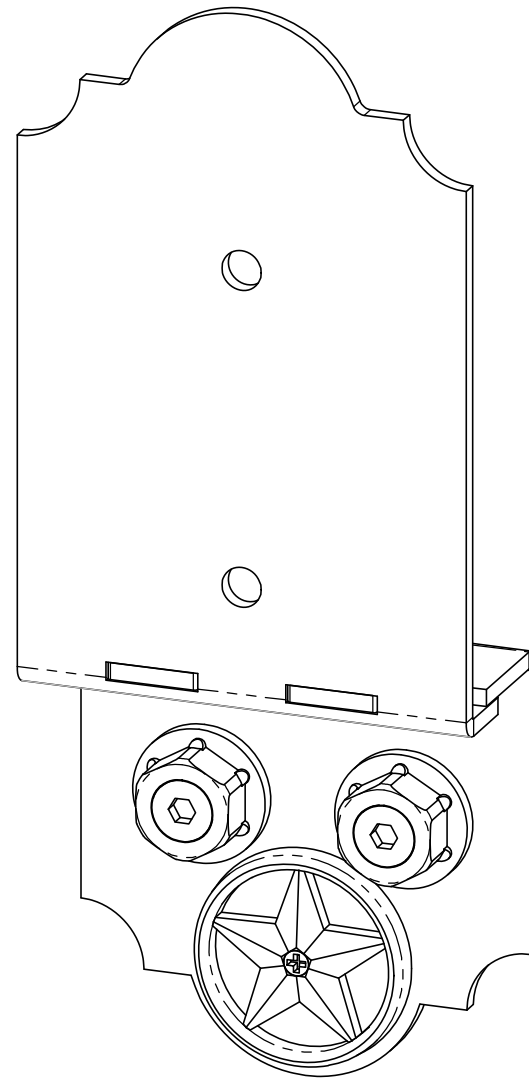
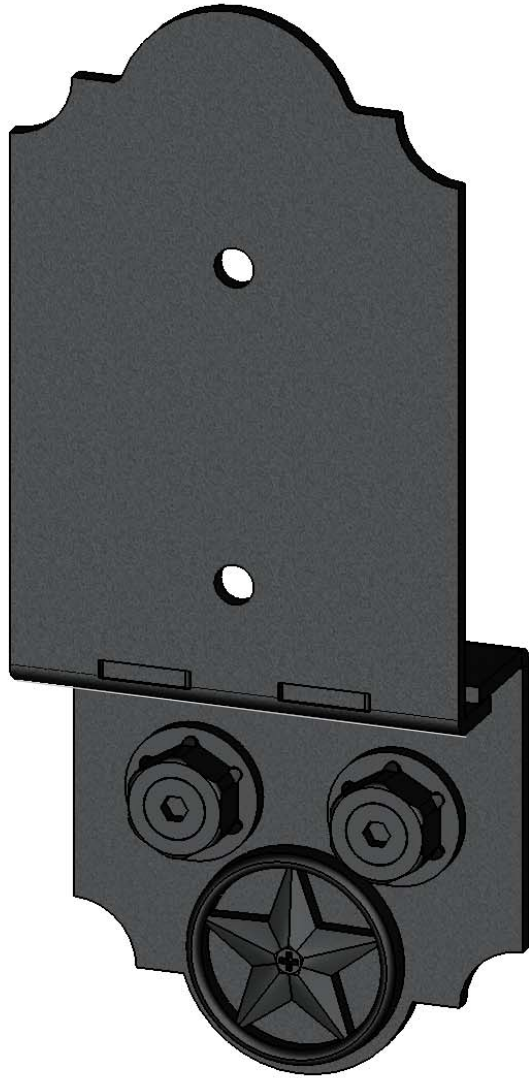

Weight: 3.64 LBS
Scale: 1:2
Last updated: 10/10/2016

TOP PLATE TIMBER BOLTS &/OR SCREWS SOLD SEPARATELY
STARS SOLD SEPARATELY



OZCO BUILDING PRODUCTS

Product & Packaging Specs

56637 Packing

Item #: Box packing

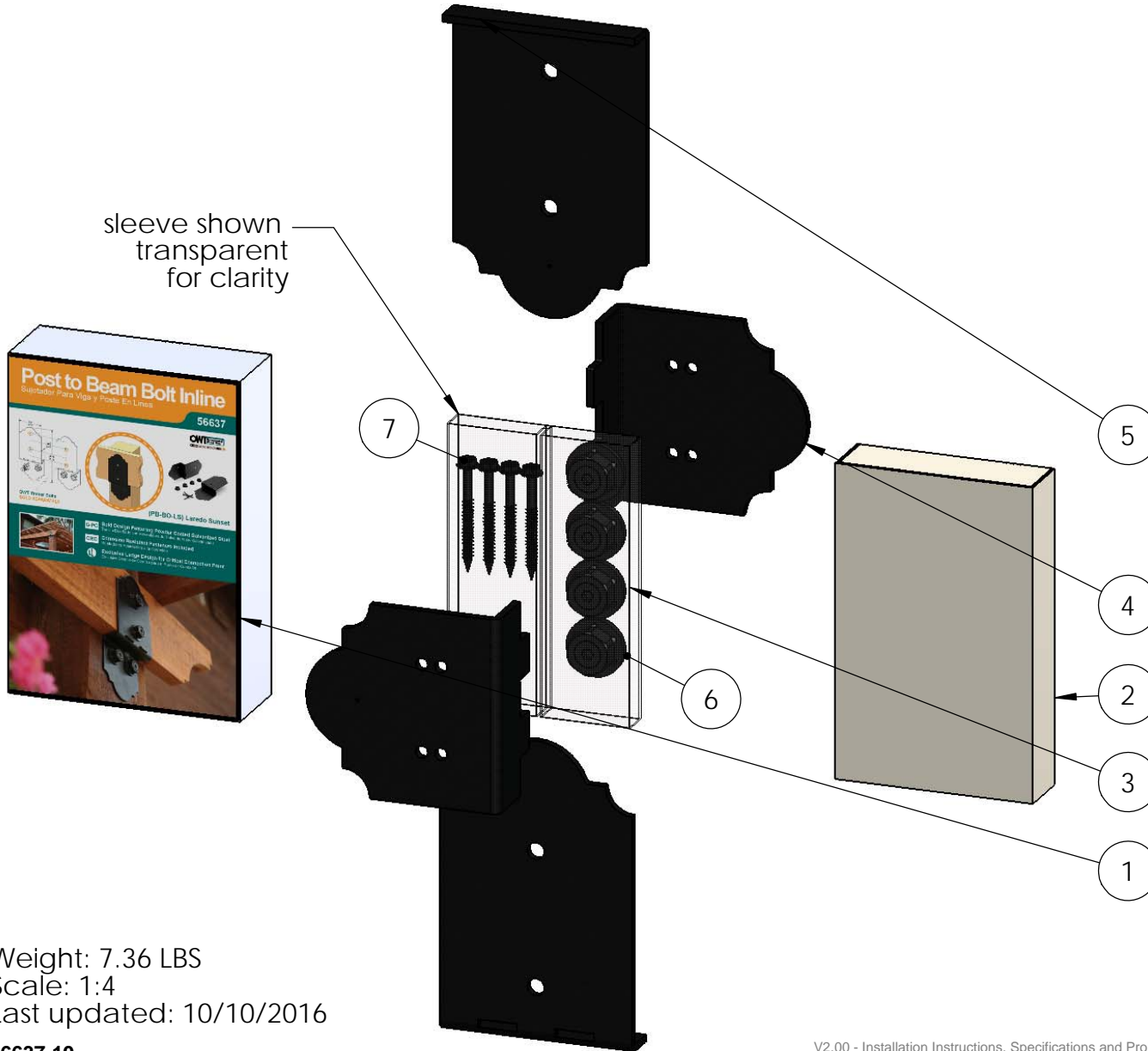

ITEM NO.	QTY.	PART NUMBER	DESCRIPTION
1	1	56637 Box	56637 Box
2	1	56637 Inner Box	56637 Inner Box
3	1	56637 Inner Box Sleeve	56637 Inner Box Sleeve
4	2	56610-11	Ledge, Post to Beam
5	2	56637-11	Plate, Compression
6	0.4	56621	1 1/2" Hex Cap Nut (HCN)
7	0.16	56626	OWT Timber Screw 2-3/4"

Weight: 7.36 LBS
 Scale: 1:4
 Last updated: 10/10/2016

56637-10

Product & Packaging Specs

56637 Packing

Item #: Case packing



Weight: 7.55 LBS
 Scale: 1:3
 Last updated: 10/10/2016

56637-10

Item #: **56637** | **P2B-BI-LS**
 Post to Beam Inline LS
PALLET 168 pcs
 SKU#: **56837**
 Weight: **1339** lbs
 LOT# _____ Priority# _____

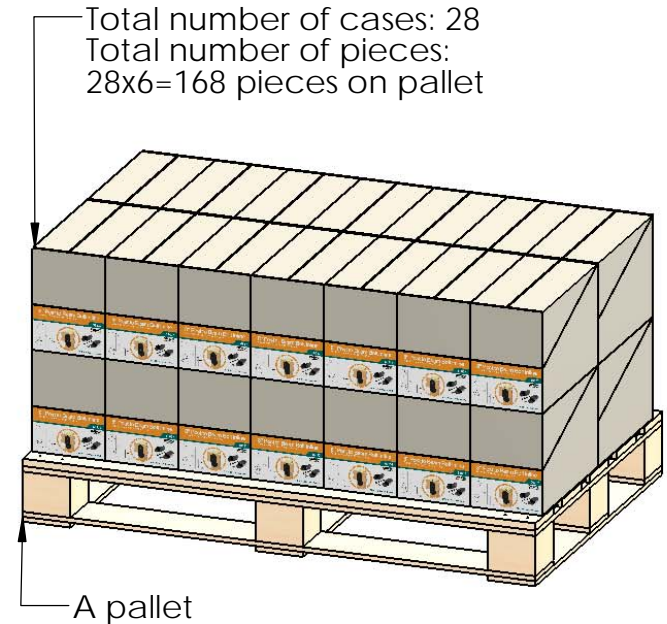
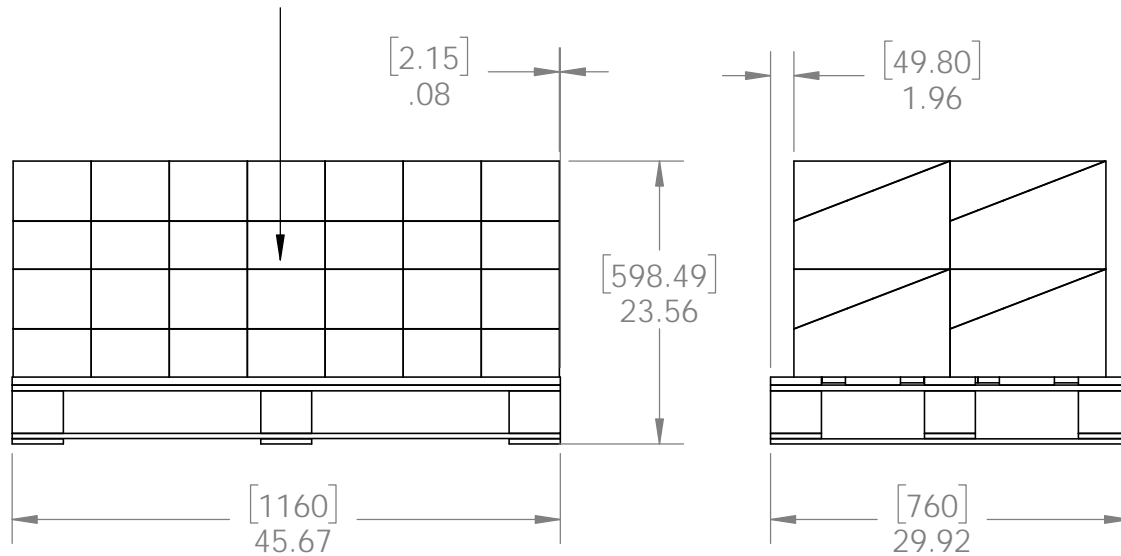

additional pallet packing instructions

- plywood on top layer
- strap to pallet
- clear wrap around boxes

Weight: 1339 LBS
 Scale: 1:16
 Last updated: 10/10/2016