



OZCO BUILDING PRODUCTS

Product & Packaging Specs

Post to Beam Bolt Offset (P2B-BO-LS)

Item #: 56636

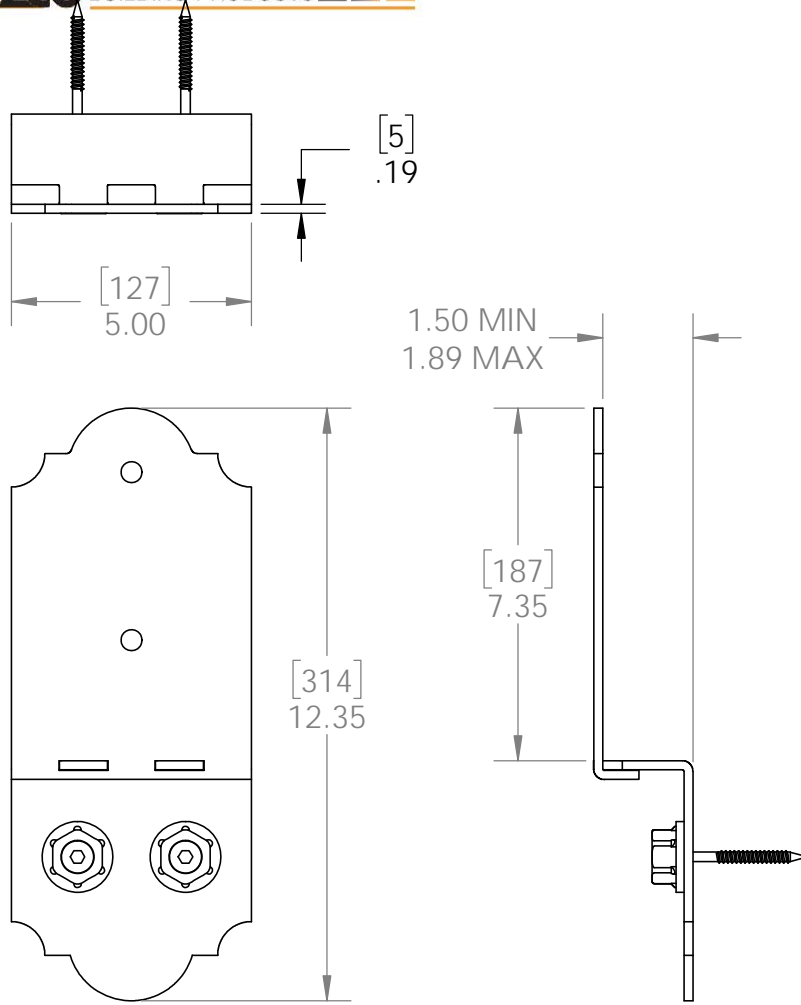

ITEM NO.	QTY.	PART NUMBER	DESCRIPTION
1	1	56636-11	Plate, Top Bolt Offset
2	1	56610-11	Ledge, Post to Beam
3	0.2	56621	1 1/2" Hex Cap Nut (HCN)
4	0.08	56626	OWT Timber Screw 2-3/4"

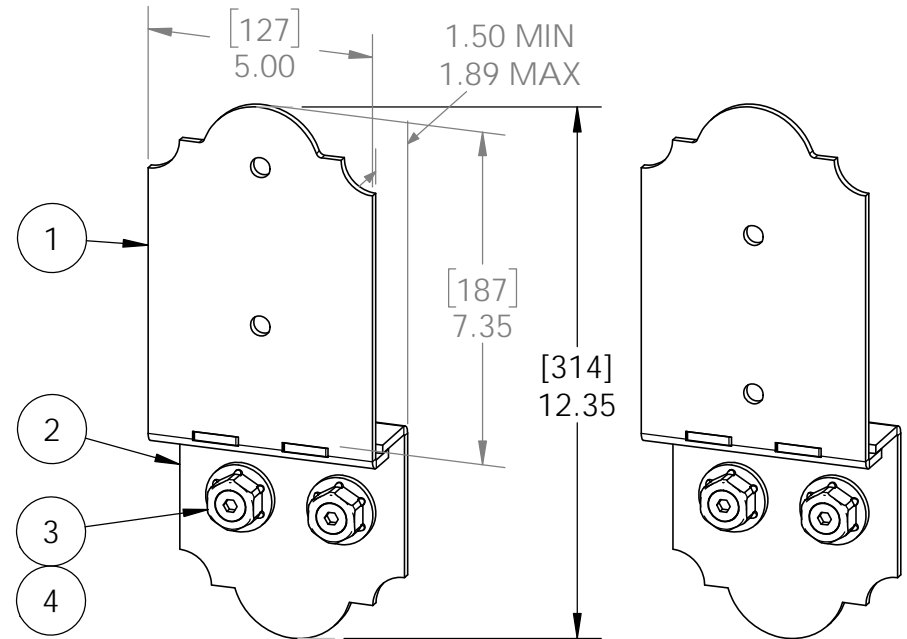

Weight: 3.64 LBS
 Scale: 1:4
 Last updated: 10/10/2016

TOP PLATE TIMBER BOLTS &/OR SCREWS SOLD SEPARATELY

56636-10

Product & Packaging Specs

Post to Beam Bolt Offset (P2B-BO-LS)

Item #: Typical Installation & Basic Assembly

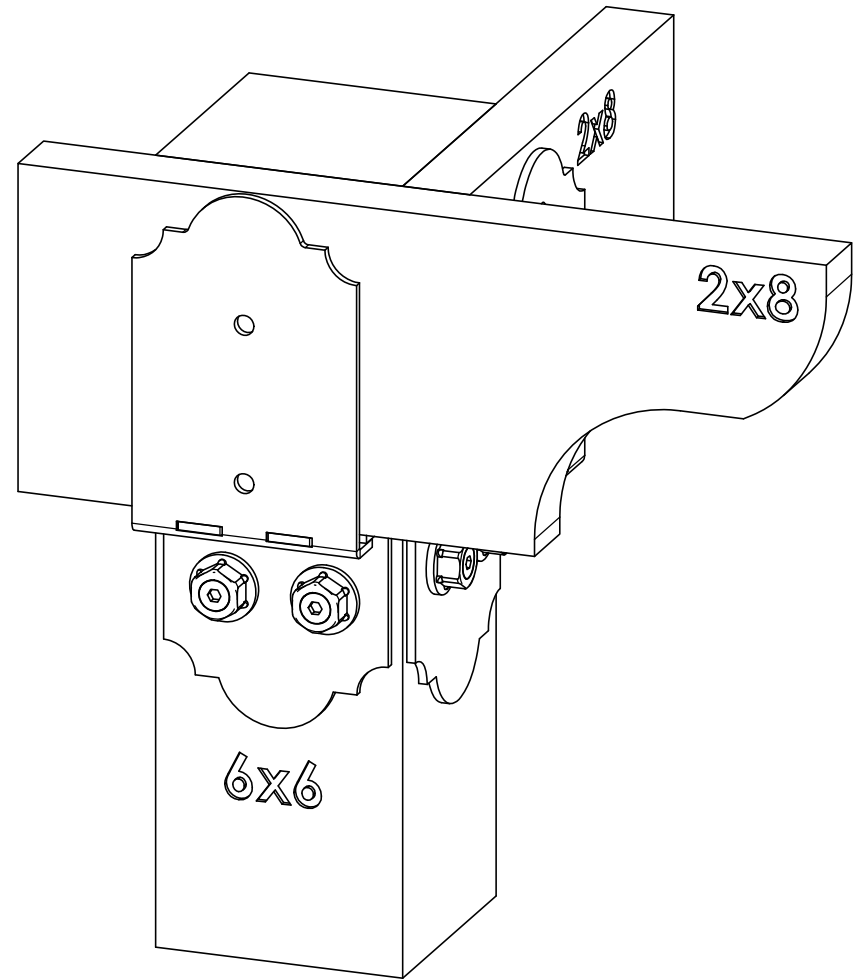
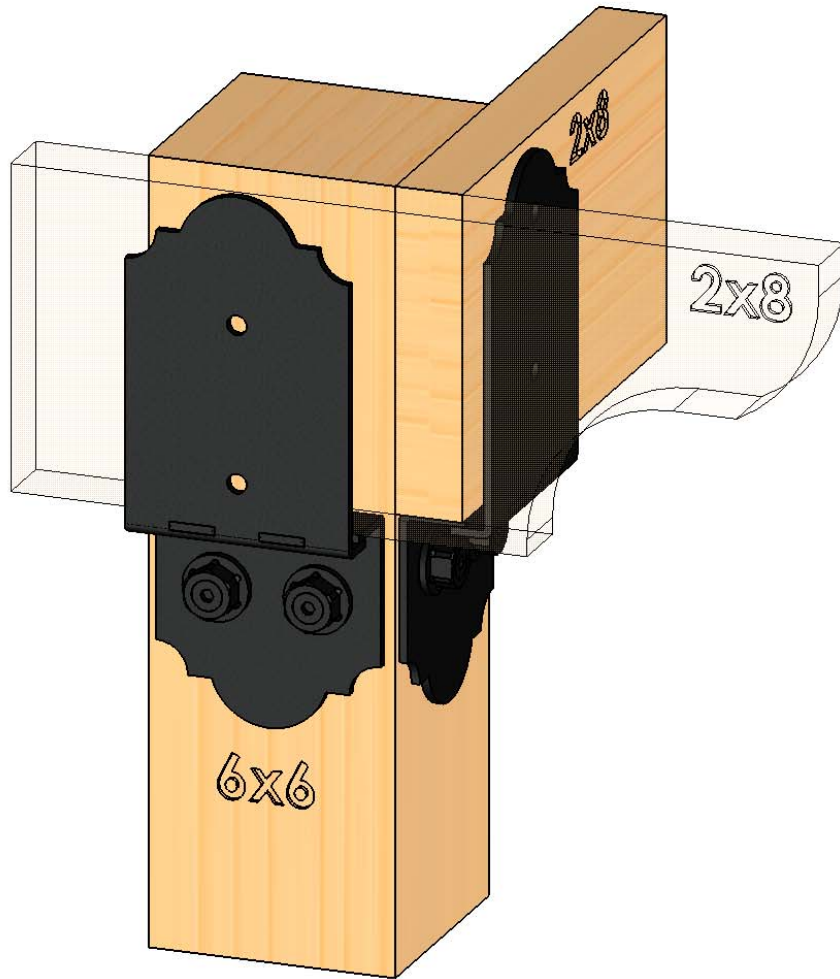

Weight: 3.64 LBS
Scale: 1:4
Last updated: 10/10/2016

TOP PLATE TIMBER BOLTS &/OR SCREWS SOLD SEPARATELY

Product & Packaging Specs

Post to Beam Bolt Offset (P2B-BO-LS)

Item #: Typical Installation & Basic Assembly

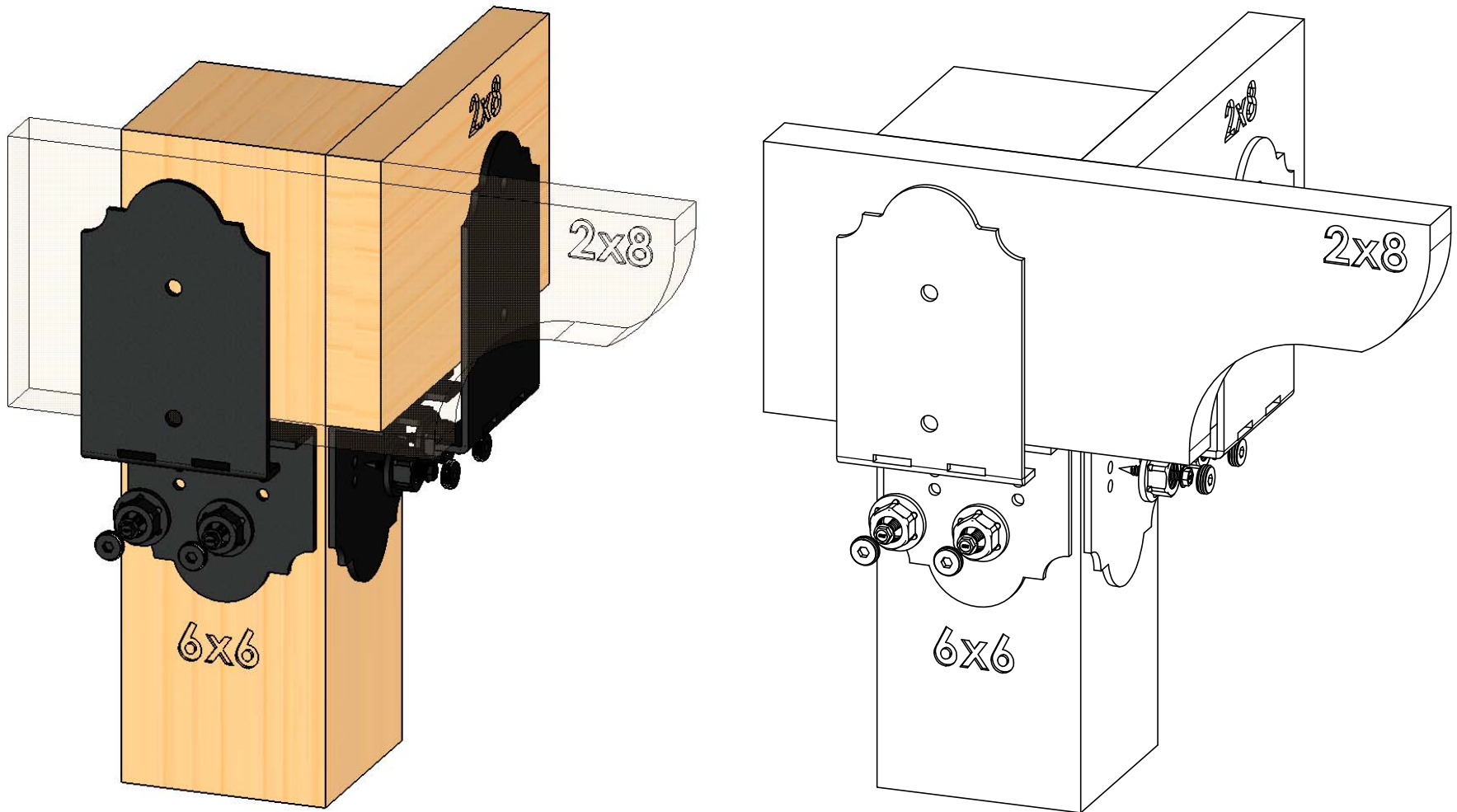

Weight: 3.64 LBS
Scale: 1:4
Last updated: 10/10/2016

TOP PLATE TIMBER BOLTS &/OR SCREWS SOLD SEPARATELY

Product & Packaging Specs

Post to Beam Bolt Offset (P2B-BO-LS)

Item #: Typical Installation & Basic Assembly

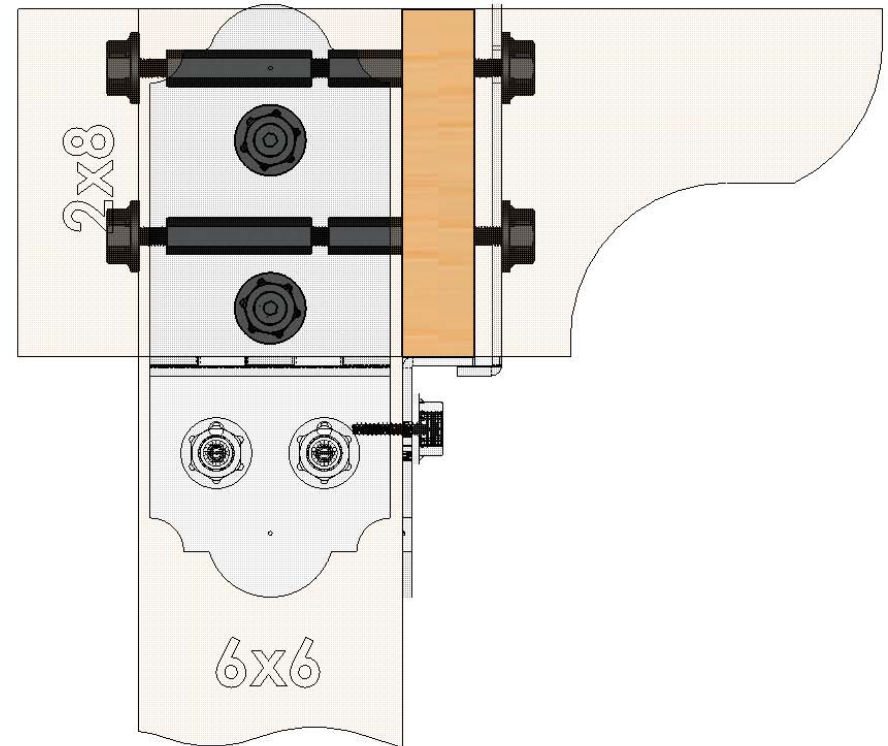
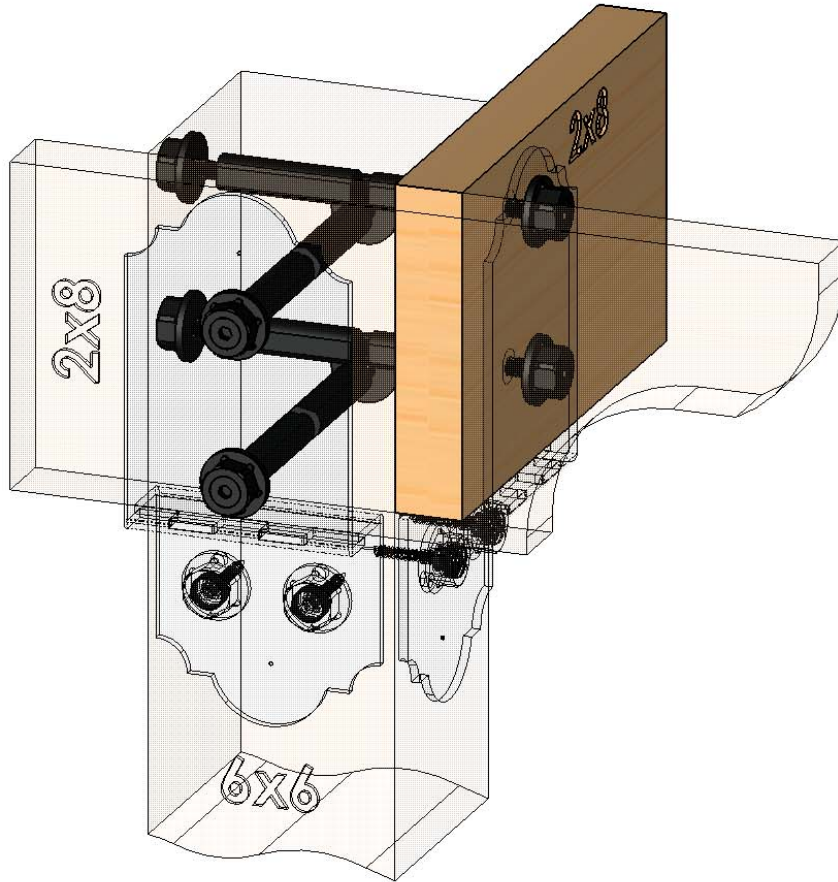

TOP PLATE TIMBER BOLTS &/OR SCREWS SOLD SEPARATELY

Weight: 36.16 LBS
Scale: 1:4
Last updated: 10/10/2016

56636-10



OZCO BUILDING PRODUCTS

Product & Packaging Specs

Post to Beam Bolt Offset (P2B-BO-LS)

Item #: Typical Installation & Basic Assembly

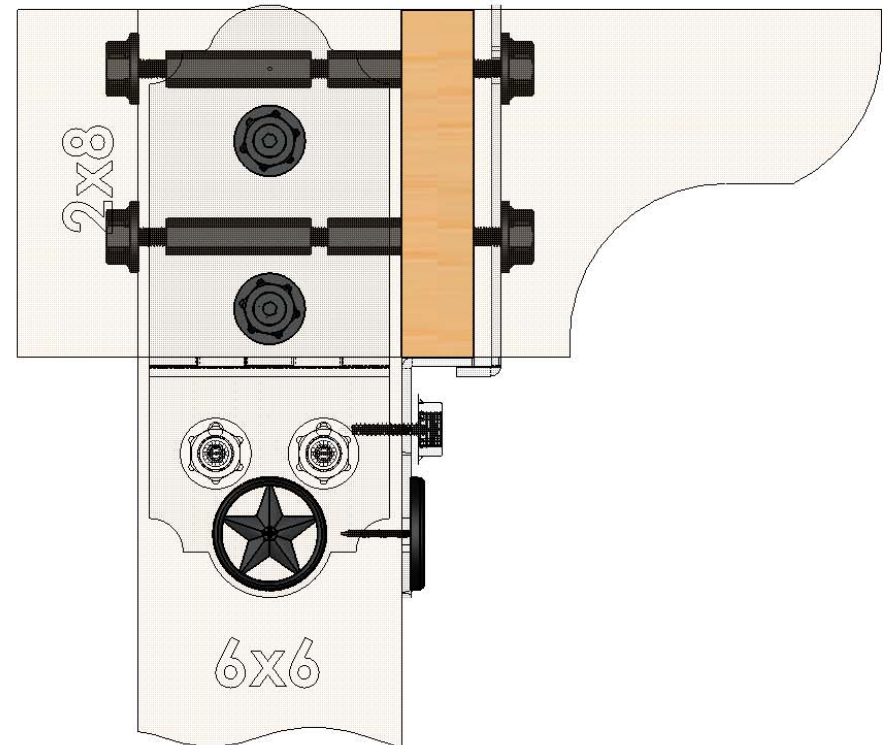
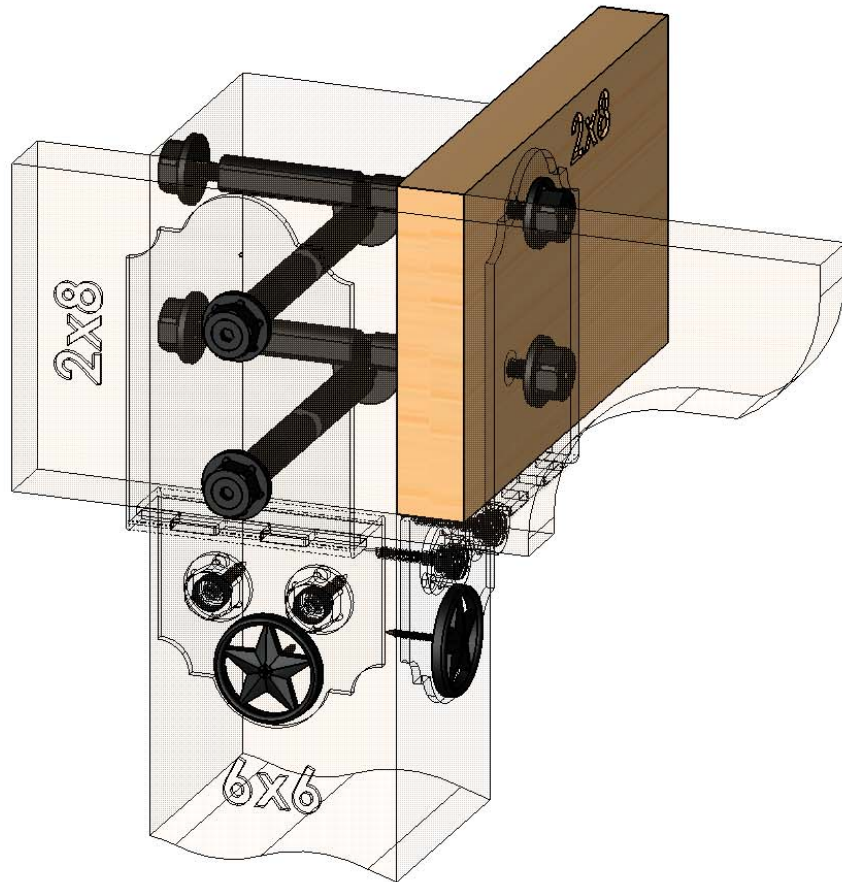

**TOP PLATE TIMBER BOLTS &/OR SCREWS SOLD SEPARATELY
STARTS SOLD SEPARATELY**

Weight: 36.16 LBS
Scale: 1:4
Last updated: 10/10/2016

56636-10

Product & Packaging Specs

Post to Beam Bolt Offset (P2B-BO-LS)

Item #: 56636

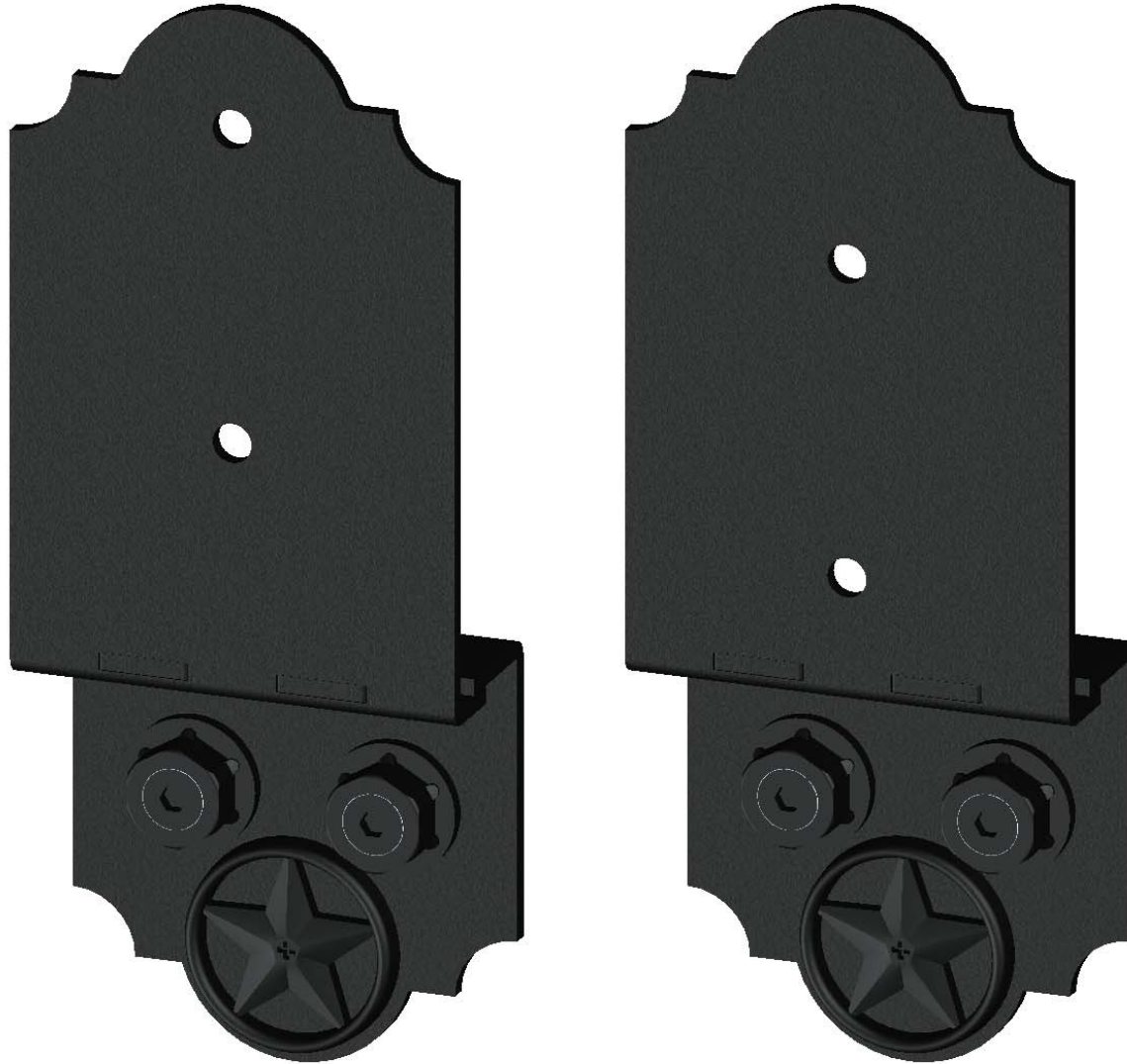

Weight: 3.64 LBS
Scale: 1:2
Last updated: 10/10/2016

TOP PLATE TIMBER BOLTS &/OR SCREWS SOLD SEPARATELY
STARTS SOLD SEPARATELY



OZCO BUILDING PRODUCTS

Product & Packaging Specs

Post to Beam Bolt Offset (P2B-BO-LS)

Item #: 56636

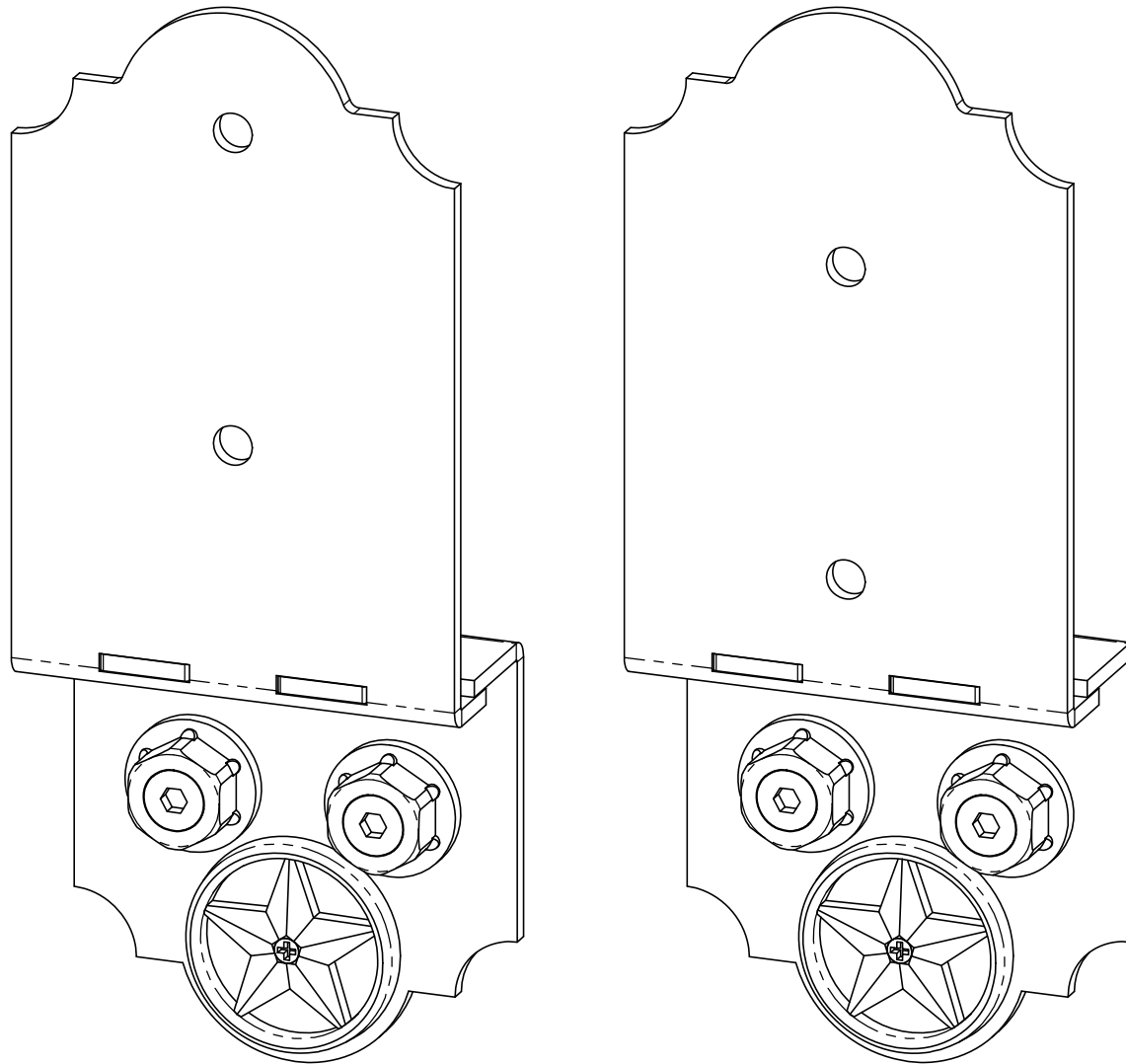

Weight: 3.64 LBS
Scale: 1:2
Last updated: 10/10/2016

TOP PLATE TIMBER BOLTS &/OR SCREWS SOLD SEPARATELY
STARTS SOLD SEPARATELY

56636-10



OZCO BUILDING PRODUCTS

Product & Packaging Specs

56636 Packing

Item #: Box packing

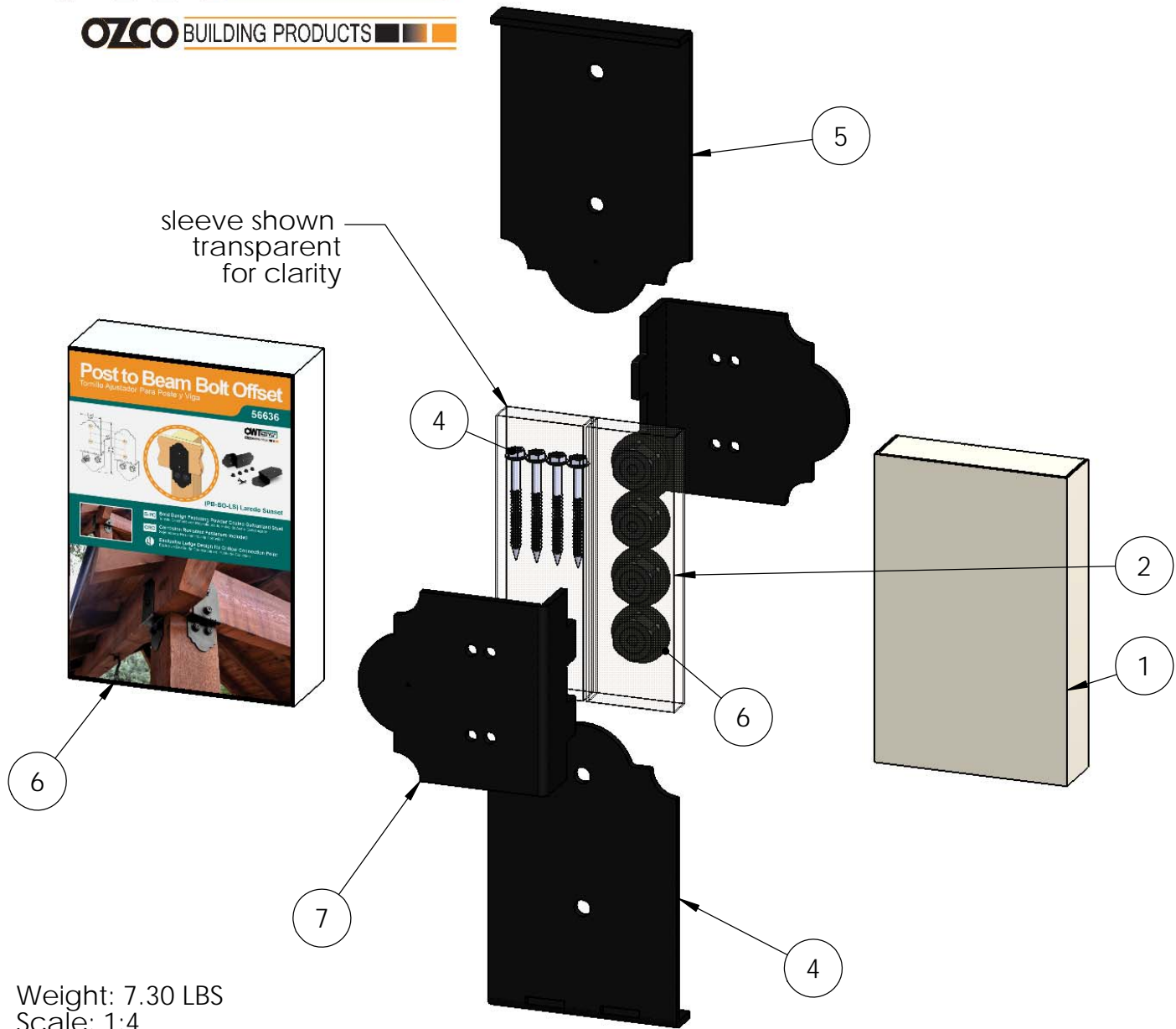

ITEM NO.	QTY.	PART NUMBER	DESCRIPTION
1	1	56637 Inner Box	56637 Inner Box
2	1	56637 Inner Box Sleeve	56637 Inner Box Sleeve
3	4	56626	OWT Timber Screw 2-3/4 (70mm)
4	1	56636-11	Plate, Top Bolt Offset
5	1	56637-11	Plate, Compression
6	1	56636 Box	Box, Post to Beam
7	2	56610-11	Ledge, Post to Beam
8	0.4	56621	1 1/2" Hex Cap Nut (HCN)

Weight: 7.30 LBS
 Scale: 1:4
 Last updated: 10/10/2016

56636-10

Product & Packaging Specs

56636 Packing

Item #: Case packing

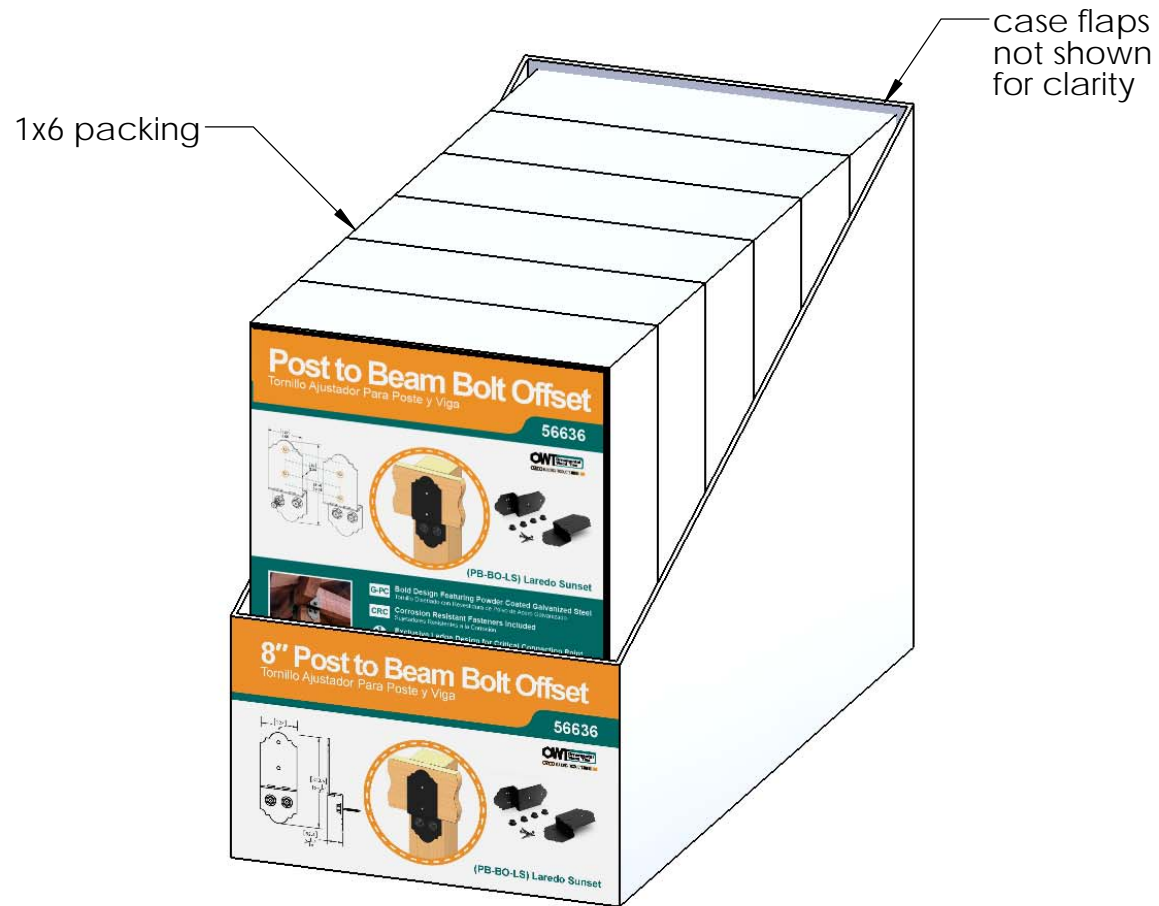

Weight: 45 LBS
 Scale: 1:3
 Last updated: 10/10/2016

56636-10

Item #: **56636** | **P2B-BO-LS**

Post to Beam Offset LS

PALLET **168 pcs**

SKU#: 56836



Weight: 1340 lbs

LOT# _____ Priority# _____

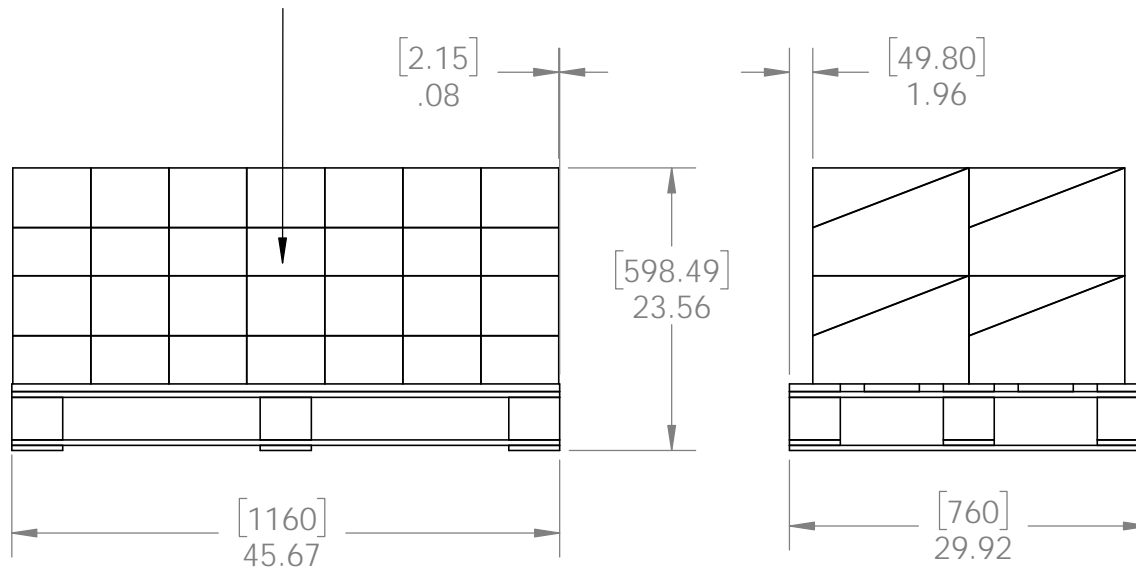

Total number of cases: 28
 Total number of pieces:
 28x6=168 pieces on pallet

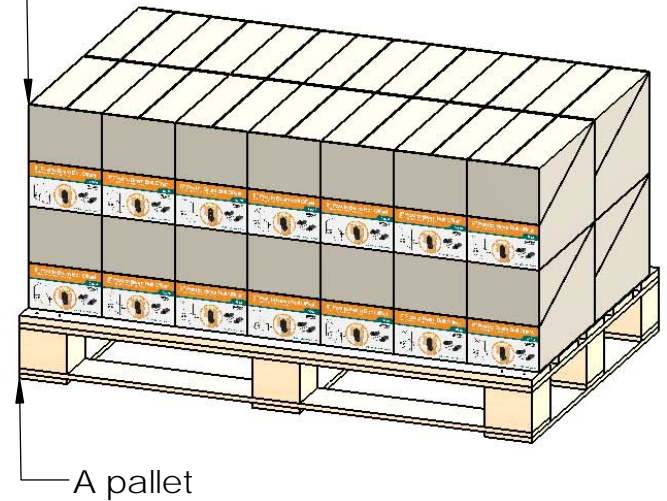

additional pallet packing instructions

- plywood on top layer
- strap to pallet
- clear wrap around boxes

Weight: 1340 LBS
 Scale: 1:16
 Last updated: 10/10/2016