

Product & Packaging Specs

8" Post to Beam Flush (P2B-LS-8F)

Item #: 56676

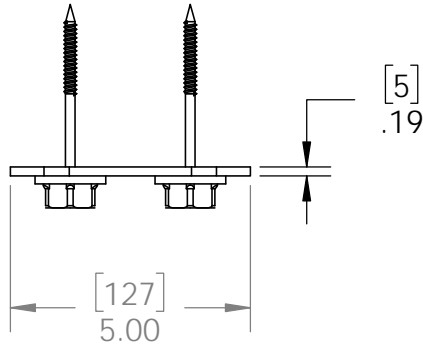

ITEM NO.	QTY.	PART NUMBER	DESCRIPTION
1	1	56676-11	Bracket, 8" Flush Post to Beam
2	2	56621	1 1/2" Hex Cap Nut (HCN)
3	2	56627	OWT Timber Screw 3-3/4"

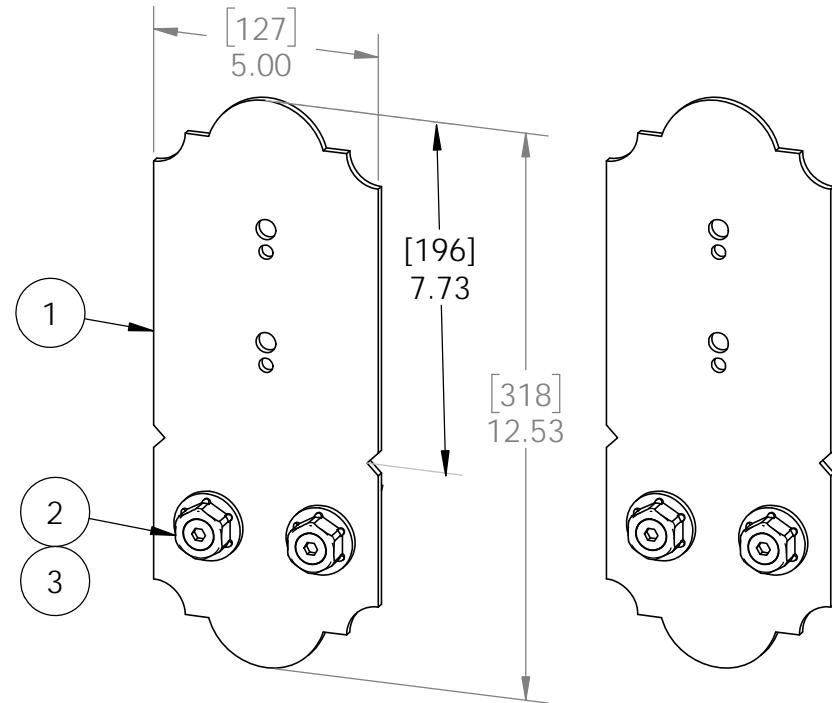
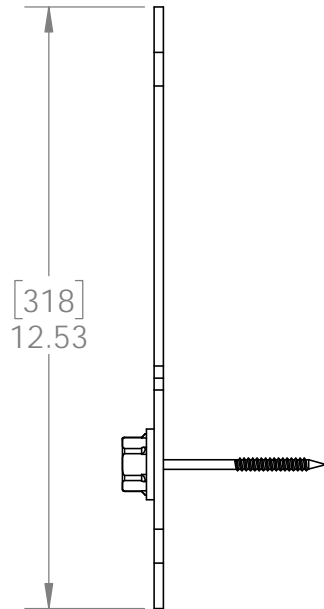
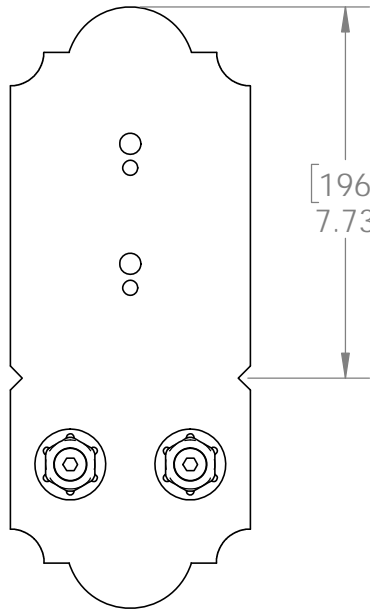

Weight: 3.01 LBS
 Scale: 1:4
 Last updated: 10/10/2016

TOP HOLES REQUIRE TIMBER BOLTS &/OR SCREWS - SOLD SEPARATELY

Product & Packaging Specs

8" Post to Beam Flush (P2B-LS-8F)

Item #: 56676

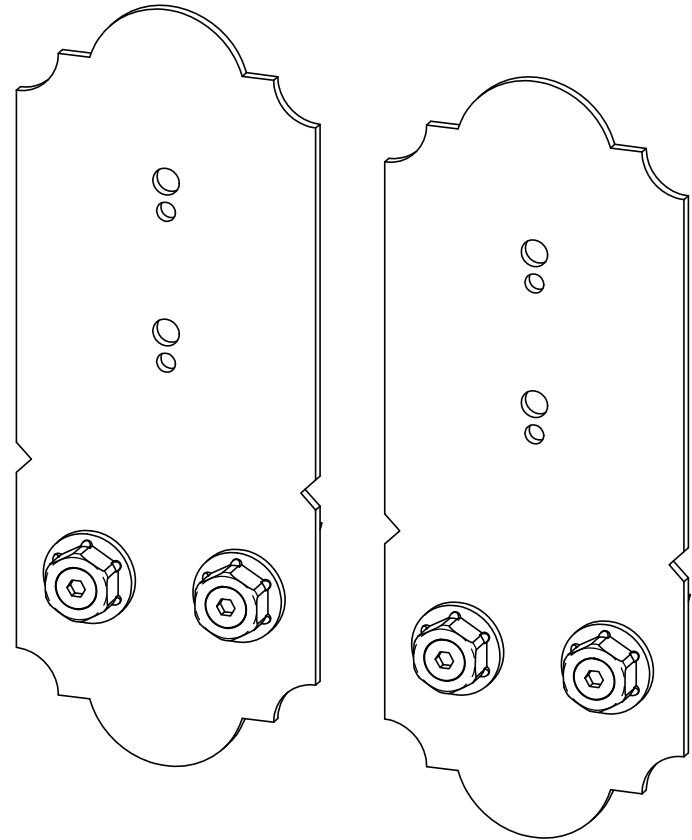
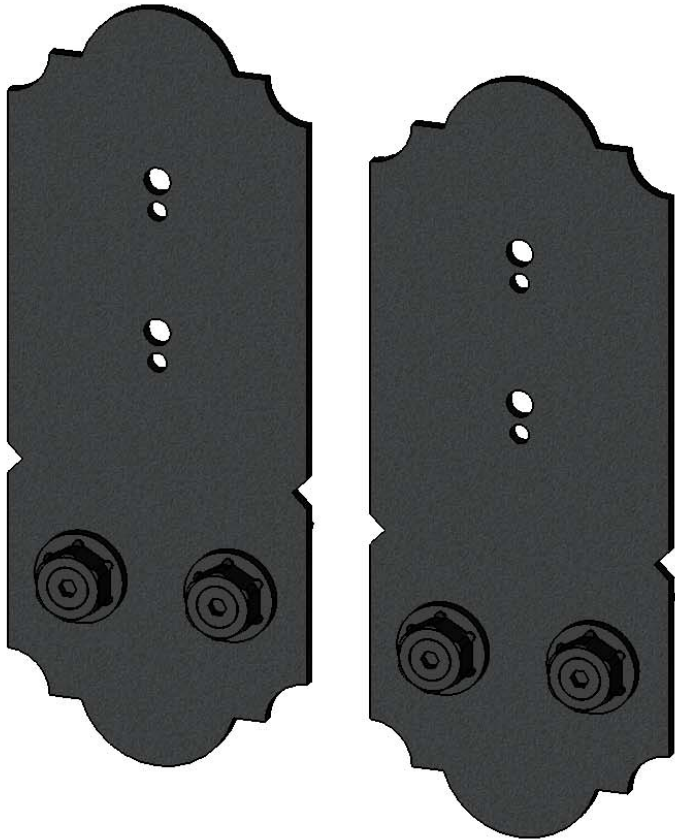

Weight: 3.01 LBS
Scale: 1:3
Last updated: 10/10/2016

TOP HOLES REQUIRE TIMBER BOLTS &/OR SCREWS - SOLD SEPARATELY

Product & Packaging Specs

8" Post to Beam Flush (P2B-LS-8F)

Item #: Typical Installation & Basic Assembly

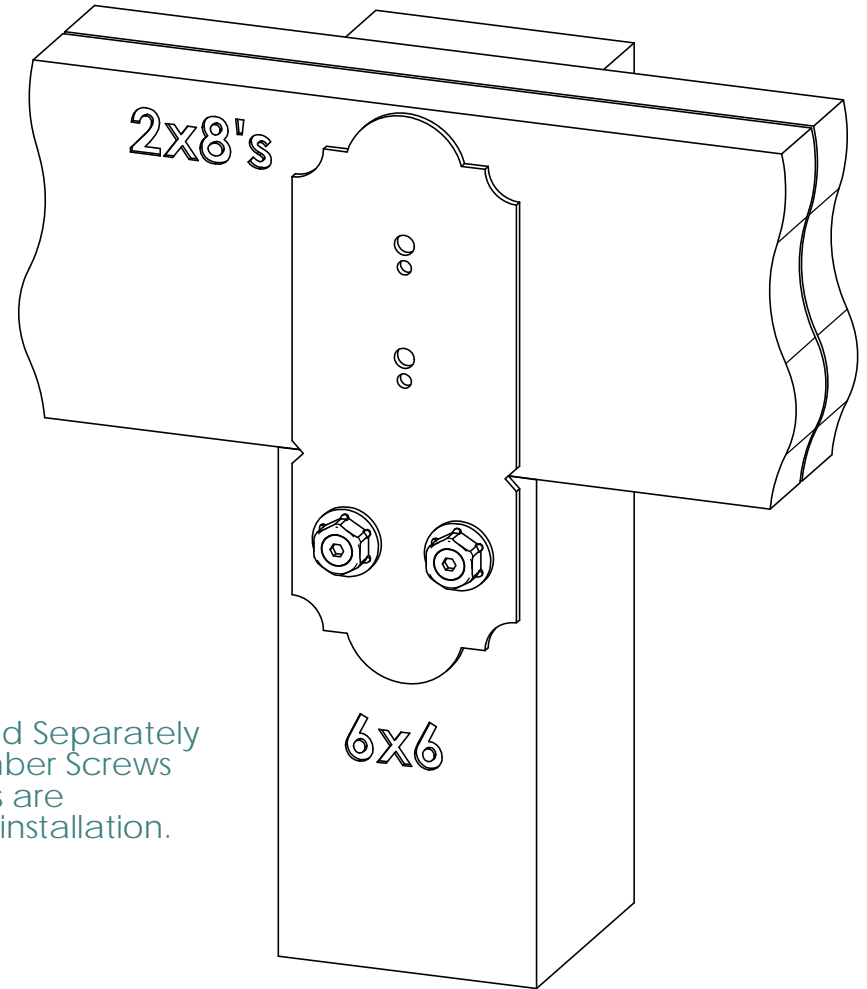
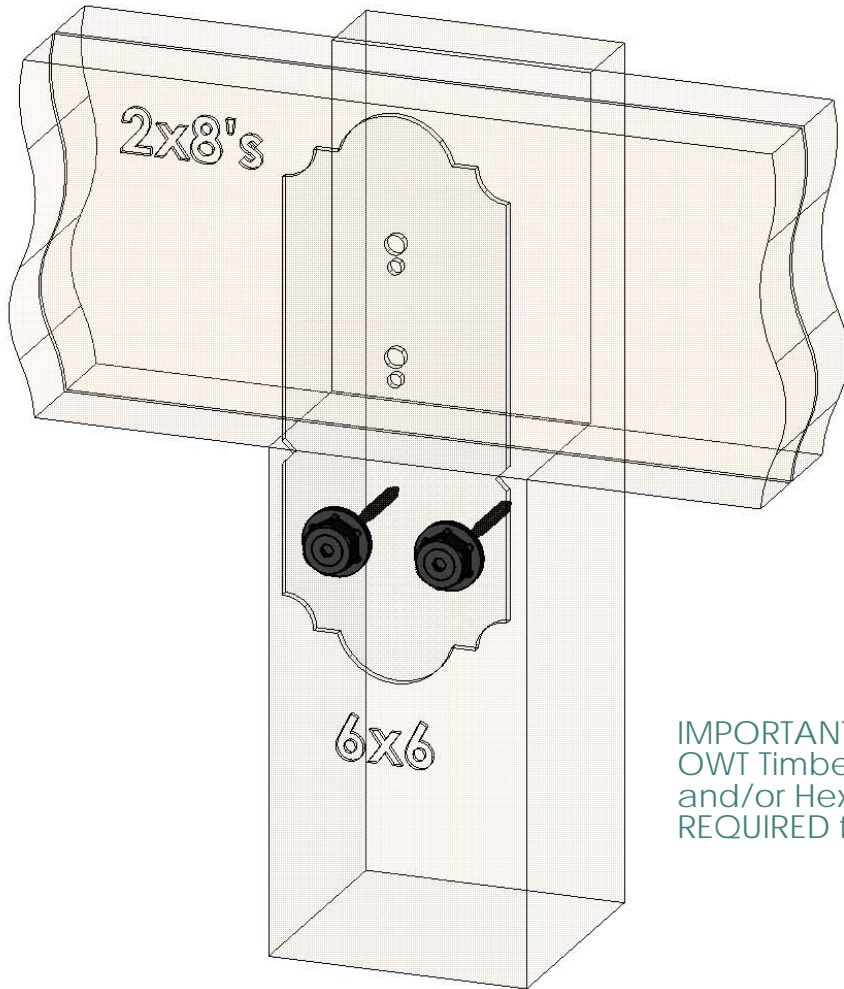

IMPORTANT: Each Sold Separately
OWT Timber Bolts, Timber Screws
and/or Hex Cap Nuts are
REQUIRED for proper installation.

TOP HOLES REQUIRE TIMBER BOLTS &/OR SCREWS - SOLD SEPARATELY

Weight: LBS
Scale: 1:4
Last updated: 10/10/2016

56676

Product & Packaging Specs

8" Post to Beam Flush (P2B-LS-8F)

Item #: Typical Installation & Basic Assembly

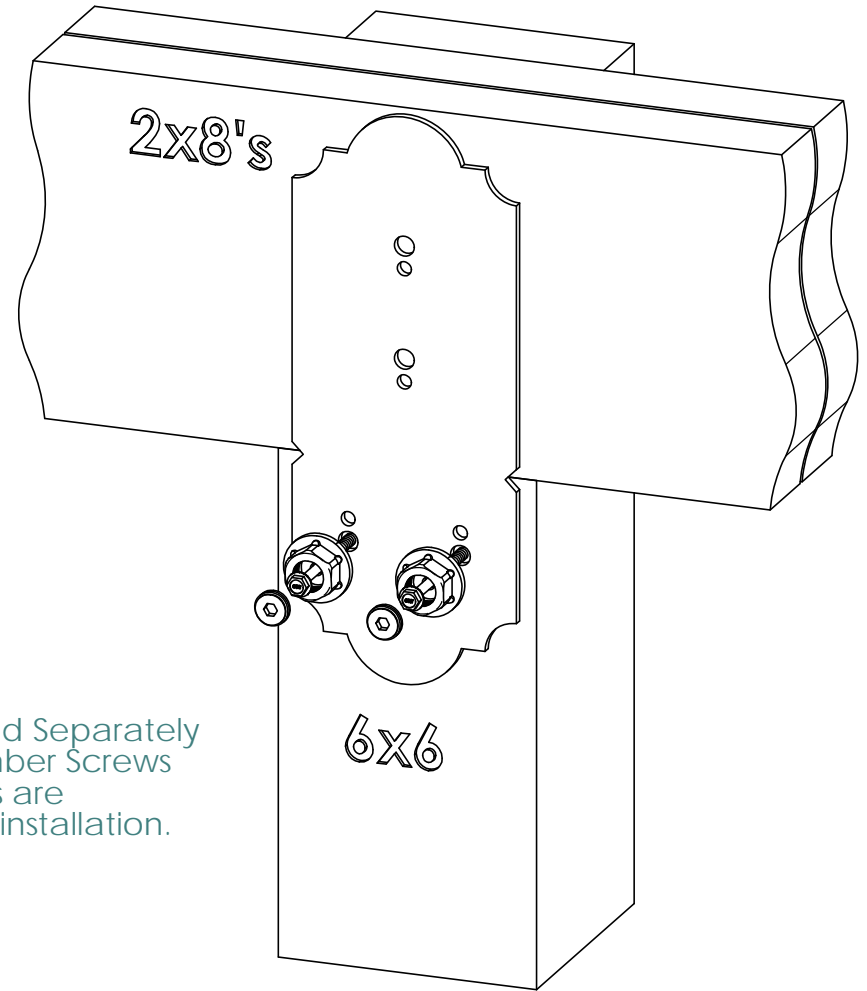
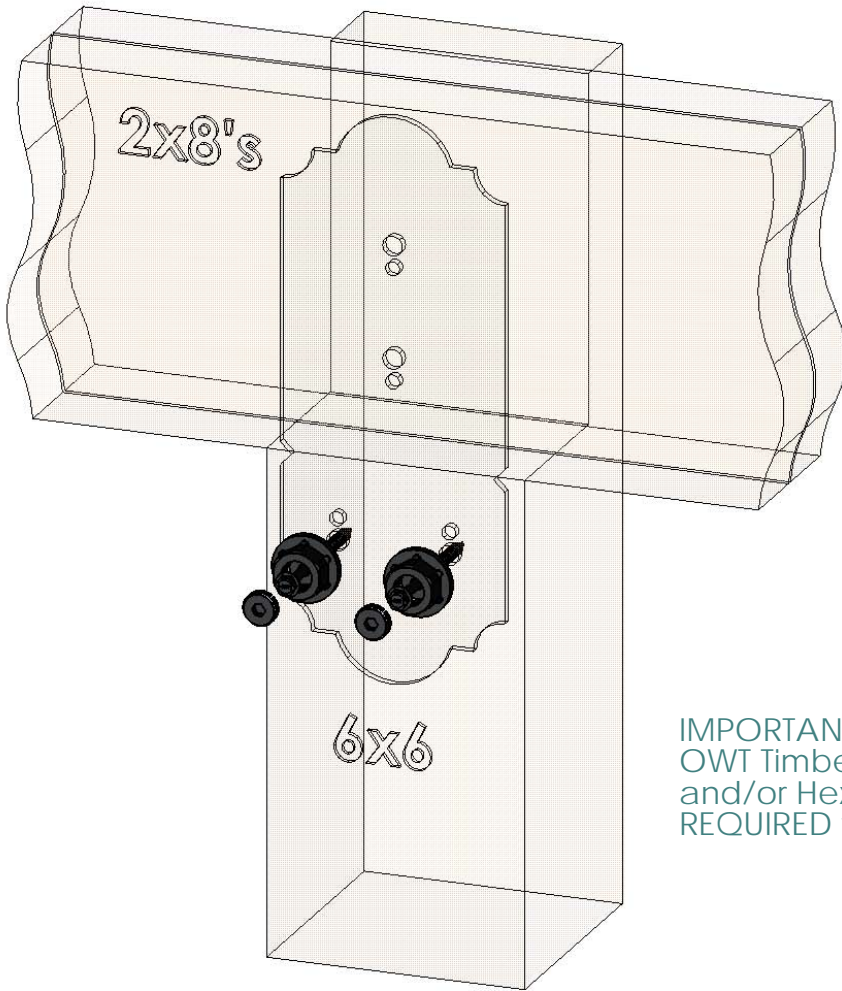

IMPORTANT: Each Sold Separately
OWT Timber Bolts, Timber Screws
and/or Hex Cap Nuts are
REQUIRED for proper installation.

TOP HOLES REQUIRE TIMBER BOLTS &/OR SCREWS - SOLD SEPARATELY

Weight: LBS
Scale: 1:4
Last updated: 10/10/2016

56676



OZCO BUILDING PRODUCTS

Product & Packaging Specs

8" Post to Beam Flush (P2B-LS-8F)

Item #: Typical Installation with Timber Bolts & 56680

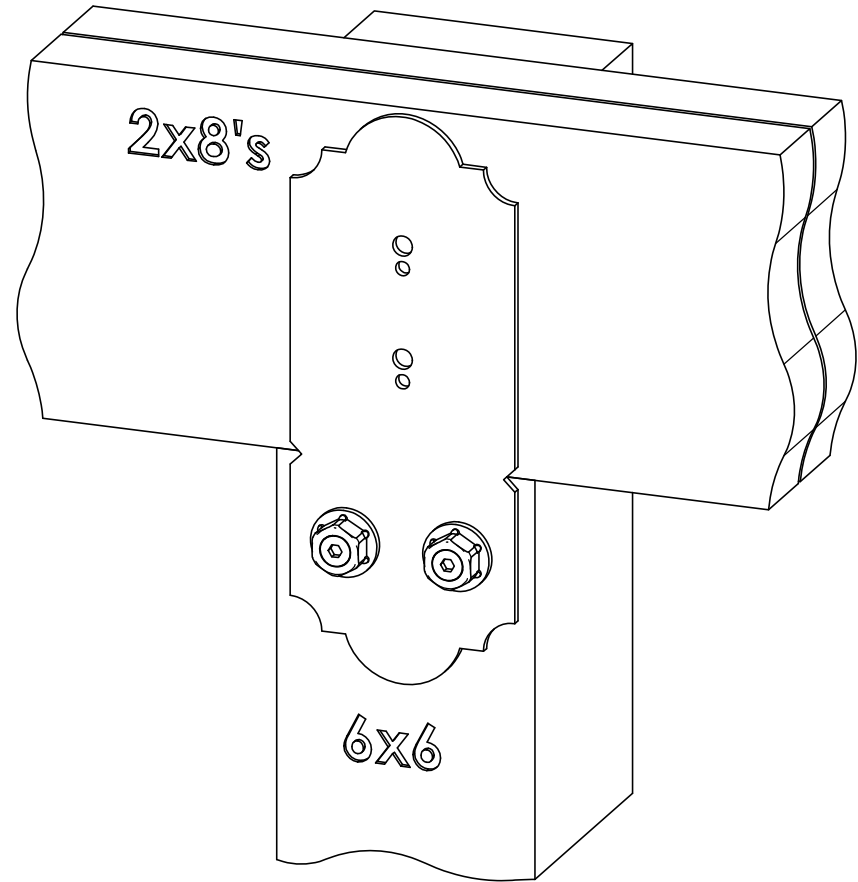
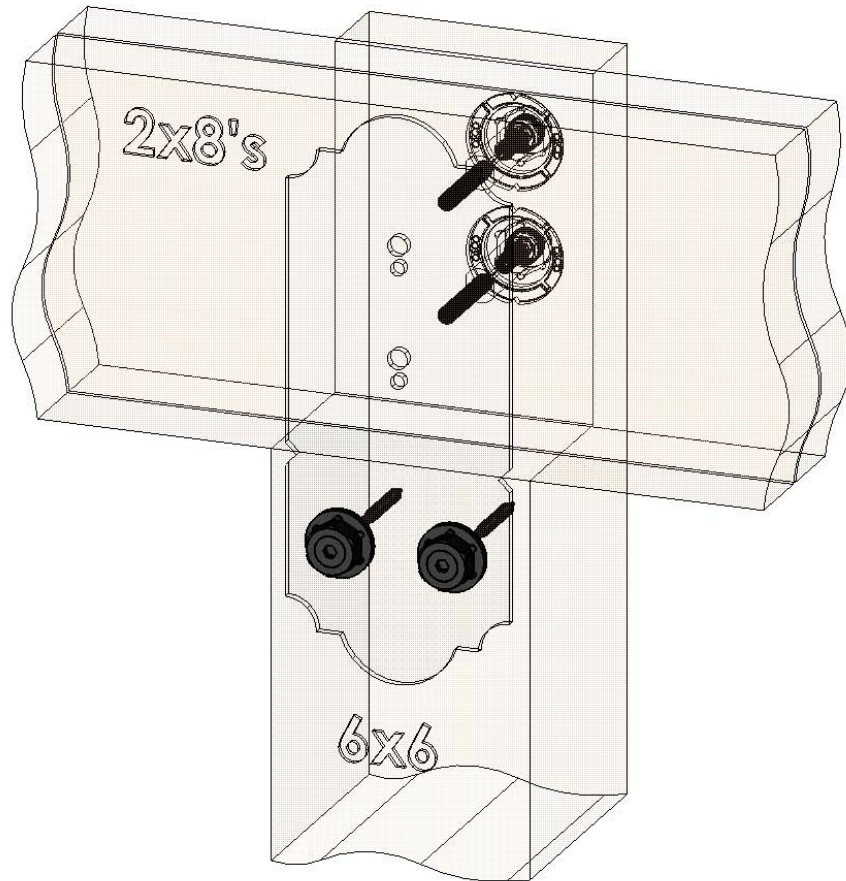

Weight: LBS
Scale: 1:4
Last updated: 10/10/2016

TOP HOLES REQUIRE TIMBER BOLTS &/OR SCREWS - SOLD SEPARATELY

56676

V2.00 - Installation Instructions, Specifications and Project Plans are effective 10/10/2016 . This information is updated periodically and should not be relied upon after 2 years from 10/10/2016 . Please visit OZCOBP.com to get current information.

Product & Packaging Specs

8" Post to Beam Flush (P2B-LS-8F)

Item #: Typical Installation with Timber Screws

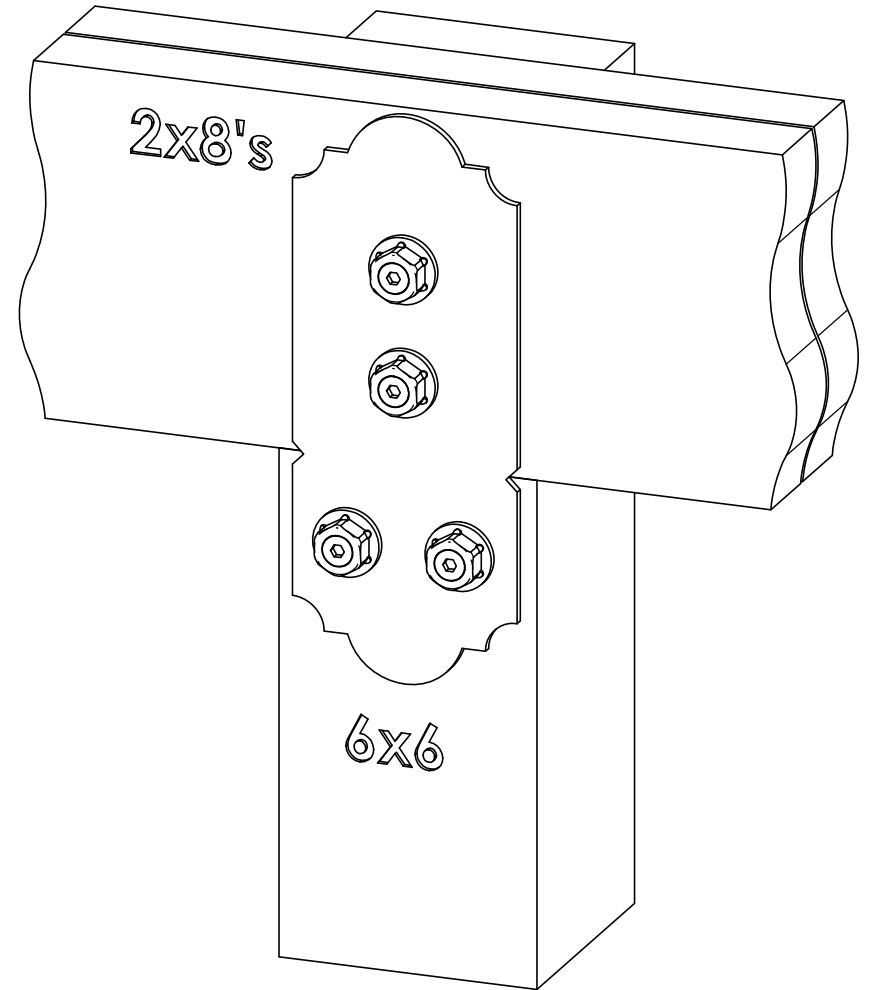
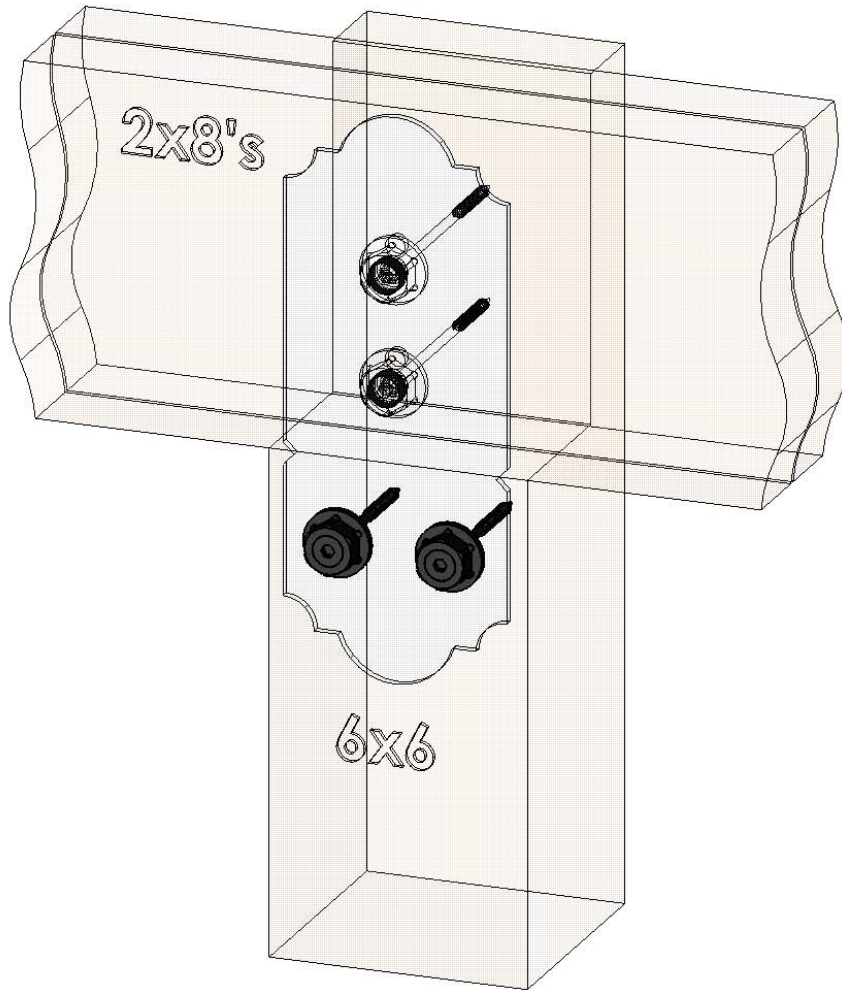

Weight: LBS
Scale: 1:4
Last updated: 10/10/2016

TOP HOLES REQUIRE TIMBER BOLTS &/OR SCREWS - SOLD SEPARATELY

Product & Packaging Specs

56676 Packing
 Item #: Box packing

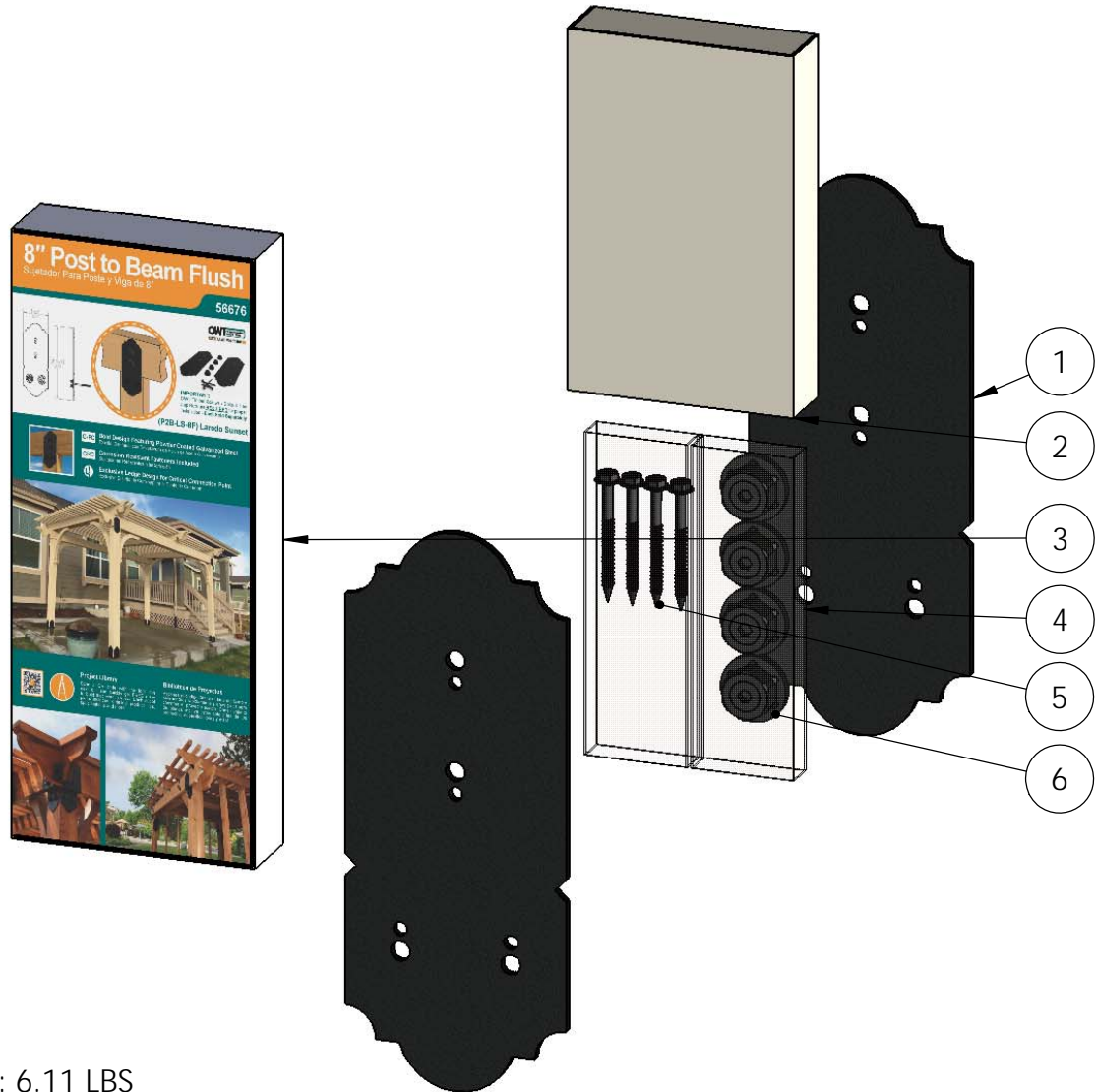

ITEM NO.	QTY.	PART NUMBER	DESCRIPTION
1	2	56676-11	Bracket, 8" Flush Post to Beam
2	1	56637 Inner Box	56637 Inner Box
3	1	Box, 56676	Box, 56676
4	1	56637 Inner Box Sleeve	56637 Inner Box Sleeve
5	0.16	56626	OWT Timber Screw 2-3/4"
6	0.4	56621	1 1/2" Hex Cap Nut (HCN)

Weight: 6.11 LBS
 Scale: 1:4
 Last updated: 10/10/2016

Product & Packaging Specs

56676 Packing

Item #: Case packing



Weight: 37 LBS
Scale: 1:4
Last updated: 10/10/2016

56676



OZCO BUILDING PRODUCTS

Product & Packaging Specs

56676 Packing

Item #: Pallet packing

Item #: **56676** | **P2B-LS-8F**

8" POST TO BEAM FLUSH
LAREDO SUNSET

PALLET | **180 pcs**

SKU#: **56876**



Weight: **545** lbs

LOT# Priority# OWT OZCO

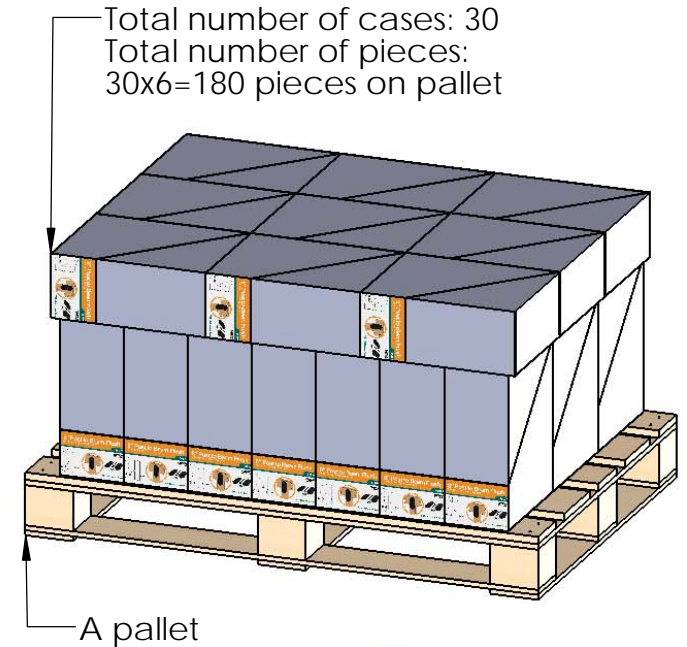
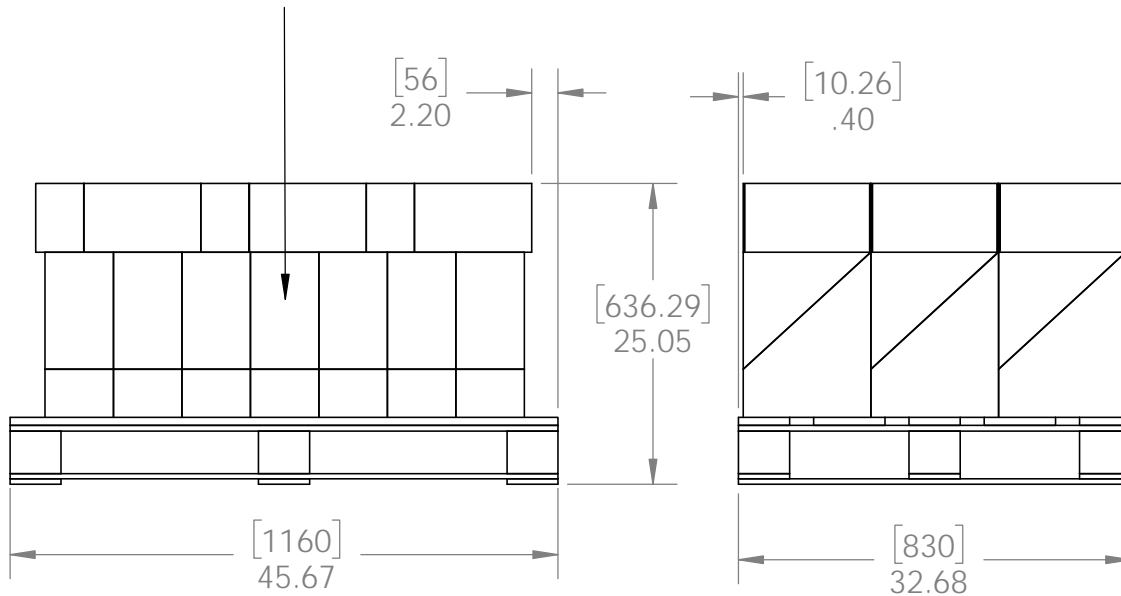

additional pallet packing instructions
 plywood on top layer
 strap to pallet
 clear wrap around boxes

Weight: 545 LBS
 Scale: 1:16
 Last updated: 10/10/2016

56676