

# Product & Packaging Specs

## 6" Post to Beam (P2B-IW-6)

Item #: 51735

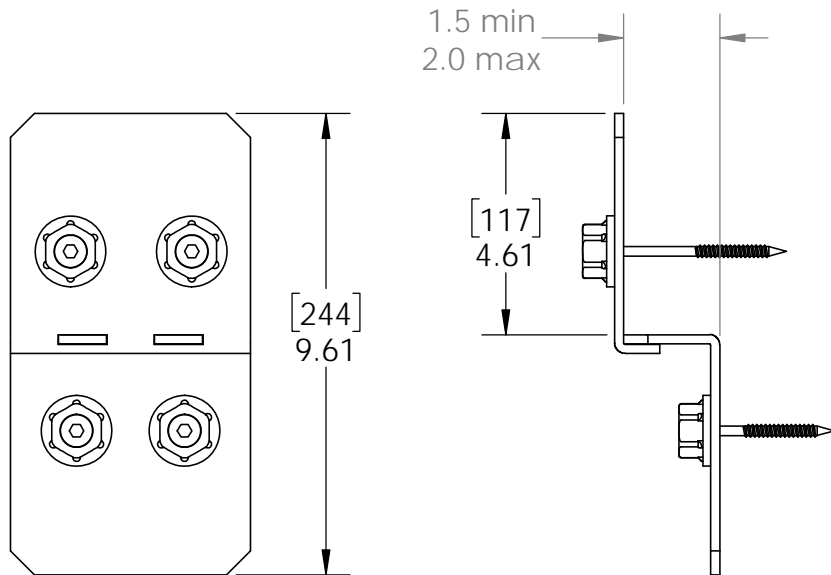
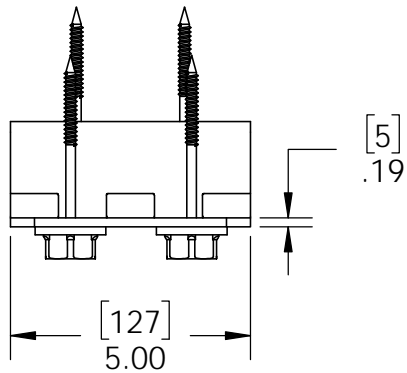

ITEM NO.	QTY.	PART NUMBER	DESCRIPTION
1	0.08	56626	OWT Timber Screw 2-3/4"
2	0.4	56621	1 1/2" Hex Cap Nut (HCN)
3	0.08	56627	OWT Timber Screw 3-3/4"
4	1	51710-11	Ledge, Post to Beam
5	1	51735-11	Plate, Top 6" Post to Beam

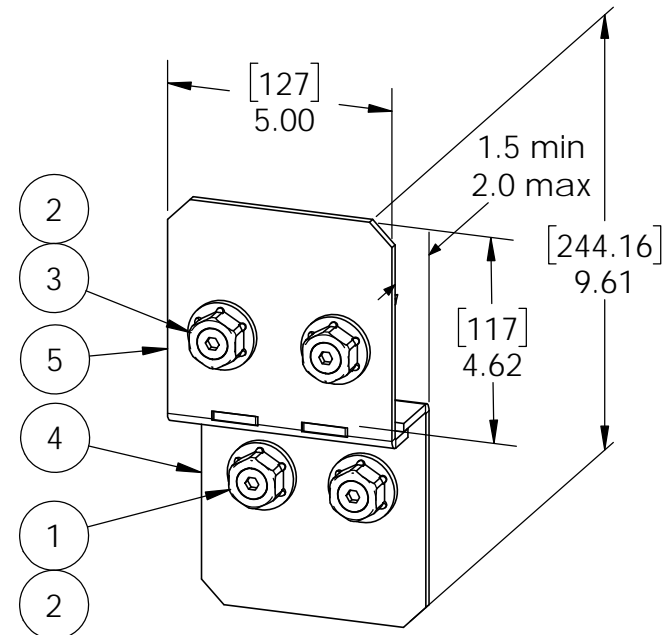

kit contains 2 assemblies

Weight: 3.43 LBS  
Scale: 1:4  
Last updated: 10/10/2016

51735

# Product & Packaging Specs

## 6" Post to Beam (P2B-IW-6)

Item #: Typical Installation & Basic Assembly

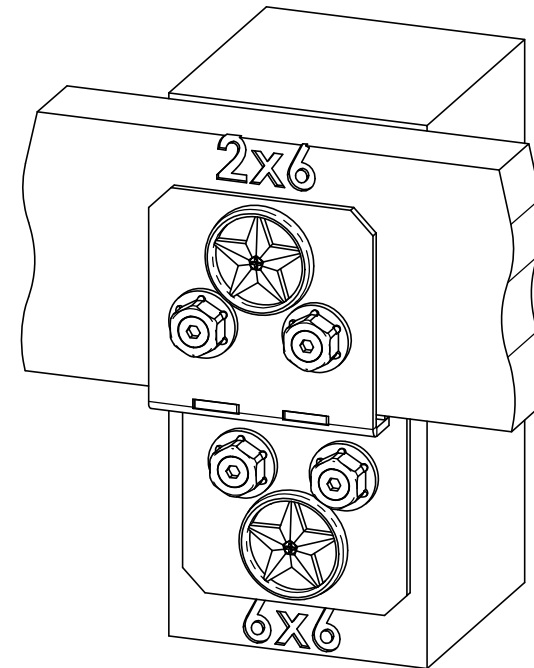
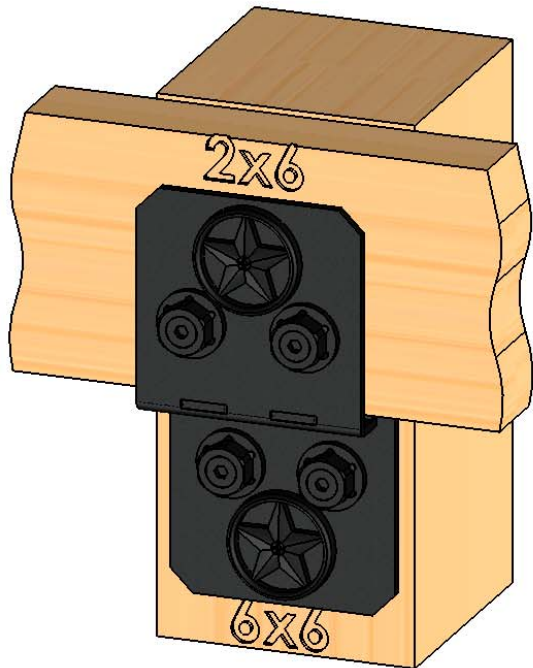

Scale: 1:4  
Last updated: 10/10/2016

51735

# Product & Packaging Specs

## 6" Post to Beam (P2B-IW-6)

Item #: Typical Installation & Basic Assembly

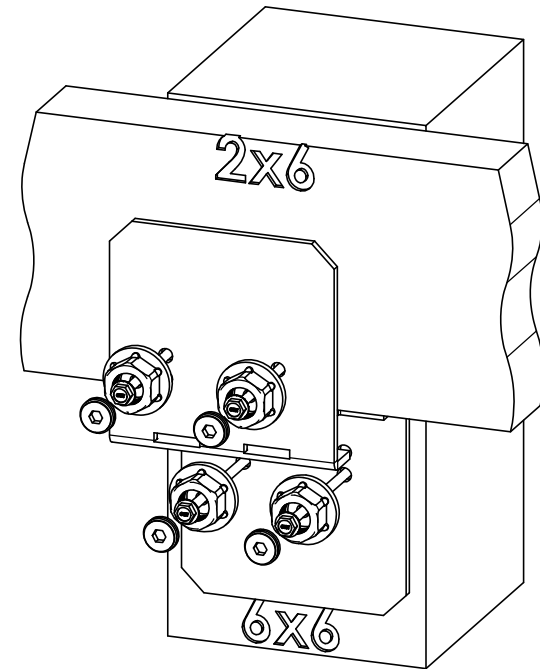
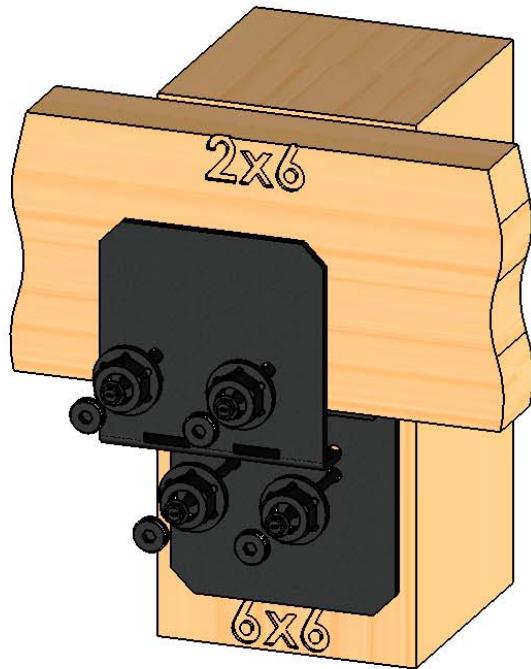

Scale: 1:4  
Last updated: 10/10/2016

51735

# Product & Packaging Specs

## 6" Post to Beam (P2B-IW-6)

Item #: 51735

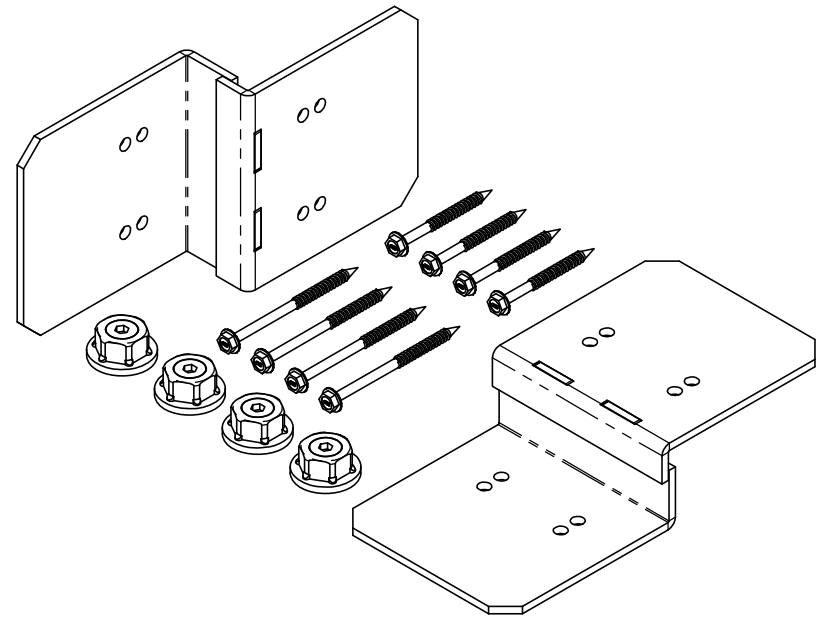
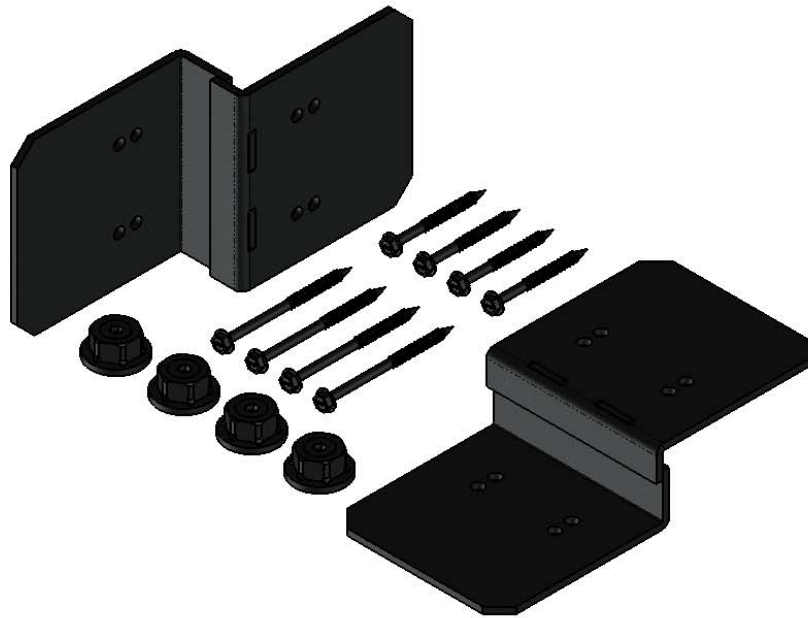

Scale: 1:4  
Last updated: 10/10/2016

51735



OZCO BUILDING PRODUCTS

# Product & Packaging Specs

## Ledge, Post to Beam

Item #: 51710-11

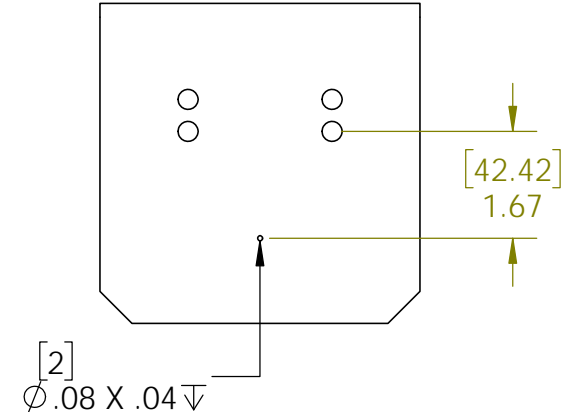
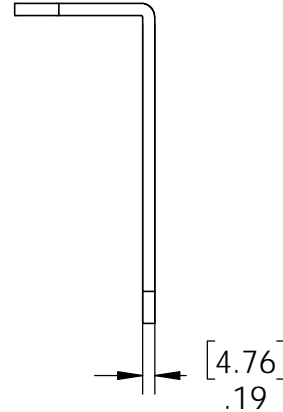
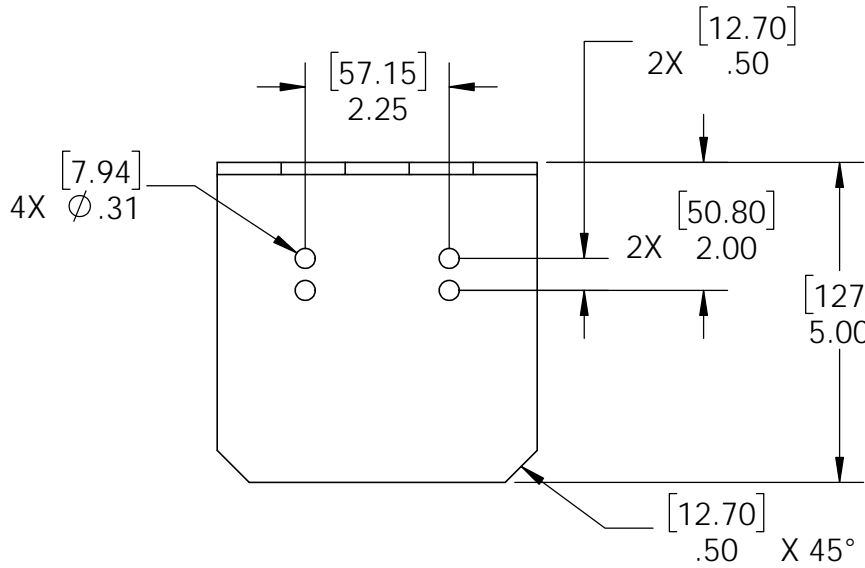
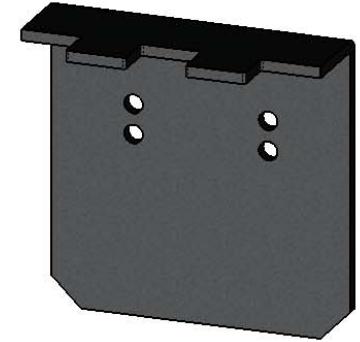
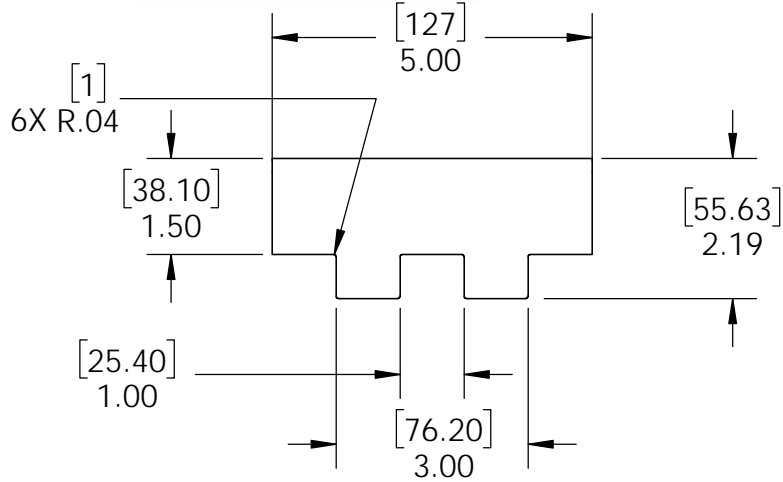

Material: ASTM A36 Steel  
 Finish: Black Powder Coat  
 Weight: 1.71 LBS  
 Scale: 1:3  
 Last updated: 10/10/2016

this part is common to 51710, 51735, 51736 & 51737

V2.00 - Installation Instructions, Specifications and Project Plans are effective 10/10/2016. This information is updated periodically and should not be relied upon after 2 years from 10/10/2016. Please visit OZCOBP.com to get current information.

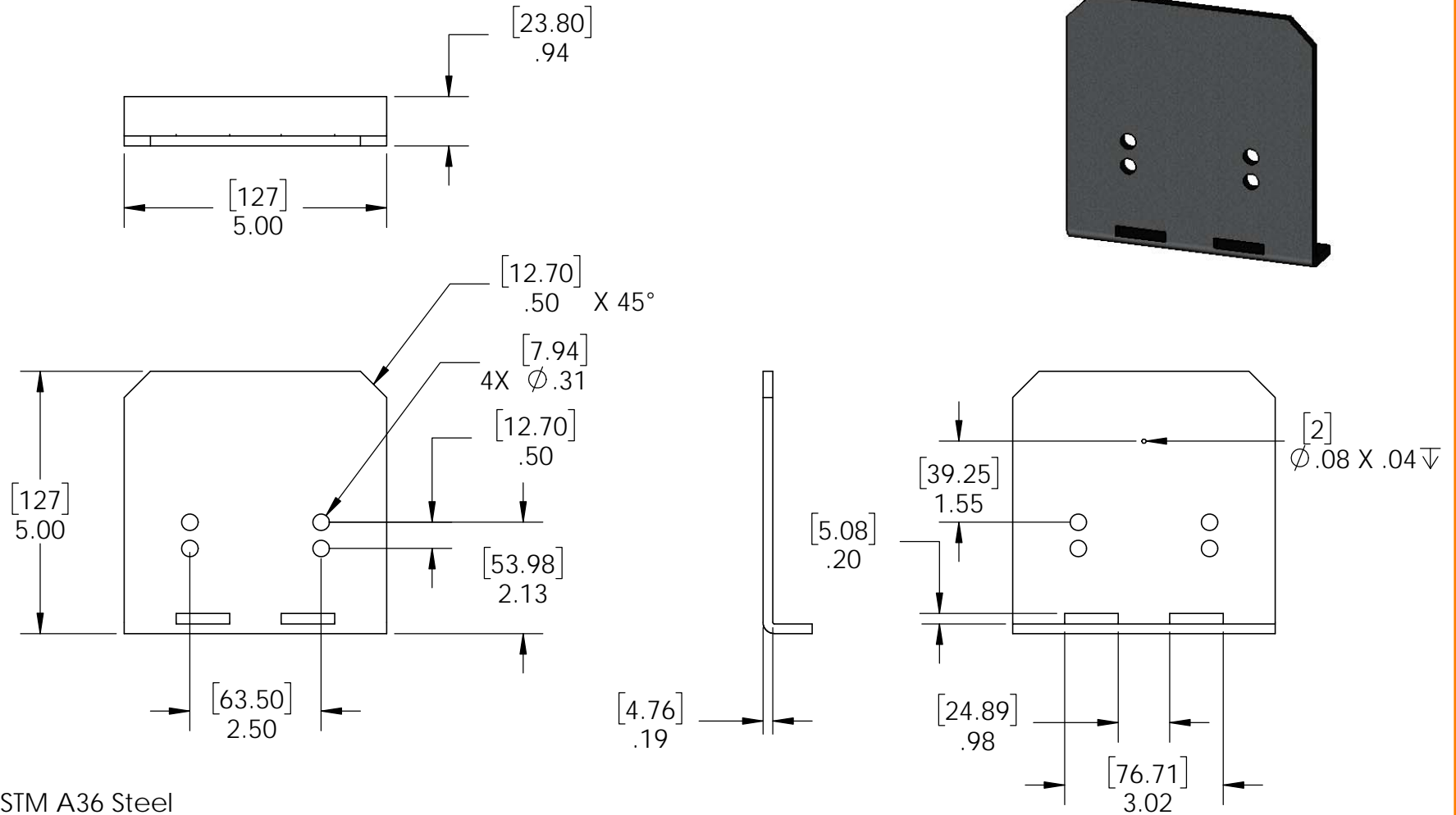

Material: ASTM A36 Steel  
 Finish: Black Powder Coat  
 Weight: 1.46 LBS  
 Scale: 1:3  
 Last updated: 10/10/2016

51735

# Product & Packaging Specs

51735 Box

Item #: Box

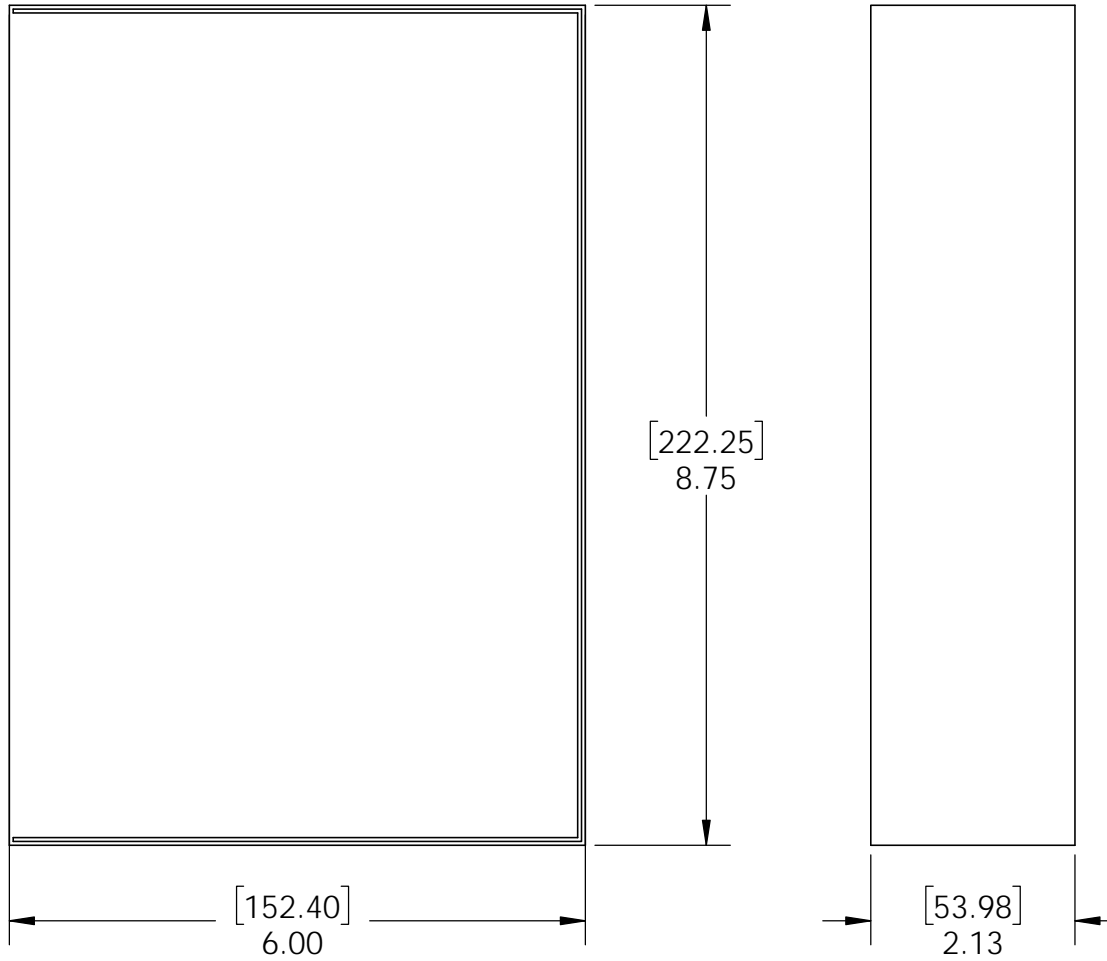

flap

Material: Corrugated Paper  
 Finish: See Artwork  
 Weight: 0.04 LBS  
 Scale: 1:2  
 Last updated: 10/10/2016

51735

# Product & Packaging Specs

## 51735 Packing

Item #: Box packing

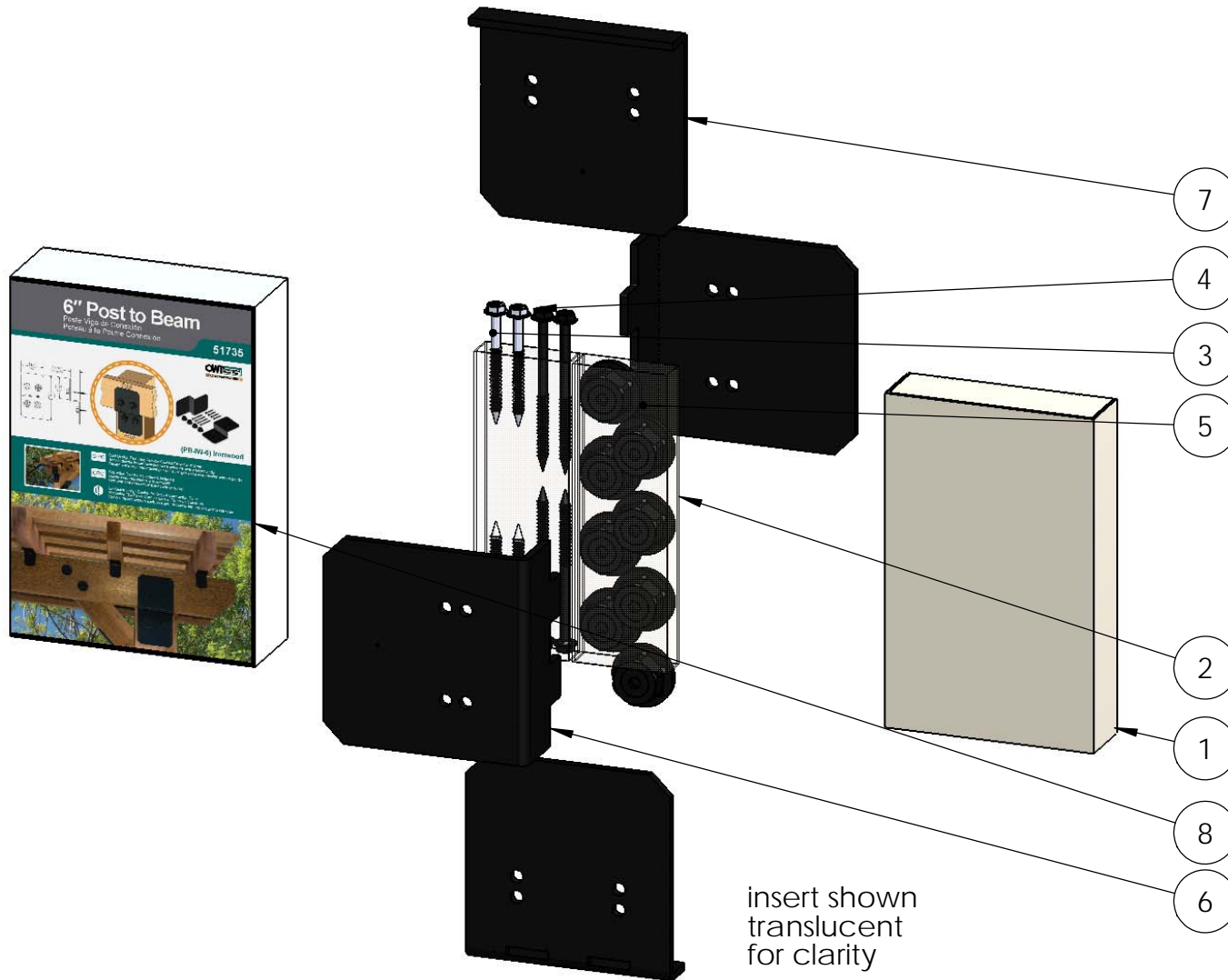

ITEM NO.	QTY.	PART NUMBER	DESCRIPTION
1	1	56637 Inner Box	56637 Inner Box
2	1	56637 Inner Box Sleeve	56637 Inner Box Sleeve
3	4	56626-10	OWT Timber Screw 2-3/4 (70mm)
4	4	56627-10	OWT Timber Screw 3-3/4 (95mm)
5	0.8	56621	1 1/2" Hex Cap Nut (HCN)
6	2	51710-11	Ledge, Post to Beam
7	2	51735-11	Plate, Top 6" Post to Beam
8	1	Box, 51735	51735 Box

Weight: 6.82 LBS  
 Scale: 1:4  
 Last updated: 10/10/2016



# Product & Packaging Specs

## 51735 Packing

Item #: Case packing

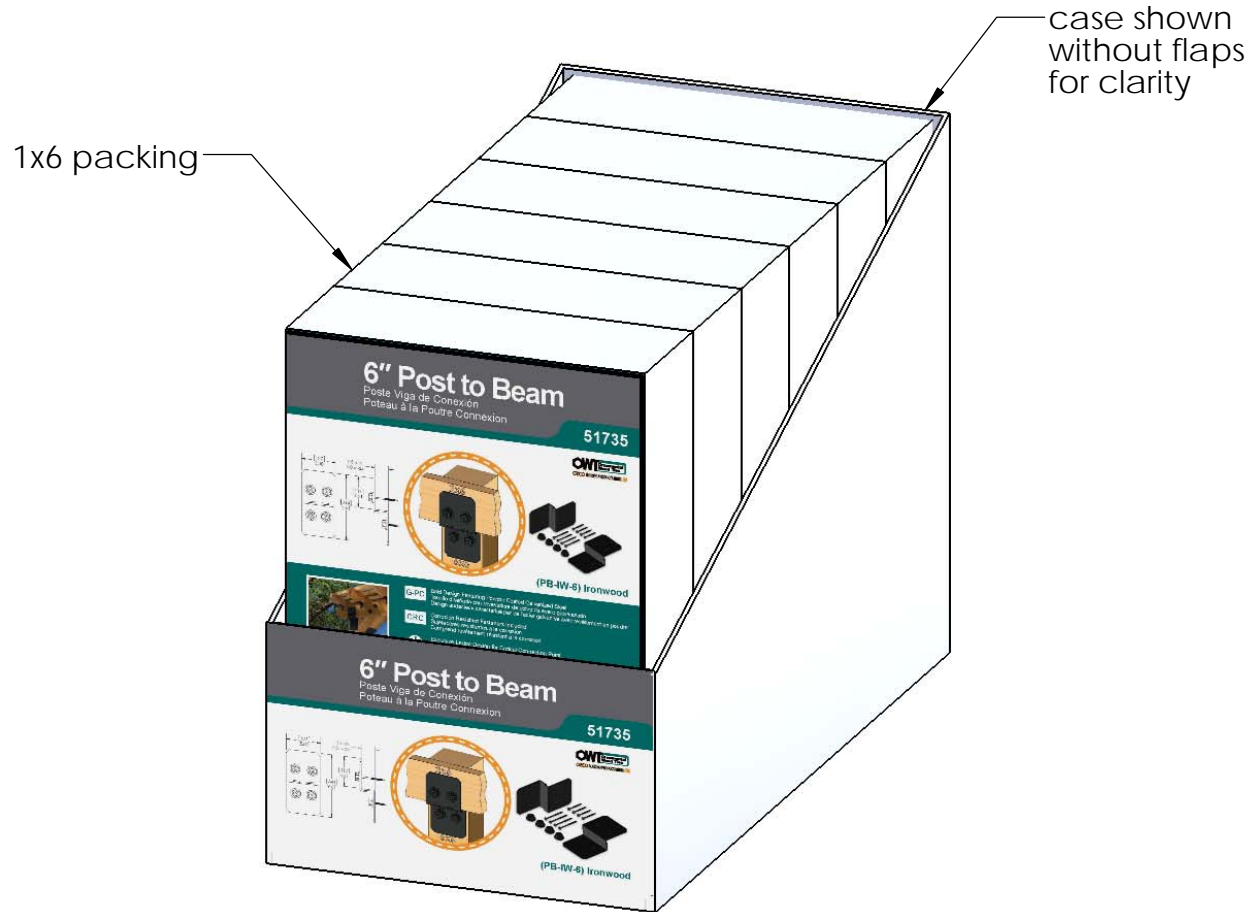

Weight: 0.42 LBS  
Scale: 1:3  
Last updated: 10/10/2016

51735

ADD PALLET LABEL

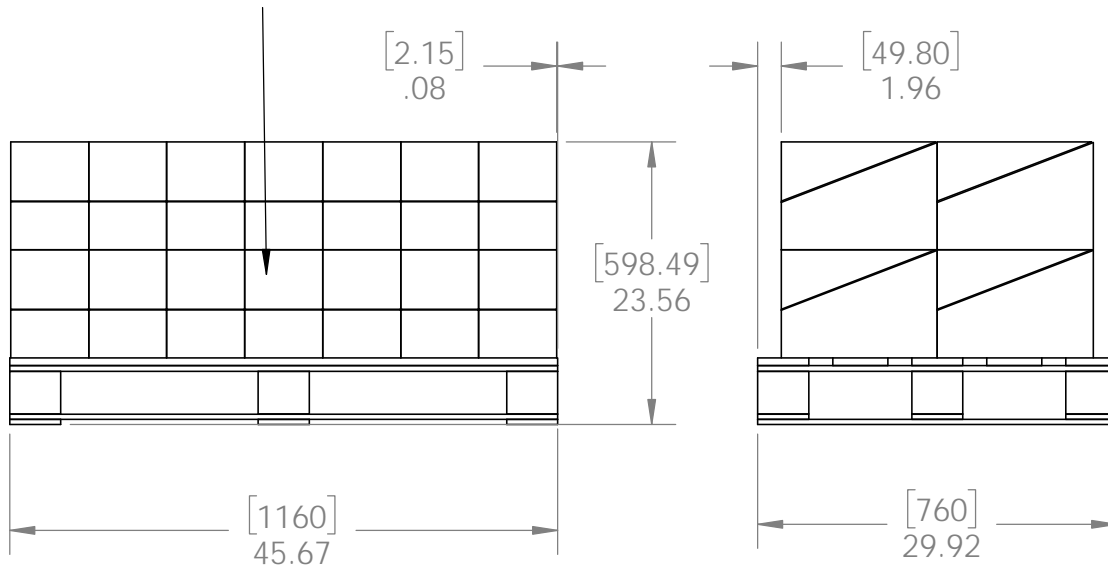

Total number of cases: 28  
 Total number of pieces:  
 28x6=168 pieces on pallet

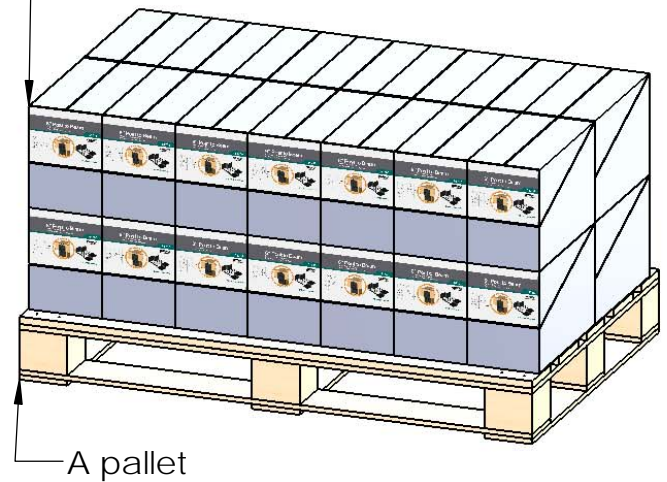

additional pallet packing instructions

- plywood on top layer
- strap to pallet
- clear wrap around boxes

Weight: 1187 LBS  
 Scale: 1:16  
 Last updated: 10/10/2016

51735