

# Product & Packaging Specs

## 8" Post to Beam (P2B-IW-8)

Item #: 51710

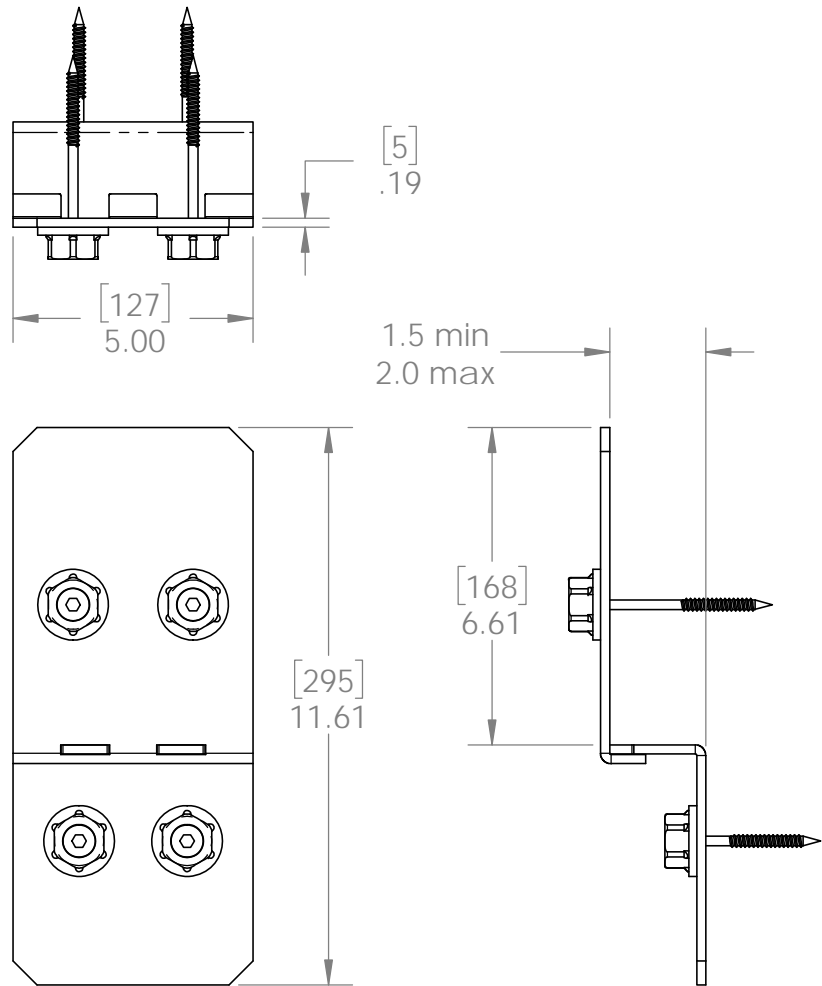

ITEM NO.	QTY.	PART NUMBER	DESCRIPTION
1	1	51710-11	Ledge, Post to Beam
2	1	51710-12	Plate, Top 8" Post to Beam
3	0.08	56627	OWT Timber Screw 3-3/4"
4	0.08	56626	OWT Timber Screw 2-3/4"
5	0.4	56621	1 1/2" Hex Cap Nut (HCN)

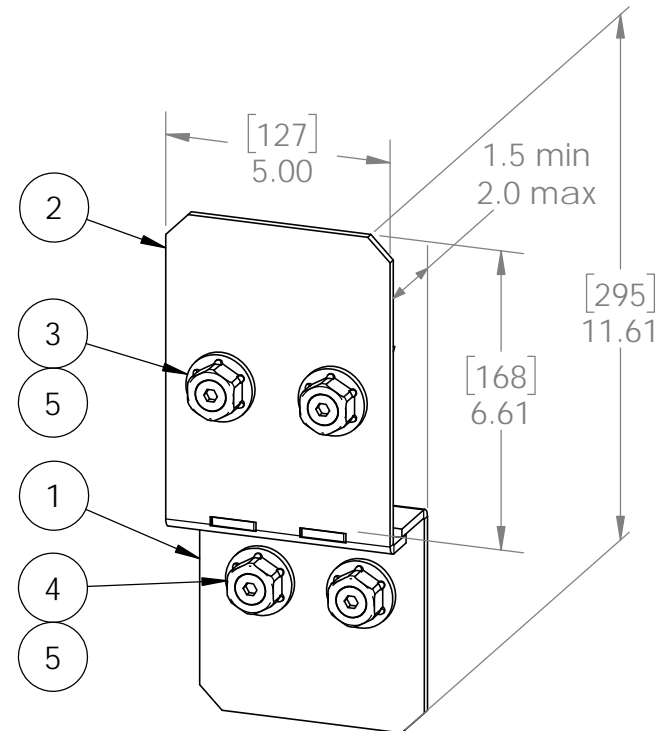

kit contains 2 assemblies

Weight: 3.96 LBS  
 Scale: 1:4  
 Last updated: 10/10/2016

51710

# Product & Packaging Specs

## 8" Post to Beam (P2B-IW-8)

Item #: 56610

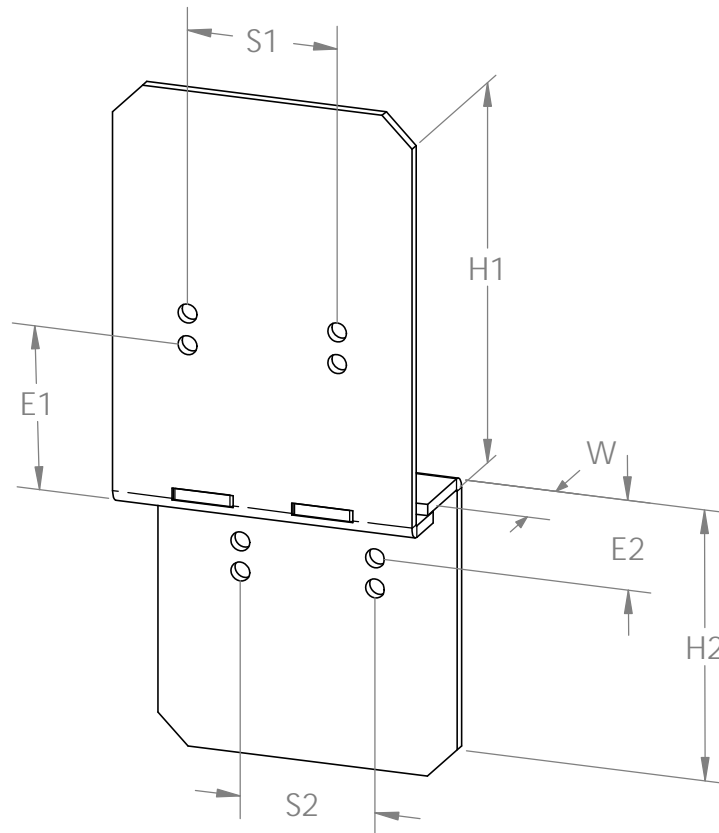

Weight: 3.70 LBS  
Scale: 1:3  
Last updated: 10/10/2016

51710

# Product & Packaging Specs

## 8" Post to Beam (P2B-IW-8)

Item #: Typical Installation & Basic Assembly

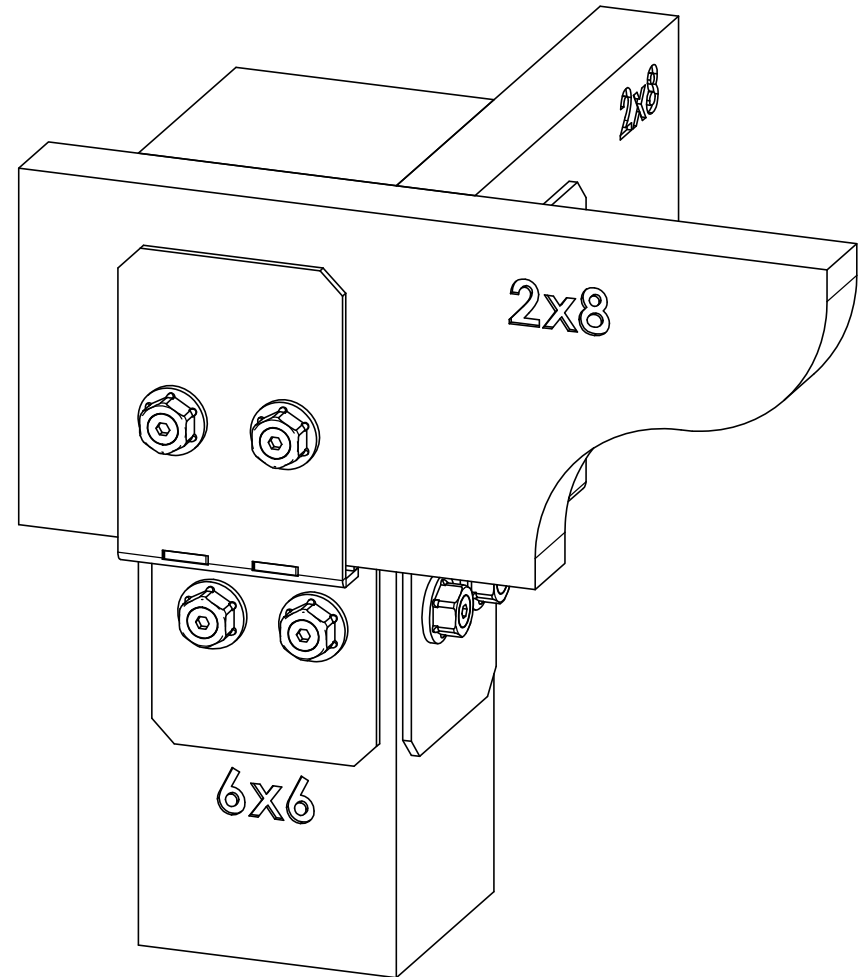
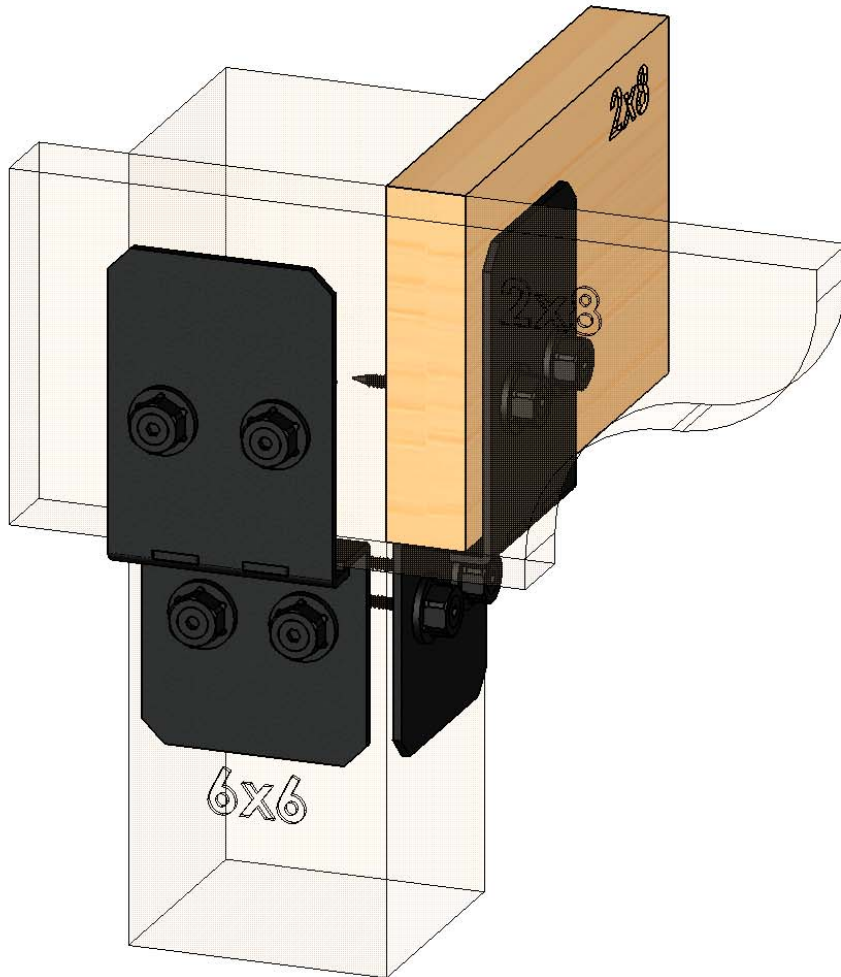

Scale: 1:4  
Last updated: 10/10/2016

51710

# Product & Packaging Specs

## 8" Post to Beam (P2B-IW-8)

Item #: Typical Installation & Basic Assembly

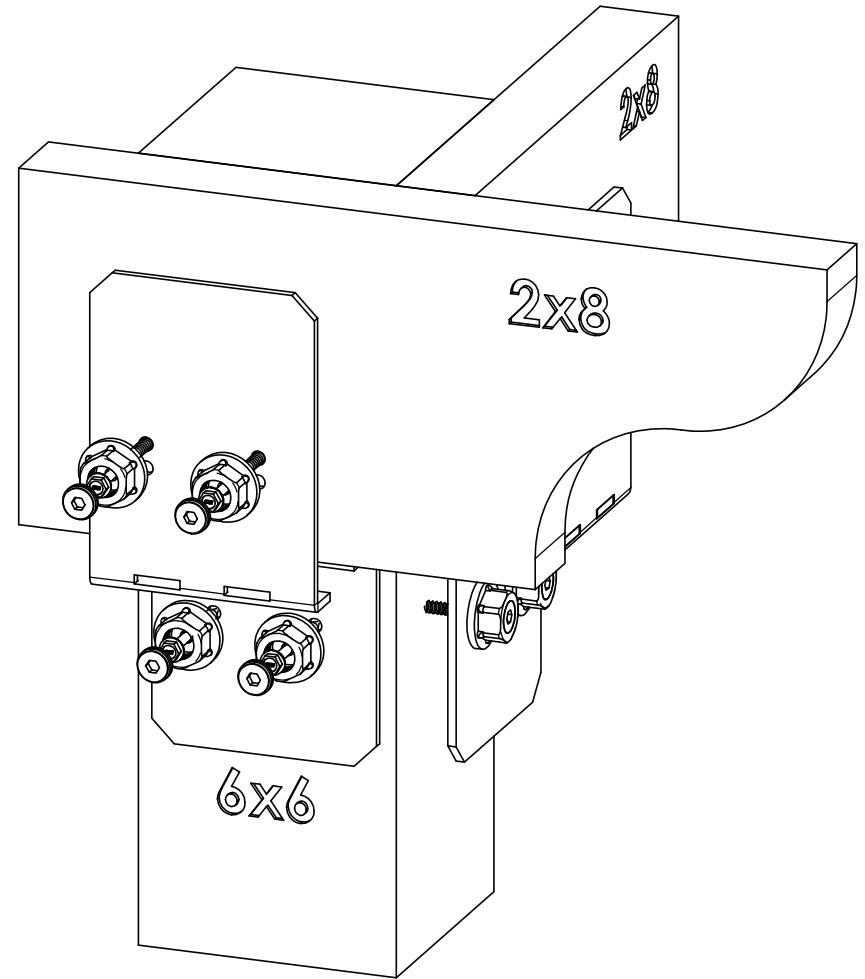
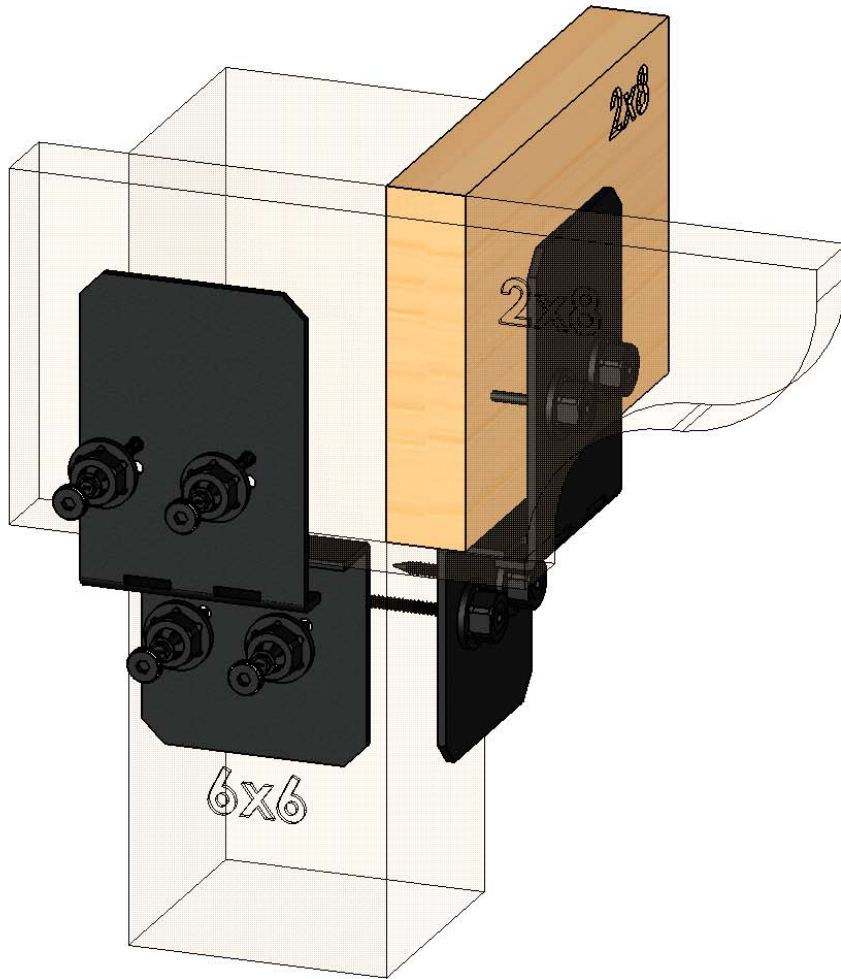

Scale: 1:4  
Last updated: 10/10/2016

51710

# Product & Packaging Specs

## 8" Post to Beam (P2B-IW-8)

Item #: Typical Installation & Basic Assembly

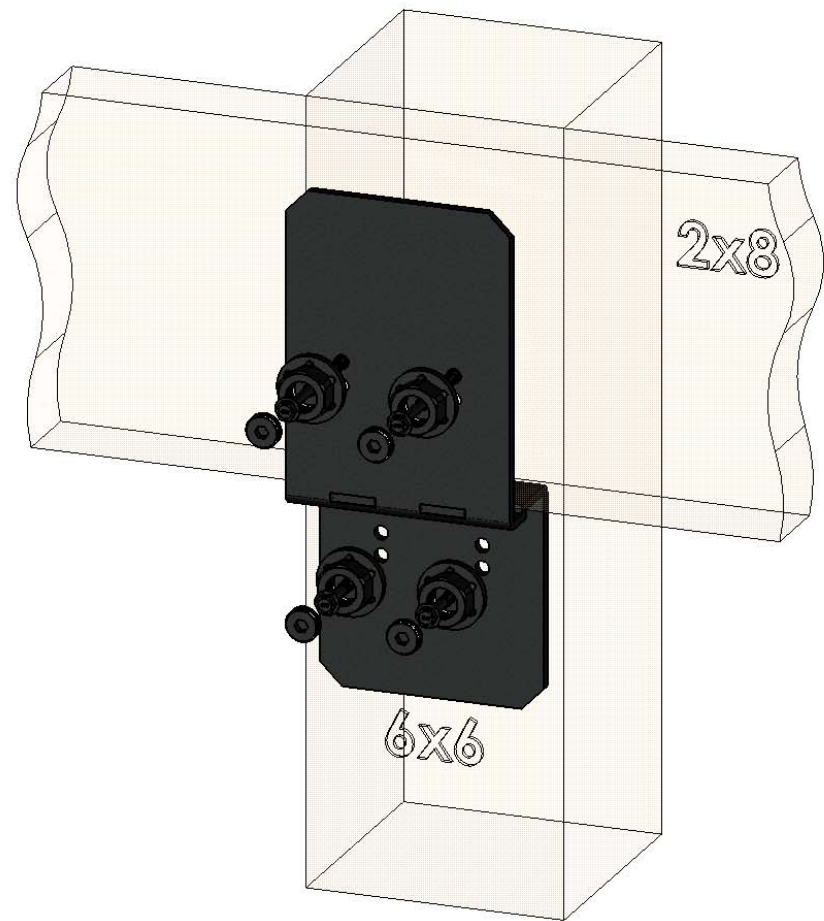
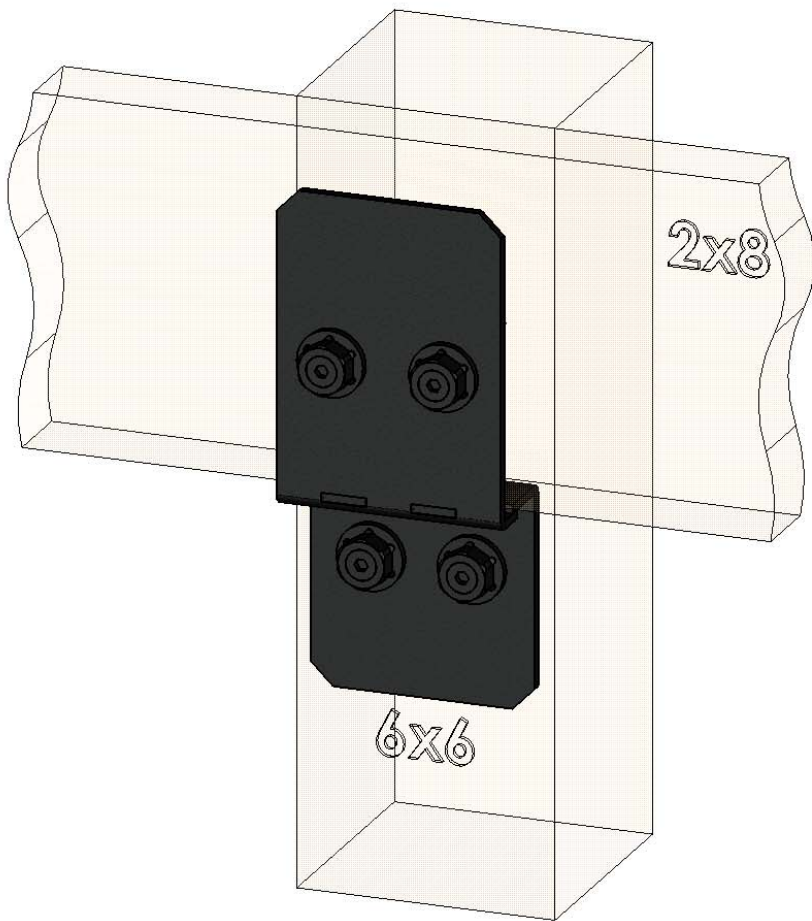

Scale: 1:4  
Last updated: 10/10/2016

51710

# Product & Packaging Specs

## 8" Post to Beam (P2B-IW-8)

Item #: Typical Installation & Basic Assembly

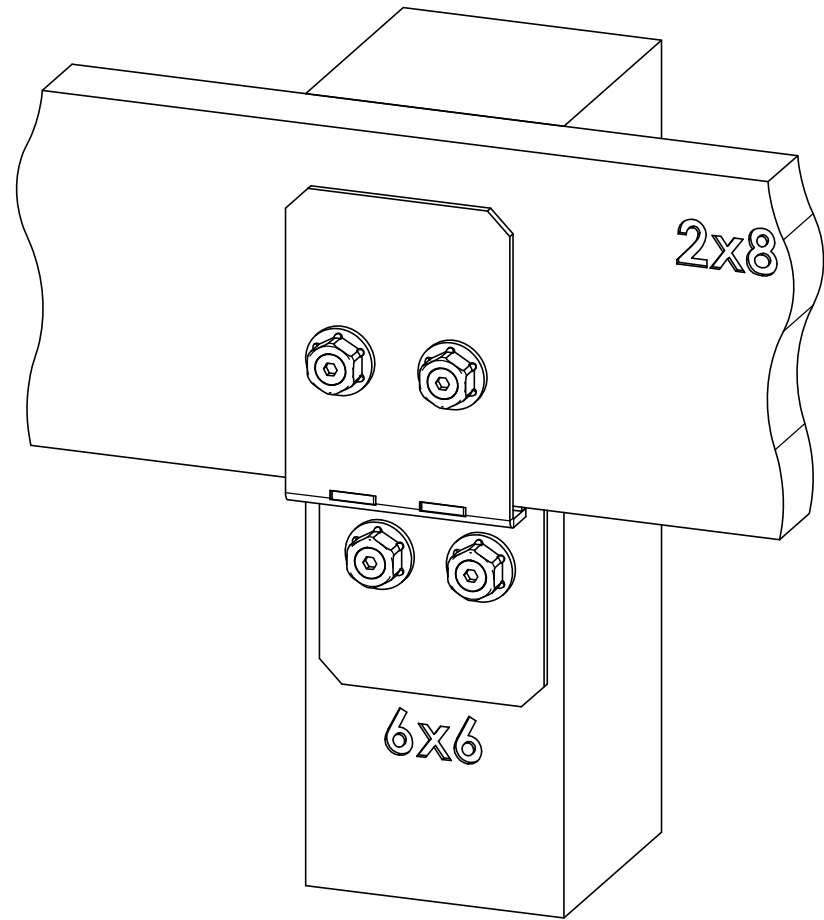
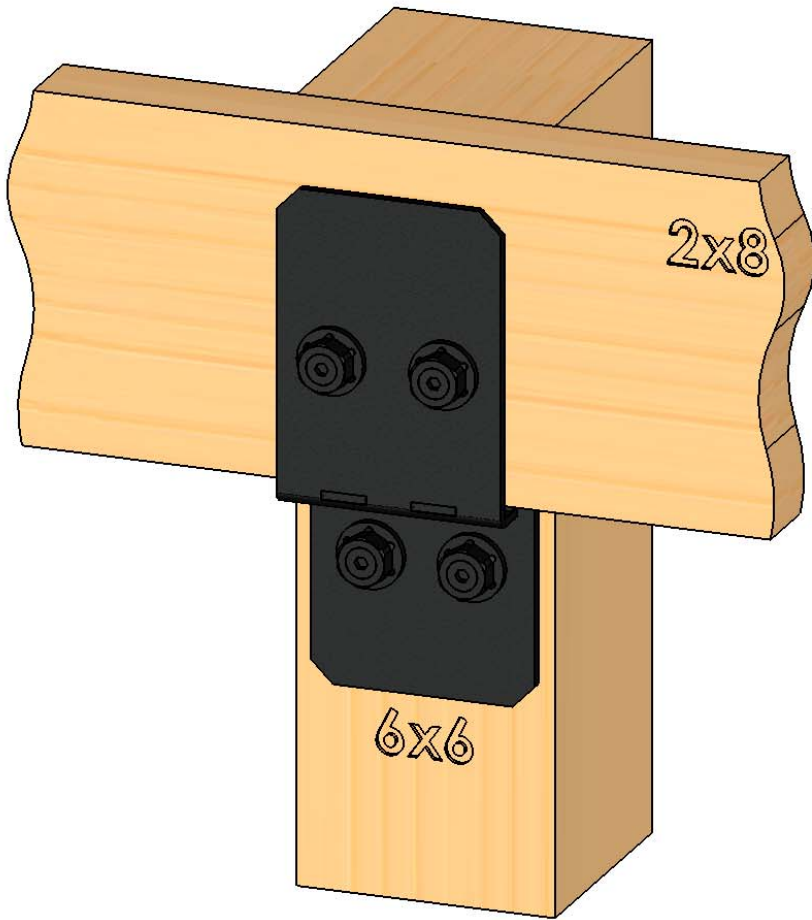

Scale: 1:4  
Last updated: 10/10/2016

51710

# Product & Packaging Specs

## 8" Post to Beam (P2B-IW-8)

Item #: 51710

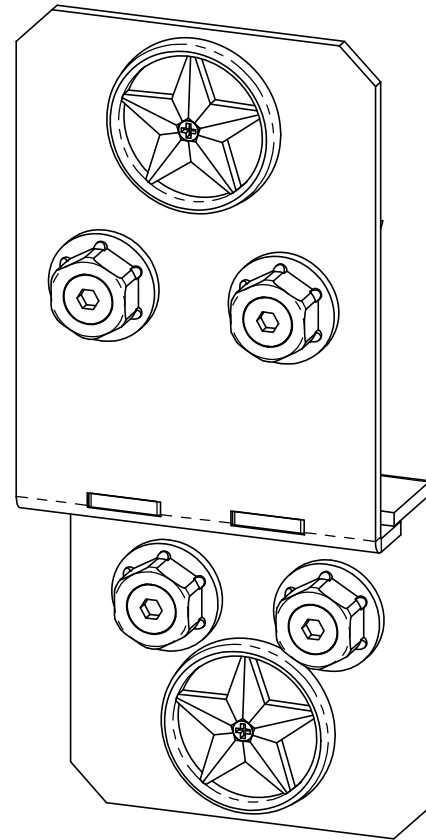
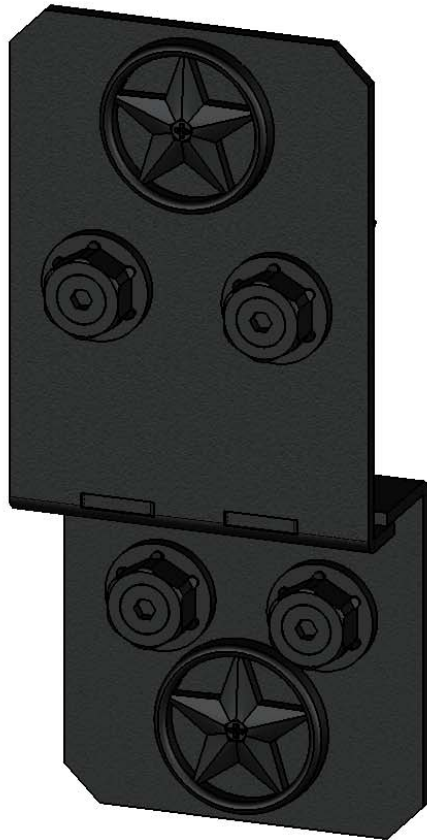

Scale: 1:2.5  
Last updated: 10/10/2016

51710

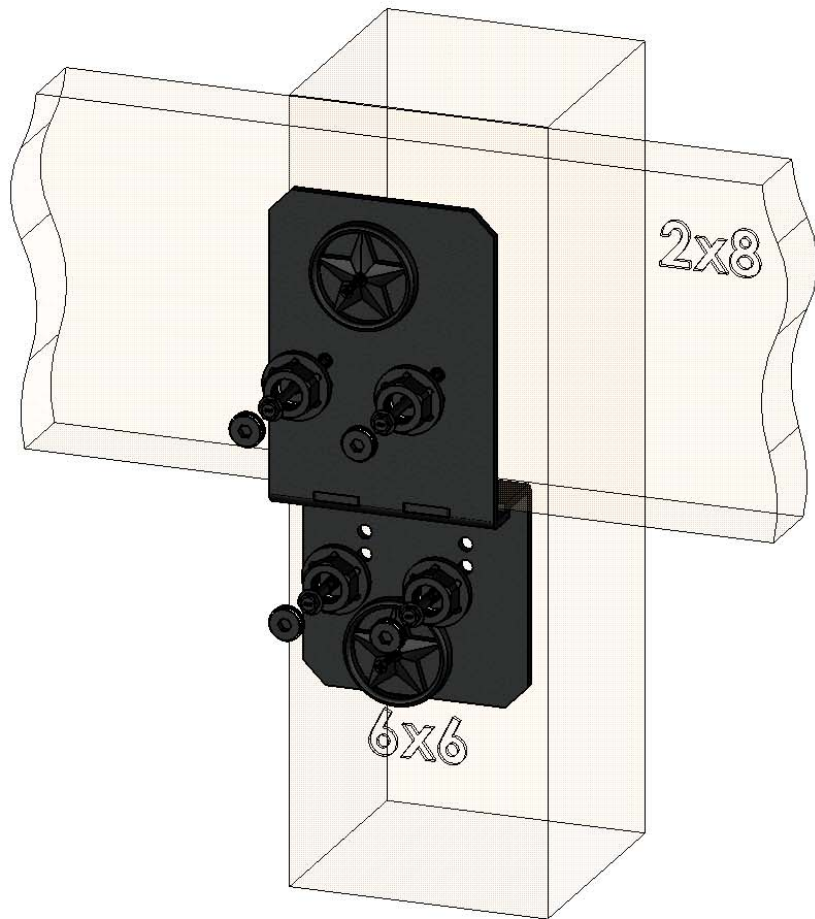
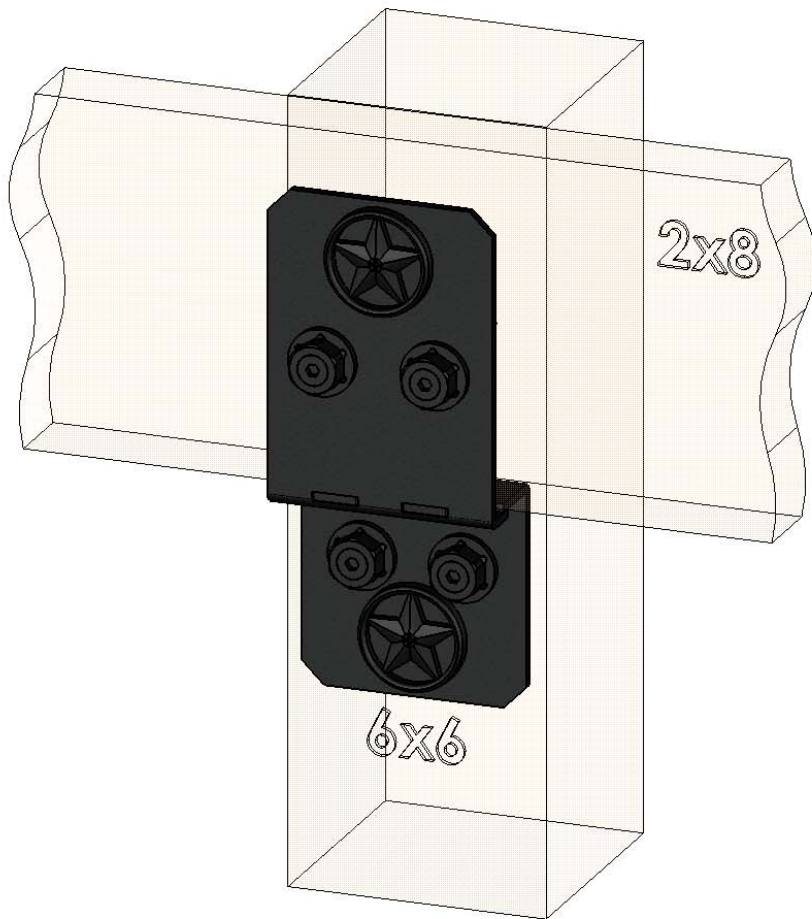

Scale: 1:4  
Last updated: 10/10/2016

51710



# Product & Packaging Specs

## 8" Post to Beam (P2B-IW-8)

Item #: 51710

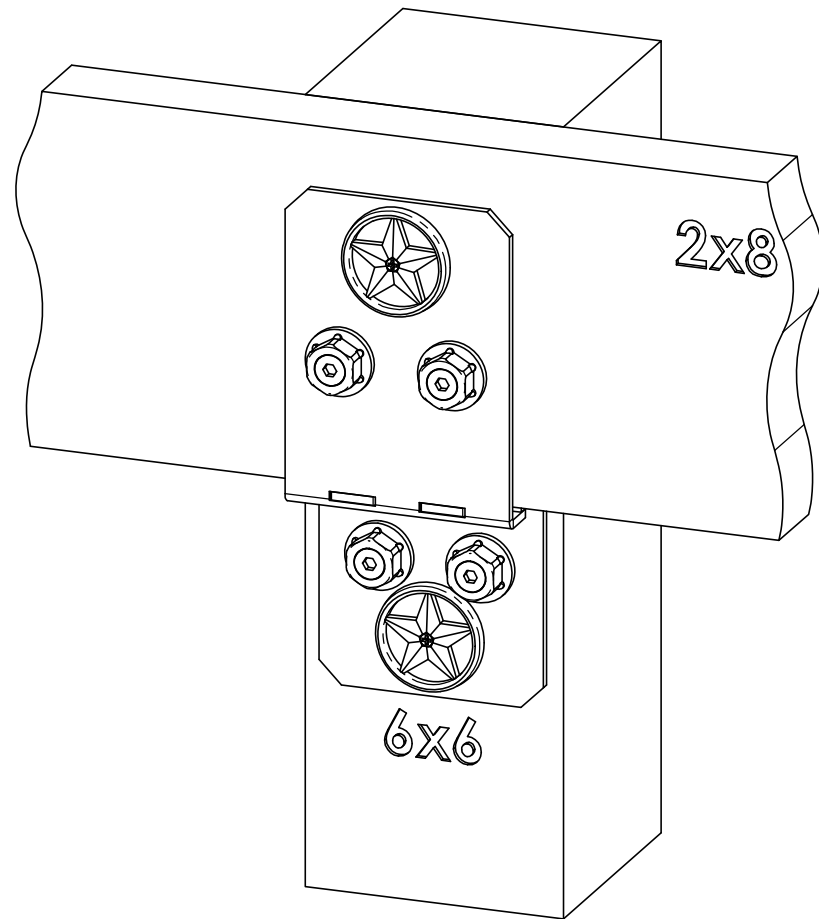
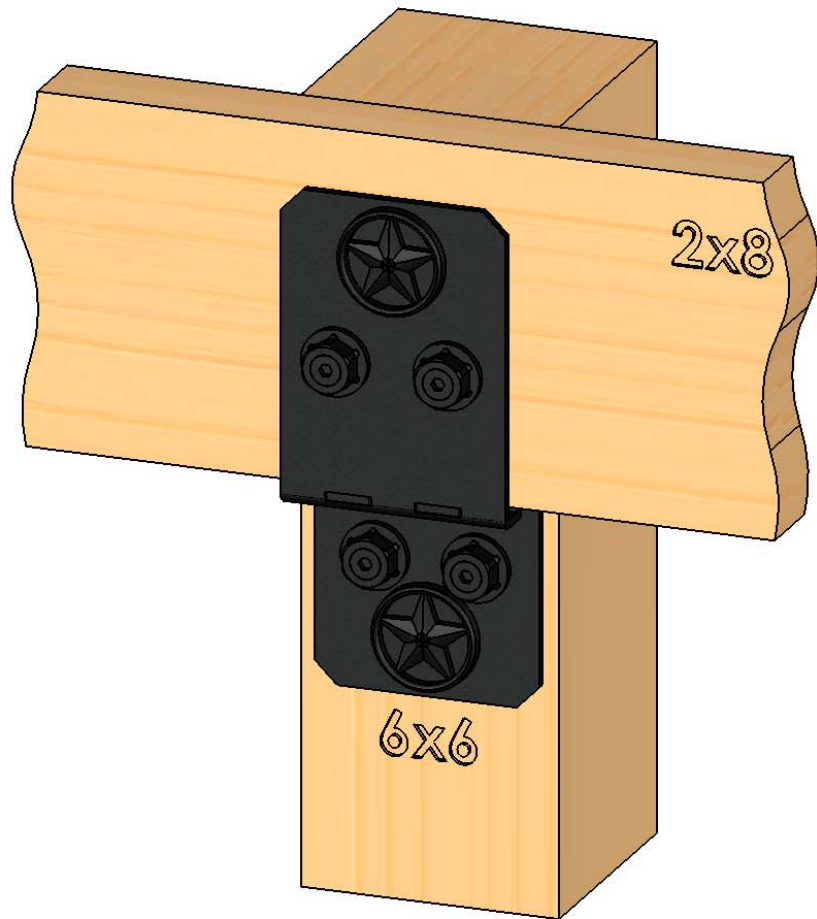

Scale: 1:4  
Last updated: 10/10/2016

51710

# Product & Packaging Specs

## 8" Post to Beam (P2B-IW-8)

Item #: 51710

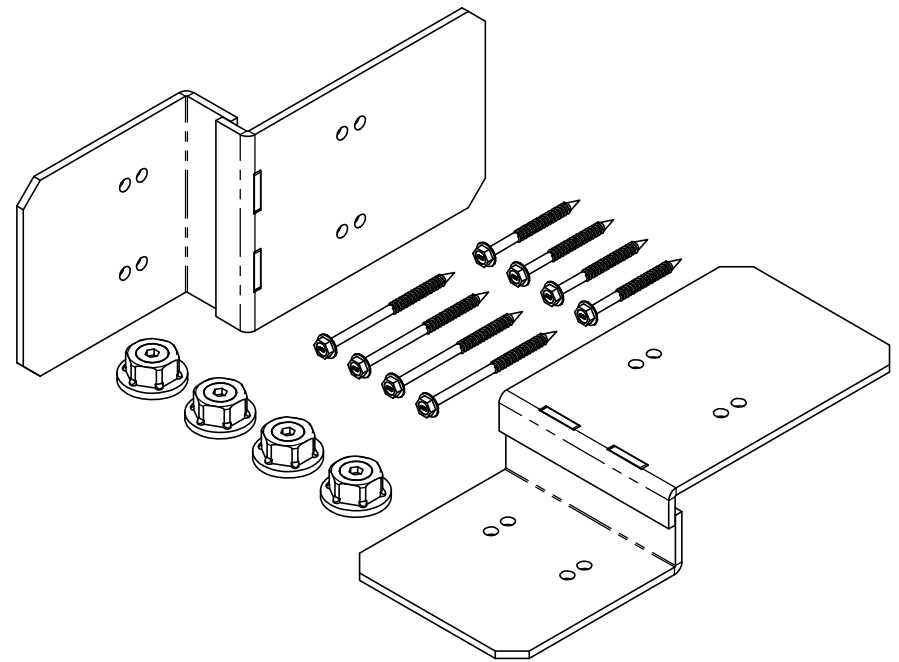
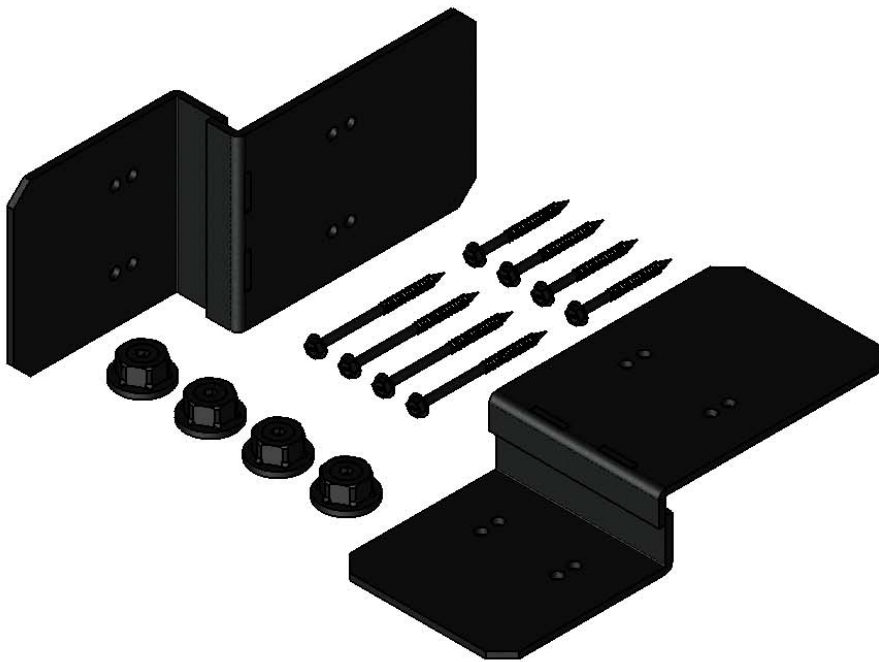

Scale: 1:4  
Last updated: 10/10/2016

51710



OZCO BUILDING PRODUCTS

# Product & Packaging Specs

Box, 51710

Item #: Box

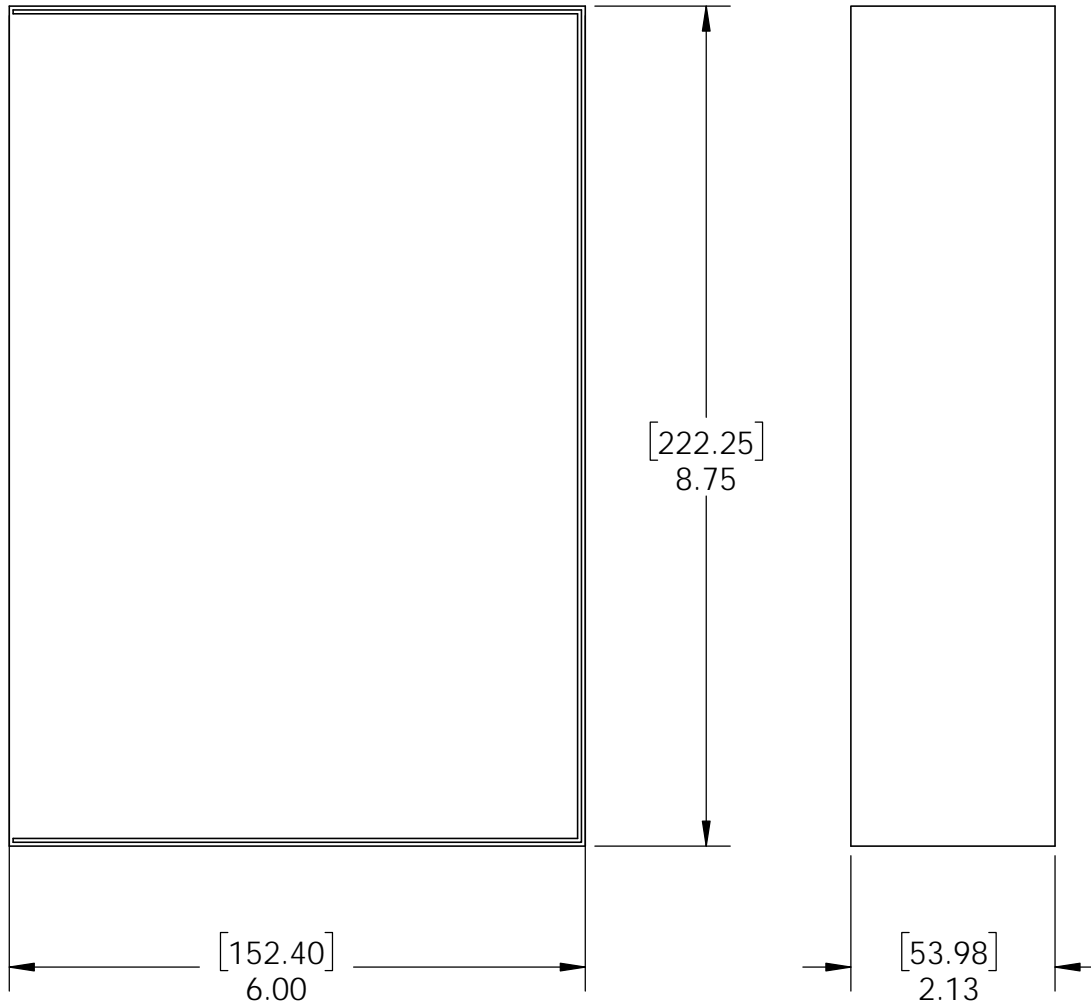

flap

Material: Corrugated Paper  
Finish: See Artwork  
Weight: 0.04 LBS  
Scale: 1:2  
Last updated: 10/10/2016

51710

# Product & Packaging Specs

## 51710 Packing

Item #: Box packing

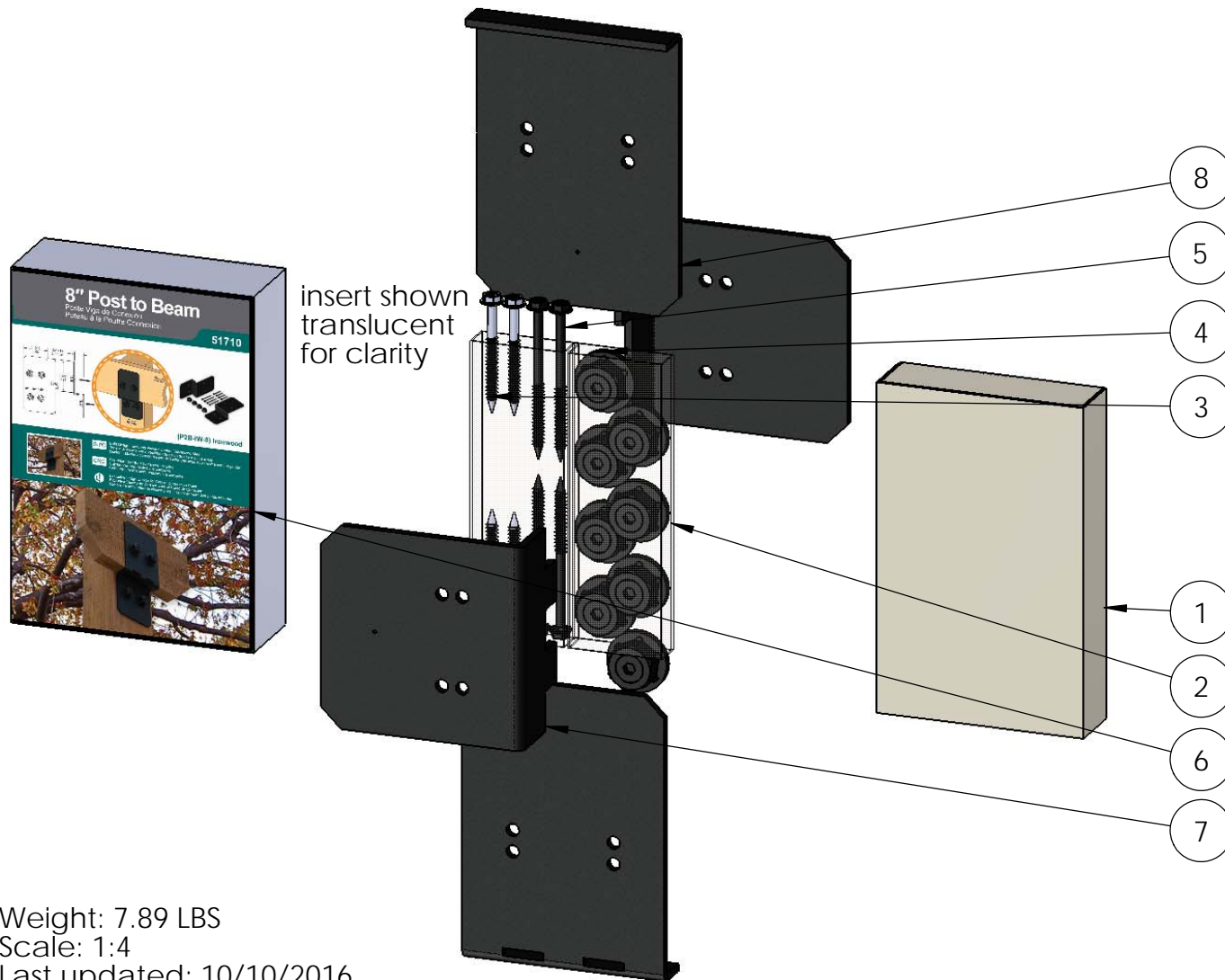

ITEM NO.	QTY.	PART NUMBER	DESCRIPTION
1	1	56637 Inner Box	56637 Inner Box
2	1	56637 Inner Box Sleeve	56637 Inner Box Sleeve
3	4	56626-10	OWT Timber Screw 2-3/4 (70mm)
4	0.8	56621	1 1/2" Hex Cap Nut (HCN)
5	4	56627-10	OWT Timber Screw 3-3/4 (95mm)
6	1	Box, 51710	Box, 51710
7	2	51710-11	Ledge, Post to Beam Plate,
8	2	51710-12	Top 8" Post to Beam

Weight: 7.89 LBS  
 Scale: 1:4  
 Last updated: 10/10/2016

51710

# Product & Packaging Specs

Case, 51710

Item #: Case

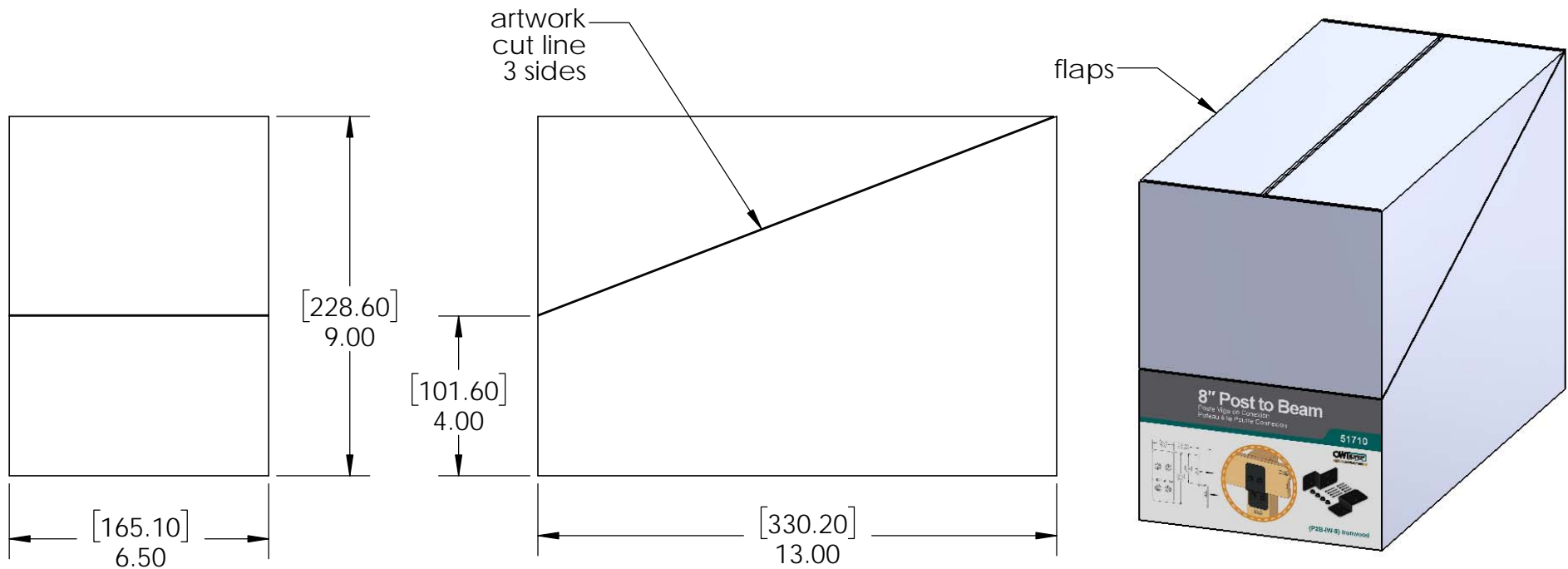

Material: Corrugated Paper  
 Finish: Natural  
 Weight: 0.23 LBS  
 Scale: 1:4  
 Last updated: 10/10/2016

51710

# Product & Packaging Specs

## 51710 Packing

Item #: Case packing

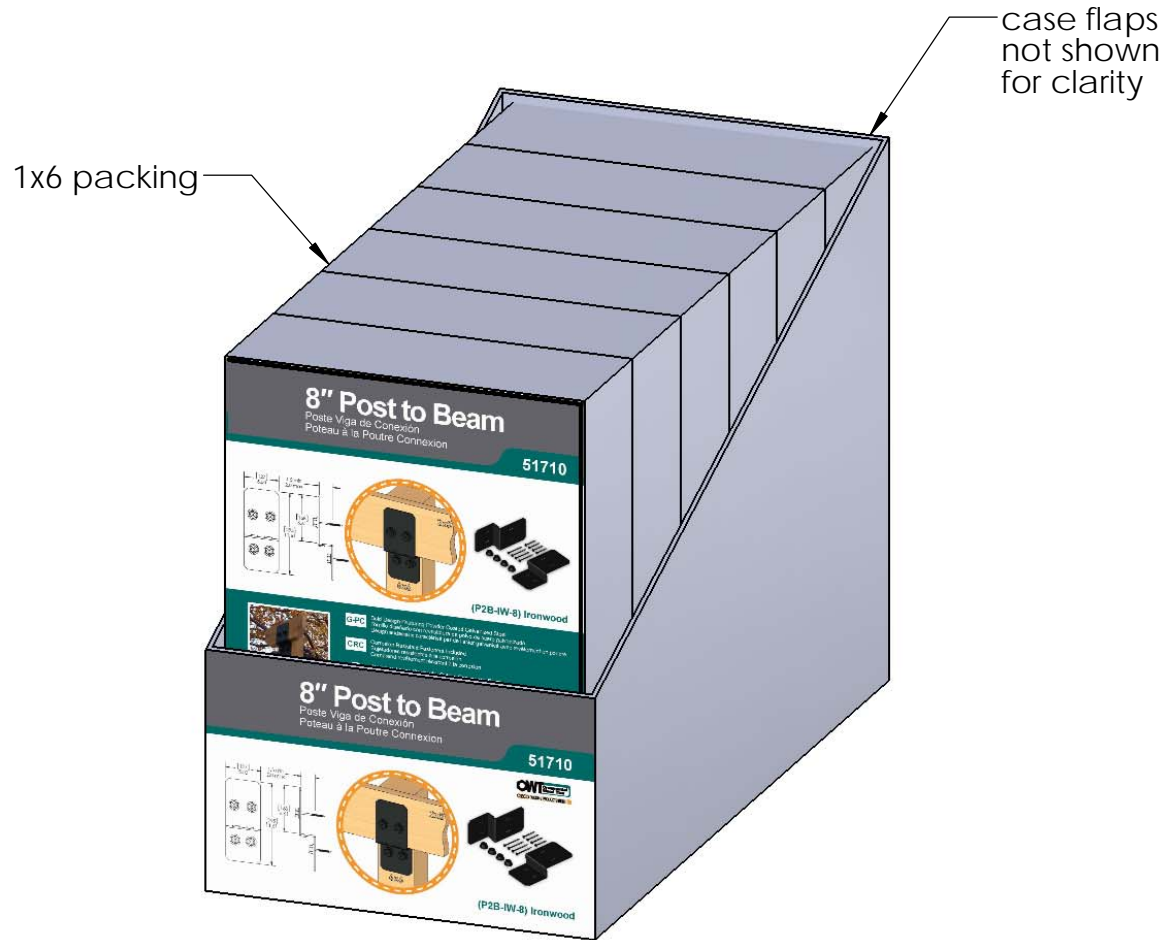

Weight: 33 LBS  
 Scale: 1:3  
 Last updated: 10/10/2016

51710

ADD PALLET LABEL

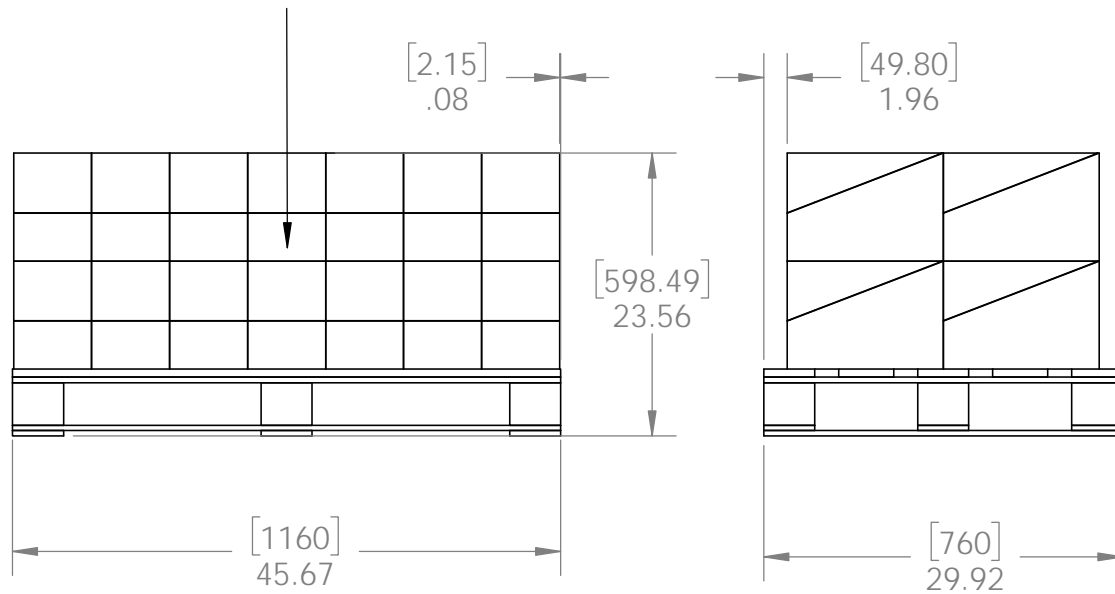

Total number of cases: 28  
 Total number of pieces:  
 28x6=168 pieces on pallet

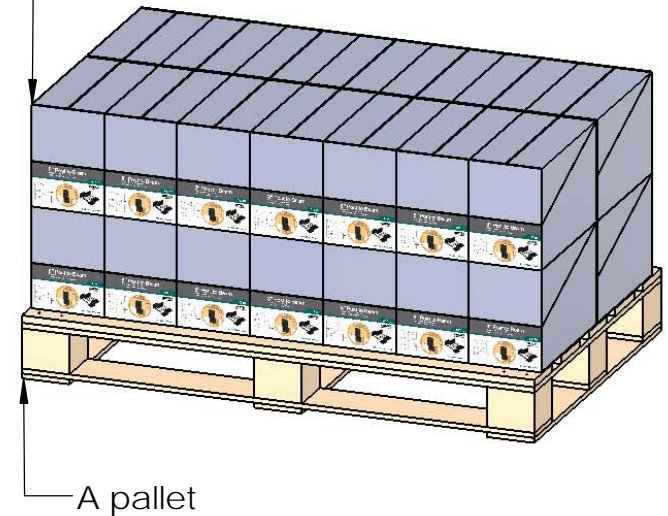

additional pallet packing instructions

- plywood on top layer
- strap to pallet
- clear wrap around boxes

Weight: 1351 LBS  
 Scale: 1:16  
 Last updated: 10/10/2016

51710