

Product & Packaging Specs

8" Post to Beam (P2B-LS-8)

Item #: 56610

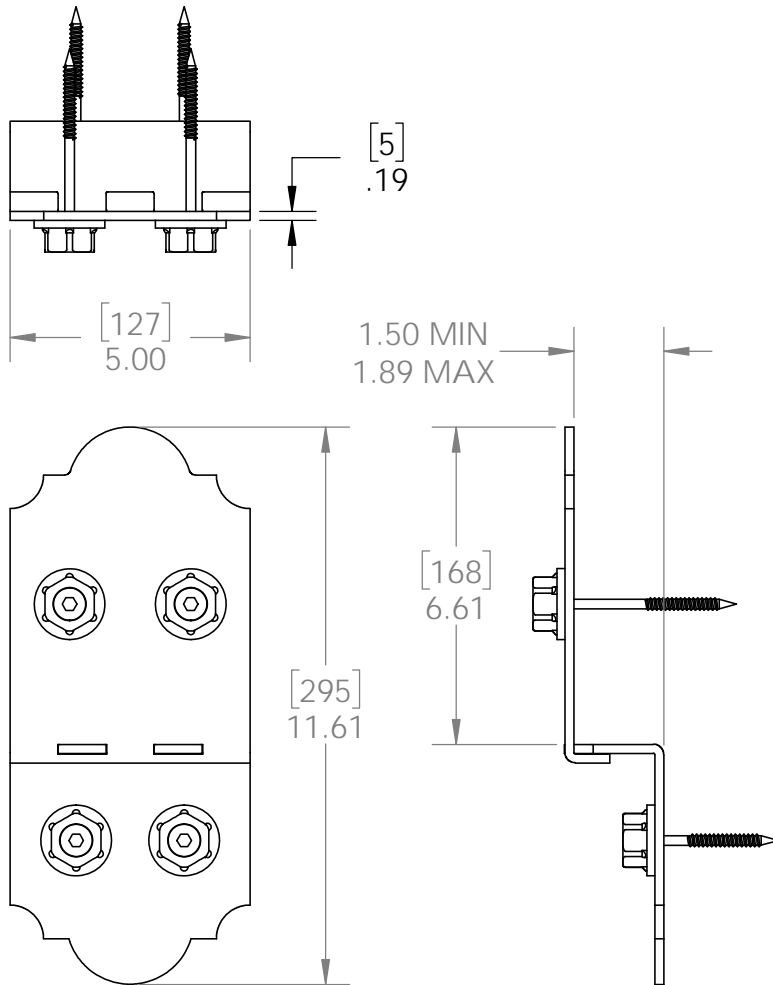

ITEM NO.	QTY.	PART NUMBER	DESCRIPTION
1	1	56610-11	Ledge, Post to Beam
2	0.08	56627	OWT Timber Screw 3-3/4"
3	1	56610-12	Plate, Top 8" Post to Beam
4	0.4	56621	1 1/2" Hex Cap Nut (HCN)
5	0.08	56626	OWT Timber Screw 2-3/4"

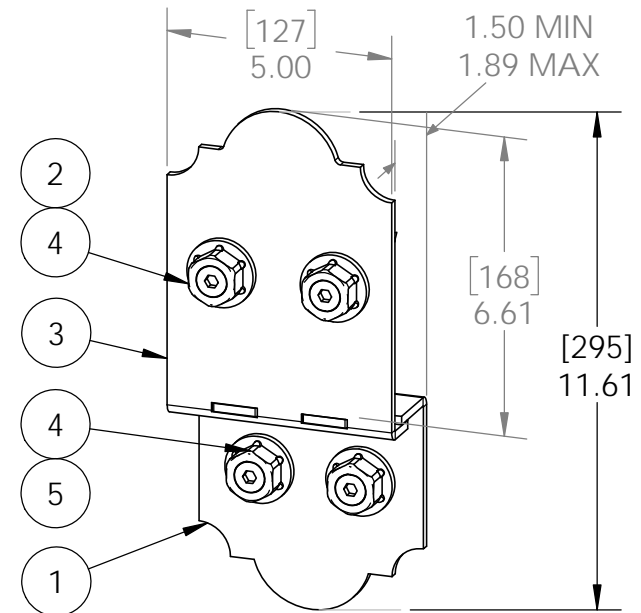

kit contains 2 assemblies

Weight: 3.56 LBS
Scale: 1:4
Last updated: 10/10/2016

56610-10

Product & Packaging Specs

8" Post to Beam (P2B-LS-8)

Item #: 56610

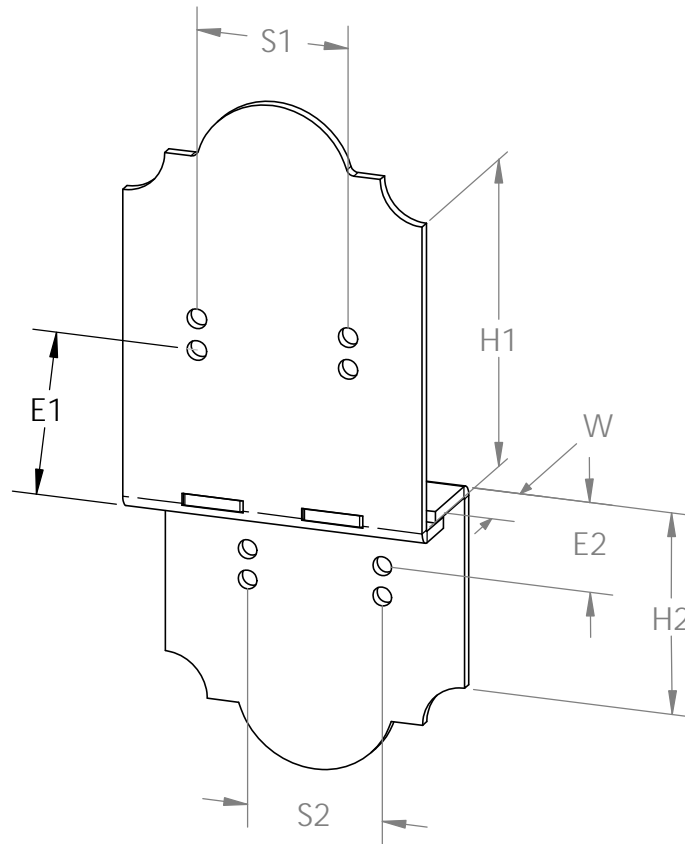

Weight: 3.31 LBS
Scale: 1:3
Last updated: 10/10/2016

56610-10

Product & Packaging Specs

8" Post to Beam (P2B-LS-8)

Item #: Typical Installation & Basic Assembly

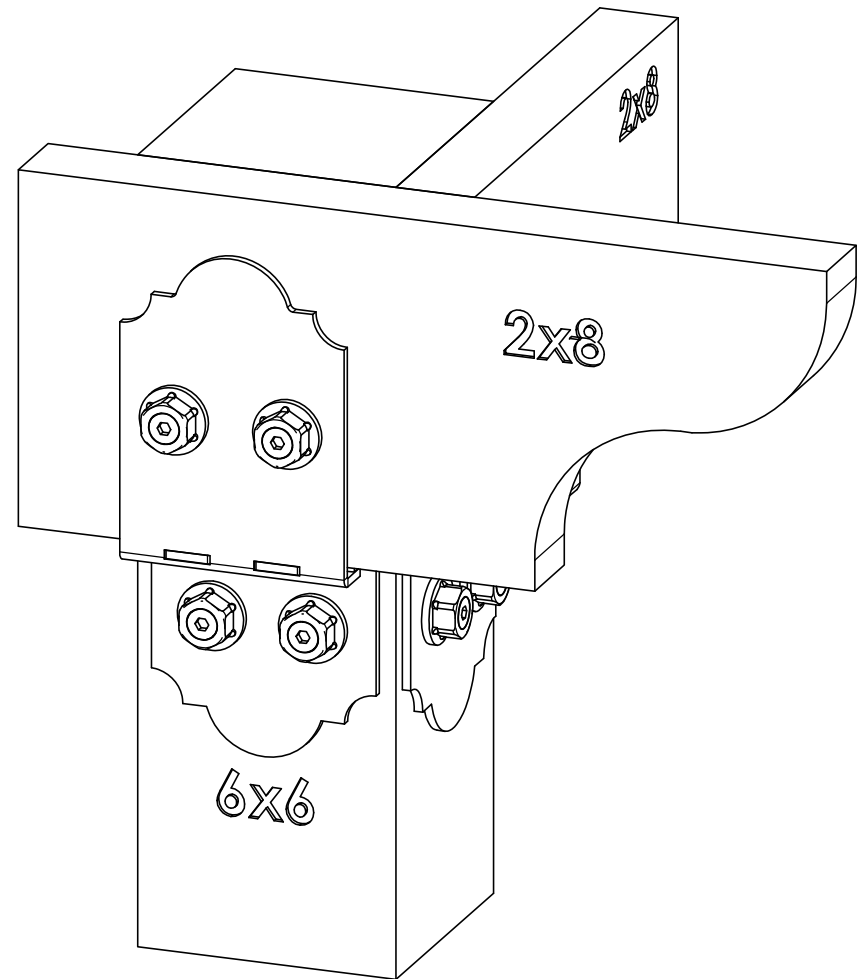
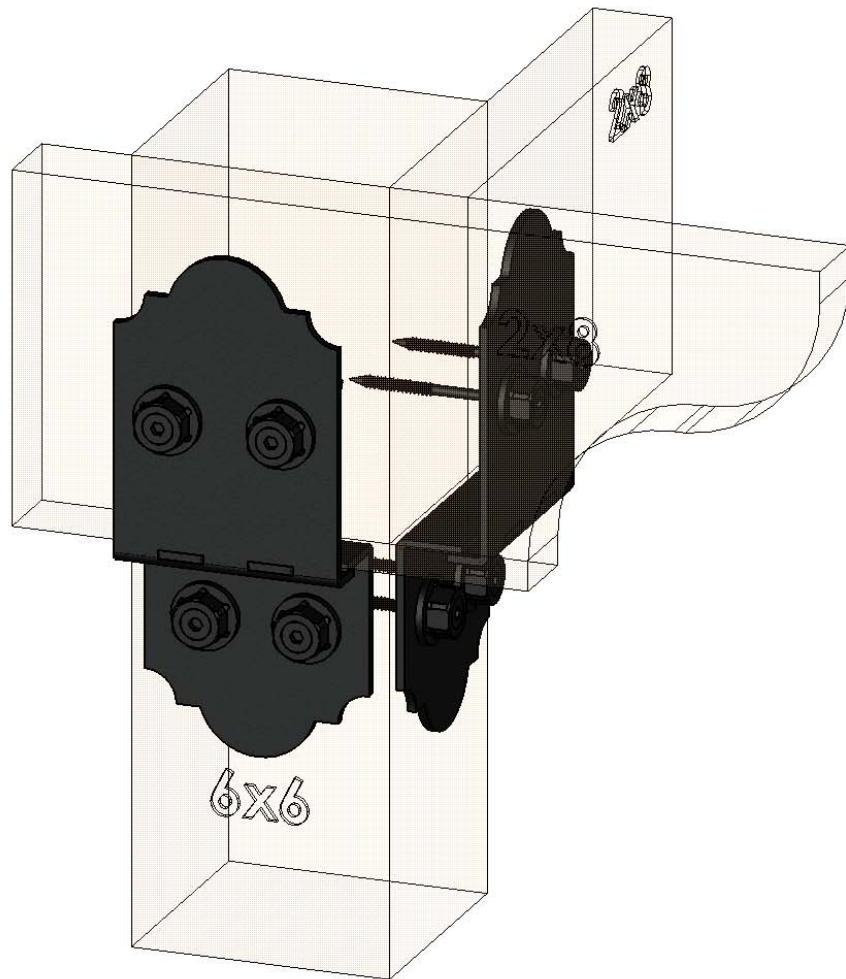

Weight: 41.34 LBS
Scale: 1:4
Last updated: 10/10/2016

56610-10

Product & Packaging Specs

8" Post to Beam (P2B-LS-8)

Item #: Typical Installation & Basic Assembly

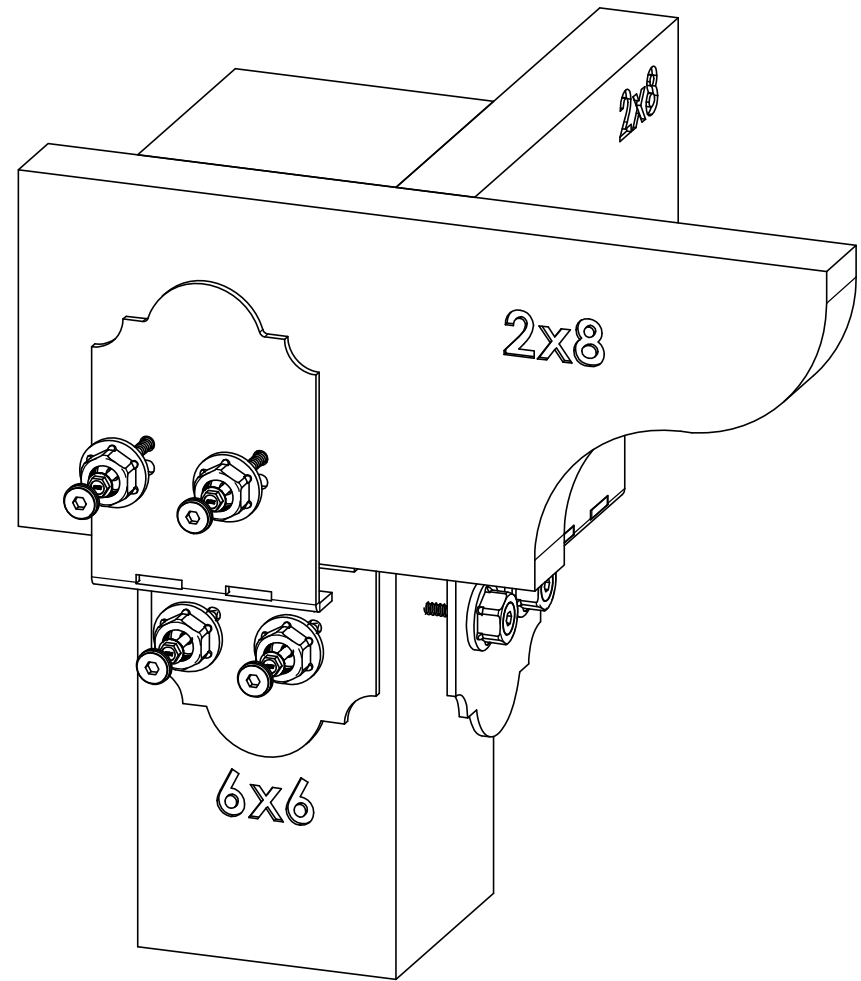
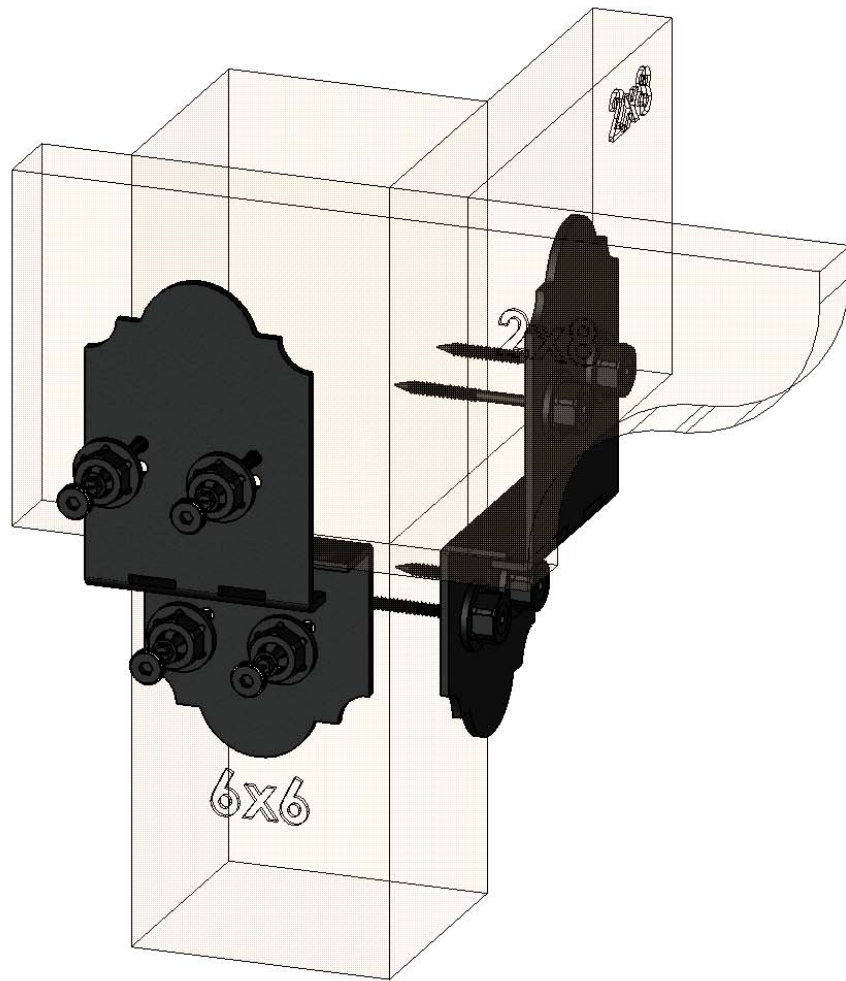

Weight: 41.34 LBS
Scale: 1:4
Last updated: 10/10/2016

56610-10

Product & Packaging Specs

8" Post to Beam (P2B-LS-8)

Item #: Typical Installation & Basic Assembly

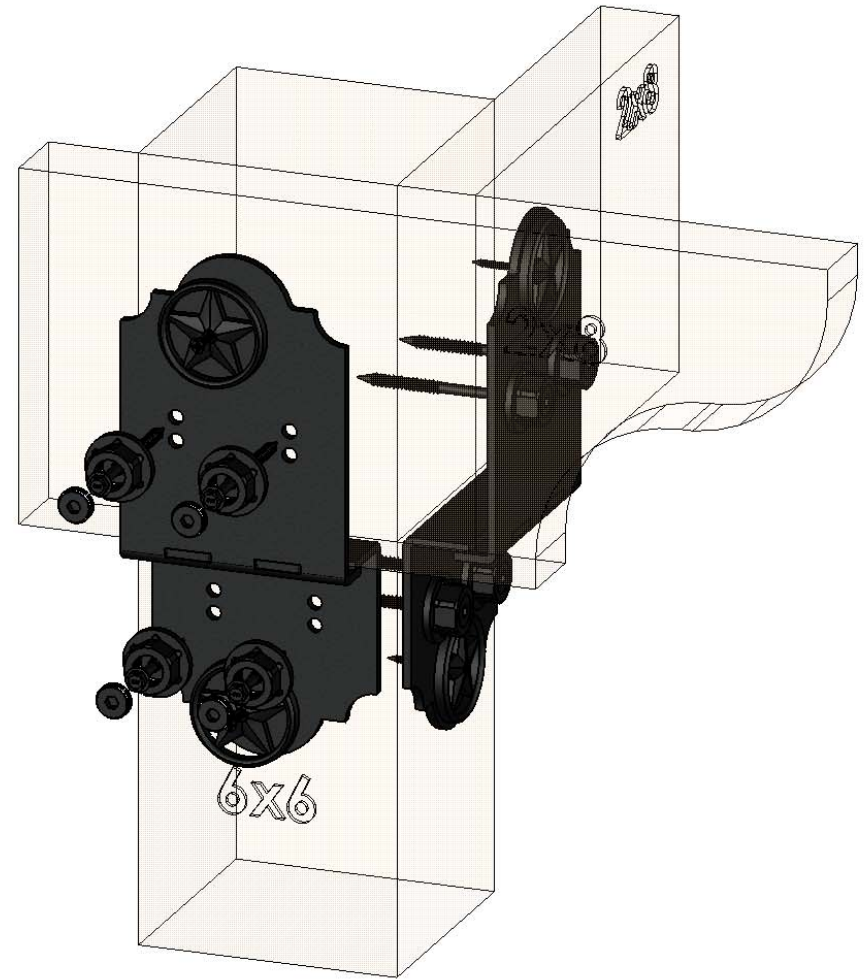
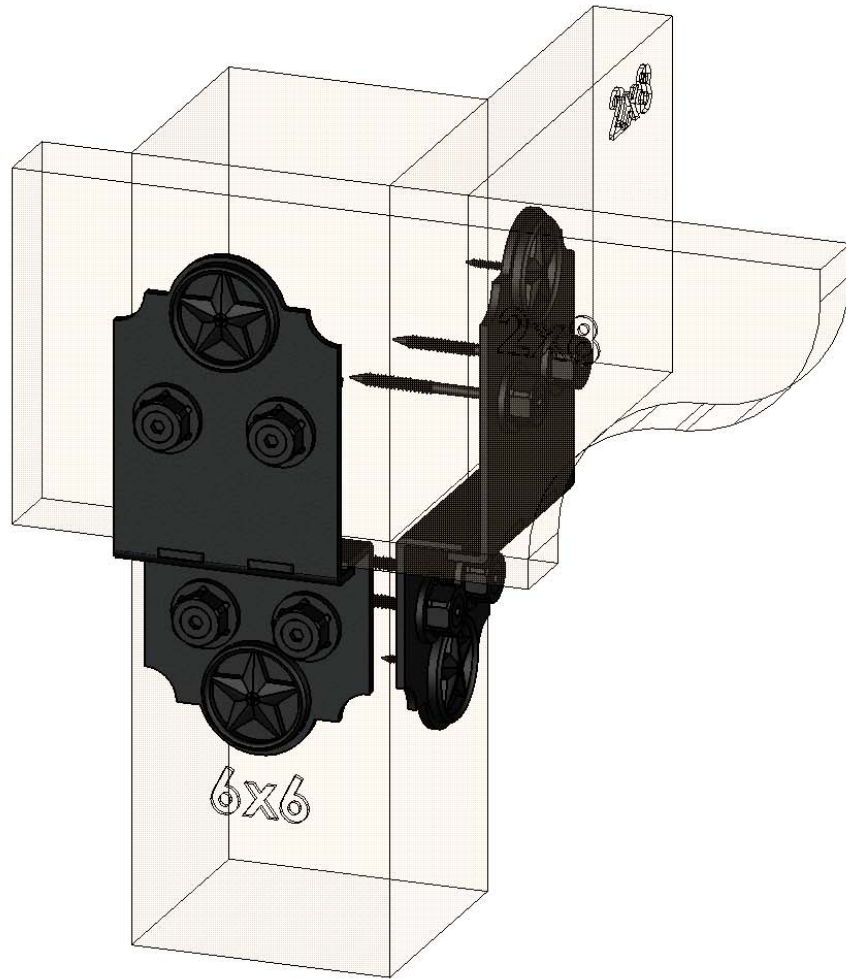

STARS SOLD SEPARATELY

Weight: 41.60 LBS
Scale: 1:4
Last updated: 10/10/2016

56610-10

Product & Packaging Specs

8" Post to Beam (P2B-LS-8)
Item #: Typical Installation & Basic Assembly

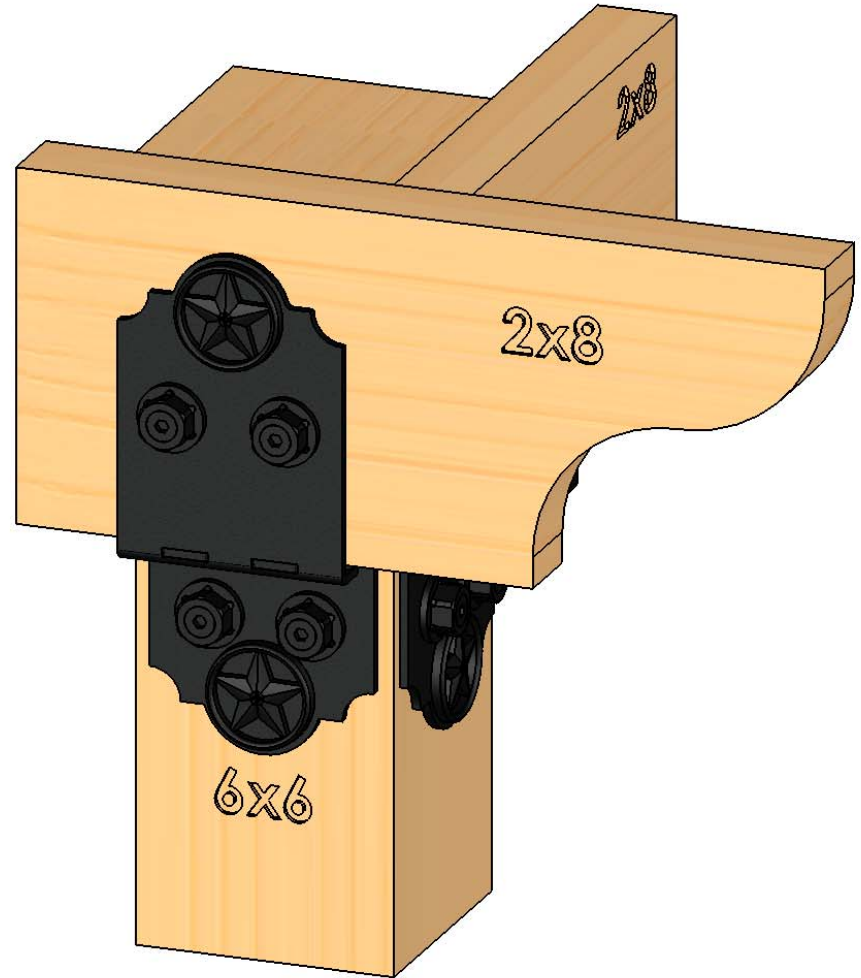
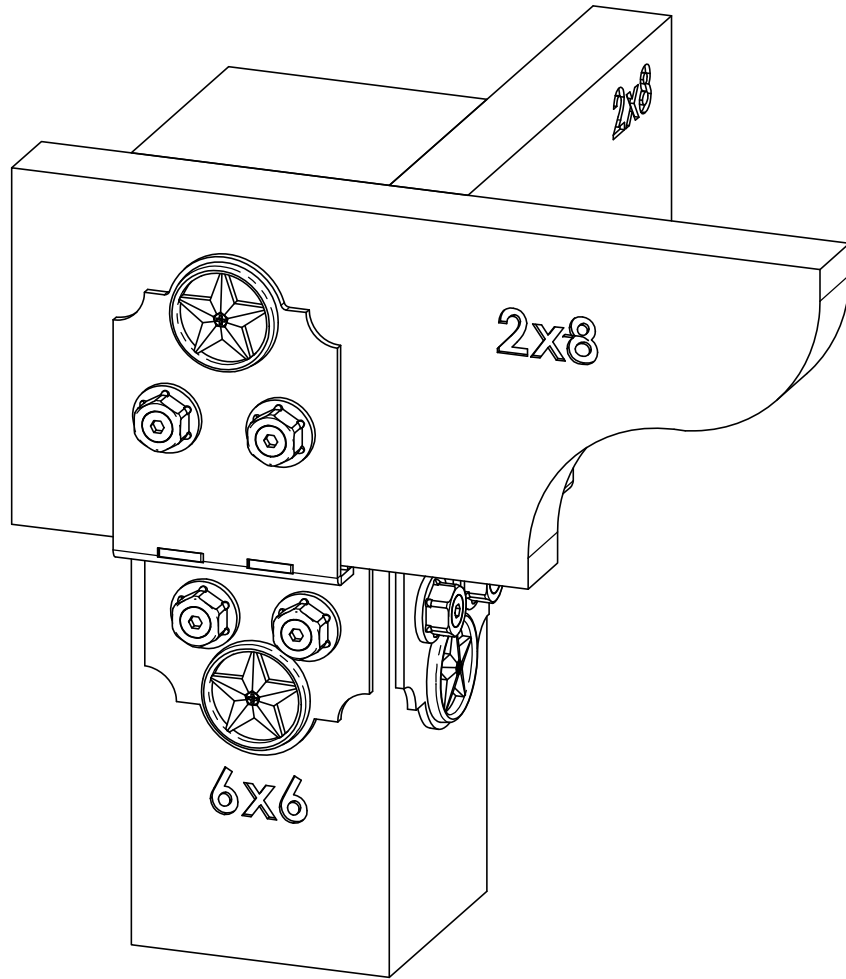

STARS SOLD SEPARATELY

Weight: 41.60 LBS
Scale: 1:4
Last updated: 10/10/2016

56610-10

Product & Packaging Specs

8" Post to Beam (P2B-LS-8)

Item #: Typical Installation & Basic Assembly

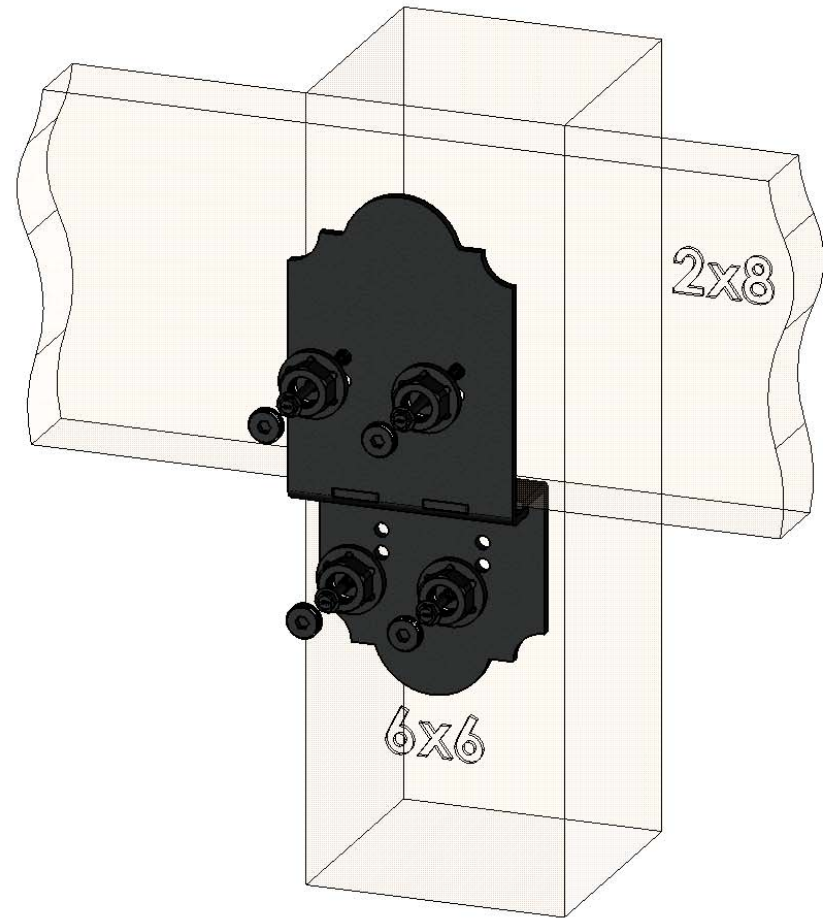
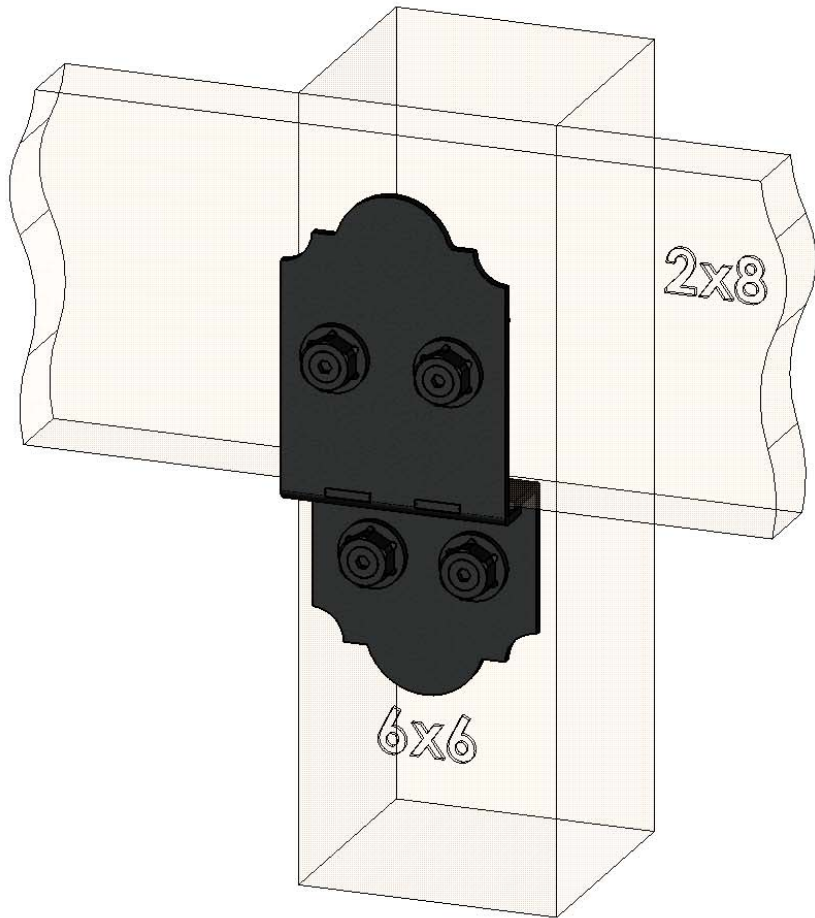

Weight: 32.75 LBS
Scale: 1:4
Last updated: 10/10/2016

56610-10

Product & Packaging Specs

8" Post to Beam (P2B-LS-8)

Item #: Typical Installation & Basic Assembly

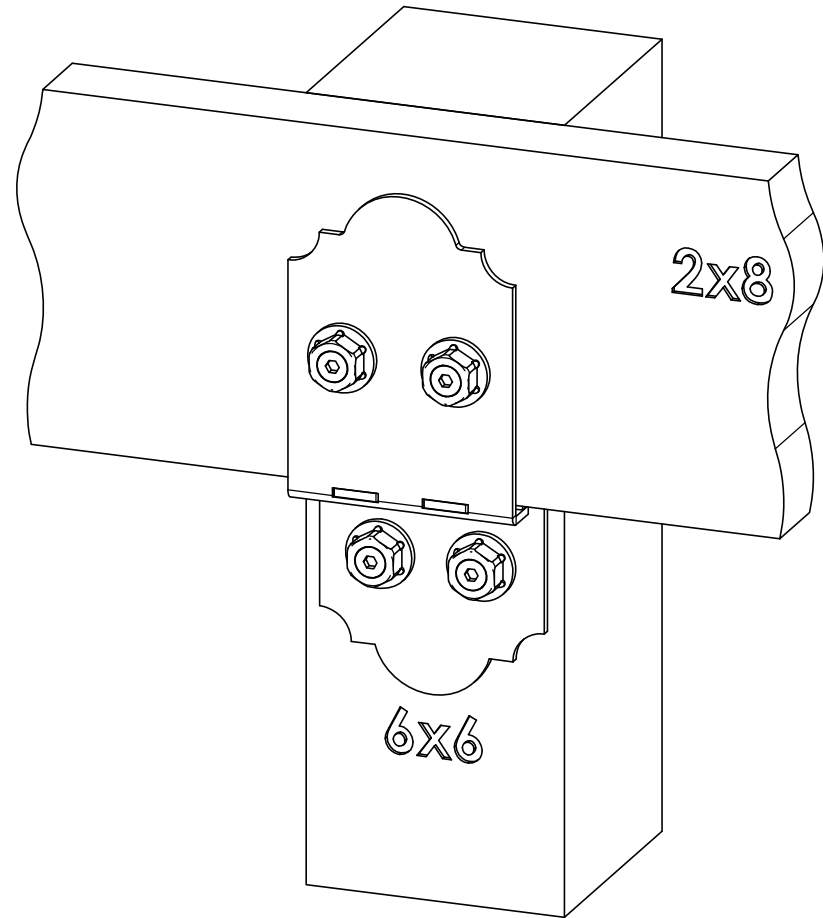
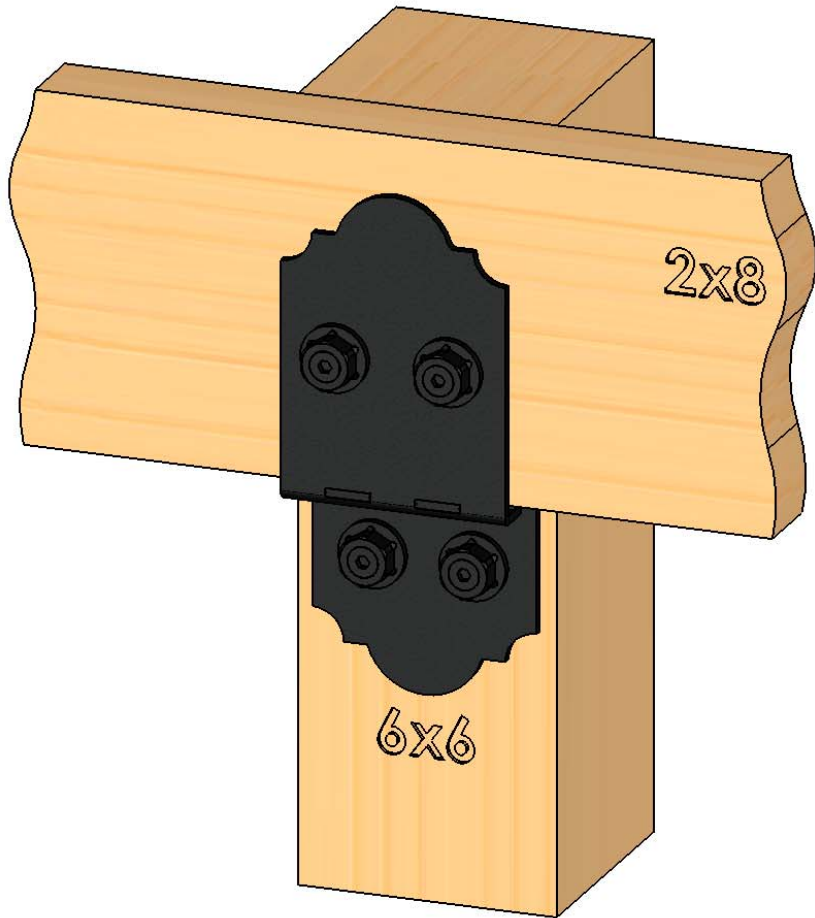

Weight: 32.75 LBS
Scale: 1:4
Last updated: 10/10/2016

56610-10

Product & Packaging Specs

8" Post to Beam (P2B-LS-8)

Item #: Typical Installation & Basic Assembly

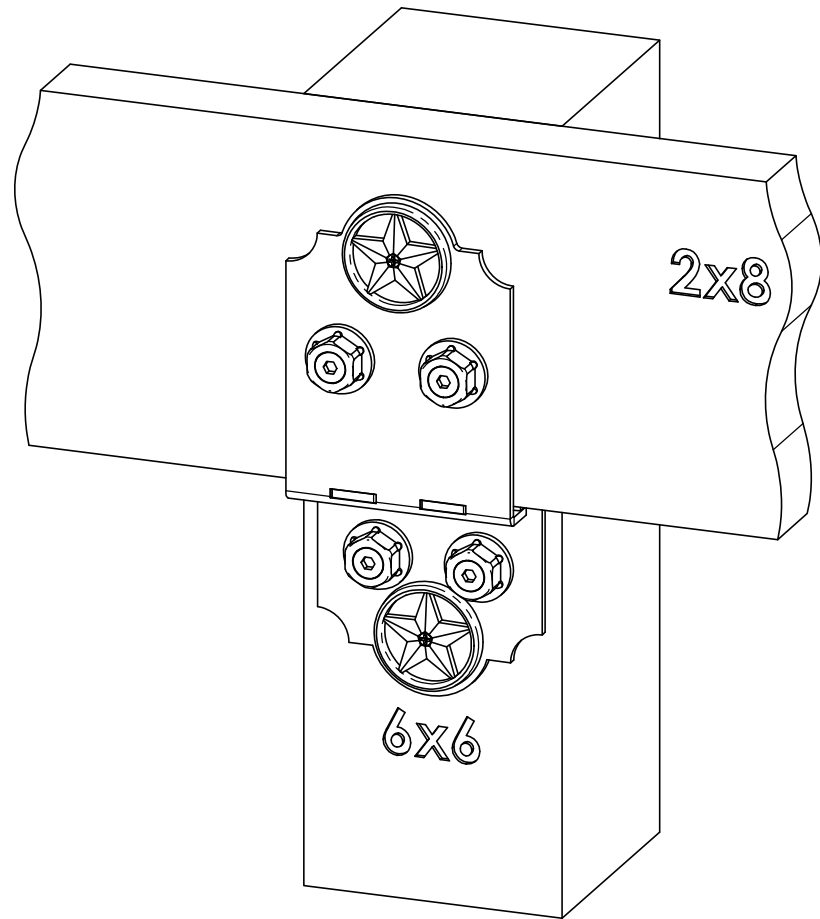
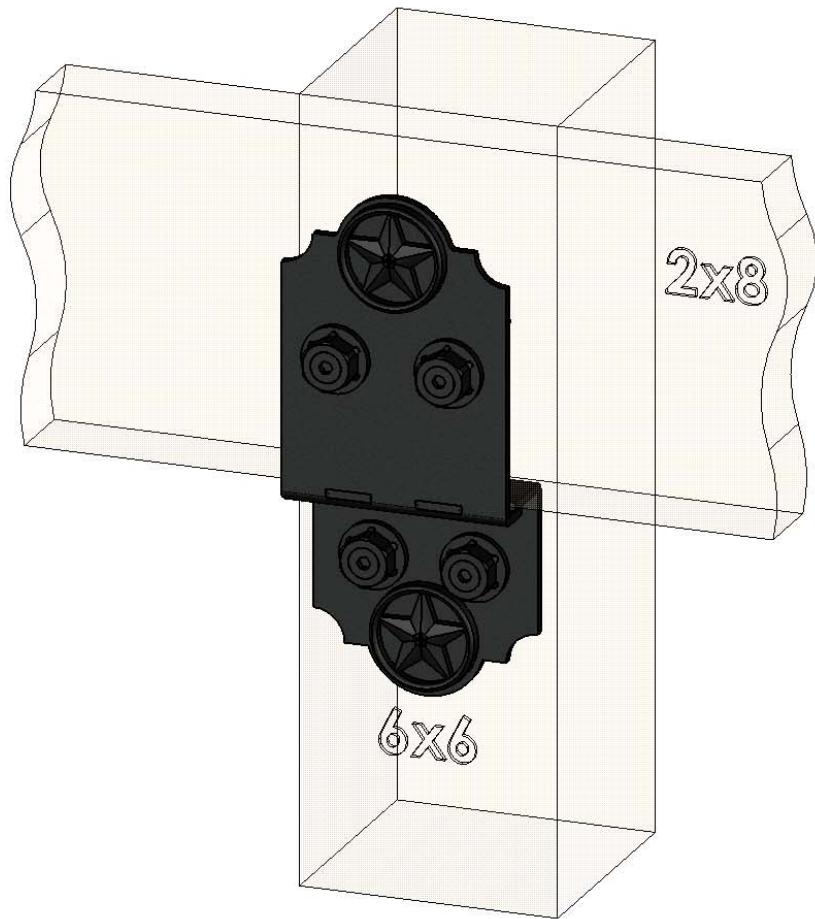

STARS SOLD SEPARATELY

Weight: 32.88 LBS
Scale: 1:4
Last updated: 10/10/2016

56610-10

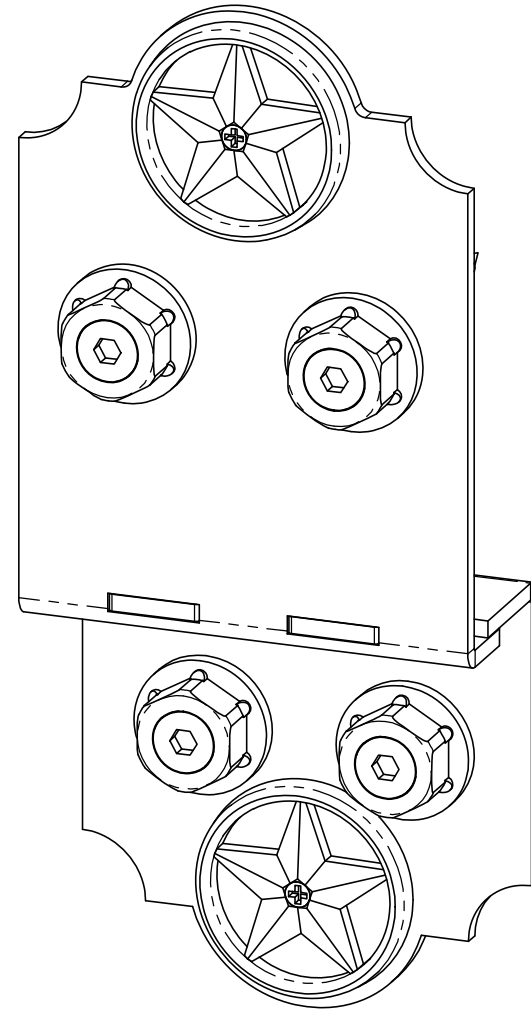
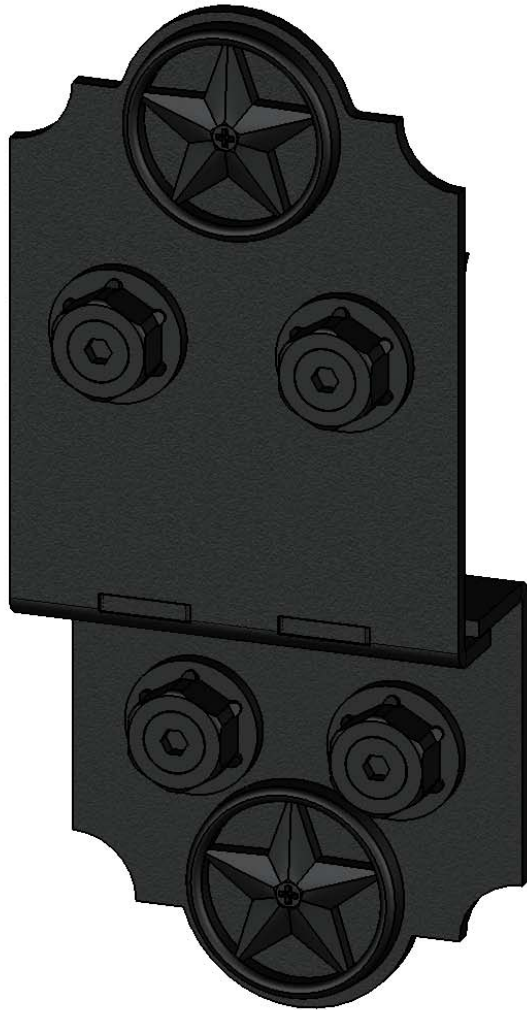

Weight: 3.69 LBS
Scale: 1:2
Last updated: 10/10/2016

STARS SOLD SEPARATELY

Product & Packaging Specs

56610 Packing

Item #: Box packing

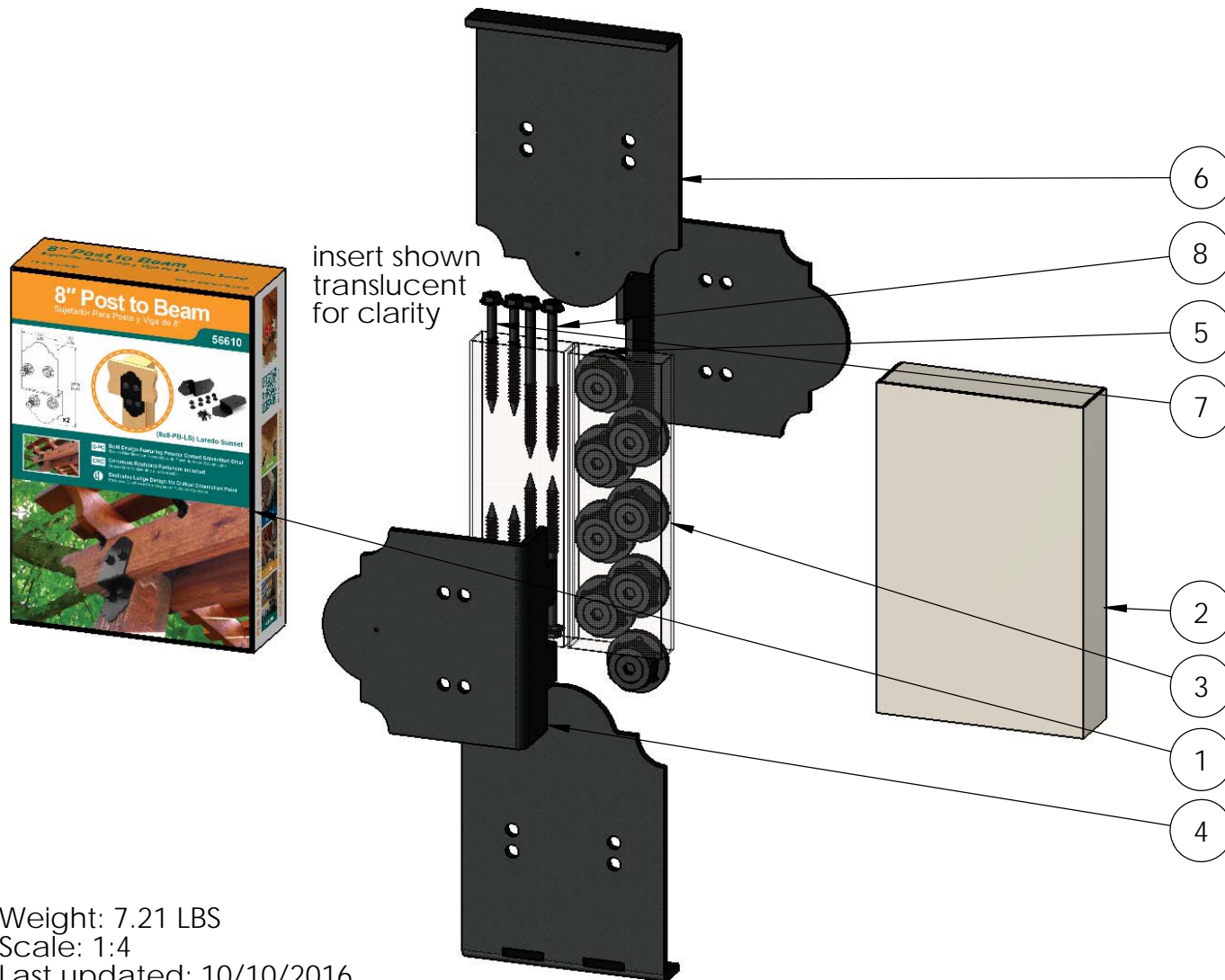

ITEM NO.	QTY.	PART NUMBER	DESCRIPTION
1	1	56610 Box	Box, Post to Beam
2	1	56637 Inner Box	56637 Inner Box
3	1	56637 Inner Box Sleeve	56637 Inner Box Sleeve
4	2	56610-11	Ledge, Post to Beam
5	0.8	56621	1 1/2" Hex Cap Nut (HCN)
6	2	56610-12	Plate, Top 8" Post to Beam
7	0.08	56626	OWT Timber Screw 2-3/4"
8	0.24	56627	OWT Timber Screw 3-3/4"

Weight: 7.21 LBS
 Scale: 1:4
 Last updated: 10/10/2016

56610-10

Product & Packaging Specs

56610 Packing

Item #: Case packing

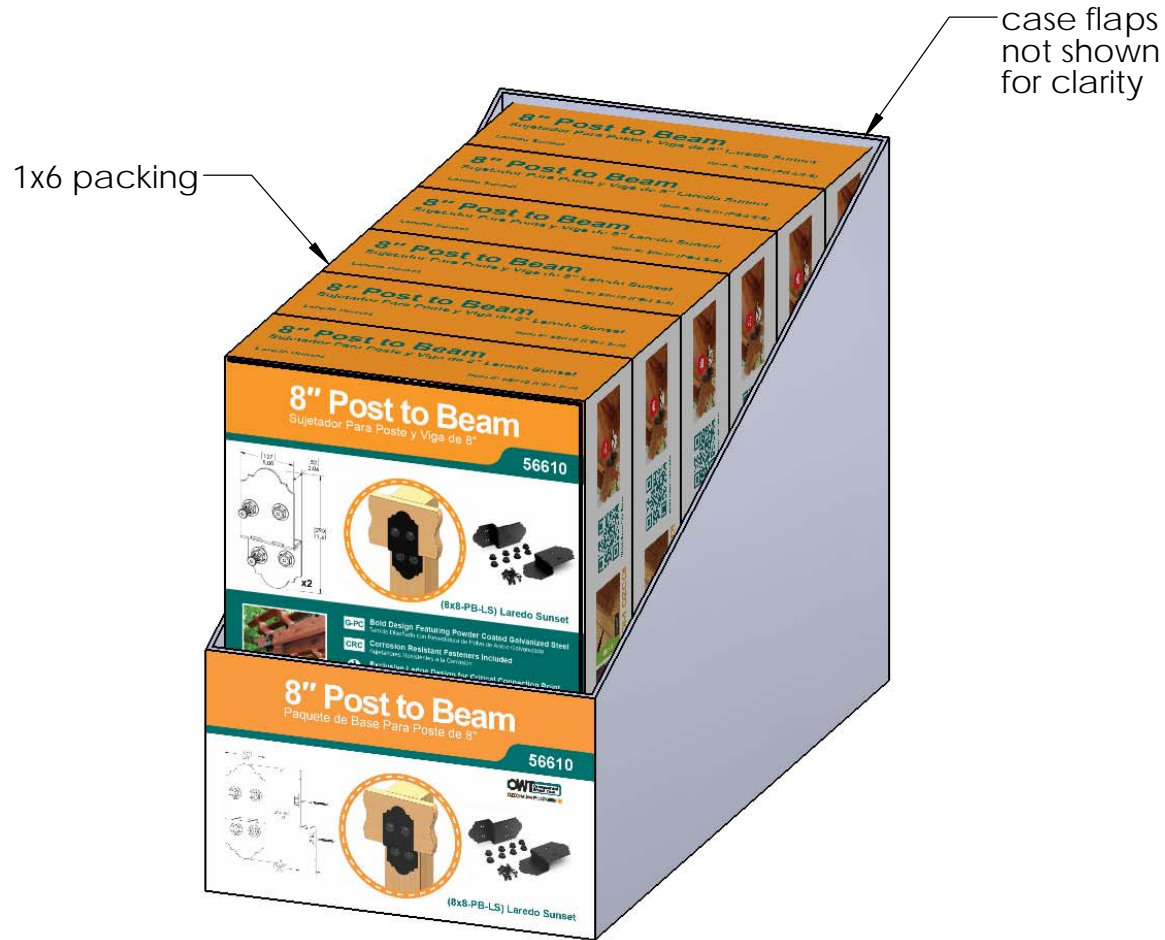

Weight: 44 LBS
 Scale: 1:3
 Last updated: 10/10/2016

56610-10

Item #: **56610** | **P2B-LS-8**

8" Post to Beam LS

PALLET **168 pcs**

SKU#: **56810**



Weight: **1351** lbs

LOT# _____ Priority# _____ **OWT** **OZCO**

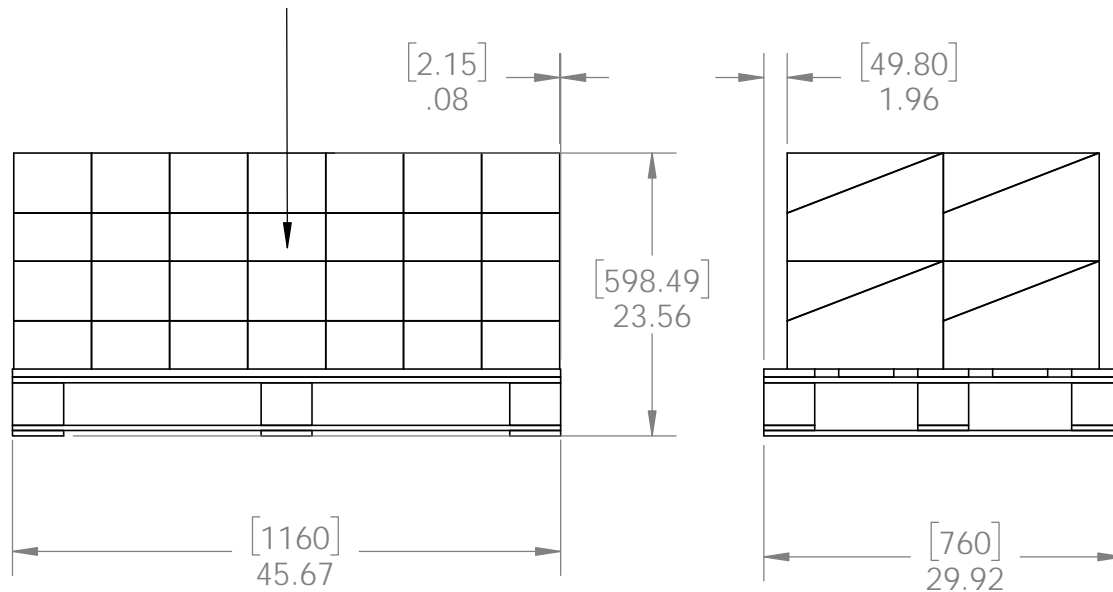

Total number of cases: 28
 Total number of pieces:
 28x6=168 pieces on pallet

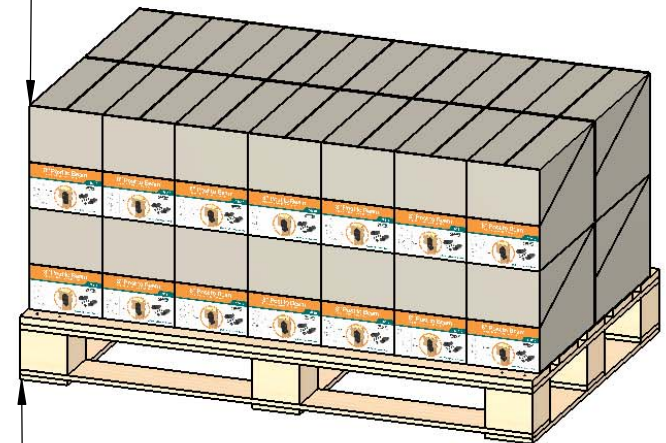

A pallet



additional pallet packing instructions

- plywood on top layer
- strap to pallet
- clear wrap around boxes

Weight: 1351 LBS
 Scale: 1:16
 Last updated: 10/10/2016