



OZCO BUILDING PRODUCTS

Product & Packaging Specs

6x6 Post Base with Rail Saddles (6X6-TRS-IW)

Item #: 51772

ITEM NO.	QTY.	PART NUMBER	DESCRIPTION
1	1	56608-11	Assembly, 6x6 Stand Off
2	2	51708-15	Plate, 6x6 Side Compression
3	0.6	56621	1 1/2" Hex Cap Nut (HCN)
4	0.24	56626	OWT Timber Screw 2-3/4"
5	2	51708-16	Plate, 6x6 Side Compression
6	12	80016	#12 x 1-1/4 Torx HD Sharp Point (T25)
7	2	56641-12	Bracket, 2x4 Top Rail Saddle

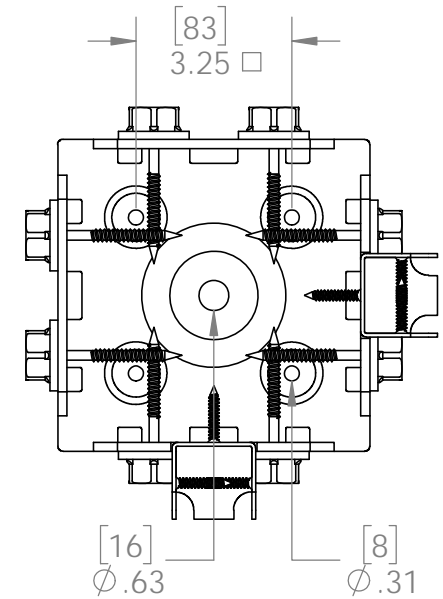
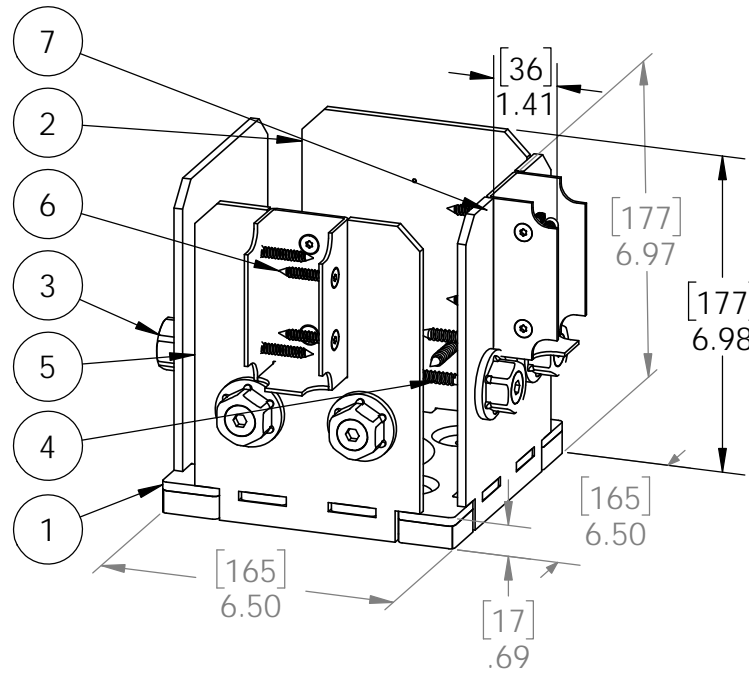
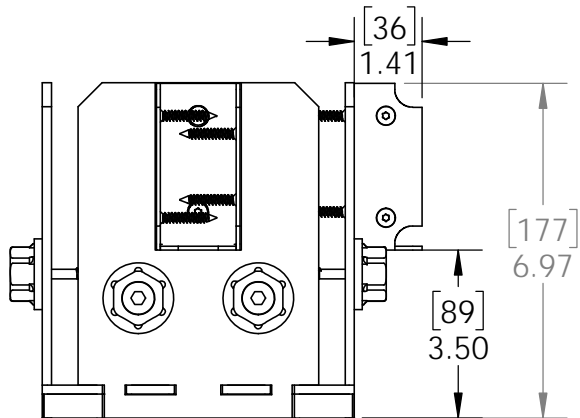
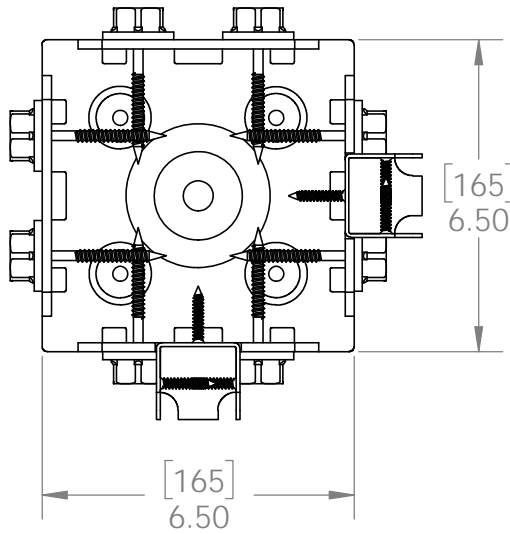

Weight: 9.58 LBS
 Scale: 1:4
 Last updated: 2/15/2017

51772

Product & Packaging Specs

6x6 Post Base with Rail Saddles (6X6-TRS-IW)

Item #: 51772

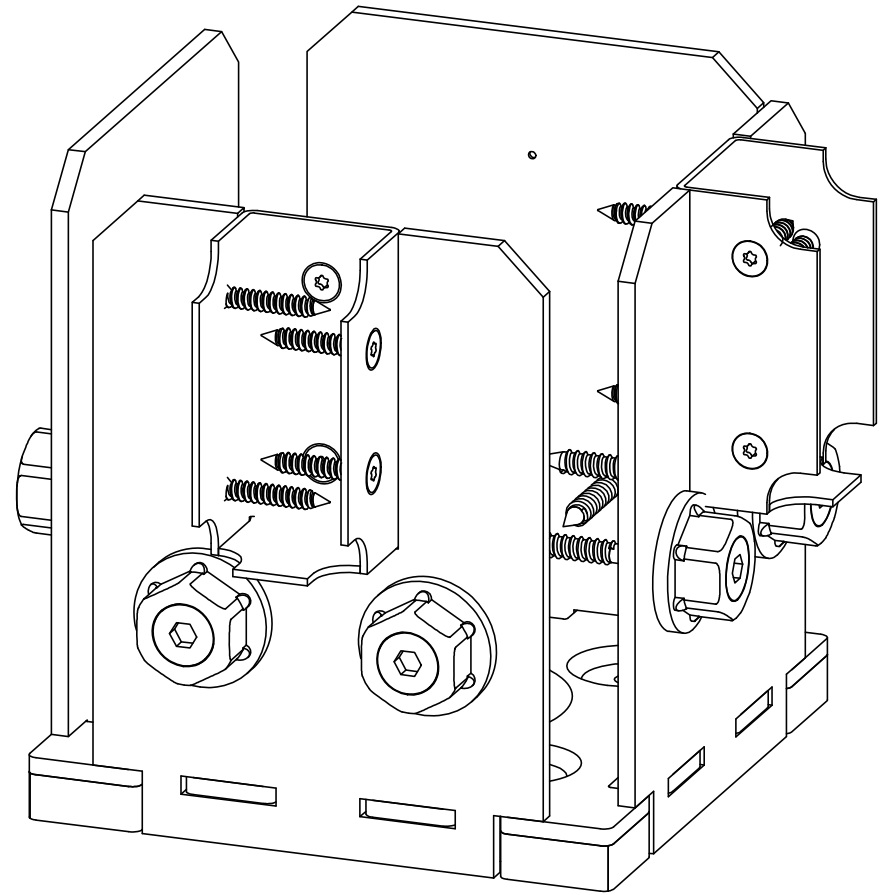
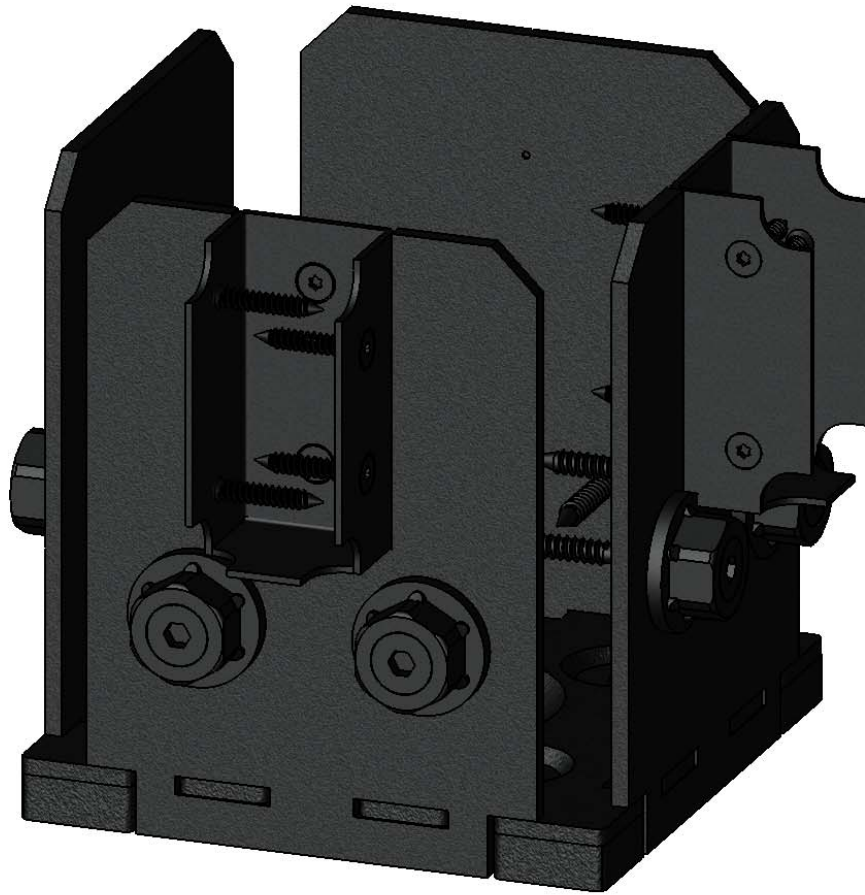

Weight: 9.58 LBS
Scale: 1:2
Last updated: 2/15/2017

51772

Product & Packaging Specs

6x6 Post Base with Rail Saddles (6X6-TRS-IW)

Item #: 51772

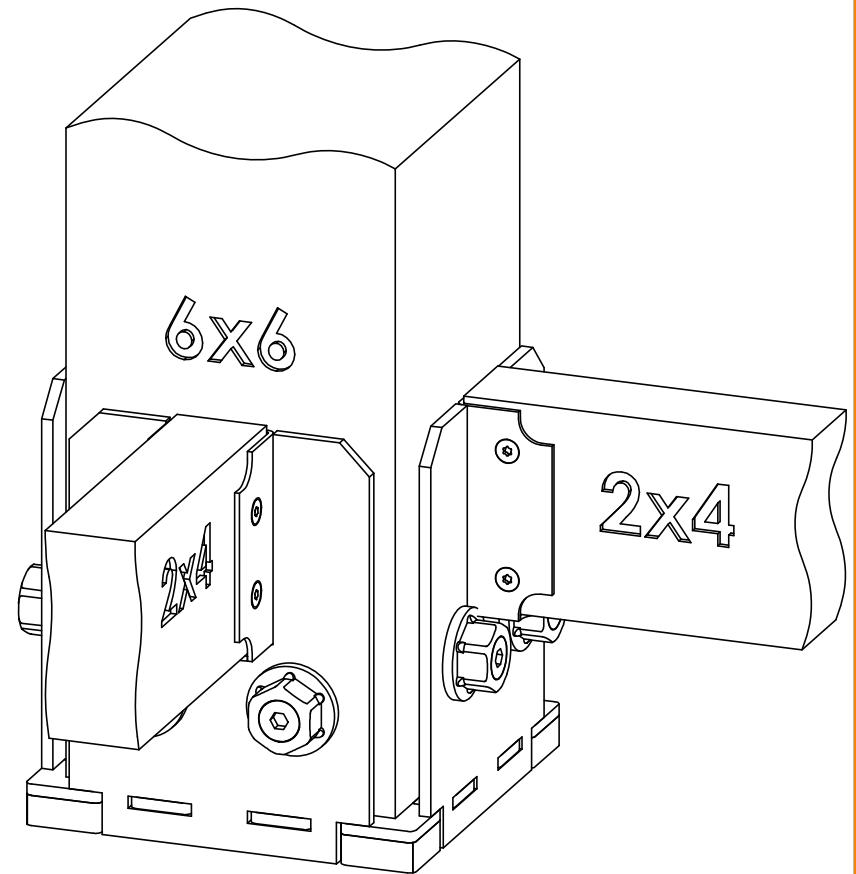
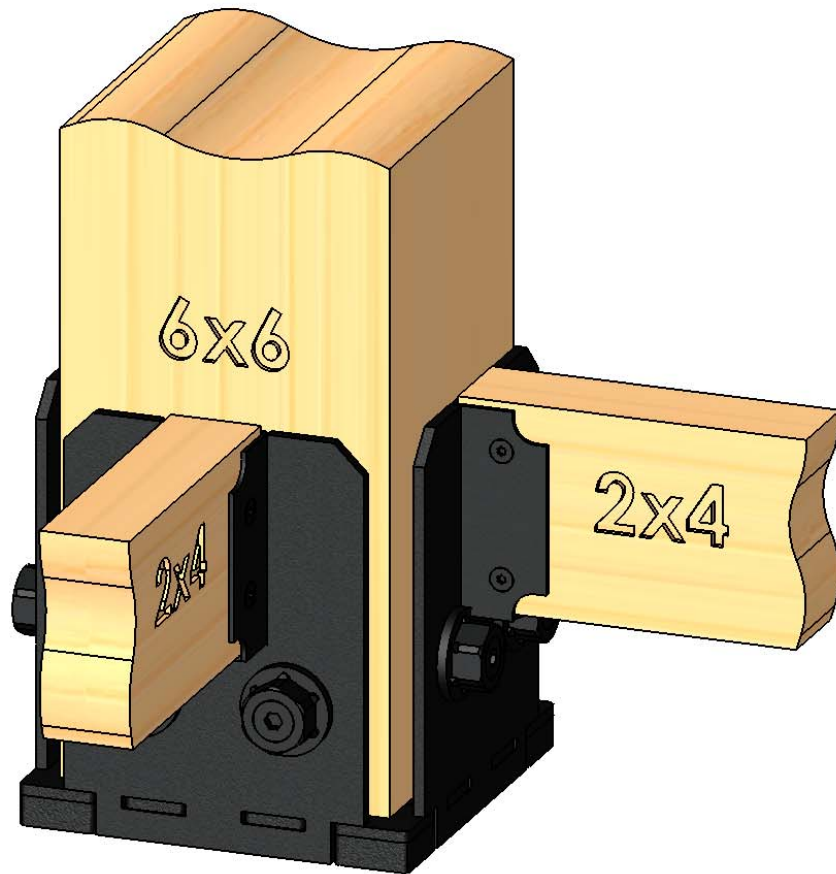

Weight: 9.58 LBS
Scale: 1:3
Last updated: 2/15/2017

51772



OZCO BUILDING PRODUCTS

Product & Packaging Specs

6x6 Post Base with Rail Saddles (6X6-TRS-IW)

Item #: 51772

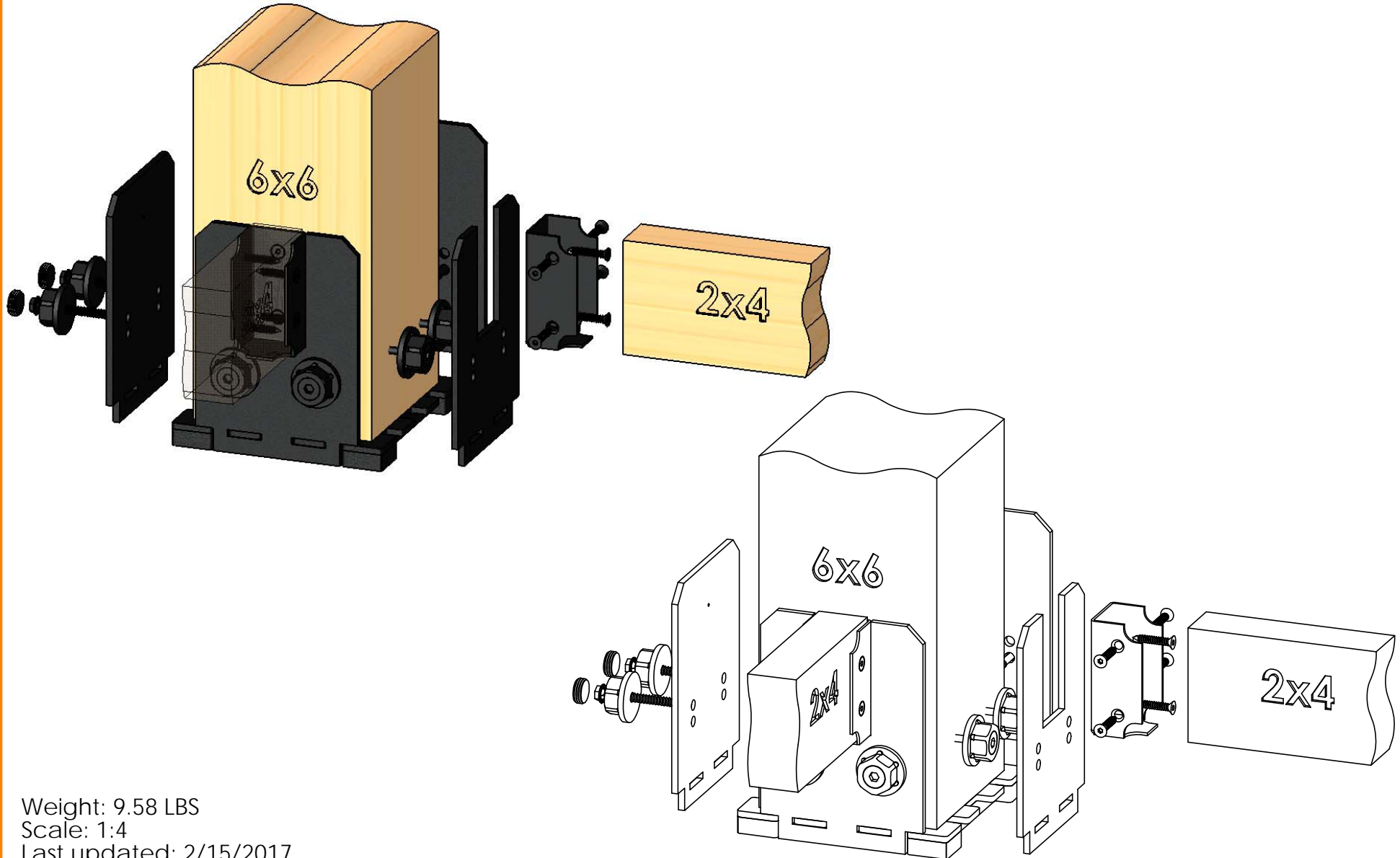

Weight: 9.58 LBS
Scale: 1:4
Last updated: 2/15/2017

51772

V2.00 - Installation Instructions, Specifications and Project Plans are effective 2/15/2017. This information is updated periodically and should not be relied upon after 2 years from 2/15/2017. Please visit OZCOBP.com to get current information.

Product & Packaging Specs

Box, 51772

Item #: Box

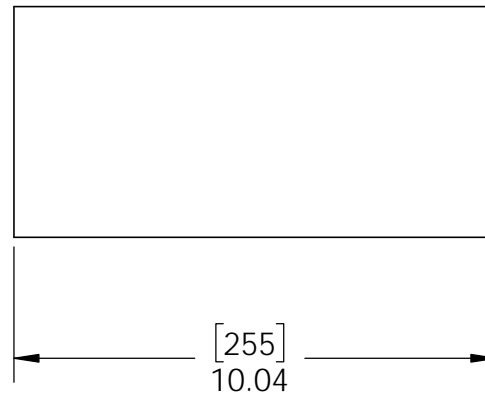
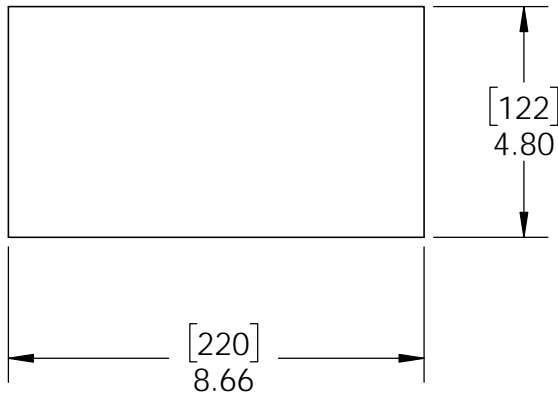

Material: Corrugated Paper
 Finish: See Artwork
 Weight: 70.55 LBS
 Scale: 1:4
 Last updated: 2/15/2017

51772



OZCO BUILDING PRODUCTS

Product & Packaging Specs

51772 Packing

Item #: Box packing

items not shown:

- installation instructions
- parts wrapped in packing foam sheet

ITEM NO.	QTY.	PART NUMBER	DESCRIPTION
1	1	Box, 51772	Box, 51772
2	1	51772	6x6 Post Base with Rail Saddles (6X6-TRS-IW)

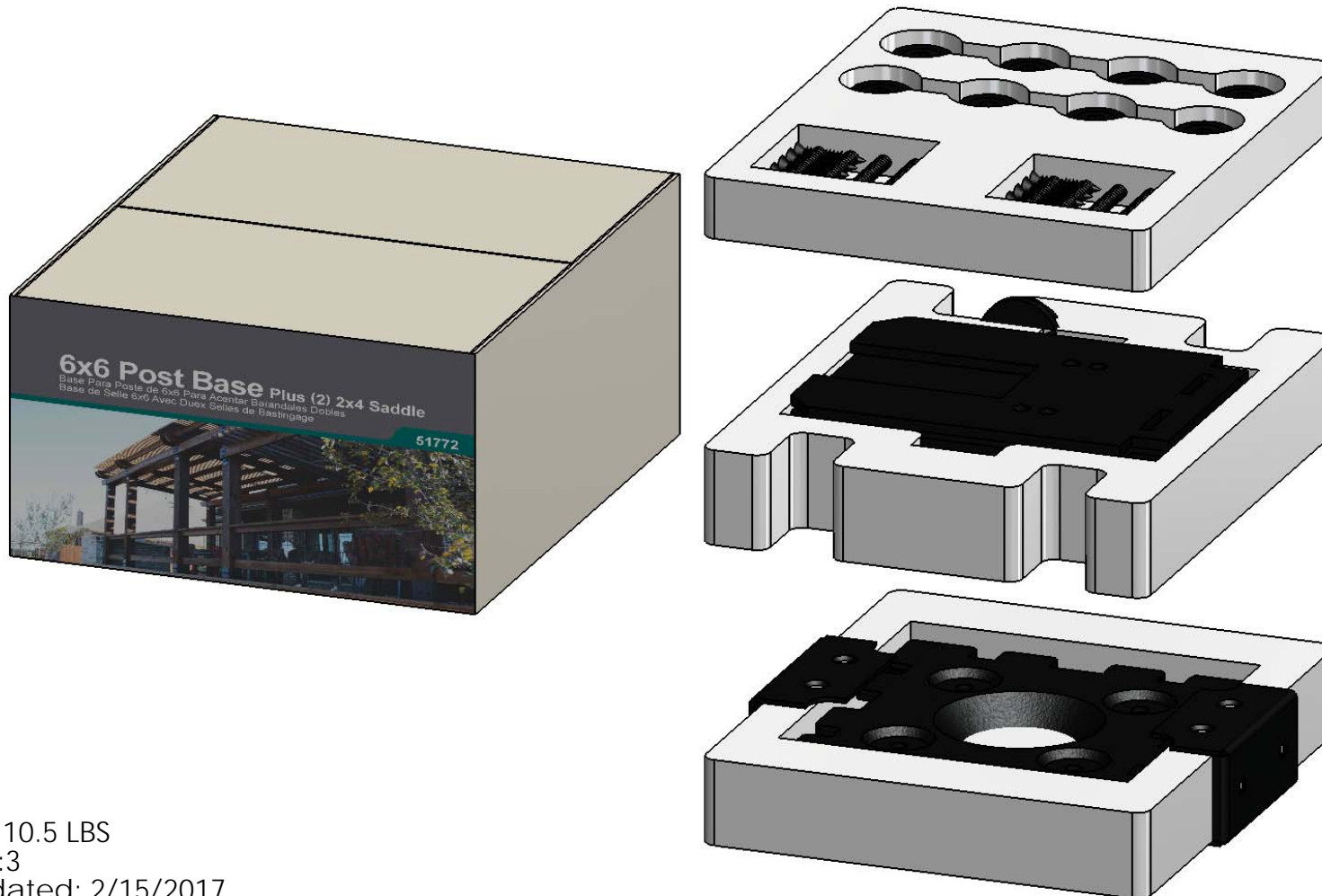

Weight: 10.5 LBS
 Scale: 1:3
 Last updated: 2/15/2017

51772

Product & Packaging Specs

Case, 51772

Item #: Case

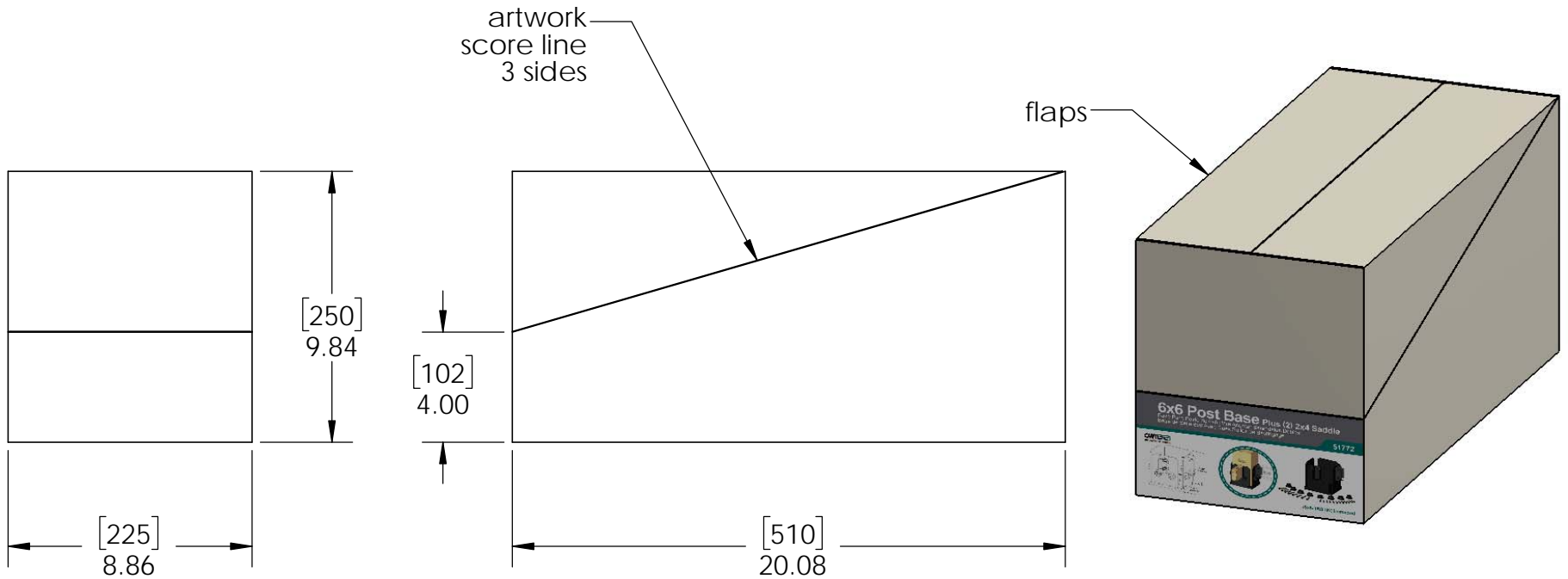

Weight: 185.48 LBS
 Scale: 1:6
 Last updated: 2/15/2017

51772



OZCO BUILDING PRODUCTS

Product & Packaging Specs

51772 Packing

Item #: Case packing

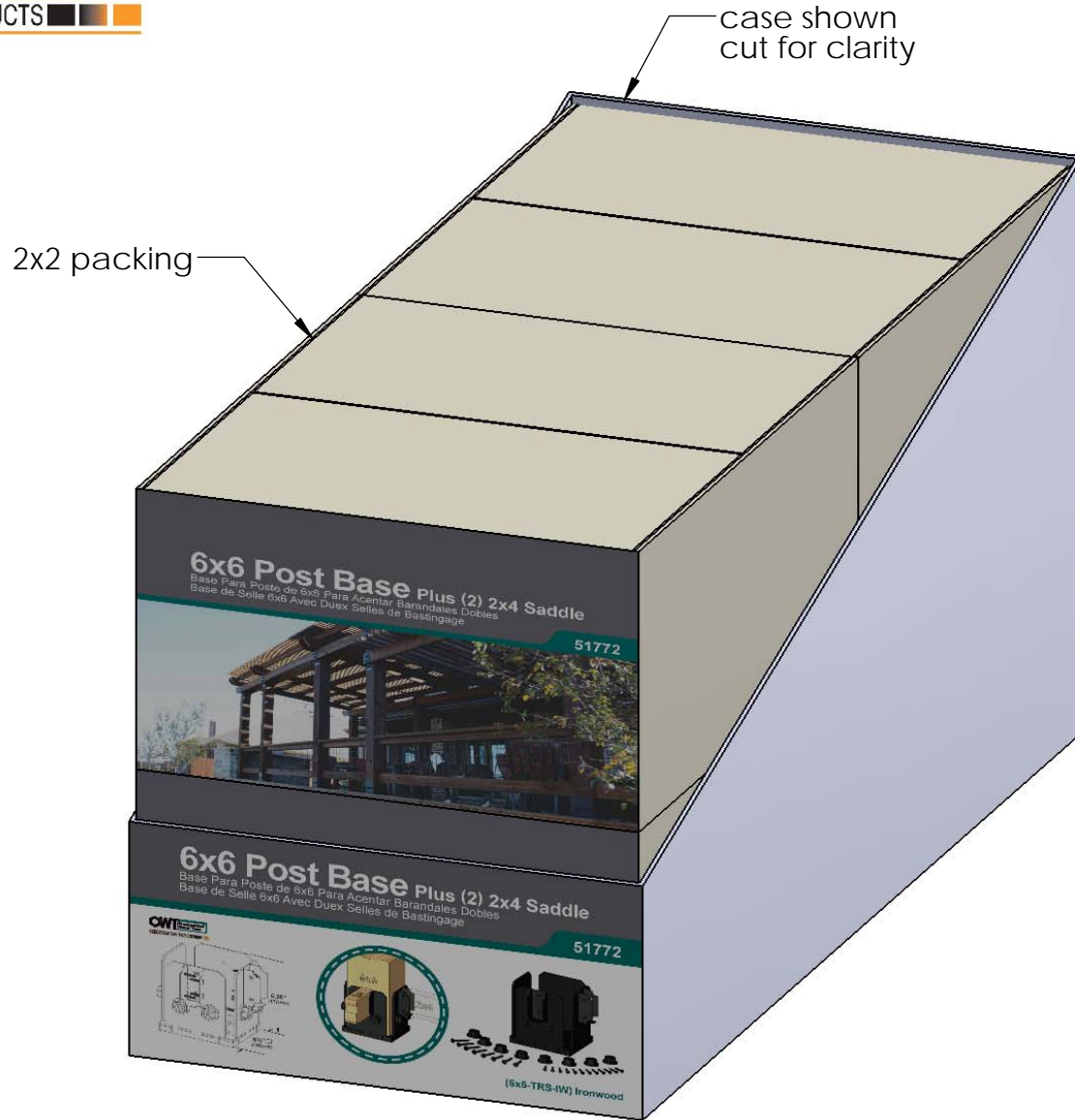

Weight: 44 LBS
Scale: 1:3
Last updated: 2/15/2017

51772



OZCO BUILDING PRODUCTS

Product & Packaging Specs

51772 Packing

Item #: Pallet packing

6x6-TRS-IW

6X6 POST BASE PLUS (2) 2X4 SADDLES

Item #:

51772

84 pcs



SKU#: 51972

Weight: 943.57 lbs

LOT# _____ Priority# _____

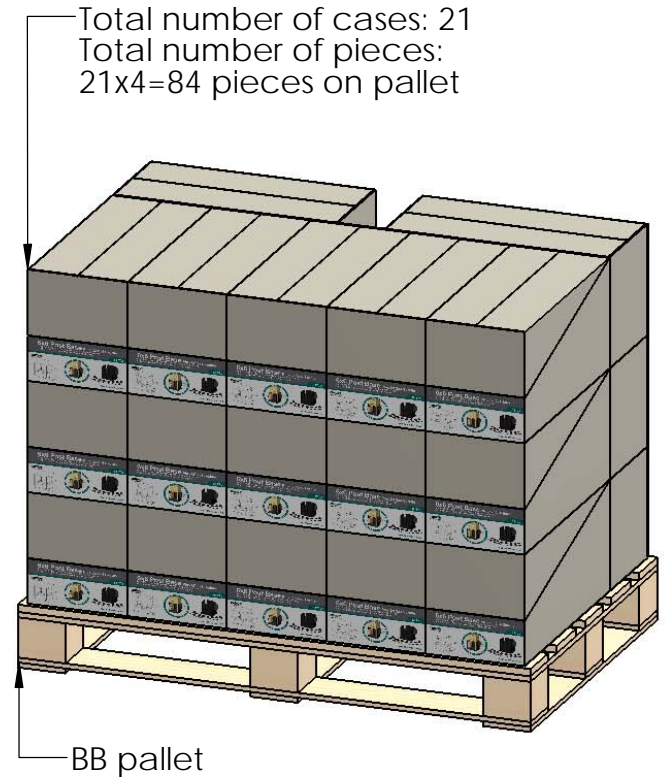
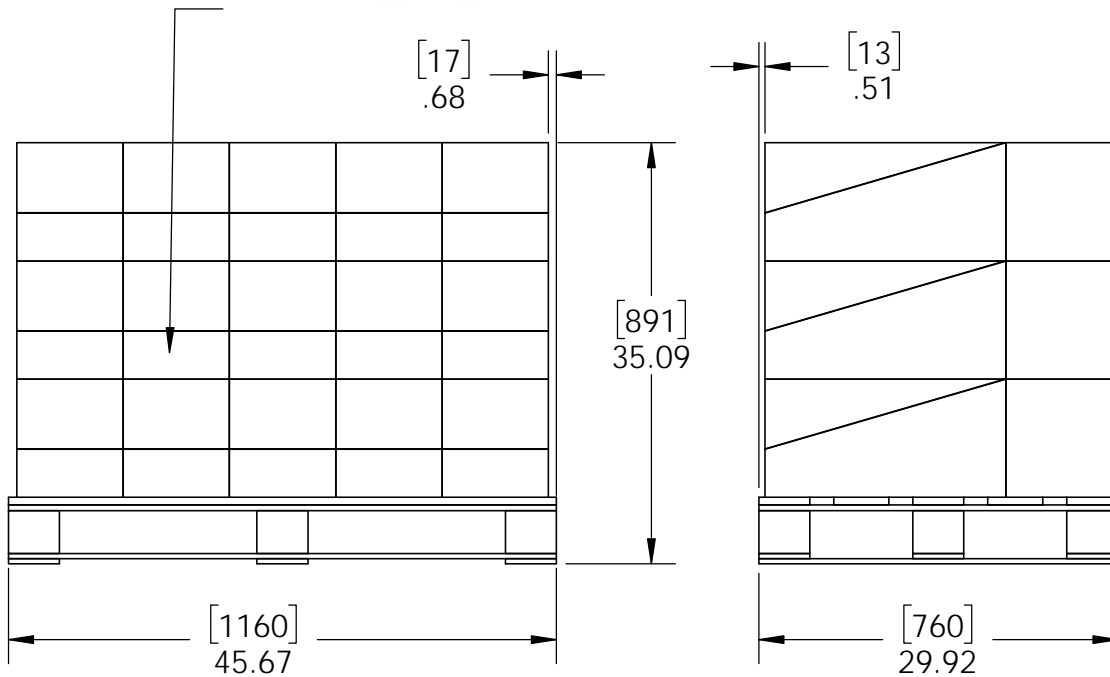

additional pallet packing instructions
plywood on top layer
strap to pallet
clear wrap around boxes

Weight: 944 LBS
Scale: 1:16
Last updated: 2/15/2017

51772