



instant post holes

OZCO BUILDING PRODUCTS

Product & Packaging Specs

27" 1-7/8 Dia Post Anchor (HB-700)

Item #: 30020

ITEM NO.	QTY.	PART NUMBER	DESCRIPTION
1	1	30020-11	Assembly, Base Anchor
2	1	30020-13	Base, Post Anchor Steel
3	1	30020-14	Cap, Post Anchor Steel

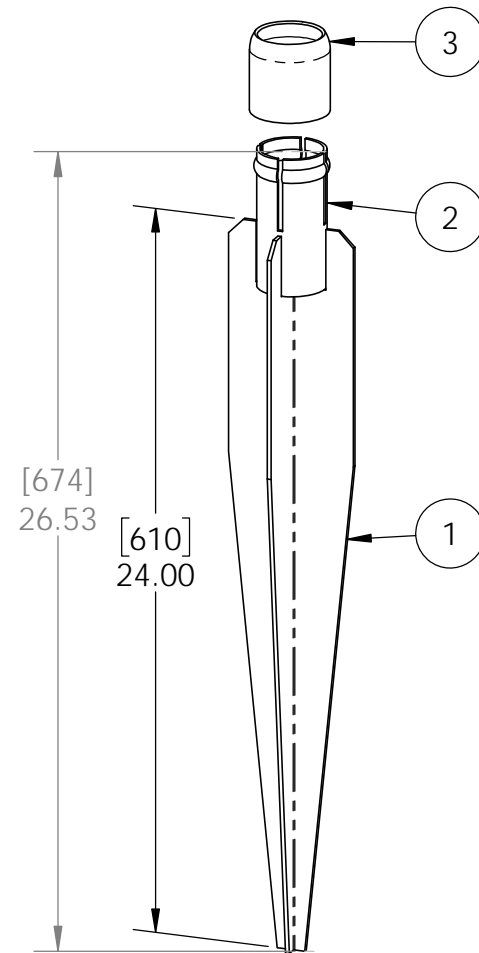
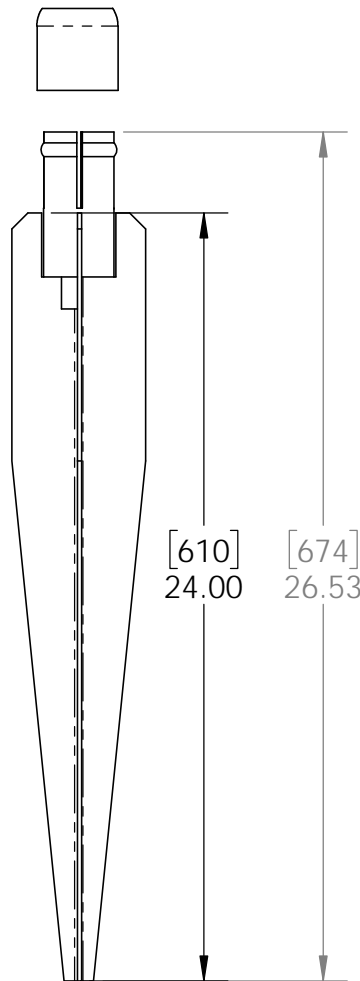
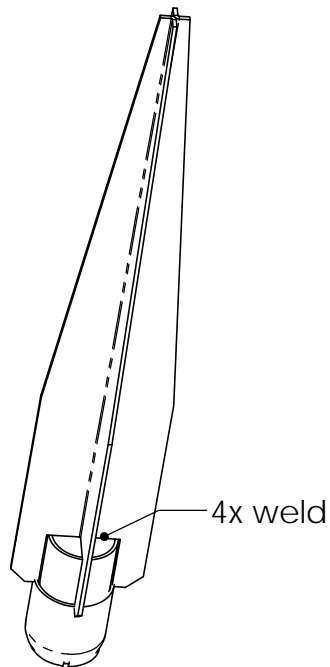

Weight: 6.21 LBS
 Scale: 1:6
 Last updated: 10/14/2016

30020-10



Product & Packaging Specs

27" 1-7/8 Dia Post Anchor (HB-700)

Item #: 30020

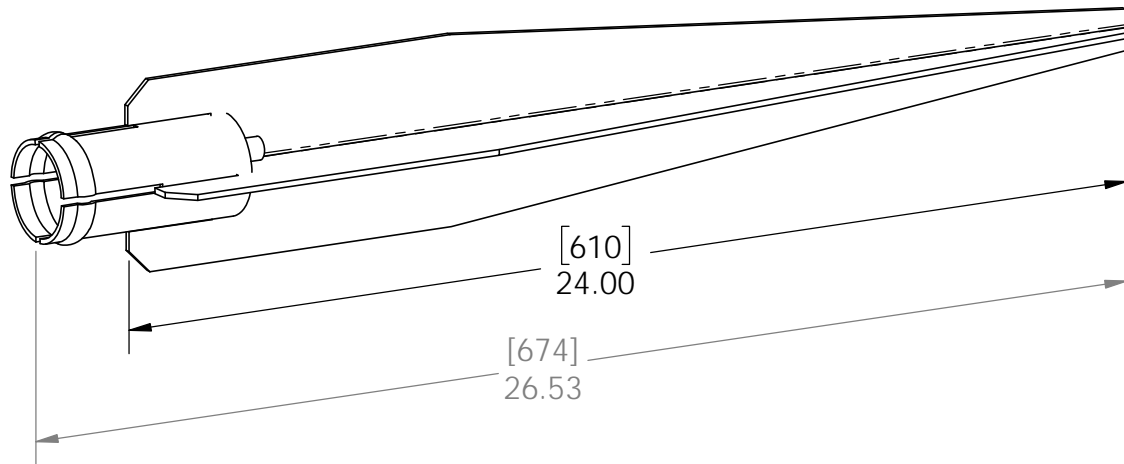

Weight: 6.21 LBS
Scale: 1:4
Last updated: 10/14/2016

30020-10

V2.00 - Installation Instructions, Specifications and Project Plans are effective 10/14/2016 . This information is updated periodically and should not be relied upon after 2 years from 10/14/2016 . Please visit OZCOBP.com to get current information.

OZ-POST

instant post holes

OZCO BUILDING PRODUCTS

Product & Packaging Specs

27" 1-7/8 Dia Post Anchor (HB-700)

Item #: 30020

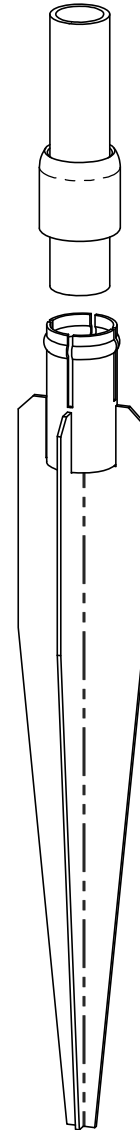
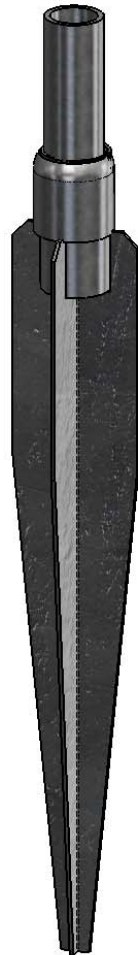
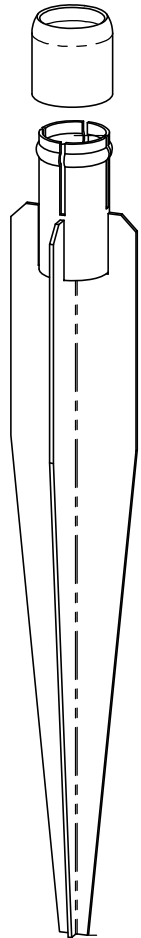

Weight: 6.21 LBS
Scale: 1:6
Last updated: 10/14/2016

30020-10

V2.00 - Installation Instructions, Specifications and Project Plans are effective 10/14/2016 . This information is updated periodically and should not be relied upon after 2 years from 10/14/2016 . Please visit OZCOBP.com to get current information. 3



instant post holes

OZCO BUILDING PRODUCTS ■■■

Product & Packaging Specs

27" 1-7/8 Dia Post Anchor (HB-700)

Item #: Typical Installation

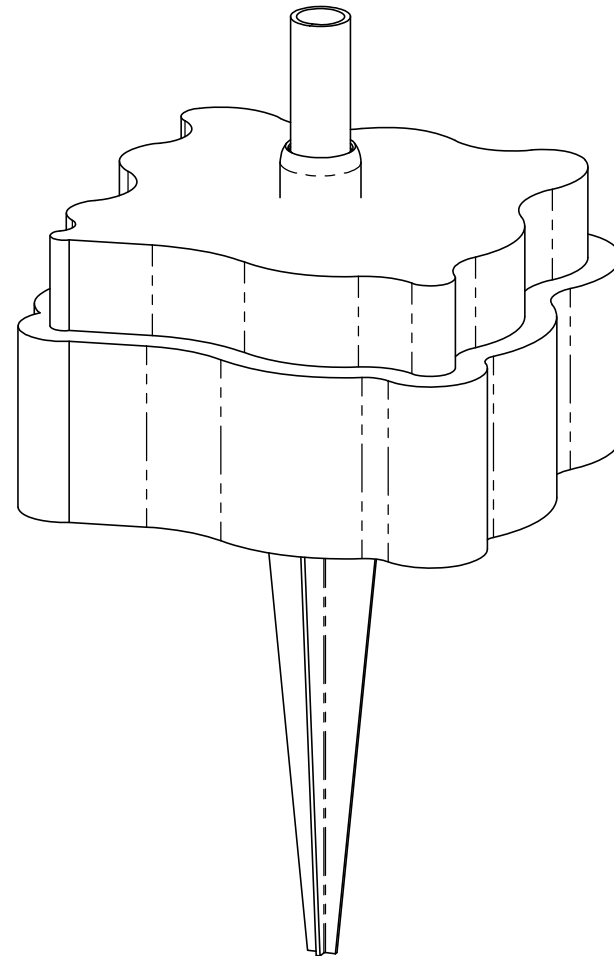
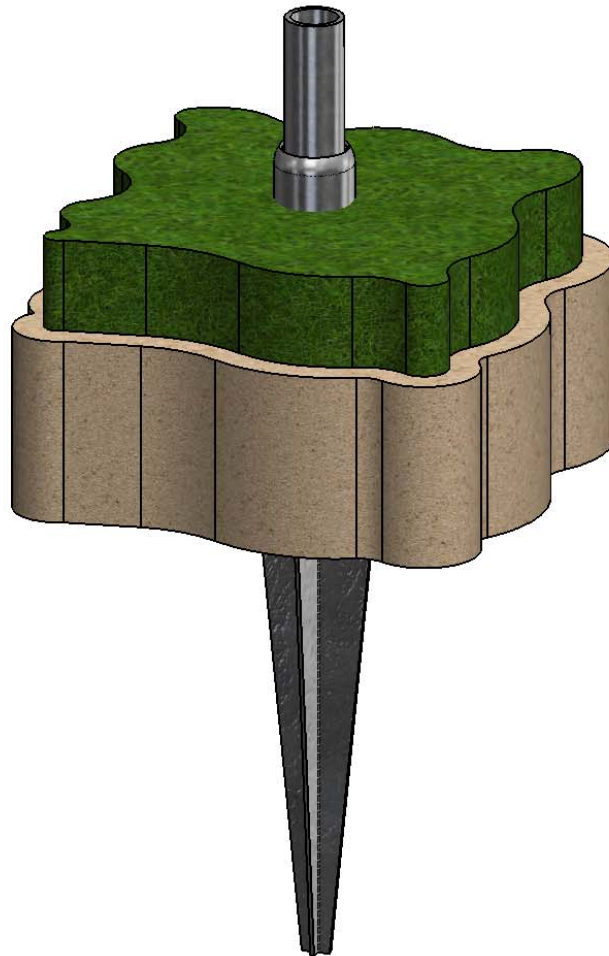

Weight: 6.21 LBS

Scale: 1:6

Last updated: 10/14/2016

30020-10



Product & Packaging Specs

Case, 30020
Item #: Case, 30020

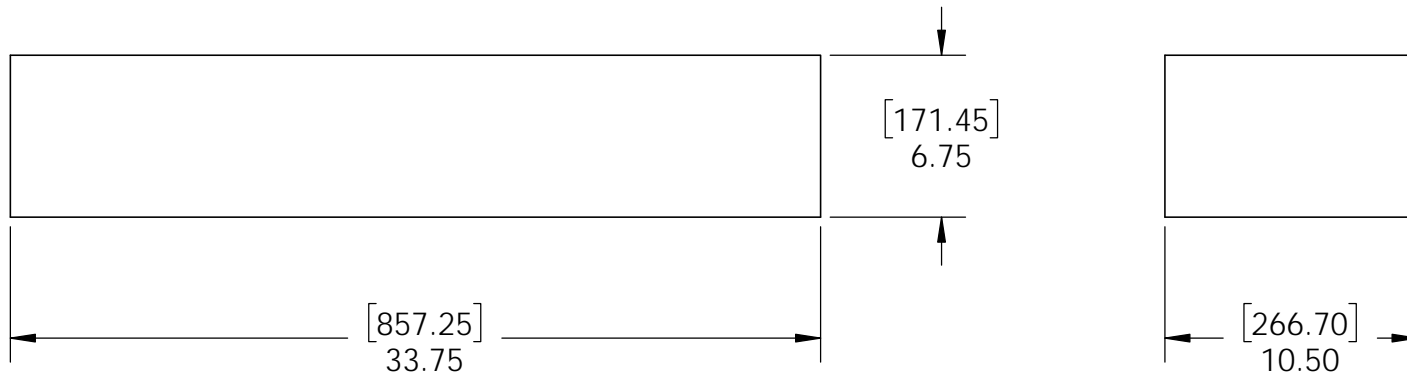
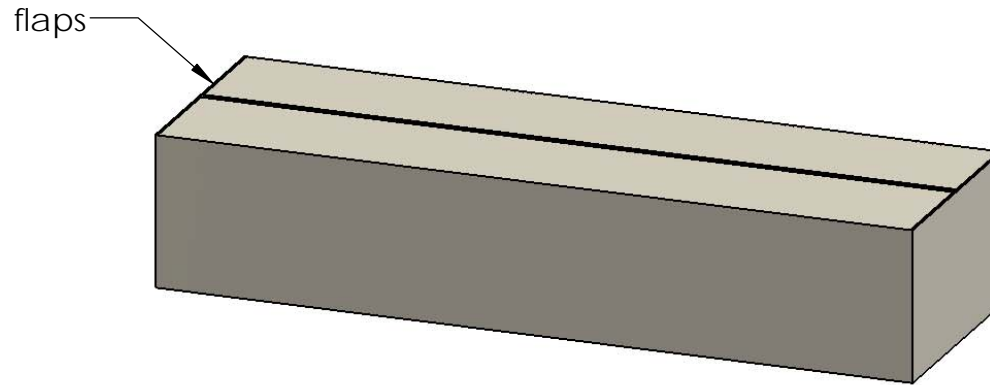

Material: Corrugated Paper
Finish: See artwork
Weight: 0.58 LBS
Scale: 1:8
Last updated: 10/14/2016

30020-10



Product & Packaging Specs

30020 Packing

Item #: Box packing

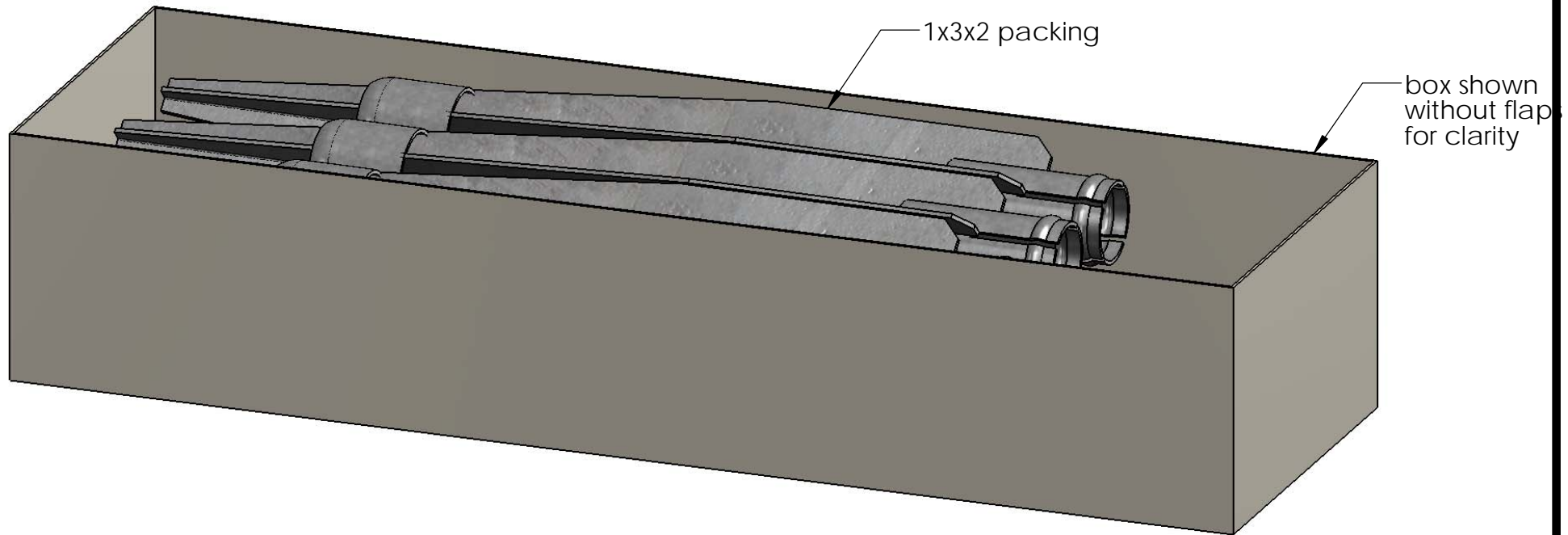

Weight: 37.69 LBS
Scale: 1:4
Last updated: 10/14/2016

30020-10

V2.00 - Installation Instructions, Specifications and Project Plans are effective 10/14/2016 . This information is updated periodically and should not be relied upon after 2 years from 10/14/2016 . Please visit OZCOBP.com to get current information. 11



Product & Packaging Specs

30020 Packing
Item #: Pallet packing

Item #: **30020** | **HB-700**
HB-700 (1 7/8" Round) Steel
PALLET 120 pcs
 SKU#: **30022**
 Weight: **730 lbs**
 LOT# Priority#

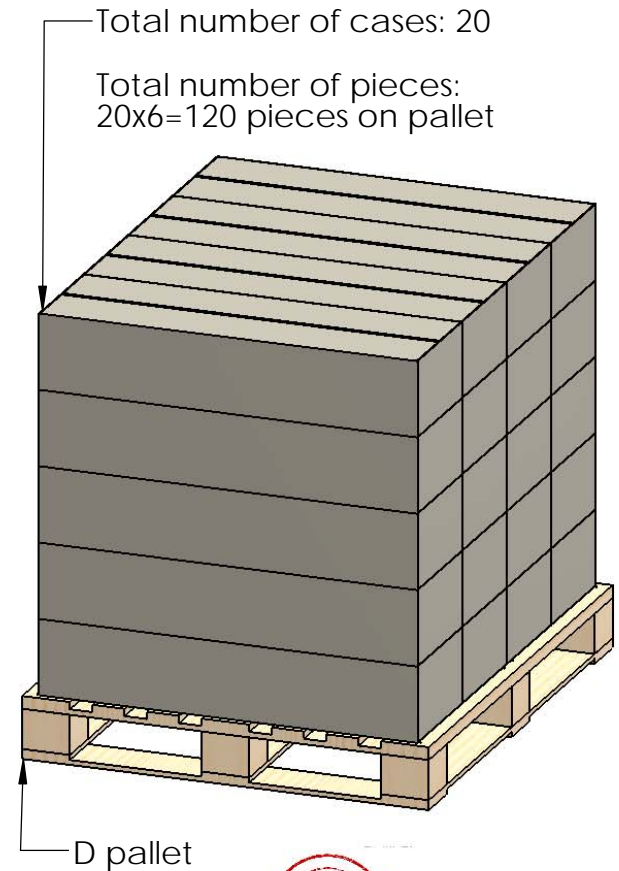
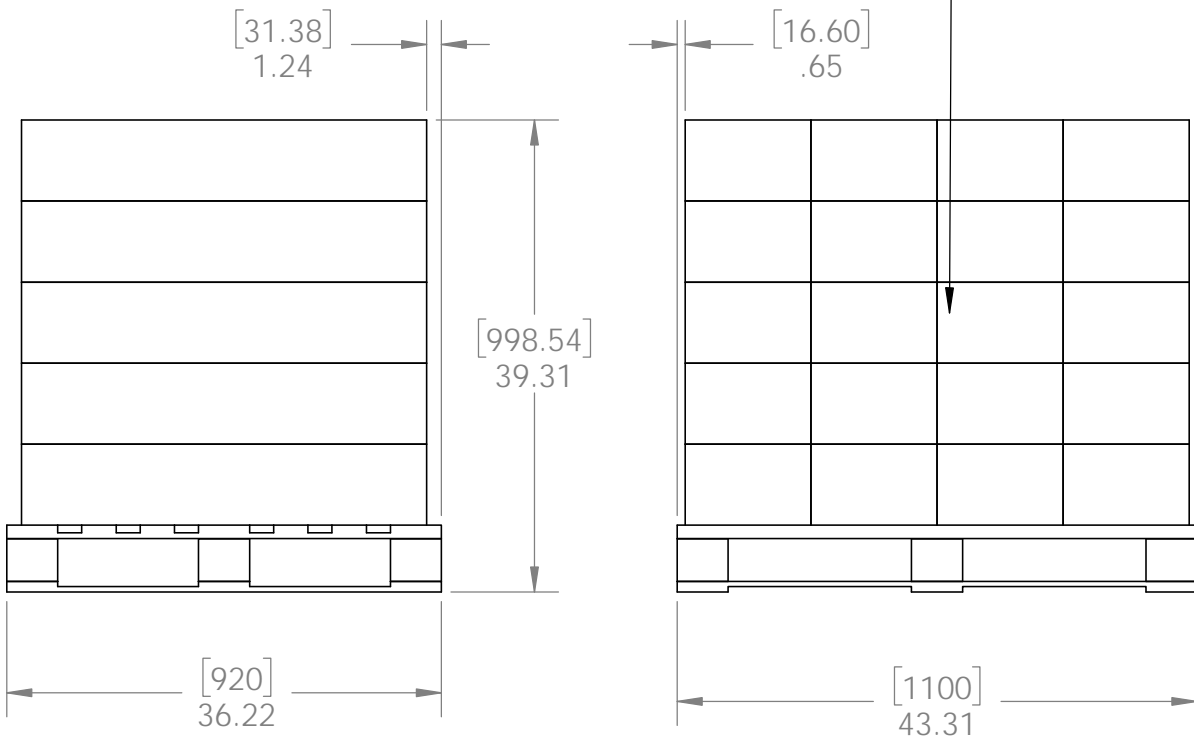

additional pallet packing instructions

- plywood on top layer
- strap to pallet
- clear wrap around boxes

Weight: 730 LBS
 Scale: 1:16
 Last updated: 10/14/2016

30020-10