

DESIGN

PURCHASE

CONSTRUCT

ENJOY

OZCO Project #576 - Firepit All Around Swing Seating



Firepit I



Firepit II



OZCO BUILDING PRODUCTS



Printing Documents from ISSUU

Unfortunately, there is currently no way to print content directly through issuu. To print a publication, you will need to download it and print it from your computer.

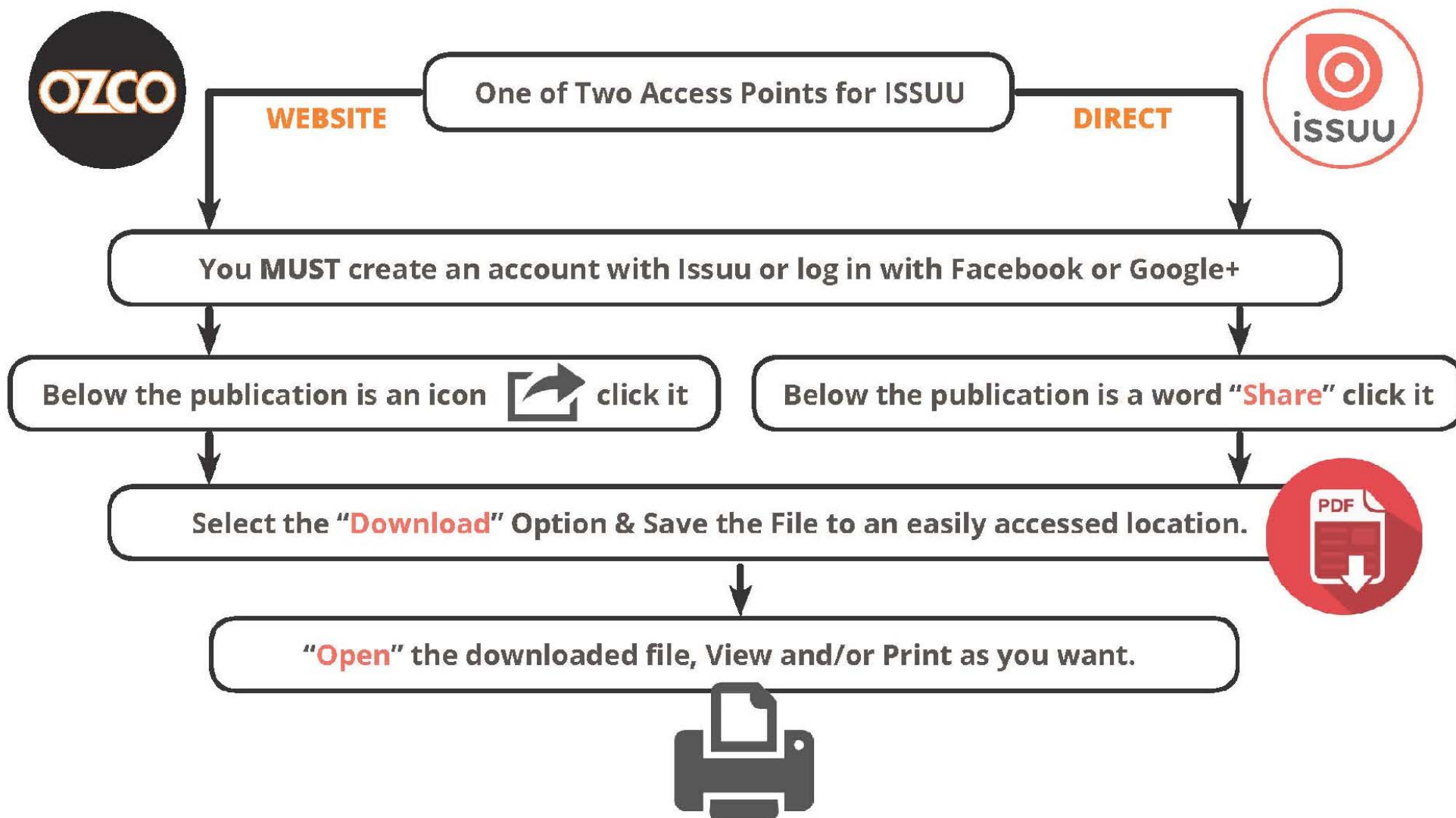



V2.00 - Installation Instructions, Specifications and Project Plans are effective 2/13/2017 . This information is updated periodically and should not be relied upon after 2 years from 2/13/2017 . Please visit OZCOBP.com to get current information.

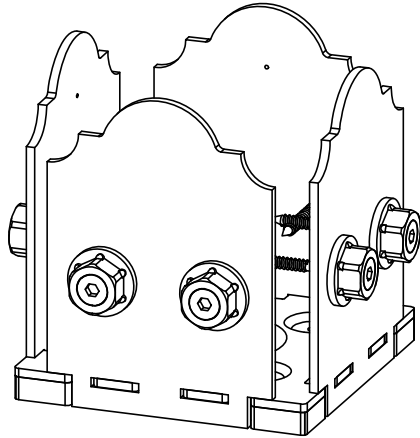

56608

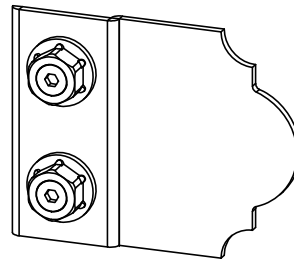

56611

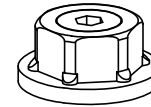

56621

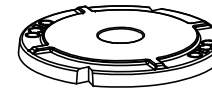

56680

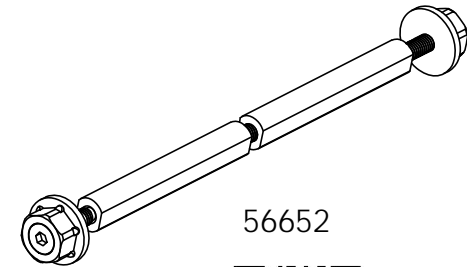

56652

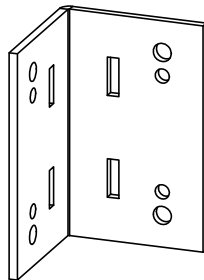

56615

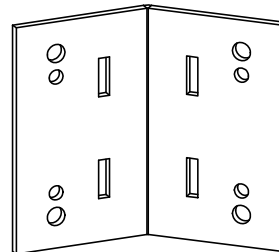

56616



56625



56647

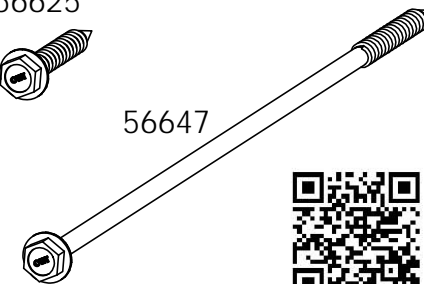

Laredo Sunset & Ironwood



Laredo Sunset
(566XX series)

2 great styles
Same functionality

choose your
connection lifestyle

both styles available for
most products

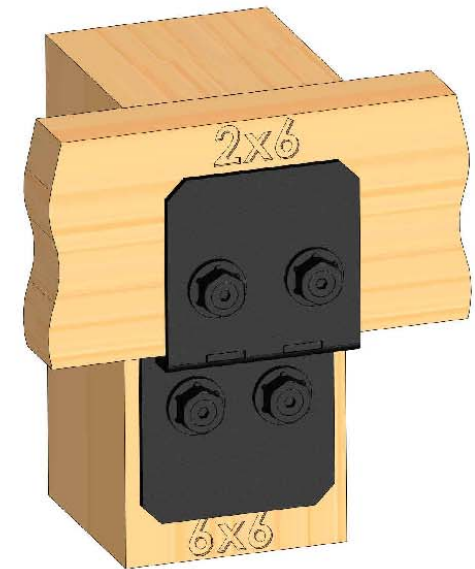

Ironwood
(517XX series)



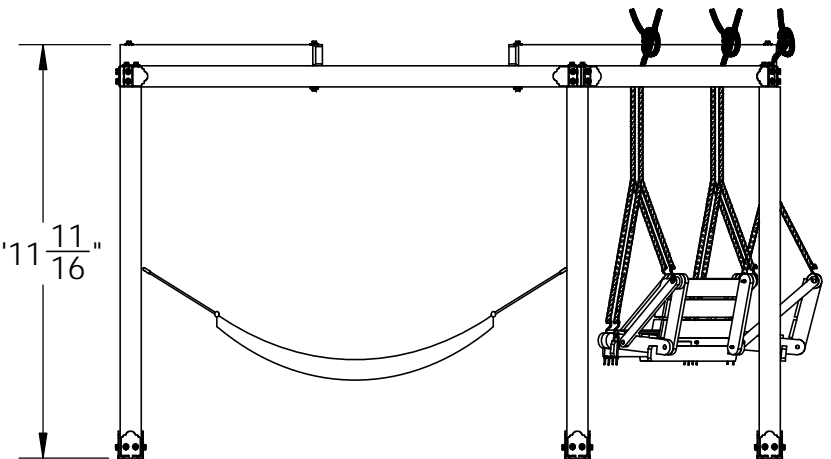
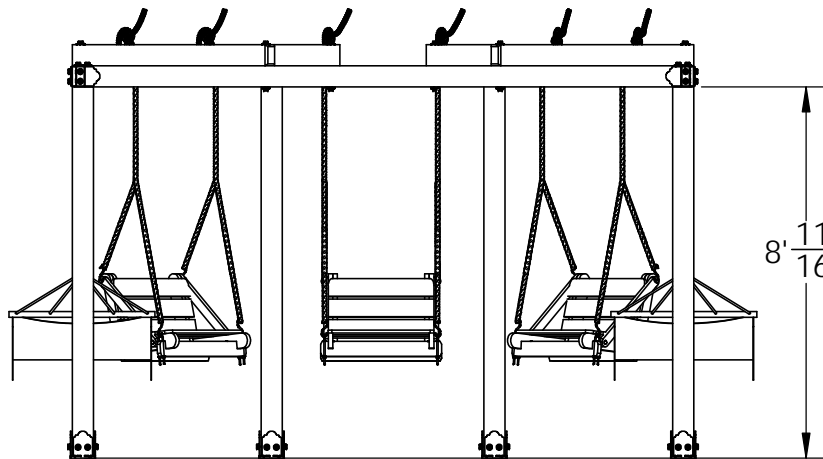
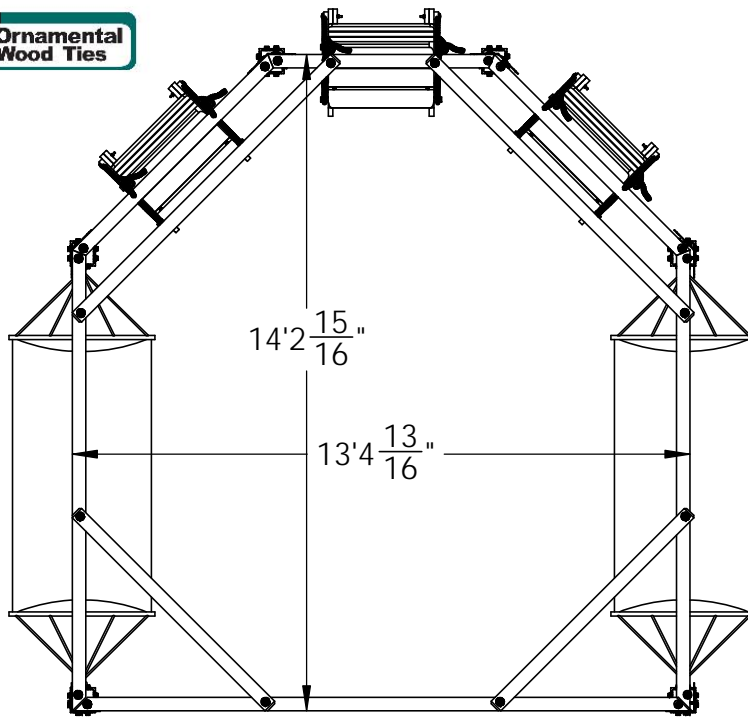

Overview I

OZCO Project #576 - Firepit All Around
Swing Seating

V2.00 - Installation Instructions, Specifications and Project Plans are effective 2/13/2017 . This information is updated periodically and should not be relied upon after 2 years from 2/13/2017 . Please visit OZCOBP.com to get current information.

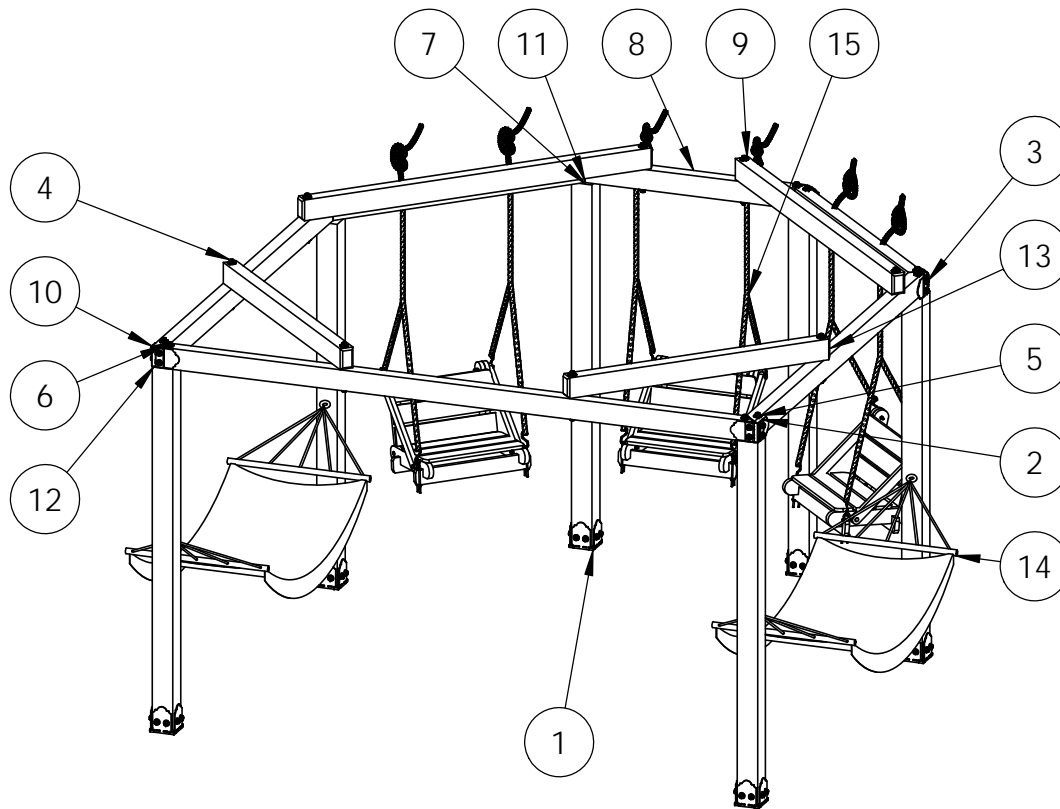

ITEM NO.	QTY.	PART NUMBER	DESCRIPTION
1	6	56608	6x6 Post Base Kit (6X6-PB-LS)
2	1	56615	Flush Inside 90 (FI-90)
	2	56611	Truss Accent (TA-LS)
	1	56625	OWT Timber Screw 1-3/4"
3	2	56616	Flush Inside 45 (FI-45)
	4	56611	Truss Accent (TA-LS)
	-	56625	OWT Timber Screw 1-3/4"
4	4	56652	OWT Timber Bolt 10-12"
	4	56680	2" Timber Bolt Heavy Duty Washer (OWT-TBW-2)
5	2	56621	1 1/2" Hex Cap Nut (HCN)
	2	56647	OWT Timber Screw 10"
6	3	56680	2" Timber Bolt Heavy Duty Washer (OWT-TBW-2)
7	6	6x6 Post	6x6x8'0"
8	1	4x6 Board	4x6x5'0"
9	2	4x6 Board	4x6x8'0"
10	2	4x6 Board	4x6x10'0"
11	2	4x6 Board	4x6x6'0"
12	1	4x6 Board	4x6x13'4 13/16"
13	2	4x6 Board	4x6x6'0"
14	2	Hammock	
15	3	swing, single with rope	Small Swing

Bill of Material I

OZCO Project #576 - Firepit All Around
Swing Seating

QTY.	PART NUMBER	DESCRIPTION
6	56608	6x6 Post Base Kit (6X6-PB-LS)
1	56615	Flush Inside 90 (FI-90)
4	56611	Truss Accent (TA-LS)
1	56625	OWT Timber Screw 1-3/4"
2	56616	Flush Inside 45 (FI-45)
4	56652	OWT Timber Bolt 10-12"
5	56680	2" Timber Bolt Heavy Duty Washer (OWT-TBW-2)
2	56621	1 1/2" Hex Cap Nut (HCN)
1	56647	OWT Timber Screw 10"
2	swing with rope	Large Swing
3	swing, single with rope	Small Swing
7	6x6x8L	6x6x8
4	4x6x8L	4x6x8
2	4x6x12L	4x6x12
1	4x6x6L	4x6x6

Material List



Translucent I

OZCO Project #576 - Firepit All Around
Swing Seating

V2.00 - Installation Instructions, Specifications and Project Plans are effective 2/13/2017 . This information is updated periodically and should not be relied upon after 2 years from 2/13/2017 . Please visit OZCOBP.com to get current information.

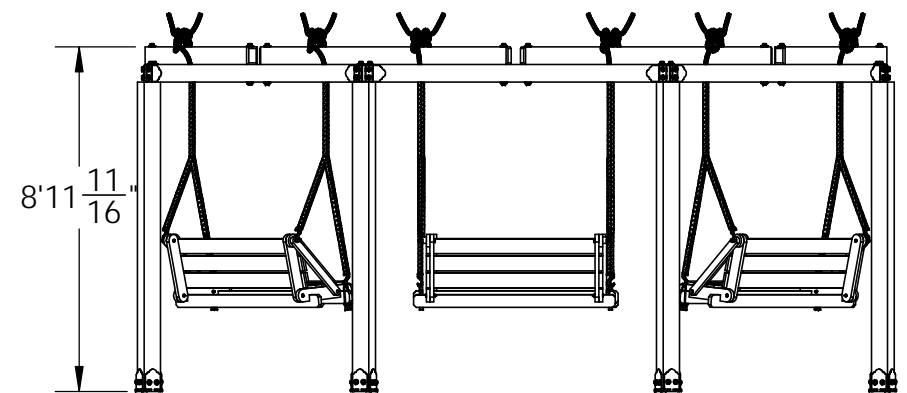
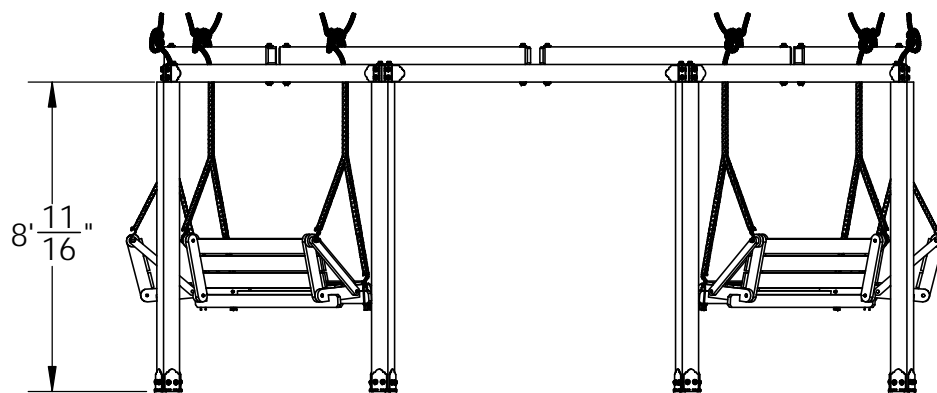
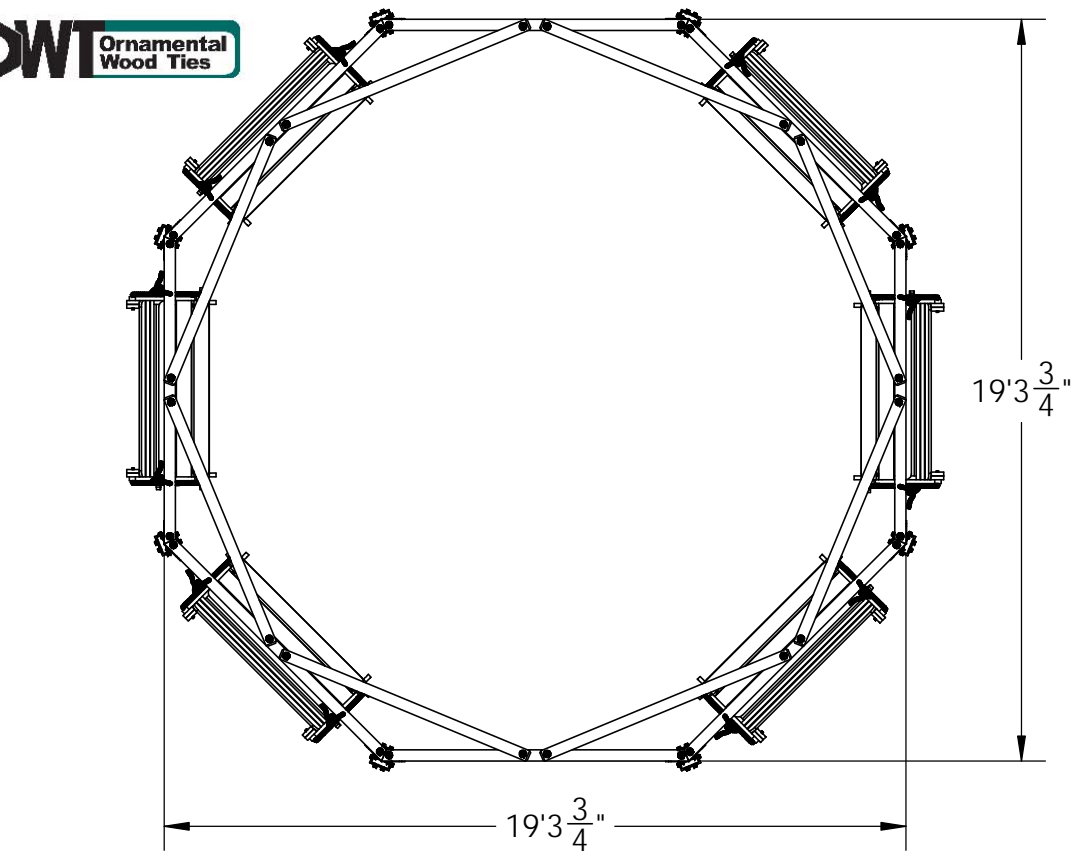

Overview II

OZCO Project #576 - Firepit All Around
Swing Seating

V2.00 - Installation Instructions, Specifications and Project Plans are effective 2/13/2017 . This information is updated periodically and should not be relied upon after 2 years from 2/13/2017 . Please visit OZCOBP.com to get current information.

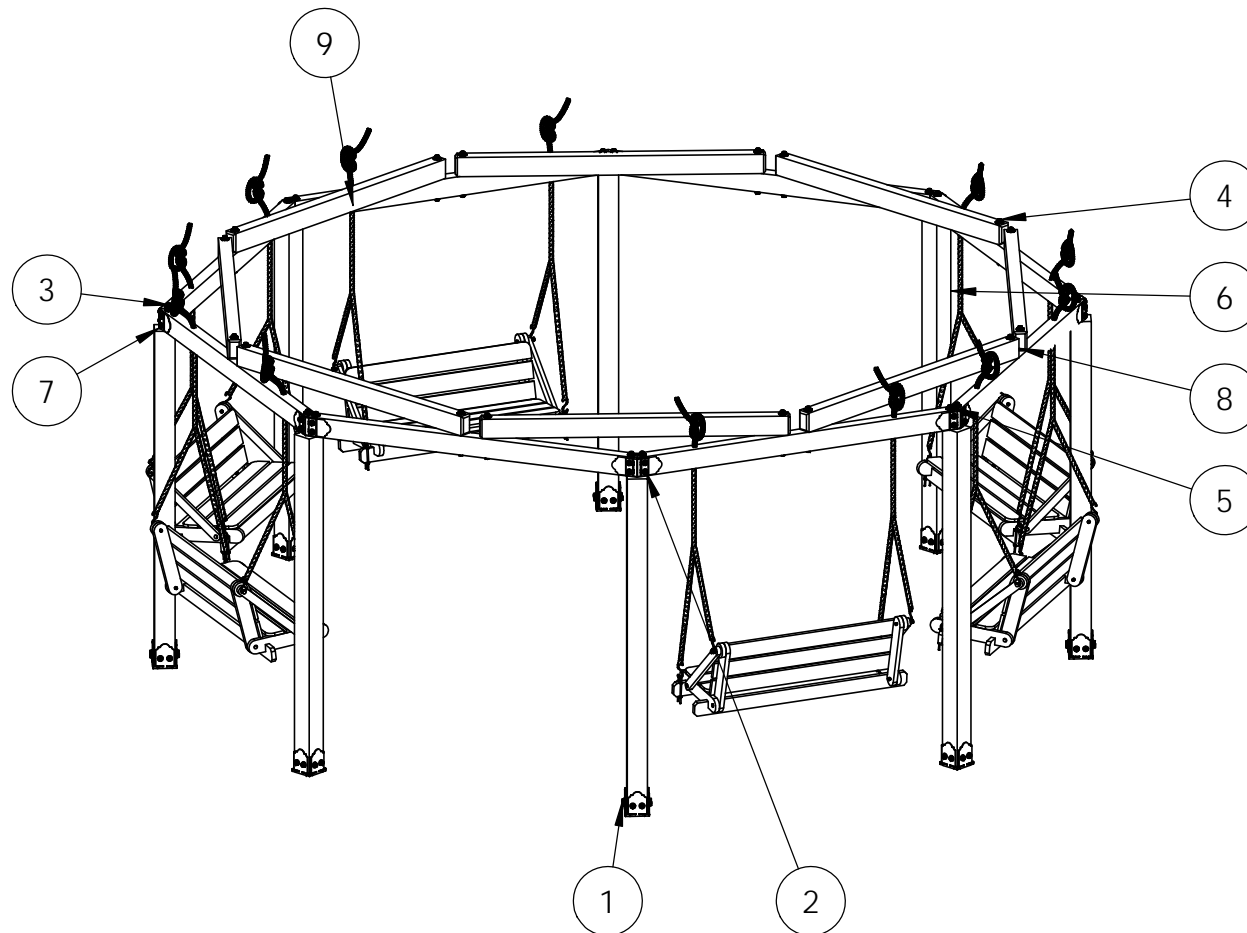

ITEM NO.	QTY.	PART NUMBER	DESCRIPTION
1	8	56608	6x6 Post Base Kit (6X6-PB-LS)
2	4	56616	Flush Inside 45 (FI-45)
	8	56611	Truss Accent (TA-LS)
	2	56625	OWT Timber Screw 1-3/4"
3	2	56621	1 1/2" Hex Cap Nut (HCN)
	2	56647	OWT Timber Screw 10"
4	8	56652	OWT Timber Bolt 10-12"
	8	56680	2" Timber Bolt Heavy Duty Washer (OWT-TBW-2)
5	4	56680	2" Timber Bolt Heavy Duty Washer (OWT-TBW-2)
6	8	6x6 Post	6x6x8'0"
7	8	4x6 Board	4x6x96.00
8	8	4x6 Board	4x6x7'0"
9	6	swing with rope	Large Swing

Bill of Material II

OZCO Project #576 - Firepit All Around
Swing Seating

QTY.	PART NUMBER	DESCRIPTION
8	56608	6x6 Post Base Kit (6X6-PB-LS)
4	56616	Flush Inside 45 (FI-45)
8	56611	Truss Accent (TA-LS)
2	56625	OWT Timber Screw 1-3/4"
2	56621	1 1/2" Hex Cap Nut (HCN)
1	56647	OWT Timber Screw 10"
8	56652	OWT Timber Bolt 10-12"
8	56680	2" Timber Bolt Heavy Duty Washer (OWT-TBW-2)
8	6x6x8L	6x6x8
16	4x6x8L	4x6x8
6	swing with rope	

Material List

